



48" SNOW BLADE ADAPTER KIT

to mount 79252 blade to 240 series

PART NO. 92-6833

**INSTALLATION
INSTRUCTIONS**

This adapter kit contains parts and instructions to mount 48" snow blade (Model 79252) onto 240 series Yard Tractors.

When 48" snow blade (Model 79252) is mounted onto 240 series Yard Tractors follow these instructions to install different rear mounts onto the tractor, not those in the Installation Instructions. Follow the Snow Blade Installation Instructions for other assembly and mounting instructions.

Loose Parts

Note: Use the chart below to verify all parts have been shipped.

DESCRIPTION	QTY.	USE
Mounting Plate	2	Rear hitch mounting.
Hitch Plate LH	1	
Hitch Plate RH	1	
Hardware Bag	1	

Tractor Set-Up (Hydrostatic Models Only)

1. Lift rear end of tractor and support with jackstands.
2. Remove rear wheels from tractor.
3. Remove (2) 5/16 x 1-1/4" bolts and nuts from left and right tractor frame (in front of transaxle) and transaxle U-bolt mounts (Fig. 1). Discard this hardware.

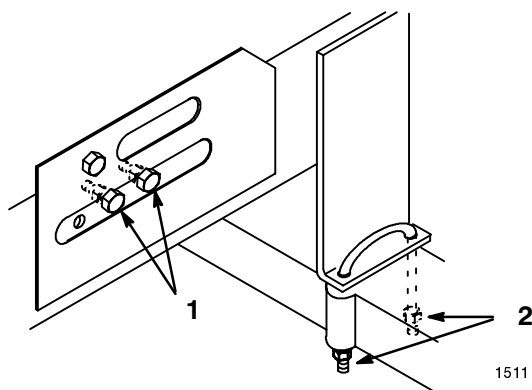

Figure 1

1. Bolt
2. Nut

4. Assemble mounting plates to the inside of left and right hitch plates with 1/2 x 1-1/2" bolts (heads on the outside) and lock nuts (Fig. 2).

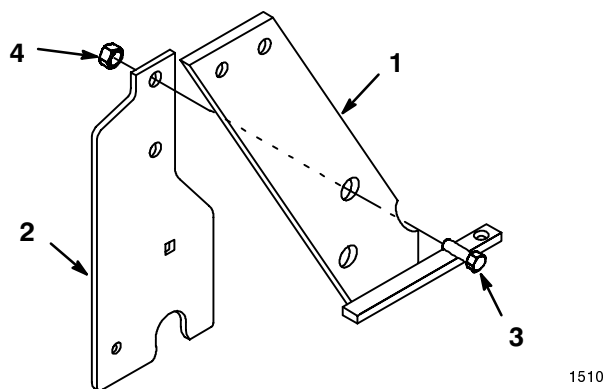

Figure 2

1. Hitch plate
2. Mounting plate
3. Bolt
4. Lock nut

5. Install latch levers to mounting plates with carriage bolts (head on the outside) washers and lock nuts (Fig. 3).

IMPORTANT: Do not tighten nut and bolt excessively to cause binding of levers at plate.

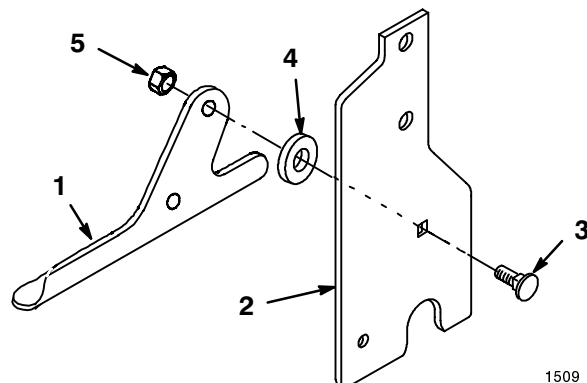

Figure 3

1. Latch lever
2. Mounting plate
3. Carriage bolt
4. Washer
5. Lock nut

6. Install rear mounting plate\hitch plate assembly alongside frame member with short tang under transaxle toward rear (Fig. 4). Secure with new U-bolts, bolts and lock nuts at holes in frame side members (Fig. 4).

IMPORTANT: On model 22-14OE01 tractors require three shim washers between hitch plate and transaxle U-bolt mount.

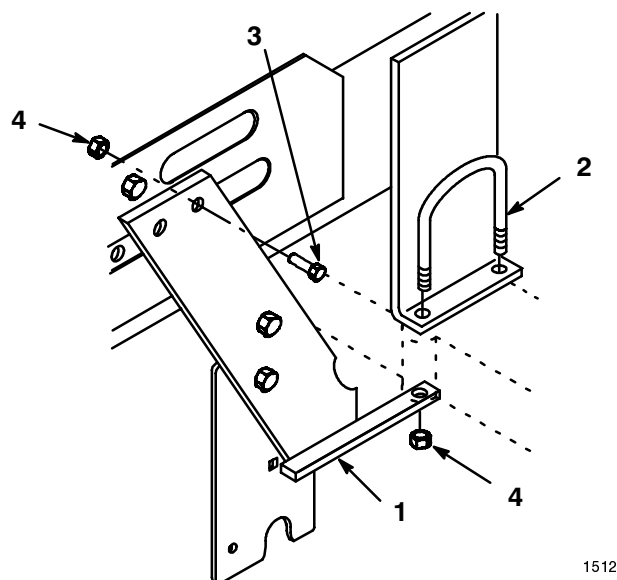

Figure 4

- | | |
|--|-------------|
| 1. Mounting plate/hitch plate assembly | 3. Bolt |
| 2. U-bolt | 4. Lock nut |

7. Install rear wheels.
8. Continue installation following Installation Instructions in Operator's Manual for Snow Blade.

Tractor Set-Up (Gear Drive Models Only)

1. Lift rear end of tractor and support with jackstands.
2. Remove rear wheels from tractor.
3. Locate 1/2" holes in frame brackets and install hitch brackets inside frame brackets with bolts (heads on the outside) and nuts (Fig. 5).

IMPORTANT: It may be necessary to drill out 3/8" dia. holes to 1/2" dia. **3/8" dia. bolts MUST NOT BE USED.**

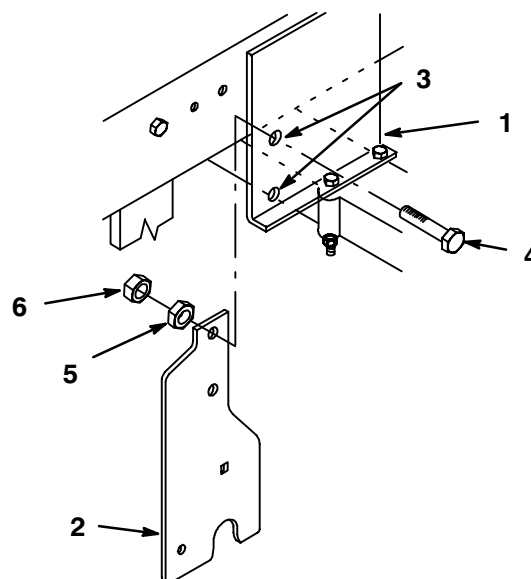
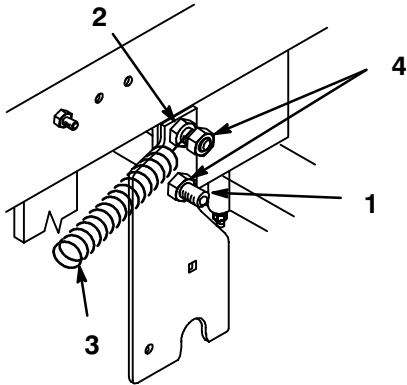

Figure 5

- | | |
|------------------|-------------|
| 1. Frame bracket | 4. Bolt |
| 2. Hitch bracket | 5. Jam nut |
| 3. 1/2" hole | 6. Lock nut |

4. Secure top bolt on left side and bottom bolt on right side with jam nuts (Fig. 6 & 7). Secure remaining bolts with lock nuts.
5. Hook clutch return spring to the top bolt on the left side and secure with lock nut flush with the end of the bolt (Fig. 6).



1514

Figure 6

- | | |
|------------|------------------|
| 1. Bolt | 3. Clutch Spring |
| 2. Jam nut | 4. Lock nut |

6. Hook brake return spring to the bottom bolt on the right side and secure with lock nut flush with the end of the bolt (Fig. 7).

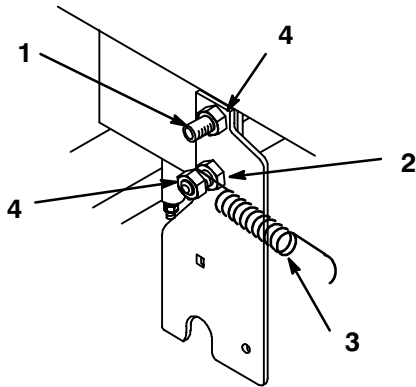

1515

Figure 7

- | | |
|------------|-----------------|
| 1. Bolt | 3. Brake Spring |
| 2. Jam nut | 4. Lock nut |

7. Install latch levers to mounting plates with carriage bolts (head on the outside) washers and lock nuts (Fig. 8).

IMPORTANT: Do not tighten nut and bolt excessively to cause binding of levers at plate.

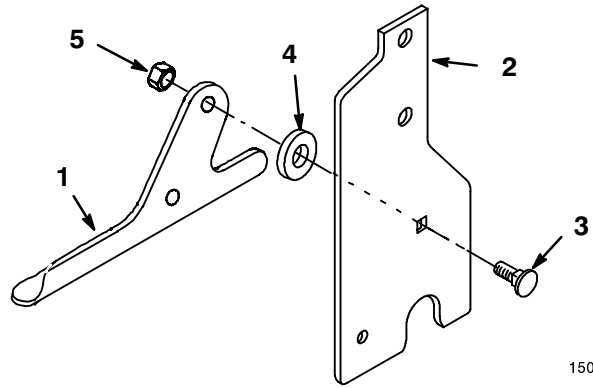

1509

Figure 8

- | | |
|-------------------|-------------|
| 1. Latch lever | 4. Washer |
| 2. Mounting plate | 5. Lock nut |
| 3. Carriage bolt | |

8. Install rear wheels.
9. Continue installation following Installation Instructions in Operator's Manual for Snow Blade.