



Hot Oil Shuttle Kit

2226 Directional Drill

Model No. 139-2475

Form No. 3426-279 Rev B

Installation Instructions

Parts List

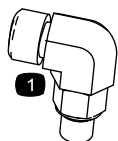

1x



1x

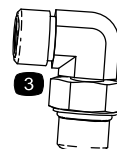

1x

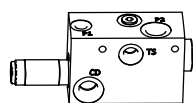

1x

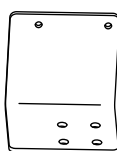

1x

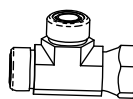

1x

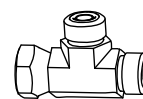

2x

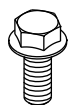

4x



2x



2x



1x



3x



43 cm (17-1/2 inch) — 1x



45 cm (18-1/2 inch) — 1x

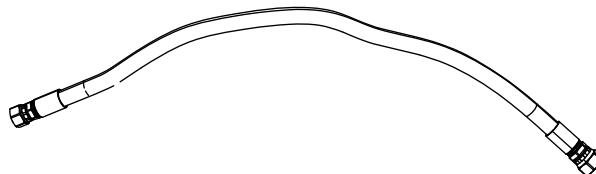

84 cm (33 inch) — 1x



Installing the Manifold

1. Move the machine to a level surface, shut off the engine, remove the key, turn the battery disconnect switch to the OFF position, and wait for the engine to cool; refer to the *Operator's Manual*.

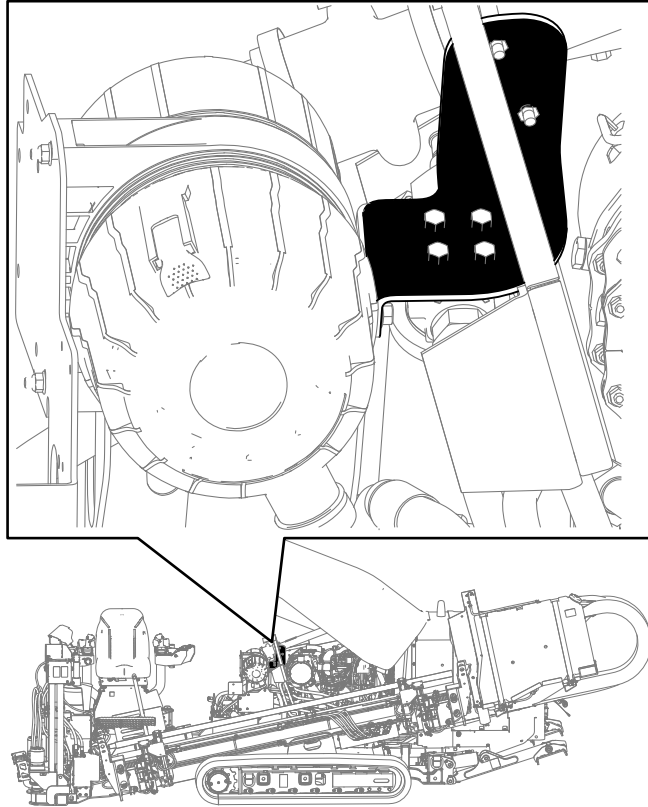

Figure 1

g269652

-
2. Install and hand tighten the fittings onto the manifold ([Figure 2](#)).

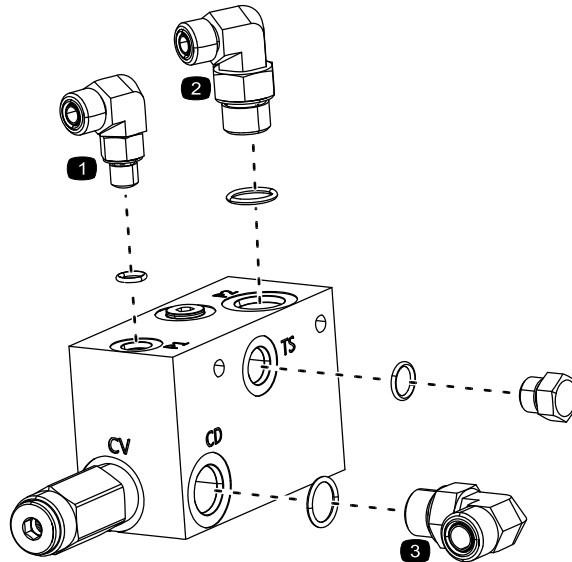
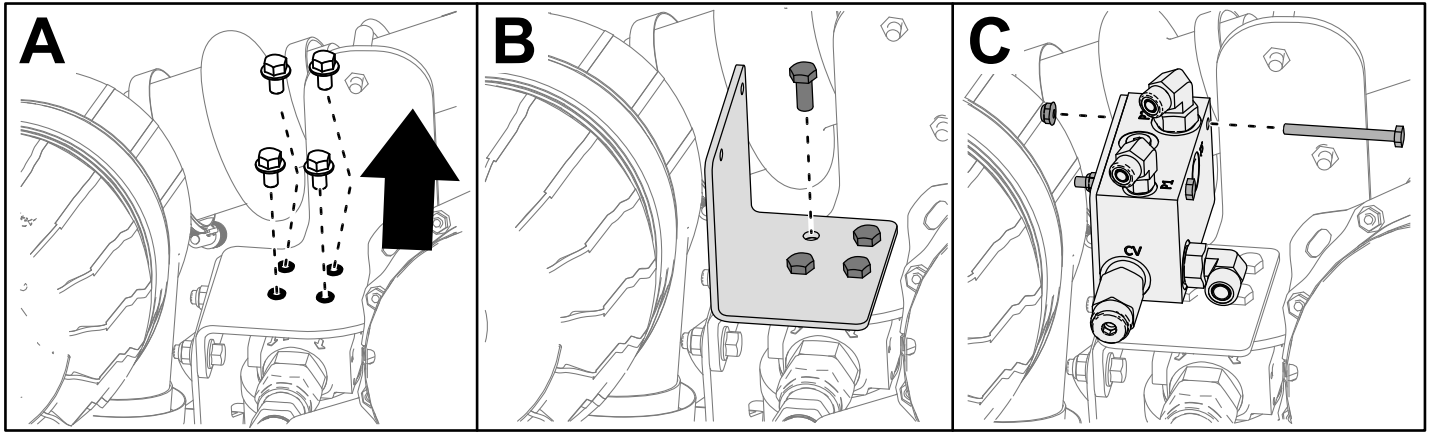

Figure 2

g269651

-
3. Install the plug onto the manifold ([Figure 2](#)) and torque to 46 to 57 N·m (34 to 42 ft-lbs).

4. Remove and discard the bolts on the charge filter mount (Box A of [Figure 3](#)).



g269650

Figure 3

5. Install the bracket using 4 bolts (3/8 inch) as shown in Box B of [Figure 3](#).
6. Install the manifold and fittings onto the bracket using 2 bolts (1/4 x 2-3/4 inches) and 2 nuts (1/4 inch) as shown in Box C of [Figure 3](#)).

Installing the Hoses

Installing the 84 cm (33 inch) Hose

1. Cut the cable ties on the hose guard and set the guard aside (Box A of [Figure 4](#)).
2. Disconnect the hose from the fitting on the case drain hard line (Box B of [Figure 4](#)).

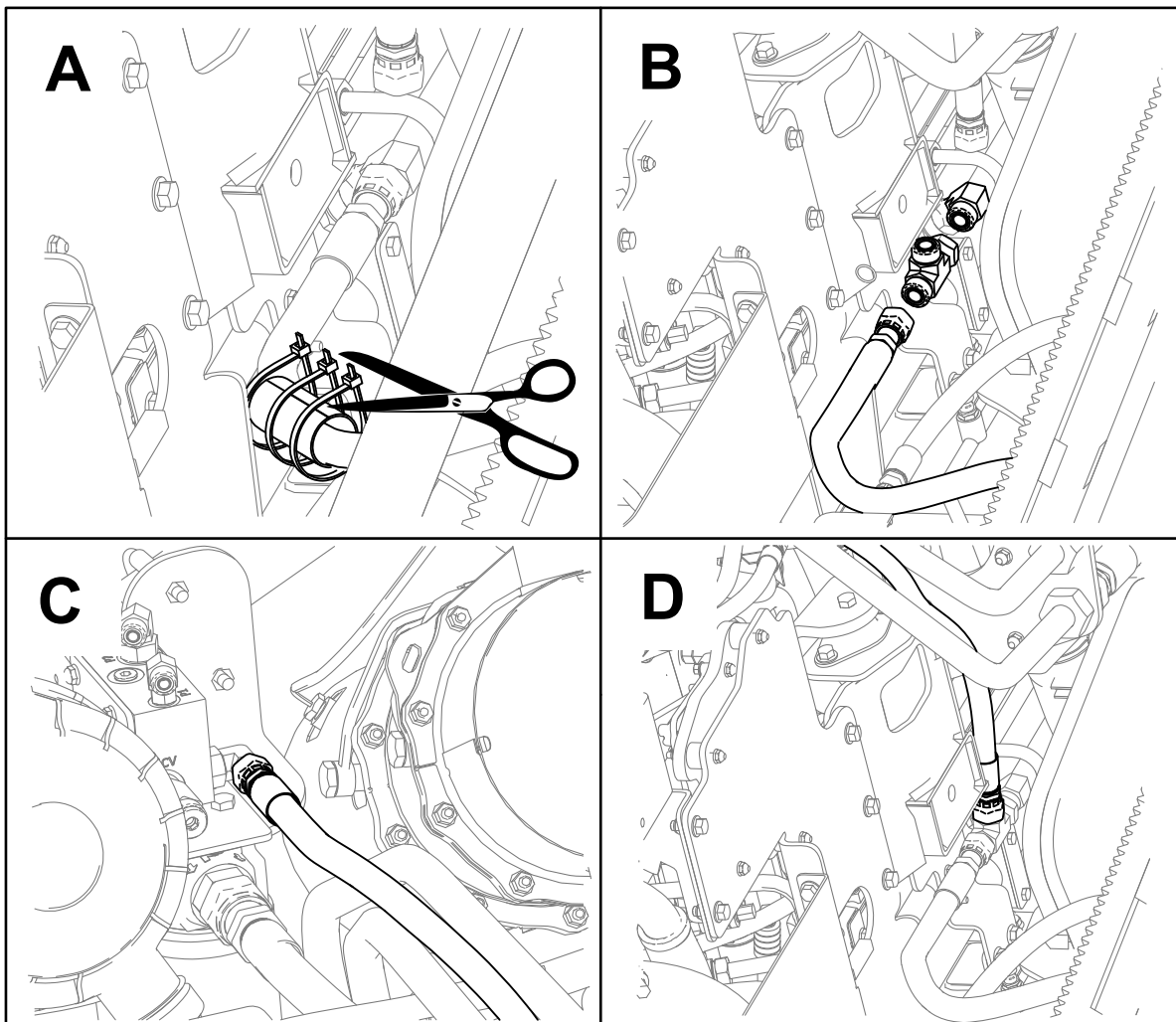

Figure 4

g269658

3. Install the large tee between the fitting and disconnected hose (Box B of [Figure 4](#)).
4. Install the 84 cm (33 inch hose) in port CD on the manifold and the top of the tee fitting (Box C and D of [Figure 4](#)).

5. Torque the fittings ([Figure 5](#)):

Important: Support the tee fitting with a crows foot on a long extension or from the side with a board or hammer handle.

- Fitting on the manifold: 78 to 98 N·m (58 to 72 ft-lb)
- 84 cm (33 inch) hose in port CD: 50 to 64 N·m (37 to 47 ft-lb)
- 84 cm (33 inch) hose connecting to the tee fitting: 81 to 100 N·m (60 to 74 ft-lb)
- Tee fitting: 81 to 100 N·m (60 to 74 ft-lb)
- Existing hose connecting to the tee fitting: 81 to 100 N·m (60 to 74 ft-lb)

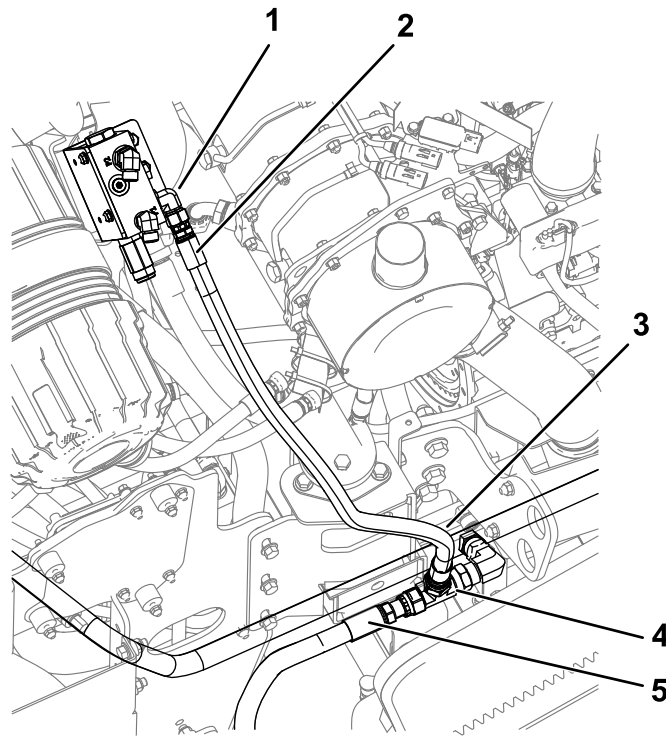

g270999

Figure 5

- | | |
|---|--|
| 1. Fitting on the manifold | 4. Tee fitting |
| 2. 84 cm (33 inch) hose in port CD | 5. Existing hose connecting to the tee fitting |
| 3. 84 cm (33 inch) hose connecting to the tee fitting | |

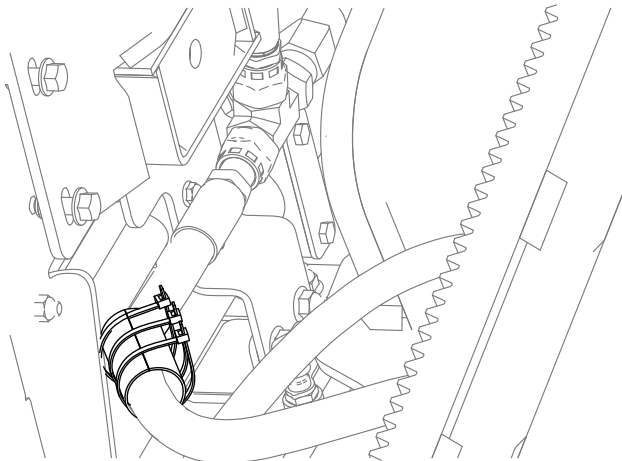

g271002

Figure 6

6. Install the hose guard using the 3 cable ties ([Figure 6](#)).

Installing the 43 cm (17-1/2 inch) Hose

1. Disconnect the hose from the upper hard line going to the rotary hydrostat (Box A of [Figure 7](#)).
2. Install a small tee between the hard line fitting and the disconnected hose (Box B of [Figure 7](#)).
3. Connect the 43 cm (17-1/2 inch) hose to the P2 fitting to the tee fitting (Box C of [Figure 7](#)).

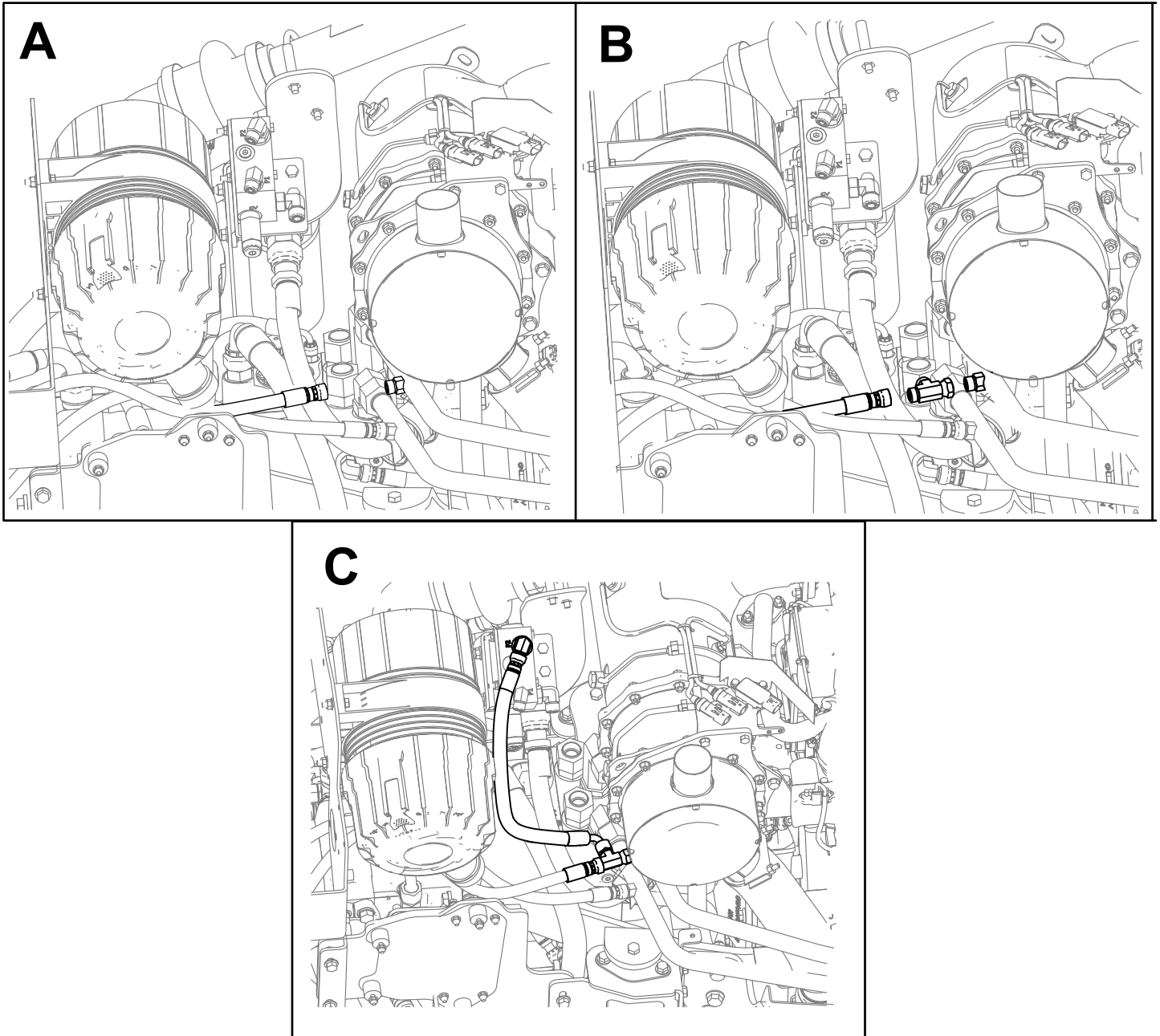

Figure 7

g269654

4. Torque the fittings (**Figure 8**):

- Fitting on the manifold: 78 to 98 N·m (58 to 72 ft-lb)
- 43 cm (17-1/2 inch) hose in port P2: 37 to 45 N·m (27 to 33 ft-lb)
- 43 cm (17-1/2 inch) hose connecting to the tee fitting: 37 to 45 N·m (27 to 33 ft-lb)
- Tee fitting: 37 to 45 N·m (27 to 33 ft-lb)
- Existing hose connecting to the tee fitting: 37 to 45 N·m (27 to 33 ft-lb)

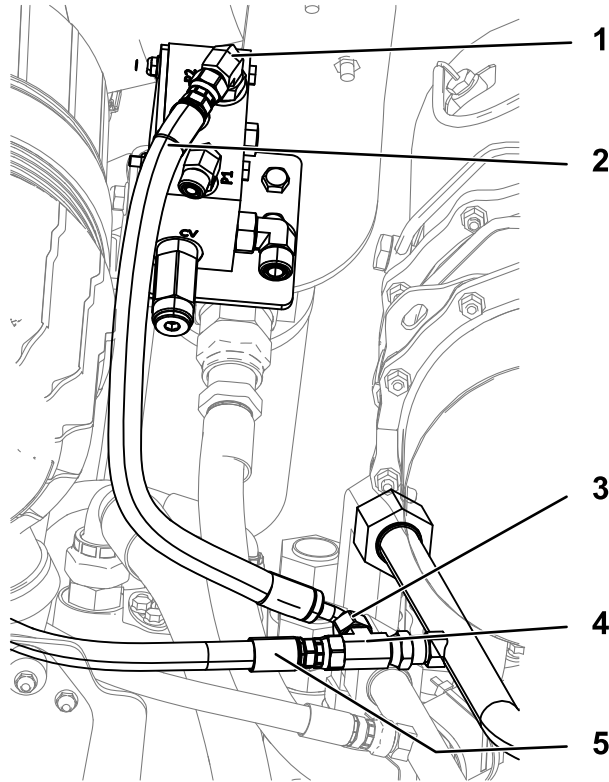

Figure 8

g271000

- | | |
|---|--|
| 1. Fitting on the manifold | 4. Tee fitting |
| 2. 43 cm (17-1/2 inch) hose in port P2 | 5. Existing hose connecting to the tee fitting |
| 3. 43 cm (17-1/2 inch) hose connecting to the tee fitting | |

Installing the 45 cm (18-1/2 inch) Hose

1. Disconnect the hose from the lower hard line going to the rotary hydrostat (Box A of [Figure 9](#)).
2. Install a small tee between the hard line fitting and the disconnected hose (Box B of [Figure 9](#)).
3. Connect the 45 cm (18-1/2 inch) hose to the P1 fitting to the tee fitting (Box C of [Figure 9](#)).

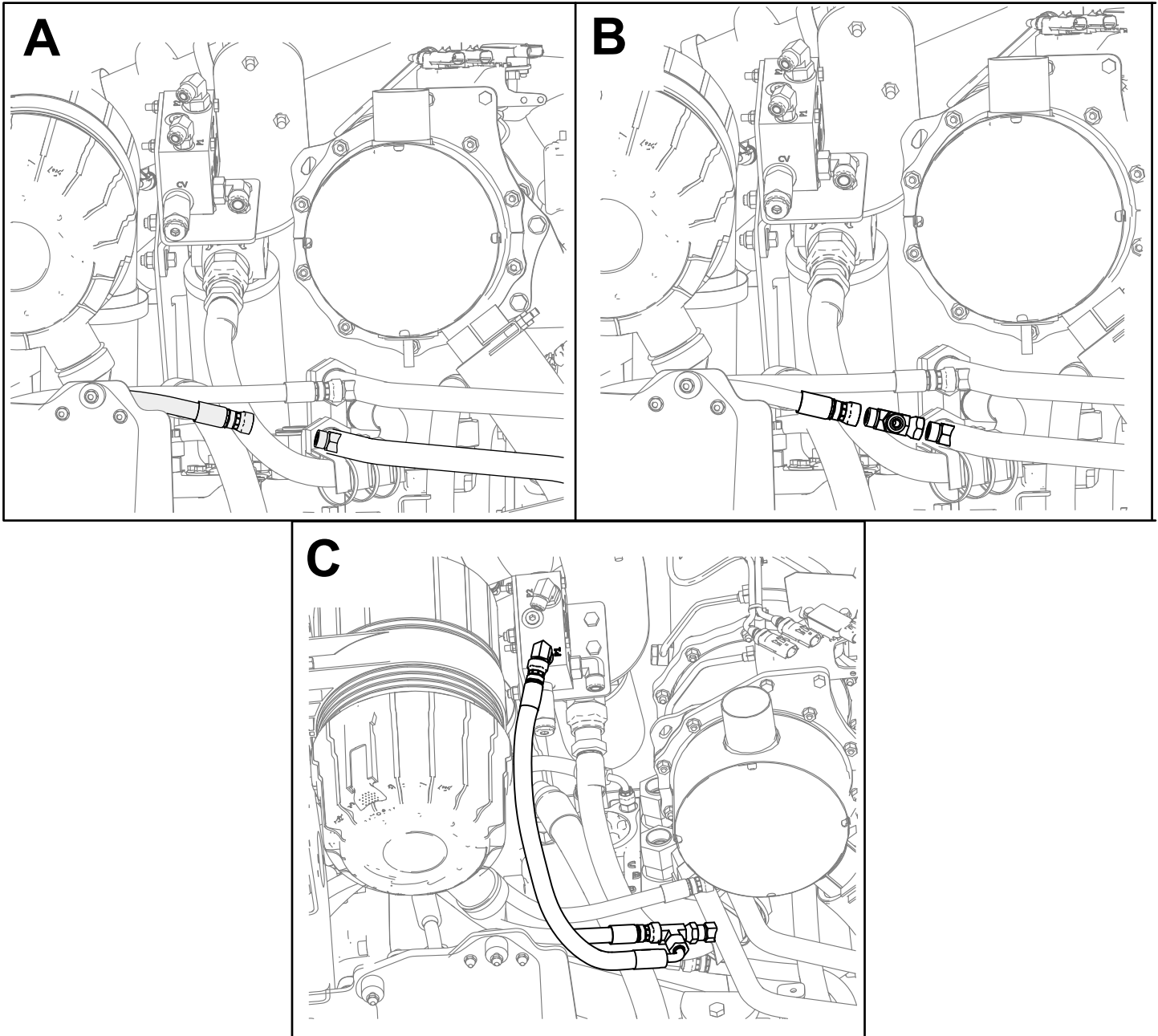

Figure 9

g269653

4. Torque the fittings ([Figure 10](#)):

- Fitting on the manifold: 20 to 26 N·m (15 to 19 ft-lb)
- 45 cm (18-1/2 inch) hose in port P1: 37 to 45 N·m (27 to 33 ft-lb)
- 45 cm (18-1/2 inch) hose connecting to the tee fitting: 37 to 45 N·m (27 to 33 ft-lb)
- Tee fitting: 37 to 45 N·m (27 to 33 ft-lb)
- Existing hose connecting to the tee fitting: 37 to 45 N·m (27 to 33 ft-lb)

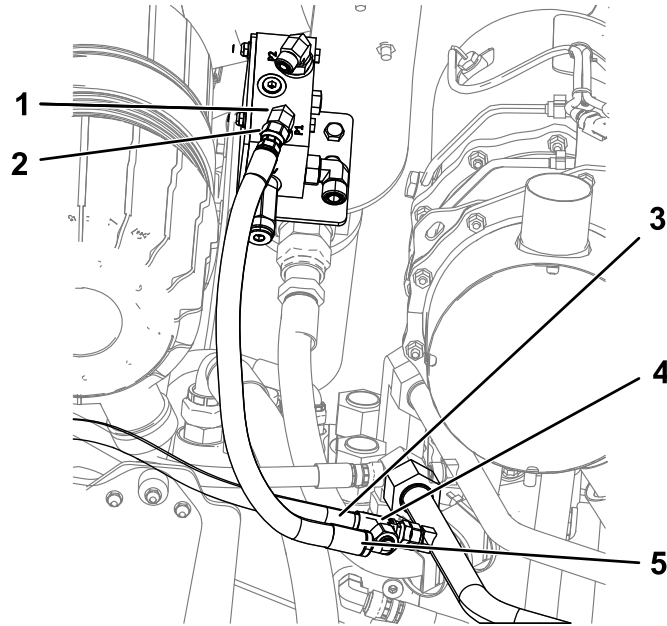

Figure 10

g270998

- | | |
|---|--|
| 1. Fitting on the manifold | 4. Tee fitting |
| 2. 45 cm (18-1/2 inch) hose in port P1 | 5. Existing hose connecting to the tee fitting |
| 3. 45 cm (18-1/2 inch) hose connecting to the tee fitting | |

Notes:

Notes:



Count on it.