



## Oil Drain Valve Kit

Part No. 99-8923

### INSTALLATION INSTRUCTIONS

## Loose Parts

**Note:** Use the chart below to identify parts for assembly.

DESCRIPTION	QTY.	USE
O-Ring	1	Install Oil Drain Valve
Oil Drain Valve	1	

## Installing Oil Drain Valve

**Note:** Install this kit when changing oil.

1. Locate and remove existing oil drain plug.
2. Install O-Ring onto oil drain valve (Fig. 1).
3. Backout clamping nut until it touches drain outlet (Fig.1).
4. Install oil drain valve into engine block. Install the drain outlet facing down. (Fig. 2).
5. Tighten clamping nut and torque to approximately 85-90 in-lbs (9.6-10.2 N•m) (Fig. 1).

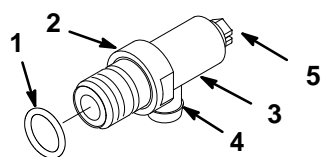

**Figure 1**

- |                    |                 |
|--------------------|-----------------|
| 1. O-Ring          | 4. Drain Outlet |
| 2. Clamping Nut    | 5. Valve end    |
| 3. Oil Drain Valve |                 |

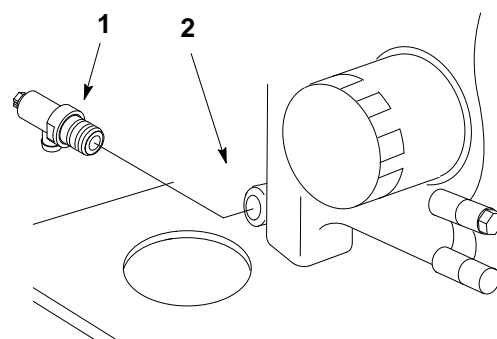

m-4403

**Figure 2**

- |                                |                 |
|--------------------------------|-----------------|
| 1. Oil Drain Valve with O-Ring | 2. Engine Block |
|--------------------------------|-----------------|

**IMPORTANT: Remember to fill engine with oil after oil drain valve is installed.**

## Operating Oil Drain Valve

1. Use either a flat screw driver, 3/8" wrench or 10mm wrench to open and close valve.
2. Rotate valve end clockwise to close valve. Rotate valve end counterclockwise to open valve.