



PART NO. 100-2531
PART NO. 100-2532

INSTALLATION
INSTRUCTIONS

FUEL TANK KIT

for Toro® Sitework™ Systems



CAUTION

Before servicing or making adjustments to the machine, stop engine and remove key from the switch.

1. Remove clamp securing fuel line to fitting on bottom of fuel tank and drain fuel into a approved container.

Note: On diesel machines, remove additional fuel line from tank.

2. Remove nut and fuel tank plate securing tank to tank mount as shown in figure 1.

3. Remove (2) screws securing tank mount to side of frame (Fig. 1). Discard all components.

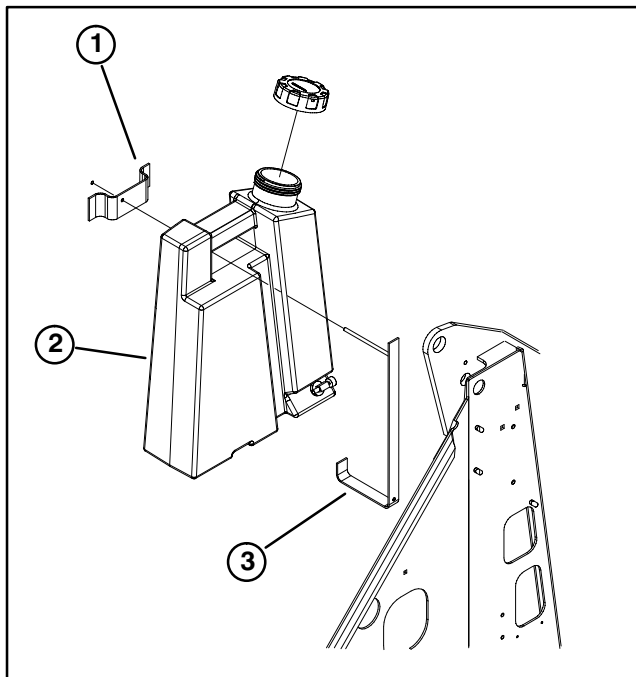

Figure 1

1. Fuel tank plate
2. Fuel tank
3. Fuel tank mount

4. Secure new tank mount to frame with (2) 1/2" lg. flange screws, positioning as shown in figure 2. **End of screws to be approximately flush with side of tank mount.** Tighten capscrews to 175-225 in.-lb.

5. Position new tank onto tank mount.

6. Secure tank to tank mount with a tank plate, (2) capscrews, (2) washers and (2) spacers. Spacers to be positioned inside tank plate (Fig. 2). Tighten capscrews to 175-225 in.-lb.

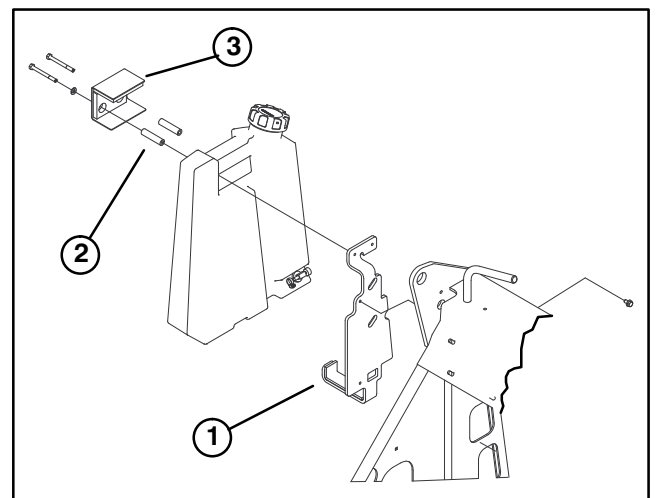

Figure 2

1. Tank mount
2. Spacers
3. Tank plate

7. Secure fuel line(s) to appropriate size fitting(s) on bottom of fuel tank and secure with hose clamp(s).

8. Install fuel tank cap.

Note: On diesel engines, air may need to be purged from fuel system before engine can will start. Refer to Operator's Manual for procedure.