

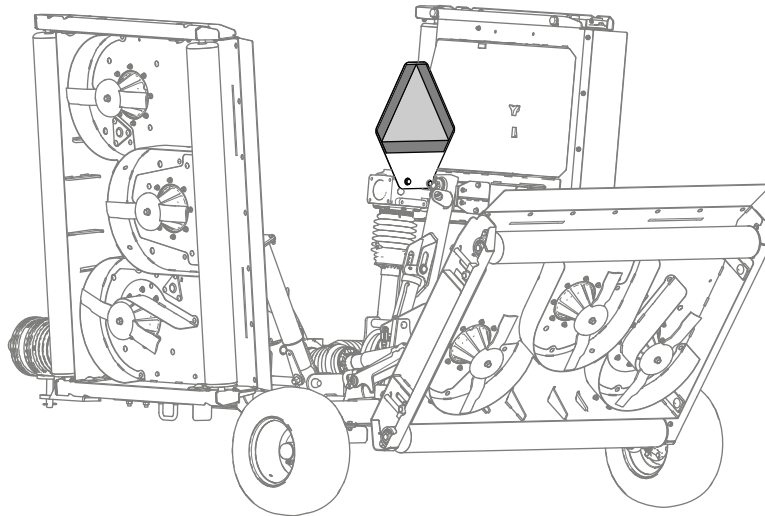

Slow Moving Vehicle Kit

Groundsmaster® 1200 Series Pull Behind Rotary Mower

Model No. 138-9030



Installation Instructions

⚠ WARNING

CALIFORNIA Proposition 65 Warning

Use of this product may cause exposure to chemicals known to the State of California to cause cancer, birth defects, or other reproductive harm.

Installation

Loose Parts

Use the chart below to verify that all parts have been shipped.

Procedure	Description	Qty.	Use
1	No parts required	–	Prepare the machine.
2	Slow-moving vehicle sign Capscrew Washer	1 2 2	Install the slow moving vehicle sign.



1

Preparing the Machine

No Parts Required

Procedure

1. Connect the machine to the tow vehicle; refer to the *Operator's Manual* for the machine.
2. Lower the mower decks; refer to the *Operator's Manual* for your machine.
3. Engage the parking brake for the tow vehicle, shutoff the engine, remove the key, and wait for all moving parts to stop before leaving the operator's seat.

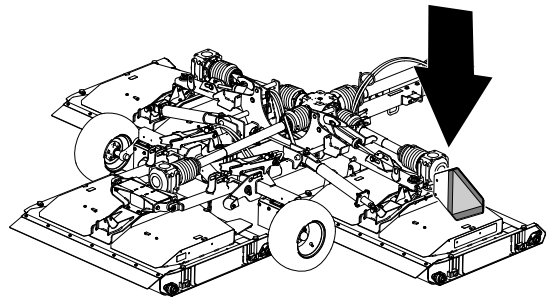

g280579

2

Installing the Slow-Moving Vehicle Sign

Parts needed for this procedure:

1	Slow-moving vehicle sign
2	Capscrew
2	Washer

Procedure

1. At the right deck gearbox, align the slow-moving vehicle sign so that the reflective side is rearward ([Figure 1](#)).

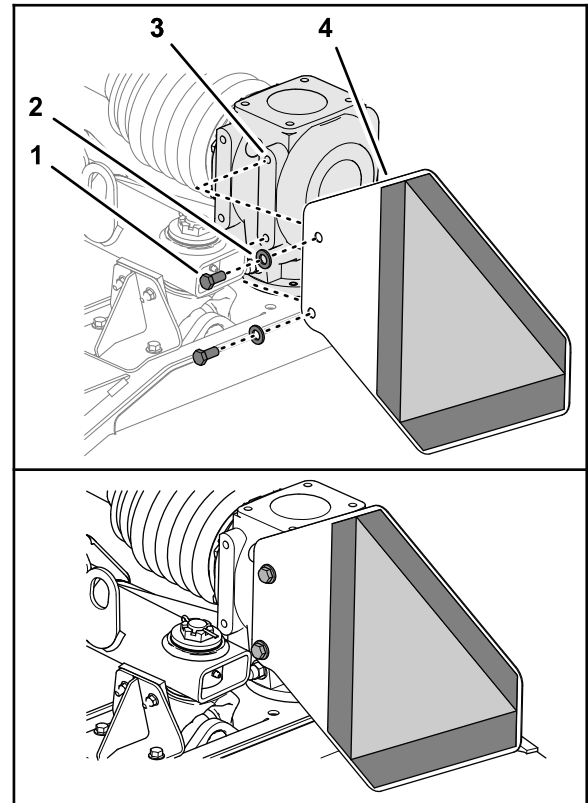

g280577

Figure 1

- | | |
|-------------|---------------------------------------|
| 1. Capscrew | 3. Threaded hole (right deck gearbox) |
| 2. Washer | 4. Slow moving vehicle sign |
-
2. Align the holes in the slow-moving vehicle sign with the threaded holes in the gearbox as shown in [Figure 1](#).
 3. Assemble the slow-moving vehicle sign to the gearbox with 2 capscrews and 2 washers.
 4. Torque the capscrews to 59 to 73 N·m (80 to 100 ft·lb).