



## Blade Kit

Part No. 100-2422

### INSTALLATION INSTRUCTIONS

## Loose Parts

**Note:** Use the chart below to identify parts for assembly.

DESCRIPTION	QTY.	USE
Righthand Blade	1	Install Blades and Spacer
Lefthand Blade	1	
Shear Bolt	4	
Lock Nut	4	
Spacer	2	

## Removing Existing Blades

### WARNING

#### POTENTIAL HAZARD

- Blade is sharp.

#### WHAT CAN HAPPEN

- Contact with sharp blade can cause serious personal injury.

#### HOW TO AVOID THE HAZARD

- Wear gloves or wrap sharp edges of the blade with a rag.

1. Disengage the power take off (PTO), set the parking brake, and turn the ignition key to "OFF" to stop the engine. Remove the key.
2. Flip up deck and lock into vertical position. Refer to Tilting the Mower on page 3.
3. Hold the blade end using a rag or thickly-padded glove. Remove the blade bolt, shear bolts, lock nuts, spacer and blade from the blade retainer.
4. Discard blades, shearbolts, locknuts and spacer.

## Installing the Blades and Spacer

**Note:** Notice there is a left hand and a right hand blade. Notice the direction in which the blades turn. The cutting edge must rotate toward the center of the deck. (Fig. 1).

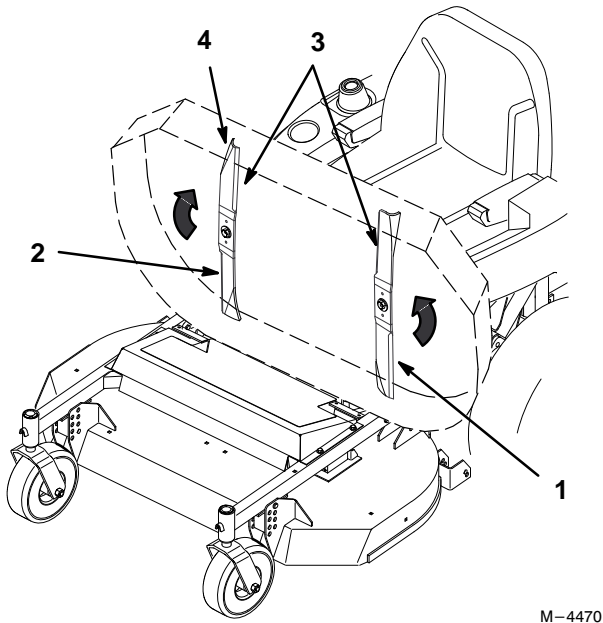

Figure 1

1. Lefthand Blade
2. Righthand Blade
3. Cutting Edge
4. Curve in Blade Towards Deck

1. Install washer and spacer onto blade bolt. New spacer is black in color (Fig. 2).

**IMPORTANT:** The curved part of the blade must be pointing upward toward the inside of the mower to ensure proper cutting.

2. Place blade against blade retainer and align holes (Fig. 2).
3. Install blade bolt, washer and spacer onto blade retainer. Thread blade bolt into spindle shaft. Ensure that the spacer is in hole of blade (Fig. 2).

4. Torque the blade bolt to 85–110 ft-lb (115–150 N•m).
5. Rotate blade. Blade should rotate freely.
6. Repeat this procedure for second blade.

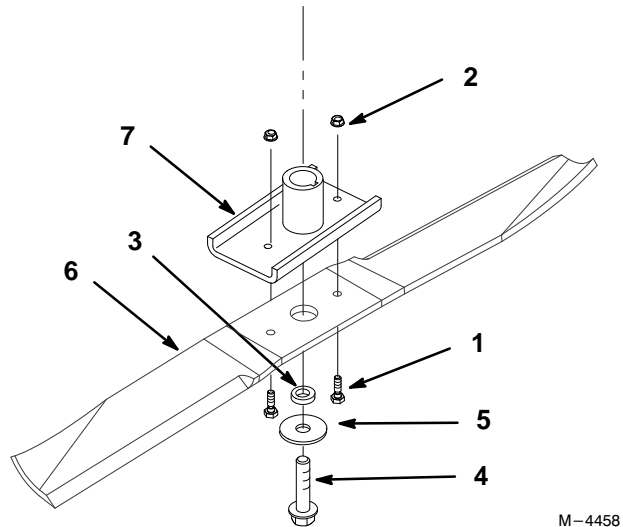

Figure 2

- |               |                            |
|---------------|----------------------------|
| 1. Shear Bolt | 5. Washer                  |
| 2. Lock Nut   | 6. Blade (Righthand Shown) |
| 3. Spacer     | 7. Blade Retainer          |
| 4. Blade Bolt |                            |

## Installing Shear Bolts

1. Install new shear bolts and lock nuts. Tighten the shear bolt to 80–90 in-lb (9–10 N•m) (Fig. 2).

**Note:** Notice the direction of the shear bolts being replaced (Fig. 2).

2. Repeat this procedure for second blade.

## Tilting the Mower

The mower can be tilted up for ease of service.

### To Raise Mower

1. Turn engine off, set the parking brake and check that PTO cover is down against deck.
2. Lift on the mower carrier frame to release weight on latch pin and pull out on latch pin to release (Fig. 3). Lower rear of mower onto anti-scalp rollers. Repeat on the other side.
3. Return the pins to the spring loaded (down) position.

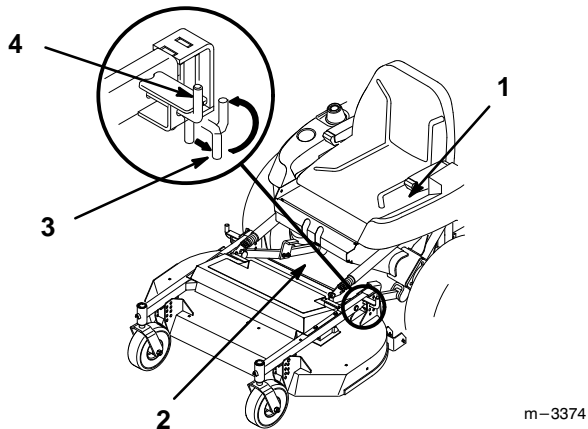

**Figure 3**

- |                  |               |
|------------------|---------------|
| 1. Parking brake | 3. Latch pin  |
| 2. PTO cover     | 4. Notch—open |

4. Standing in front of the mower, lift up and push rearward on front to raise mower (Fig. 4).
5. Raise mower until it contacts stops and latch pins snap into locked position.

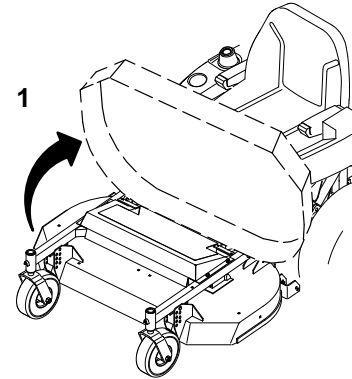

**Figure 4**

1. Mower up

