



Backlap Kit

Greensmaster® 1021 or 1026 Mower

Model No. 04800

Installation Instructions

Installation

Loose Parts

Use the chart below to verify that all parts have been shipped.

Procedure	Description	Qty.	Use
1	No parts required	–	Prepare the machine.
2	No parts required	–	Remove the control cover.
3	Proximity-sensor assembly Double-ended screw Flange nut (1/4 inch) Interlock module Hex-head bolt (3/8 inch)	1 2 2 1 2	Install the proximity-sensor assembly and interlock module
4	Wire harness	1	Install the wire harness
5	No parts required	–	Install the control cover.
6	Drive hub Seal	1 1	Install the backlap knob to the reel-drive assembly.
7	Bail catch Knob Axle-lock bracket Transport Wheel Kit (order separately; contact your authorized Toro distributor)	1 1 1 1	Prepare to backlap.

1

Preparing the Machine

No Parts Required

Procedure

1. Park the machine on a level surface.
2. Engage the parking brake.
3. Shut off the engine.
4. Remove the spark-plug wire from the spark plug; refer to your machine *Operator's Manual*.

2

Removing the Control Cover

No Parts Required

Procedure

1. Disconnect the wire-harness connector from the hour meter ([Figure 1](#)).



3

Installing the Proximity-Sensor Assembly and Interlock Module

Parts needed for this procedure:

1	Proximity-sensor assembly
2	Double-ended screw
2	Flange nut (1/4 inch)
1	Interlock module
2	Hex-head bolt (3/8 inch)

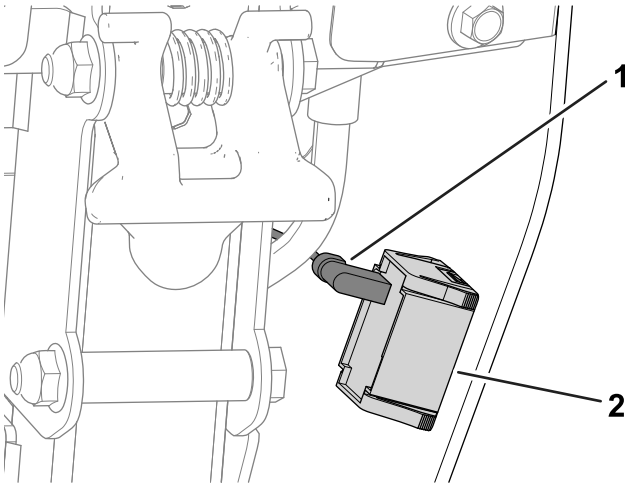

g280735

Figure 1

1. Wire-harness connector 2. Hour meter

2. Remove the control cover by removing the screws that secure the control cover to the rear panel ([Figure 2](#)).

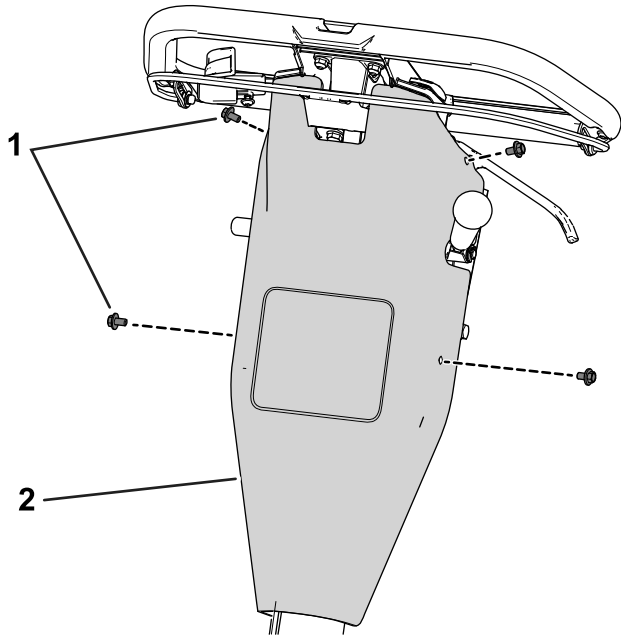

g280734

Figure 2

1. Screw 2. Control cover

Installing the Proximity-Sensor Assembly

Refer to [Figure 3](#) for this procedure.

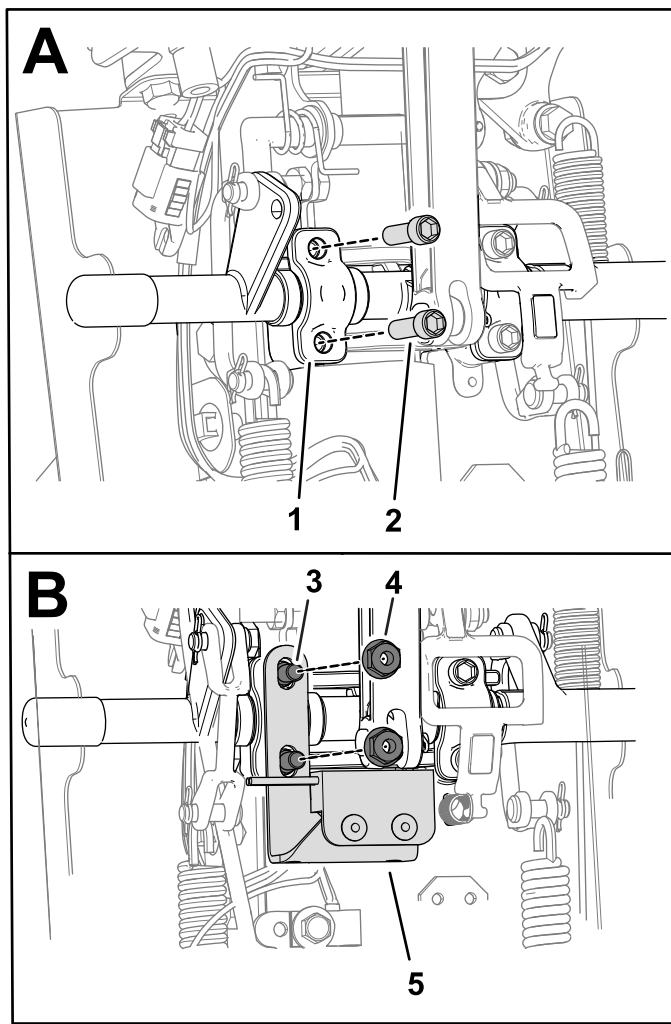

Figure 3

1. Spacer
2. Socket-head screw
3. Double-ended screw
4. Flange nut (1/4 inch)
5. Proximity-sensor assembly

1. Remove the socket-head screws from the spacer on the control shaft
2. Use 2 double-ended screw and 2 flange nuts (1/4 inch) to install the proximity-sensor assembly to the spacer on the control shaft.
3. Torque the screws and nuts to 9 to 12 N·m (7 to 9 ft-lb).

Installing the Interlock Module

Use 2 hex-head bolts (3/8 inch) to install the interlock module to the cable bulkhead ([Figure 4](#)).

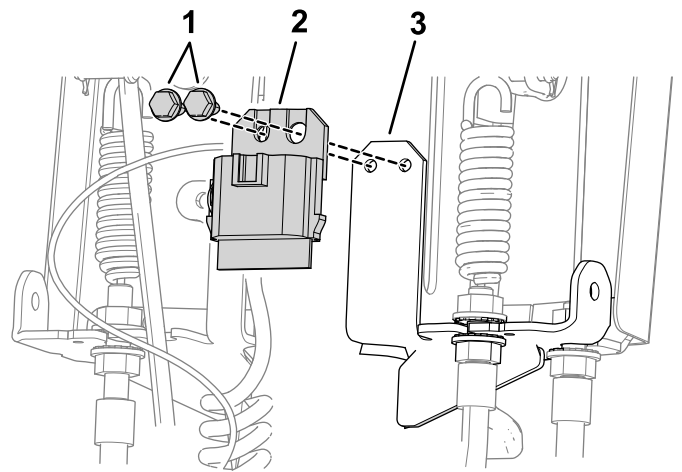

Figure 4

1. Screw
2. Interlock module
3. Cable bulkhead

4

Installing the Wire Harness

Parts needed for this procedure:

1	Wire harness
---	--------------

Procedure

Install the wire harness as follows:

- Wire-harness end with the 6-socket connector: install to the interlock module.
- Wire-harness end labeled **TRACTION SWITCH**: install to the proximity-sensor connector.
- Wire-harness end labeled **TO MAIN HARNESS**: install to the machine-wire-harness end labeled **TO INTERLOCK MODULE**.

5

Installing the Control Cover

No Parts Required

Procedure

Refer to the illustrations in [2 Removing the Control Cover \(page 1\)](#) for this procedure.

1. Use the previously-removed screws to install the control cover.
2. Connect the wire-harness connector to the hour meter.

6

Installing the Backlap Knob to the Reel-Drive Assembly

Parts needed for this procedure:

1	Drive hub
1	Seal

Procedure

1. Remove the plug from the top of the reel-drive assembly ([Figure 5](#)).

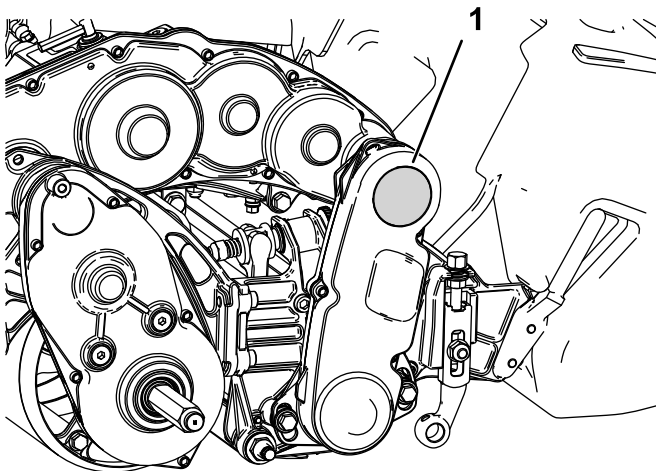

Figure 5

1. Plug

2. Remove the 3 bolts that secure the cover to the reel-drive assembly and remove the reel-drive cover ([Figure 6](#)).

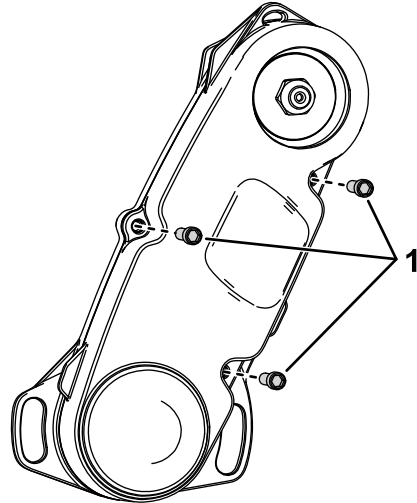

Figure 6

1. Bolt

3. While securing the drive pulley from movement, remove the nut from the reel-drive shaft ([Figure 7](#)).

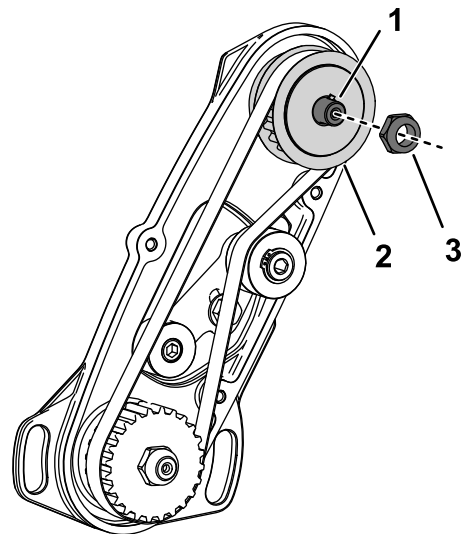

Figure 7

1. Reel-drive shaft
2. Pulley
3. Nut

4. While securing the drive pulley from movement, install the drive hub to the reel-drive shaft ([Figure 8](#)).

7

Preparing to Backlap

Parts needed for this procedure:

1	Bail catch
1	Knob
1	Axle-lock bracket
1	Transport Wheel Kit (order separately; contact your authorized Toro distributor)

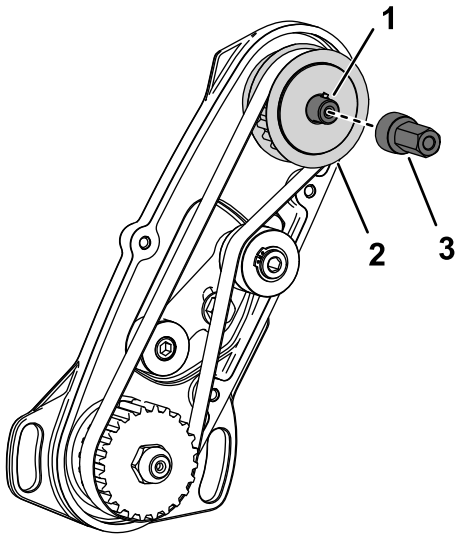

Figure 8

g284490

1. Reel-drive shaft
2. Pulley
3. Drive hub

5. While securing the drive pulley from movement, torque the drive hub to 37 to 44 N·m (27 to 32 ft-lb).
6. Lubricate the lip of the reel-drive cover and press the seal flush into the cover ([Figure 9](#)).

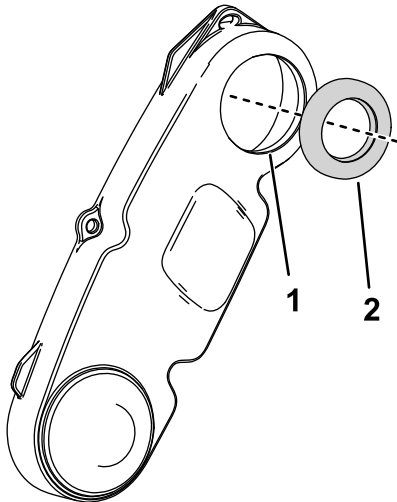

Figure 9

g284488

1. Lip
2. Seal

7. Install the cover to the reel-drive assembly with the bolts that you removed in step 2; refer to [Figure 6](#).

Procedure

1. Install the spark-plug wire to the spark plug; refer to your machine *Operator's Manual*.
2. Gather the remaining loose parts (i.e., the bail catch, knob, and axle-lock bracket) and the transport wheels for use in [Backlapping the Cutting Unit](#) (page 6).

Operation

Backlapping the Cutting Unit

Preparing the Machine for Backlapping

1. Move the kickstand to the TRANSPORT-WHEEL SERVICE position; refer to your machine *Operator's Manual*.
2. Note the position of the traction drum (refer to your machine *Operator's Manual*) and install the axle-lock bracket to the left axle shaft as follows:
 - **Drum set to the Low position:** slide the bracket over the shaft with the shorter prong facing toward the machine.
 - **Drum set to the High position:** slide the bracket over the shaft with the longer prong facing toward the machine (as shown in [Figure 10](#)).

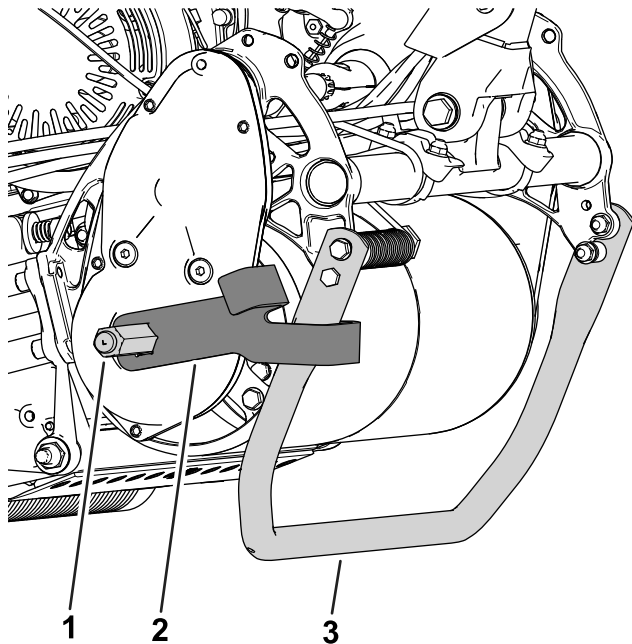

Figure 10

1. Left axle shaft
2. Axle-lock bracket
3. Kickstand

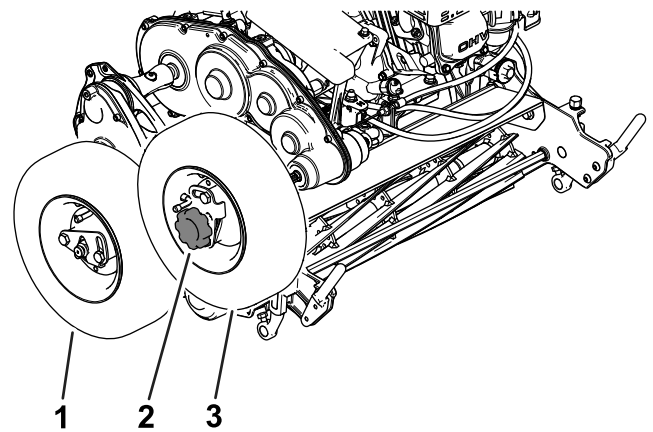

Figure 11

1. Transport wheel—right-wheel shaft
 2. Knob
 3. Transport wheel—drive hub
-
4. Remove the coupler from the transmission driveshaft and adjust the reel-drive assembly to ensure that the wheels are contacting; refer to the cutting unit maintenance section of your machine *Operator's Manual*.
 5. Install the knob over the wheel on the drive hub ([Figure 11](#)).

3. Install the transport wheels onto the right-wheel shaft and the drive hub; refer to [Figure 11](#).

Performing a Backlapping Job

⚠ DANGER

Contact with the reel or other moving parts can result in personal injury.

- Stay away from the reel while backlapping.
- Do not use a short-handled paint brush for backlapping. A brush and handle assembly (Part No. 29-9100) is available from your authorized Toro distributor.

1. Start the engine; refer to your machine *Operator's Manual*.
2. Engage the traction drive as follows:
 - **Machines equipped with the clutch bail:** Engage the clutch bail and install the bail catch (Figure 12).

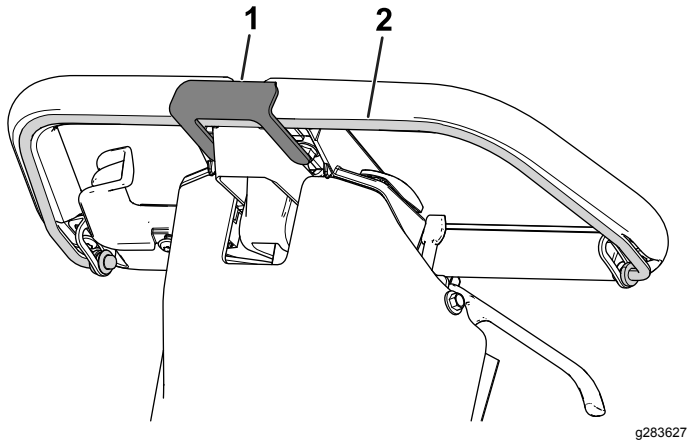

Figure 12

1. Bail catch
2. Clutch bail

- **Machines equipped with the Traction Lever Kit:** Move the traction lever down to the ENGAGED position; refer to the kit *Installation Instructions*.
3. Use a long-handled brush to apply lapping compound to the rotating reel.

4. When the backlapping operation is completed and cutting reel is not moving, perform the following steps:
 - A. Run a file across the front face of the bedknife.

Note: This will remove any burrs or rough edges that may have built up on the cutting edge.
 - B. Remove the bail catch and axle-lock bracket.
 - C. Align the reel-drive assembly with the transmission driveshaft and install the reel-drive coupler to the driveshaft; refer to the cutting unit maintenance section of your machine *Operator's Manual*.



Count on it.