



<h2 style="margin: 0;">Rear Baffle Kit</h2> <p style="margin: 0;">for 48" OFZ Deck</p>	
<p>Part No. 100-2438</p>	<p><b>INSTALLATION INSTRUCTIONS</b></p>

## Loose Parts

**Note:** Use the chart below to identify parts for assembly.

DESCRIPTION	QTY.	USE
Righthand Baffle	1	Connect Baffles
Lefthand Baffle	1	
Screw	6	Install Baffles
Flat Washer	4	
Retainer Nut	2	
Lock Nut	4	

## Pre-Installation

**WARNING**

**POTENTIAL HAZARD**

- **Blade is sharp.**

**WHAT CAN HAPPEN**

- **Contact with sharp blade can cause serious personal injury.**

**HOW TO AVOID THE HAZARD**

- **Wear gloves or wrap sharp edges of the blade with a rag.**

3. Thoroughly clean mower deck. All debris must be removed to ensure baffle will fit properly against mower deck.
4. Repair all bent or damaged areas of mower deck and replace any missing parts.

## Removing Existing Baffles

1. Disengage the power take off (PTO), set the parking brake, and turn the ignition key to "OFF" to stop the engine. Remove the key.
2. Tilt up deck and lock into vertical position. Refer to Tilting the Mower on page 4.

1. Remove hardware for exiting baffles and then remove baffles.

## Installing Retainer Nuts

Install retainer nuts into two existing holes if none exist.

1. Remove all baffles that are bolted under deck.
2. On the top surface of the deck, install one retaining leg into the the square opening of the deck (Fig. 1).
3. Push a screw driver into the other leg and insert retaining nut into square hole (Fig. 1).

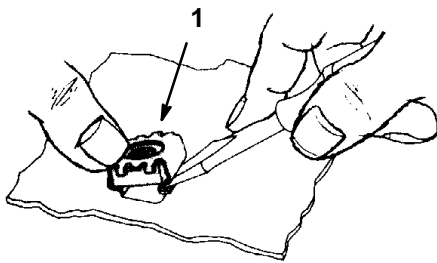

Figure 1

M-4234

1. Retainer Nut

## Connecting Baffles

1. Slide the left and right baffles together and hook together.

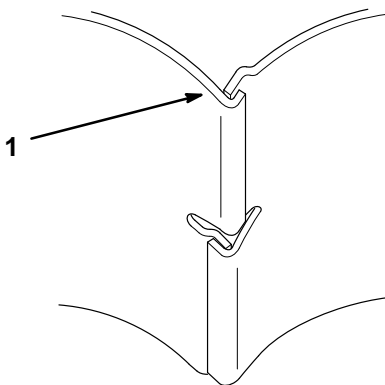

Figure 2

M-4510

1. Baffles hooked together

## Installing Baffles

**Note:** There are two holes that already exist for installing the baffle. (Fig. 3).

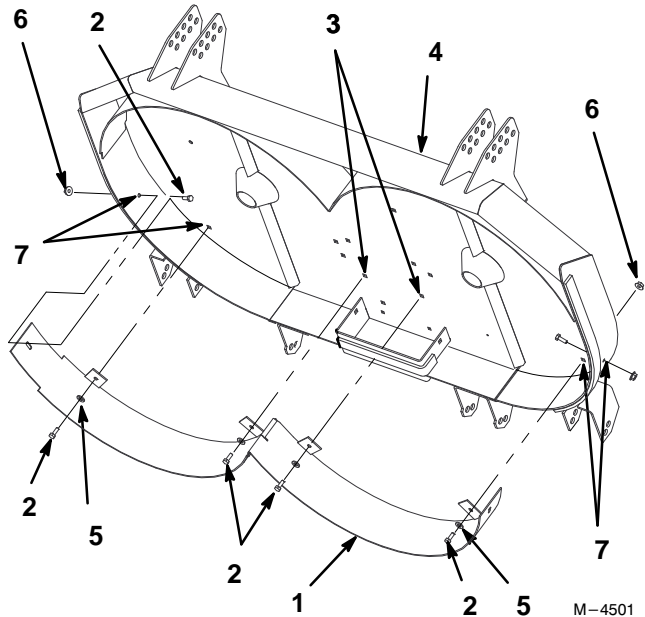

Figure 3

M-4501

- |  |                   |
|--|-------------------|
| 1. Baffles (Assembled)                       | 4. Deck           |
| 2. Bolt                                      | 5. Washer         |
| 3. Retainer nuts installed in existing holes | 6. Lock Nut       |
|  | 7. Holes to drill |

1. Place baffles in the cutting chamber (Fig. 3).

**Note:** When installing bolts, the bolt heads need to be on the inside of cutting deck.

2. Install a bolt with washer into baffle and two existing holes containing retainer nuts (Fig. 3).
3. To determine where you need to drill holes, arrange the baffle in the mower as shown in Figure 4. Rotate the blade to ensure that the clearance between the tip of the blade and the baffle is correct.

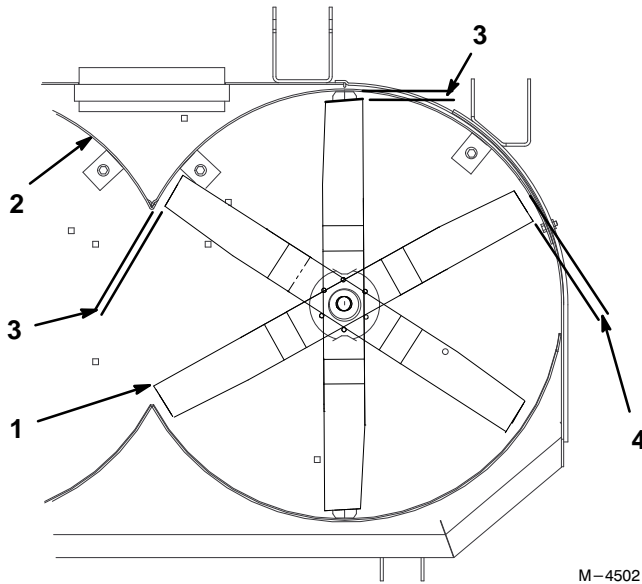

**Figure 4**

- |                             |                   |
|-----------------------------|-------------------|
| 1. Blade (Right-hand Shown) | 3. 1/4" Clearance |
| 2. Baffle                   | 4. 3/8" Clearance |

4. Mark the location of the two holes on the top of deck and the two holes on the side.

**IMPORTANT: Make sure the clearance between blade tip and baffle is correct. Refer to Figure 4.**

5. Drill four 9/32" holes at the marked locations in the mower.
6. Install and tighten all mounting hardware securely (Fig. 3).
7. Rotate all the blades to ensure that there is at least 1/4" and 3/8" clearance between the blades and baffles (Fig. 4).

## **! WARNING**

### **POTENTIAL HAZARD**

- A blade that is bent or damaged could break apart and pieces could be thrown at bystanders or at you as you use the mower.

### **WHAT CAN HAPPEN**

- Pieces of blade that may be thrown could seriously injure or kill you or bystanders.

### **HOW TO AVOID THE HAZARD**

- Always replace bent or damaged blade with a new blade.
- Never file or create sharp notches in the edges or surfaces of blade.

8. Make sure all unused holes in deck are plugged with a nut and bolt for safety.

## **! DANGER**

### **POTENTIAL HAZARD**

- Open holes in the mower expose you and others to thrown debris.

### **WHAT CAN HAPPEN**

- Debris thrown out of holes in the mower can cause injury.

### **HOW TO AVOID THE HAZARD**

- Never operate mower without hardware mounted in all holes in mower.
- Install hardware in mounting holes when mulching baffle is removed.

PROTOTYPE

## Tilting the Mower

The mower can be tilted up for ease of service.

### To Raise Mower

1. Turn engine off, set the parking brake and check that PTO cover is down against deck.
2. Lift on the mower carrier frame to release weight on latch pin and pull out on latch pin to release (Fig. 5). Repeat on the other side. Lower rear of mower onto anti-scalp rollers.
3. Return the pins to the spring loaded (down) position.

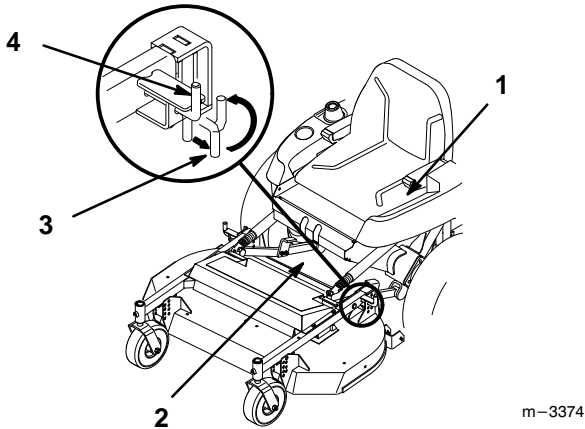

**Figure 5**

- |                  |               |
|------------------|---------------|
| 1. Parking brake | 3. Latch pin  |
| 2. PTO cover     | 4. Notch—open |

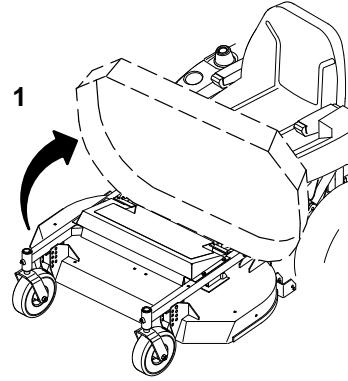

**Figure 6**

1. Mower up
- 

4. Standing in front of the mower, lift up and push rearward on front to raise mower (Fig. 6).
5. Raise mower until it contacts stops and latch pins snap into locked position.

PROTOTYPE