



Recoil Kit

22in Recycler® or Super Recycler® Lawn Mower

Model No. 139-6623

Model No. 139-6624

Installation Instructions

Loose Parts

Use the chart below to verify that all parts have been shipped.

Description	Qty.	Use
No parts required	—	Prepare the machine.
Engine-shroud assembly	1	Install the kit.
Recoil-starter-rope stop	1	

Kit Model 139-6623 includes an engine shroud with a textured finish and kit Model 139-6624 includes an engine shroud with a glossy finish. These kits can be used interchangeably according to your preference.

Preparing the Machine

1. Shut off the engine, wait for all moving parts to stop, and allow the machine to cool before servicing it.
2. Remove the 3 nuts holding the engine-shroud assembly onto the engine and then remove the old engine-shroud assembly.

Note: Retain the nuts for use in Step 1 of [Installing the Shroud Assembly and Rope Stop](#) (page 1).

Installing the Shroud Assembly and Rope Stop

1. Secure the new engine-shroud assembly onto the engine with the previously removed nuts.
2. Install the recoil-starter rope in the rope guide as shown in [Figure 1](#).

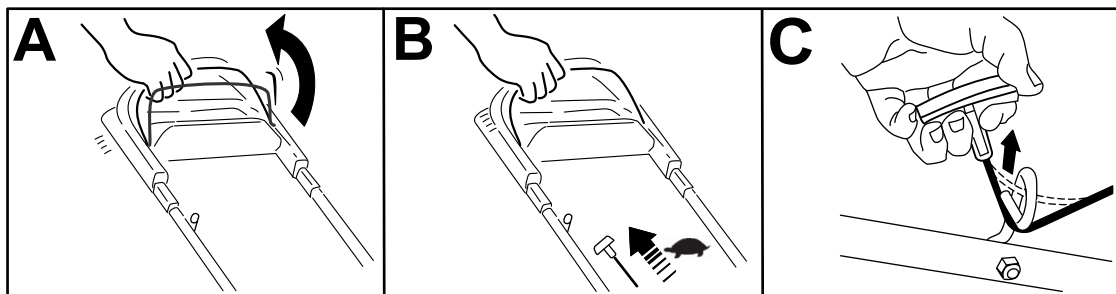

Figure 1

g230719

3. Hold the blade-control bar against the handle.



4. Pull the recoil-starter rope 2.5 cm (3/4 inch) out from the engine shroud (A of [Figure 2](#)).
5. With the rope pulled out, install the recoil-starter-rope stop onto the rope as close to the engine as possible (B of [Figure 2](#)).
6. Secure the recoil-starter-rope stop onto the rope by pinching it with a pliers (C of [Figure 2](#)).

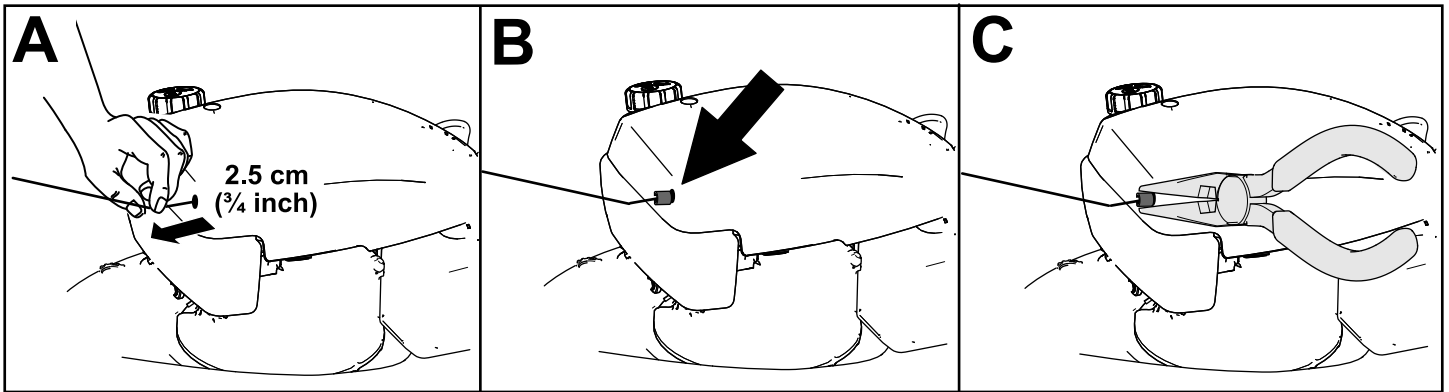

g283560

Figure 2