



Rear Baffle Kit

for 60" OFZ Deck

Part No. 100-2439

**INSTALLATION
INSTRUCTIONS**

Loose Parts

Note: Use the chart below to identify parts for assembly.

DESCRIPTION	QTY.	USE
Baffle	1	Install New Baffle
Screw	1	
Lock Nut	1	

Pre-Installation

WARNING

POTENTIAL HAZARD

- Blade is sharp.

WHAT CAN HAPPEN

- Contact with sharp blade can cause serious personal injury.

HOW TO AVOID THE HAZARD

- Wear gloves or wrap sharp edges of the blade with a rag.

1. Disengage the power take off (PTO), set the parking brake, and turn the ignition key to "OFF" to stop the engine. Remove the key.
2. Tilt up deck and lock into vertical position.
3. Thoroughly clean mower deck. All debris must be removed to ensure baffle will fit properly against mower deck.
4. Repair all bent or damaged areas of mower deck and replace any missing parts.

Removing Existing Wear Plate

1. Remove existing righthand wear plate under deck. Save hardware that is removed (Fig. 1).

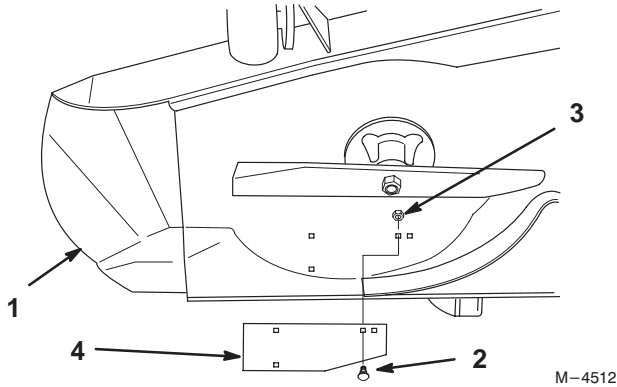

Figure 1

- | | |
|---------|---------------|
| 1. Deck | 3. Nut |
| 2. Bolt | 4. Wear Plate |

Installing New Baffle

Note: Use existing three holes in which wear plate was located.

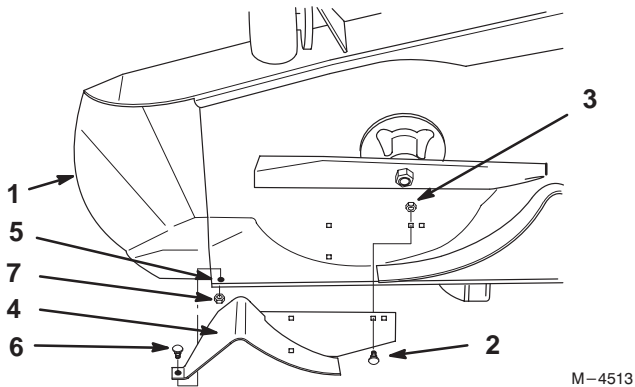

Figure 2

- | | |
|-----------|------------------|
| 1. Deck | 5. Hole to drill |
| 2. Bolt | 6. Screw |
| 3. Nut | 7. Flange Nut |
| 4. Baffle | |

1. Install new baffle into existing wear plate holes (Fig. 2).

Note: When installing bolts, the bolt heads need to be on the inside of cutting deck.

2. Use the baffle as a template to drill a hole in side of deck. Mark location and drill a 11/32 in. hole. (Fig. 2).
3. Install screw and flange nut into deck and baffle. Torque to 200±25 in-lb.
4. Rotate blade to ensure it does not hit baffle.

WARNING

POTENTIAL HAZARD

- A blade that is bent or damaged could break apart and pieces could be thrown at bystanders or at you as you use the mower.

WHAT CAN HAPPEN

- Pieces of blade that may be thrown could seriously injure or kill you or bystanders.

HOW TO AVOID THE HAZARD

- Always replace bent or damaged blade with a new blade.
- Never file or create sharp notches in the edges or surfaces of blade.