



Heated (Only) Cab Kit

2015 and After Groundsmaster® 4000-D Rotary Mower

Model No. 31232—Serial No. 400400001 and Up

Operator's Manual

Safety

This product complies with all relevant European directives. For details, please see the Declaration of Incorporation (DOI) at the back of this publication.

Safety and Instructional Decals



Safety decals and instructions are easily visible to the operator and are located near any area of potential danger. Replace any decal that is damaged or missing.

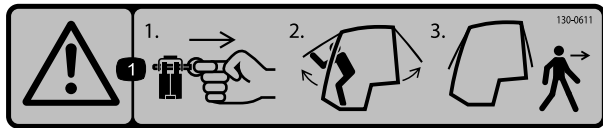

decal130-0611

130-0611

1. 1) Remove the pin. 2) Raise the doors. 3) Exit the cab.

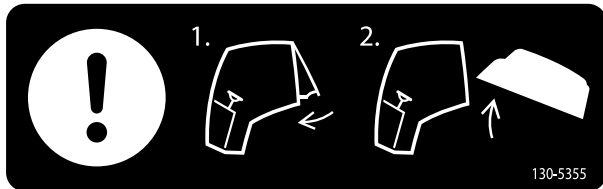

decal130-5355

130-5355

1. Close the rear window. 2. Raise the hood.

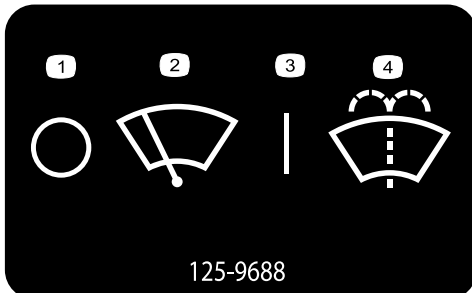

decal125-9688

125-9688

1. Windshield wipers—off
2. Windshield wipers
3. Windshield wipers—on
4. Spray windshield washer fluid

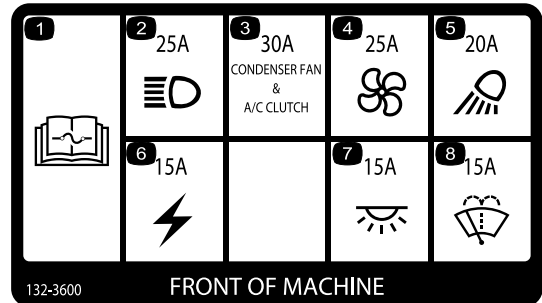

decal132-3600

132-3600

1. Read the *Operator's Manual* for more information on fuses.
2. Headlight—25 A
3. Condenser fan and A/C clutch—30 A
4. Fan—25 A
5. Working light—20 A
6. Auxiliary power—15 A
7. Cab light—15 A
8. Windshield wipers—15 A

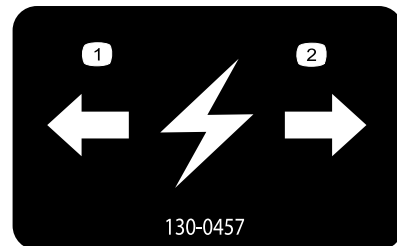

decal130-0457

130-0457

1. Left
2. Right



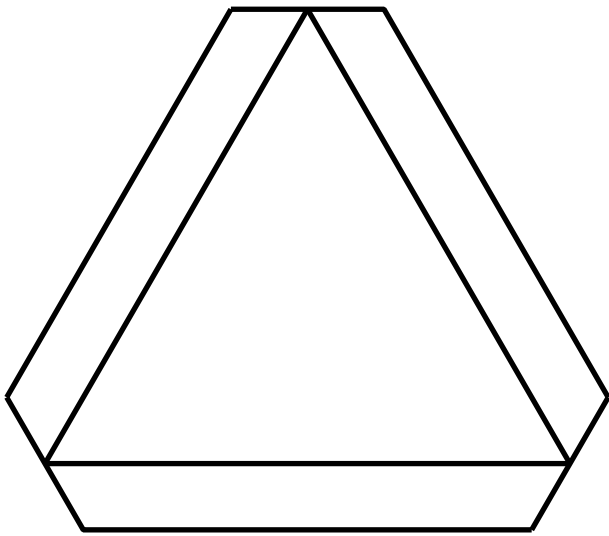

120-0250

decal120-0250

1. Slow-moving vehicle



decal130-5356

130-5356

1. Use the foot pedal to move forward or in reverse.

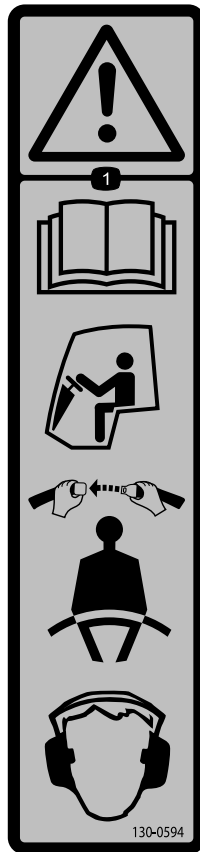

130-0594

decal130-0594

1. Warning—read the *Operator's Manual*; when sitting in the cab, always wear a seat belt; wear hearing protection.

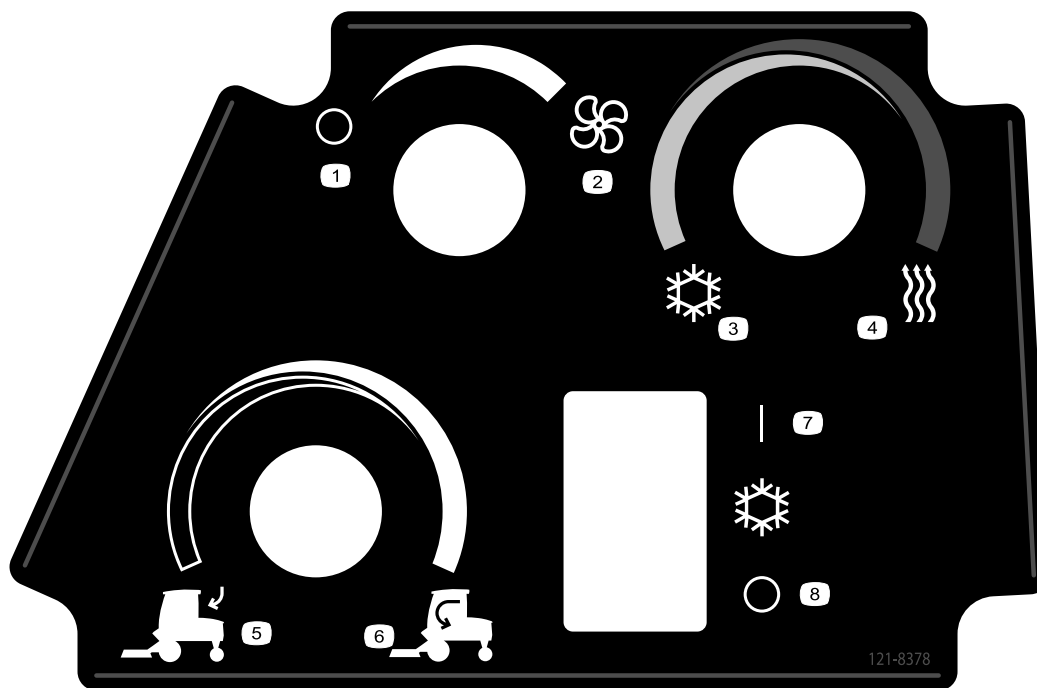

121-8378

decal121-8378

121-8378

- | | | | |
|----------------|-------------|-----------------|--------------------------------------|
| 1. Fan—off | 3. Cold air | 5. External air | 7. Air conditioner—on (If equipped) |
| 2. Fan—on full | 4. Hot air | 6. Internal air | 8. Air conditioner—off (If equipped) |

Setup

Loose Parts

Use the chart below to verify that all parts have been shipped.

Procedure	Description	Qty.	Use
1	No parts required	–	Prepare the machine.
2	Safety decal	1	Apply the safety decal to the rear window.
3	Left foam seal Right foam seal Rear foam seal	1 1 1	Install the foam seals to the cab.
4	Step plate Step support Bolt (3/8 x 3-1/2 inch) Flange nut (3/8 inch)	1 1 2 2	Install the step plate.
5	Left bumper bracket Right bumper bracket Bumper Flange nut (5/16 inch)	1 1 2 2	Install the mower-deck bumper.
6	Front seal Tread foam Rear seal	1 1 1	Install the foam parts.
7	Cab unit Floor tread Straight fittings Hose clamps Side-seal cover Side seal Carriage bolt (3/8 inch) Flange nut (3/8 x 3/4 inch)	1 1 2 2 1 1 1 1	Install the cab to the machine.
8	Washer-fluid tank Tank strap Tank support Carriage bolt (5/16 x 7/8 inch) Flange nut (5/16 inch) Wire harness	1 2 1 6 6 1	Install the washer-fluid bottle.
9	No parts required	–	Connect the wire harness to the machine.
10	No parts required	–	Complete the installation.

1

Preparing the Machine

No Parts Required

Positioning the Machine

1. Clear a location in your workspace under the hoist system.

Note: Verify that your hoist system is capable of safely supporting the cab unit over the machine during the installation.

2. Move the machine to the workspace, lower the mower decks, shut off the engine, set the parking brake, and remove the key from the ignition switch.
3. Allow the engine coolant to cool and then drain the coolant from the machine; refer to the *Service Manual*.

Removing the ROPS

Remove the ROPS from the machine and store it in an appropriate area.

Important: Have an assistant help you remove the ROPS from the machine.

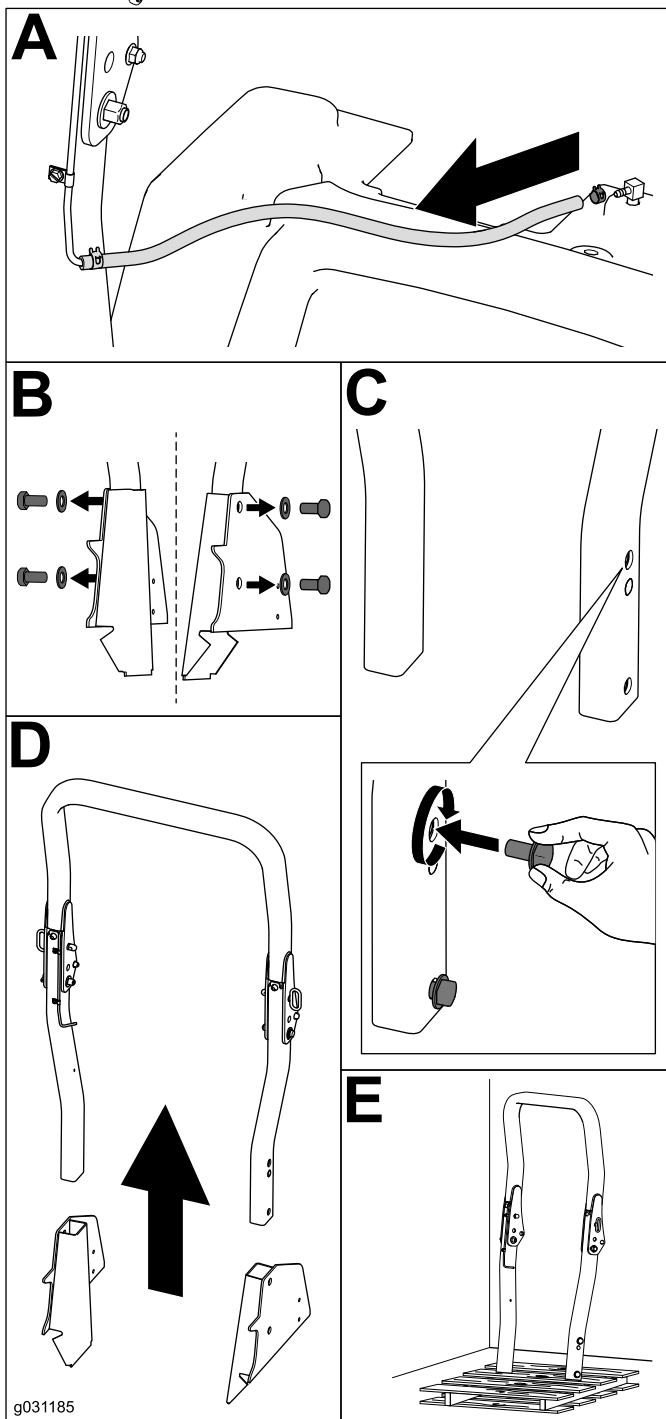
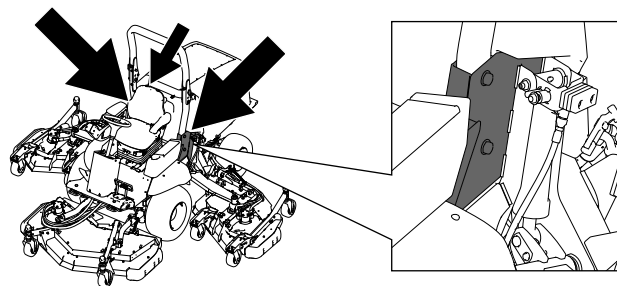

Figure 1

2

Applying the Safety Decal

Parts needed for this procedure:

1	Safety decal
---	--------------

Procedure

Note: Follow this procedure if required by local regulations.

Apply the safety decal to the rear window as shown in [Figure 2](#).

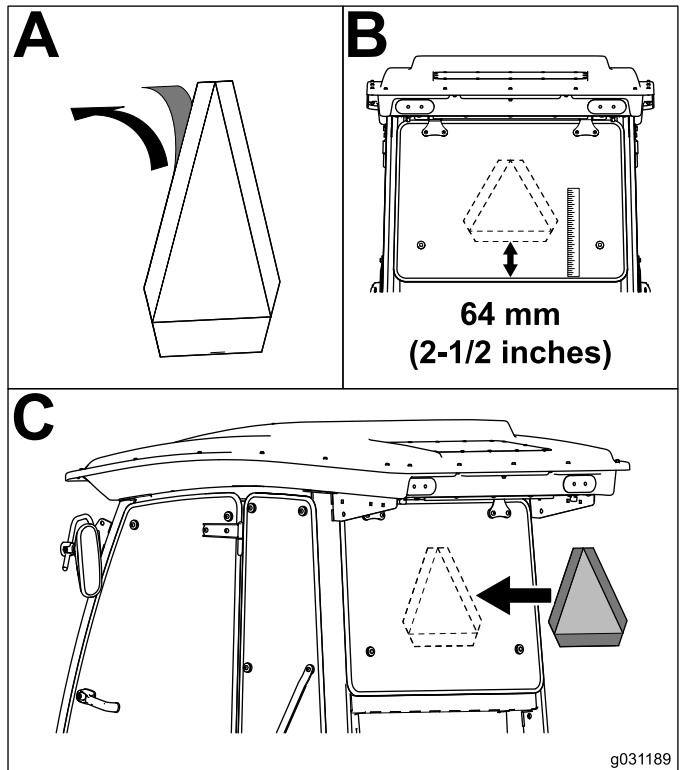
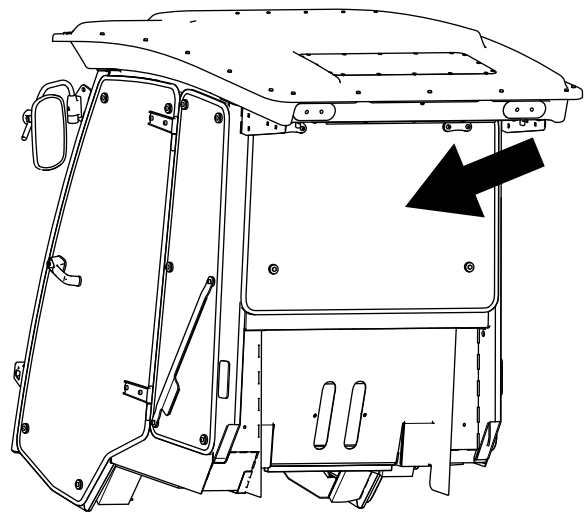

Figure 2

3

Installing the Foam Seals

Parts needed for this procedure:

1	Left foam seal
1	Right foam seal
1	Rear foam seal

Installing the Side Foam Seals

Remove the adhesive backer from the foam seals and apply them to the cab as shown in [Figure 3](#).

Note: Apply all foam seals in this procedure 13 mm (1/2 inch) away from the inside edge of the cab.

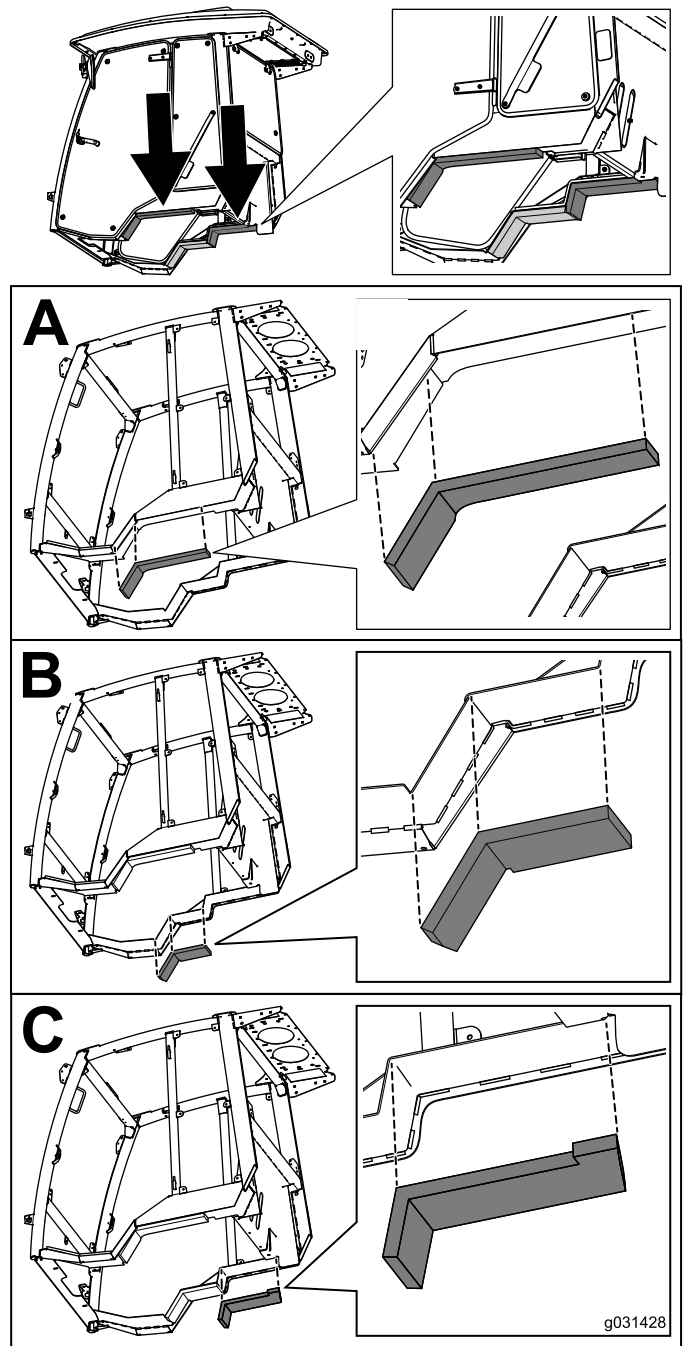

Figure 3

g031428

4

Installing the Step Plate

Parts needed for this procedure:

1	Step plate
1	Step support
2	Bolt (3/8 x 3-1/2 inch)
2	Flange nut (3/8 inch)

Procedure

Remove the step support on the machine and then install the step support included in the cab kit as shown in [Figure 4](#).

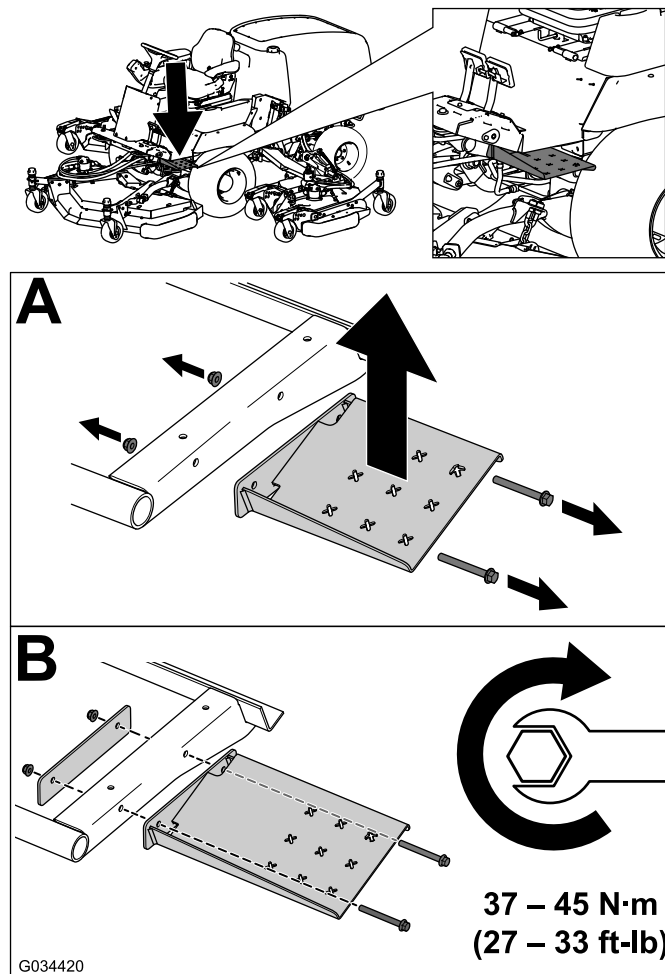

Figure 4

5

Installing the Mower-Deck Bumper

Parts needed for this procedure:

1	Left bumper bracket
1	Right bumper bracket
2	Bumper
2	Flange nut (5/16 inch)

Procedure

Install the bumper assembly to the left and right mower decks as shown in [Figure 5](#).

Note: Use the existing hardware on the mower deck when you install the bumper bracket.

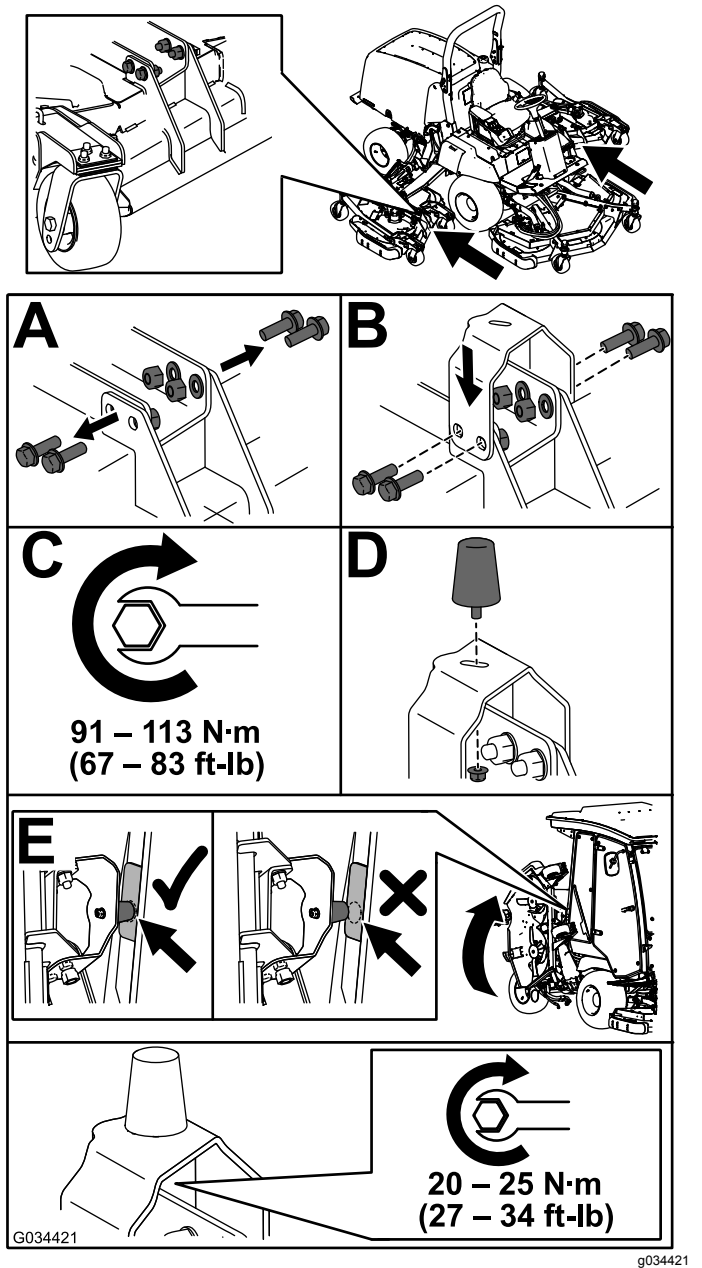

Figure 5

g034421

6

Installing the Foam Parts

Parts needed for this procedure:

1	Front seal
1	Tread foam
1	Rear seal

Installing the Foam Parts onto the Operator Platform

Install the foam parts to the operator platform ([Figure 6](#)).

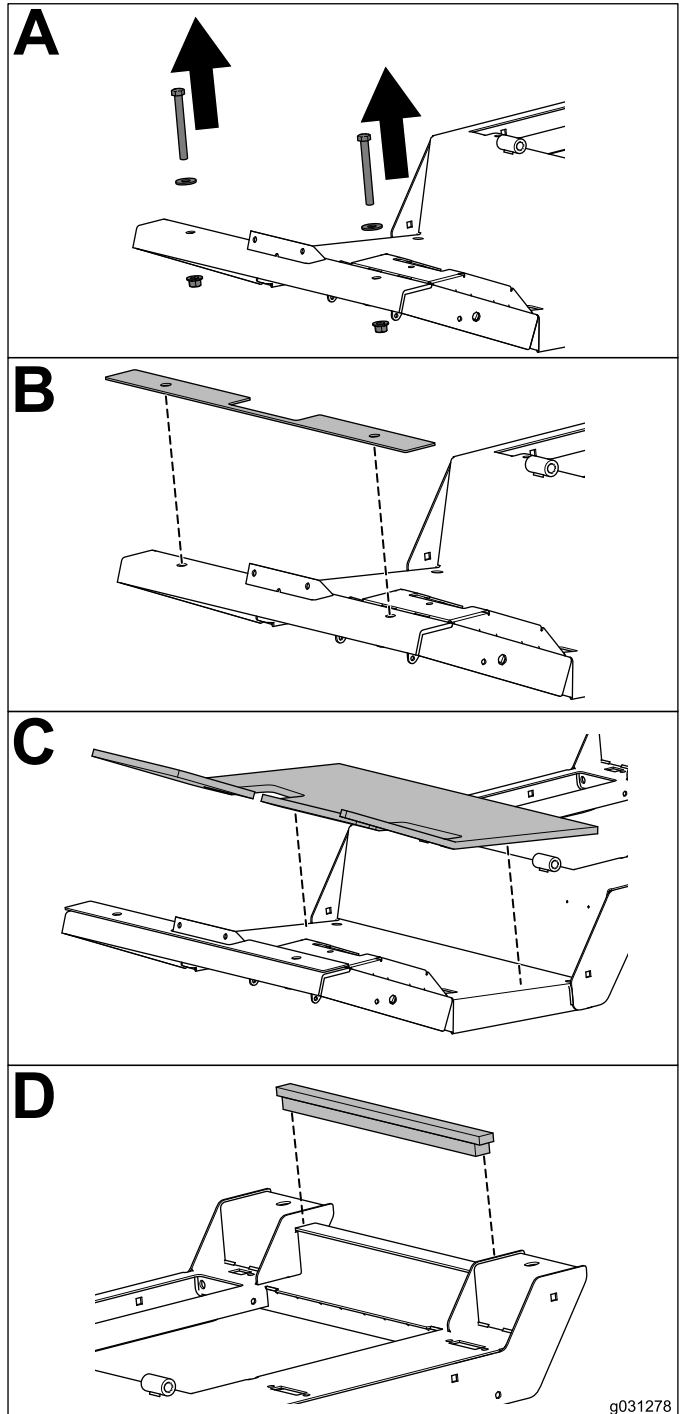
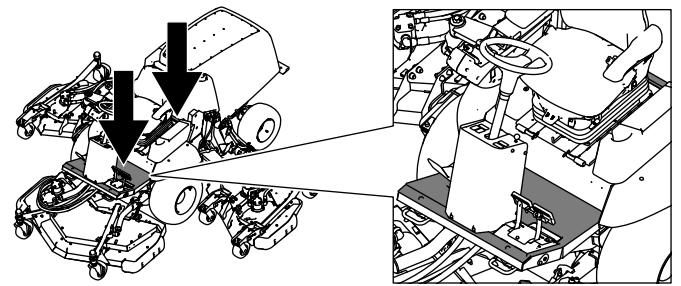

g031278

g031278

Figure 6

7

Installing the Cab Unit

Parts needed for this procedure:

1	Cab unit
1	Floor tread
2	Straight fittings
2	Hose clamps
1	Side-seal cover
1	Side seal
1	Carriage bolt (3/8 inch)
1	Flange nut (3/8 x 3/4 inch)

Connecting to the Lift Points

Use the 4 lift points located on each corner of the cab unit (Figure 7).

Important: Do not allow the lift system to contact the plastic headliner.

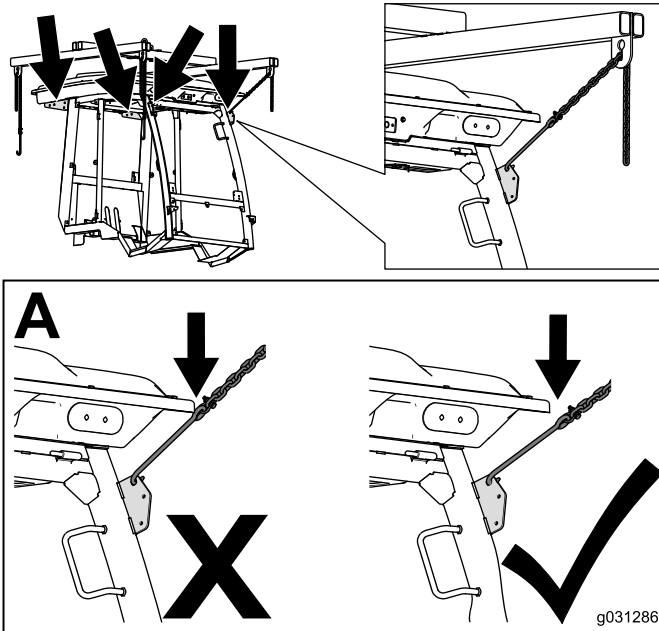

Figure 7

Securing the Cab to the Machine

Use the existing hardware to secure the cab to the machine (Figure 8).

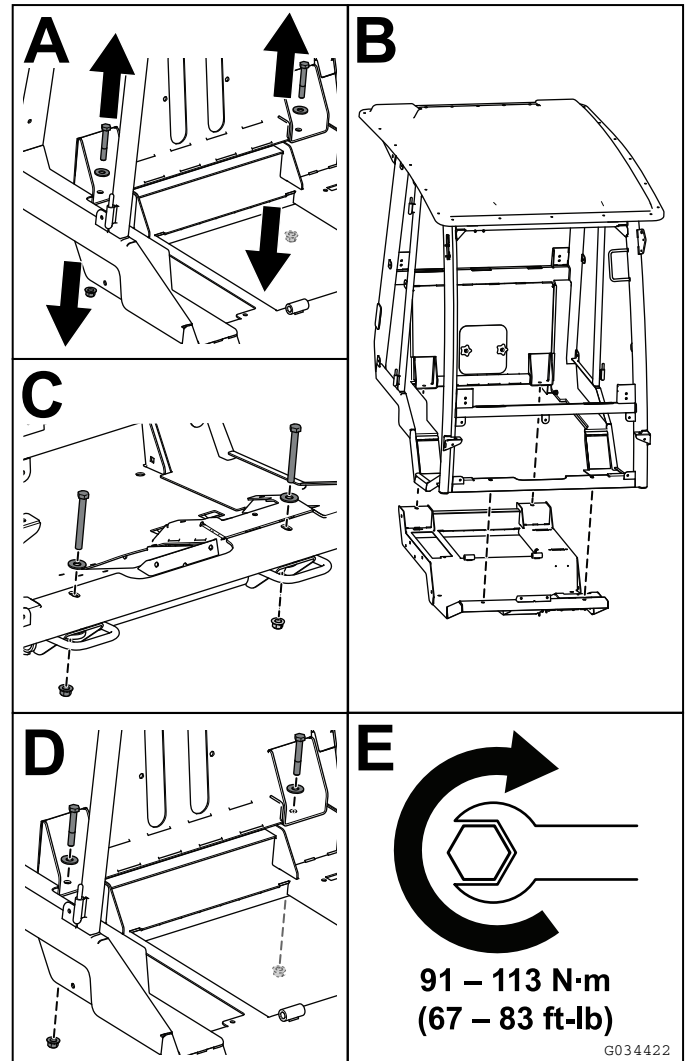
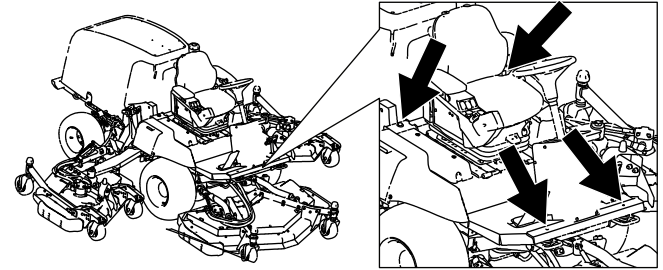

Figure 8

Installing the Floor Tread

Install the floor tread onto the operator platform (Figure 9).

Note: Ensure that you apply the adhesive strip to a clean surface with enough pressure to adhere the strip to the platform.

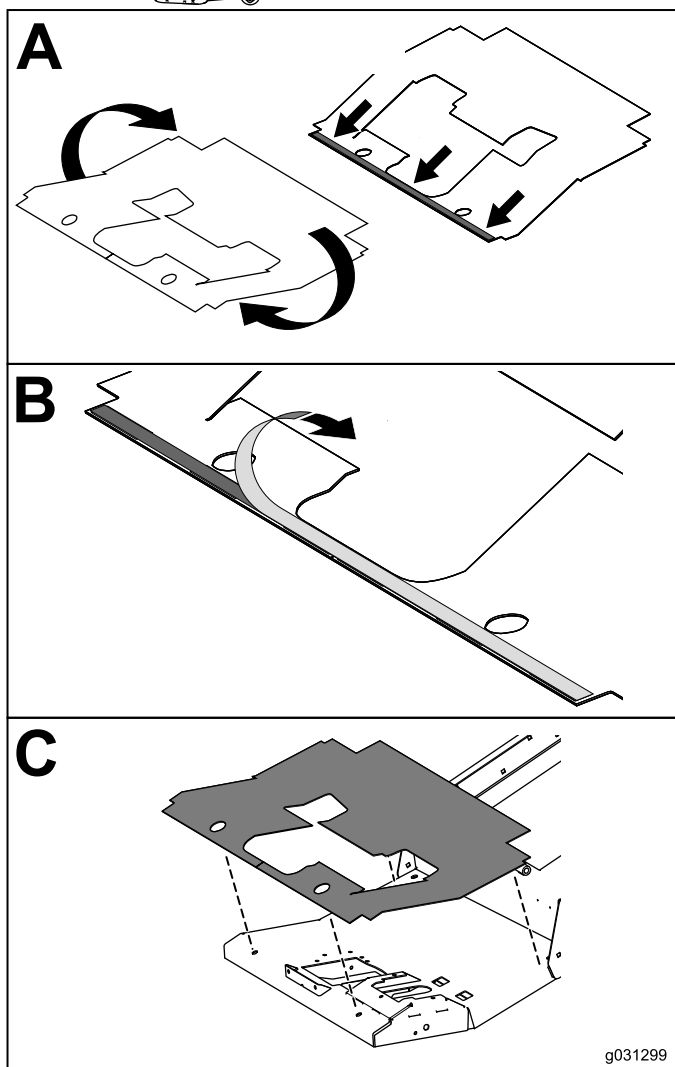
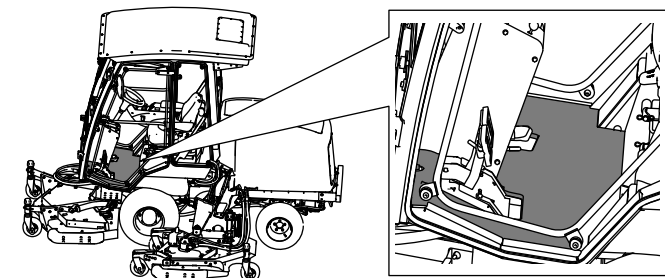

Figure 9

Install the Heater-Hose Fittings

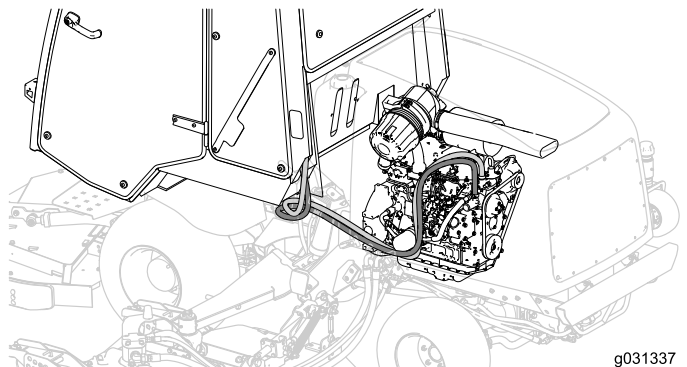
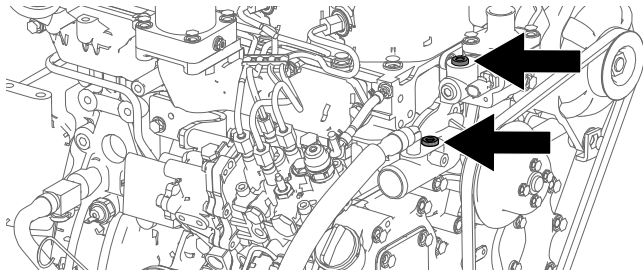

Figure 10

Drain the coolant from the engine; refer to the *Operator's manual*.

Important: Allow the engine to cool and drain the coolant before performing the following procedure.



Routing the Heater Hoses

Route the heater hoses underneath the machine and into the engine compartment (Figure 12).

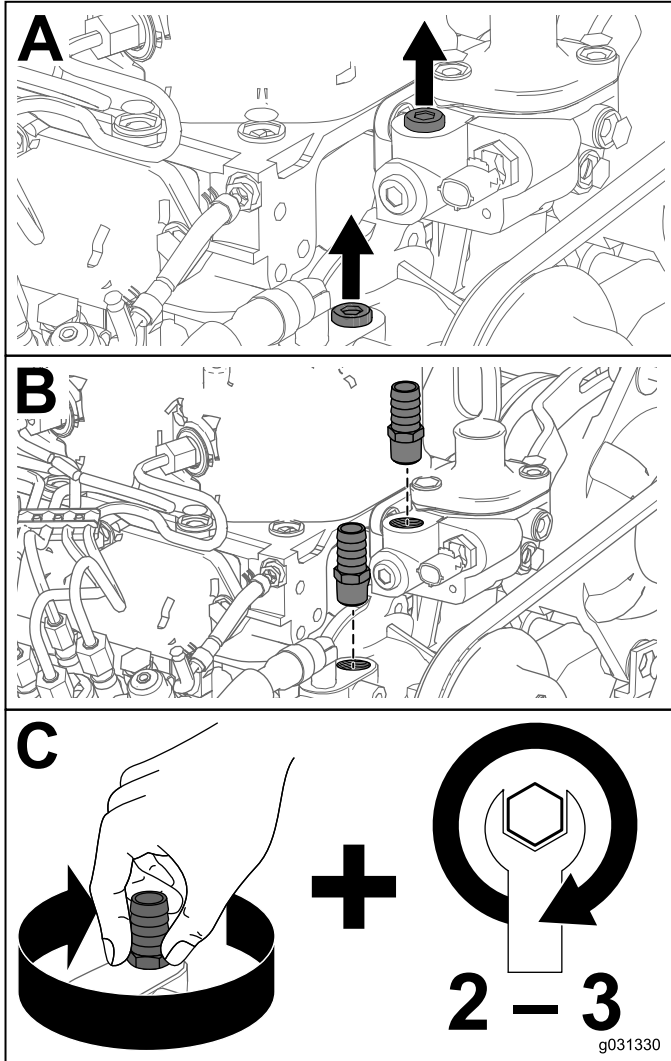

Figure 11

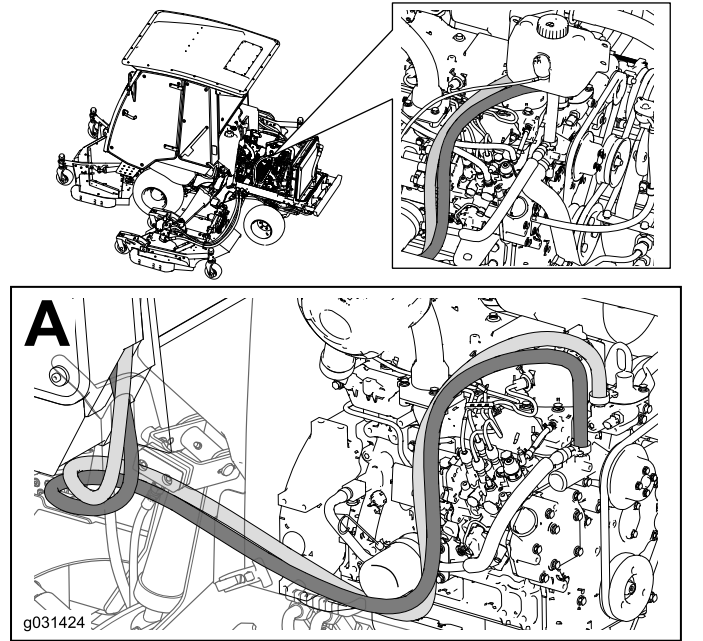

Figure 12

Important: Do not secure the hoses to hot or moving parts.

Note: Store the engine plugs with the ROPS assembly to use when you remove the cab.

Connecting the Heater Hoses

Connect the heater hoses to the hose fittings.

Note: Connect the heater hose containing the red plug to the supply port and the heater hose containing the green plug to the return port on the engine as shown in [Figure 13](#).

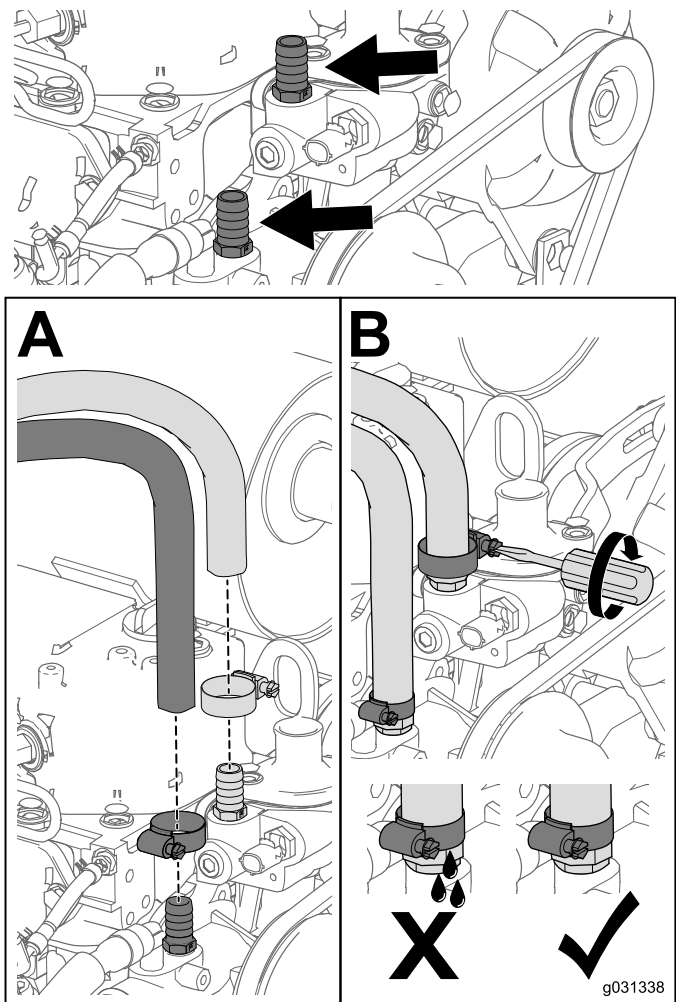

Figure 13

Connecting the Vent Hose

Use the existing hardware to connect the vent tube from the cab ([Figure 14](#)).

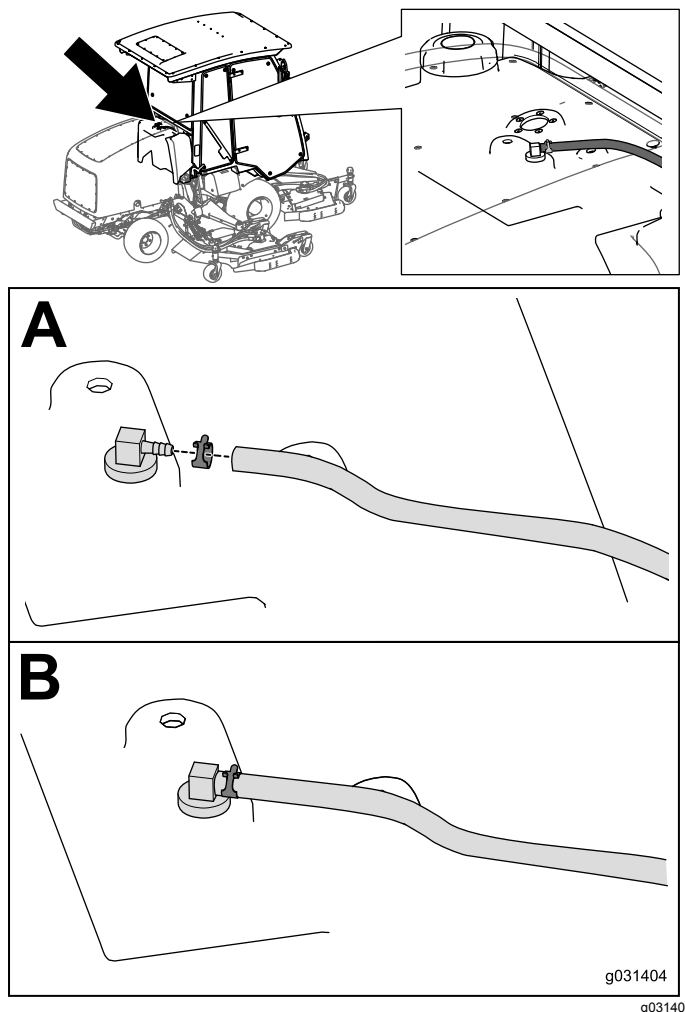

Figure 14

Note: Store the hose plugs with the ROPS assembly to use when you remove the cab.

Installing the Side Seal

Install the side seal to the cab ([Figure 15](#)).

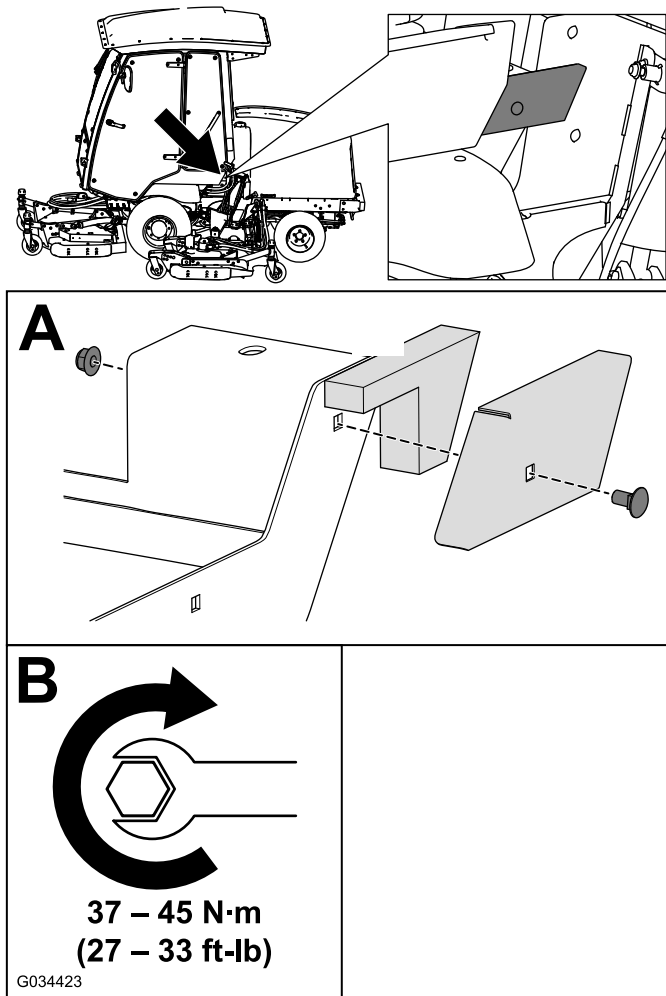

Figure 15

g034423

8

Installing the Washer-Fluid Tank

Parts needed for this procedure:

1	Washer-fluid tank
2	Tank strap
1	Tank support
6	Carriage bolt (5/16 x 7/8 inch)
6	Flange nut (5/16 inch)
1	Wire harness

Installing the Tank

Install washer-fluid tank to the machine (Figure 16).

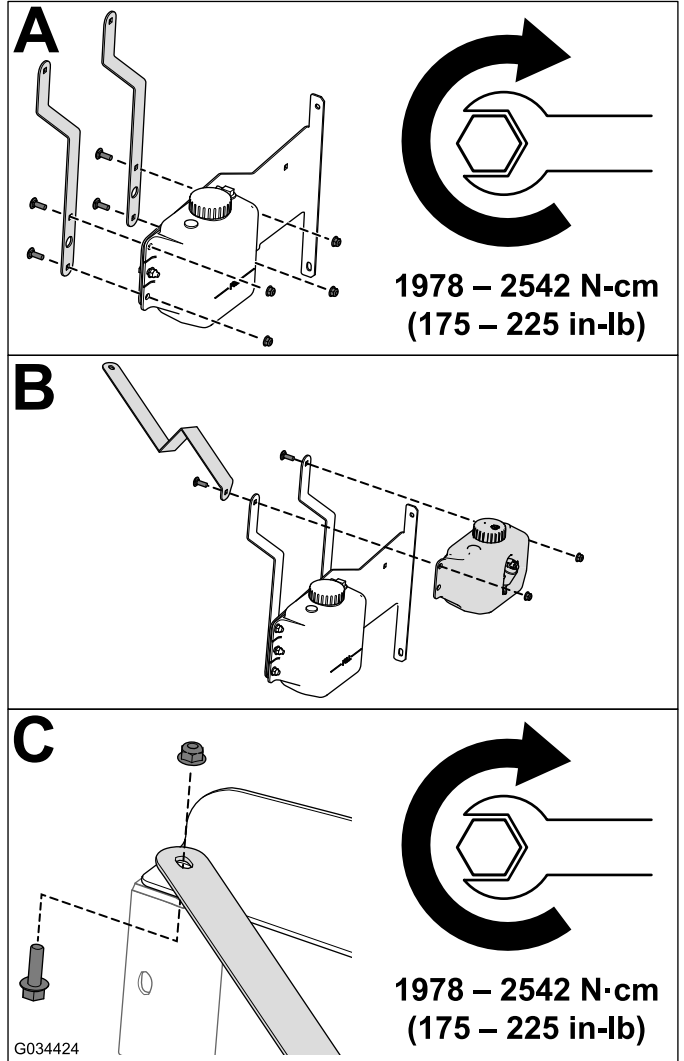
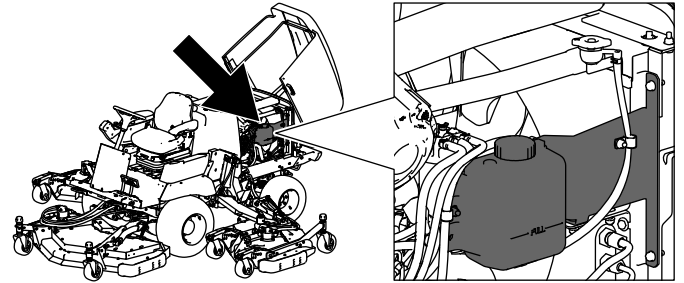

Figure 16

Note: Use the existing hardware when you secure the tank support to the machine.

Routing and Connecting the Hose

Route the washer-fluid hose through the R-clamp under the machine and toward the back of the machine (Figure 17).

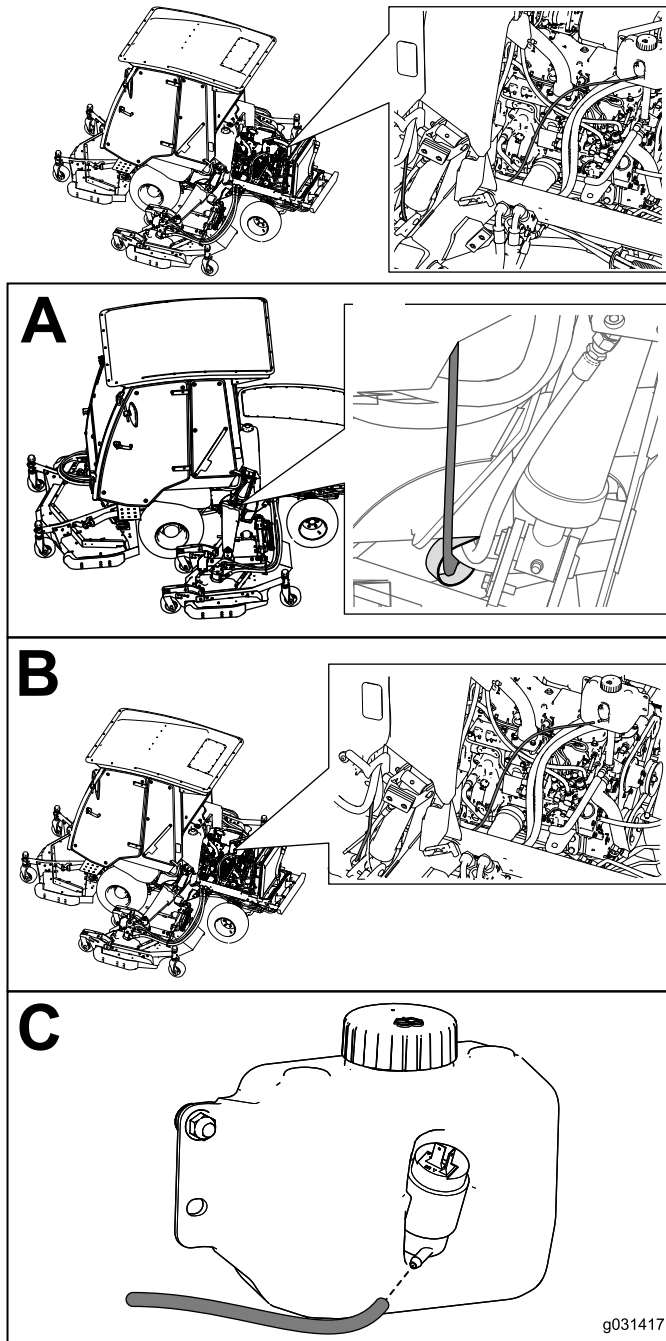

Figure 17

Connecting the Wire Harness

Connect the wire harness for the washer-fluid bottle (Figure 18).

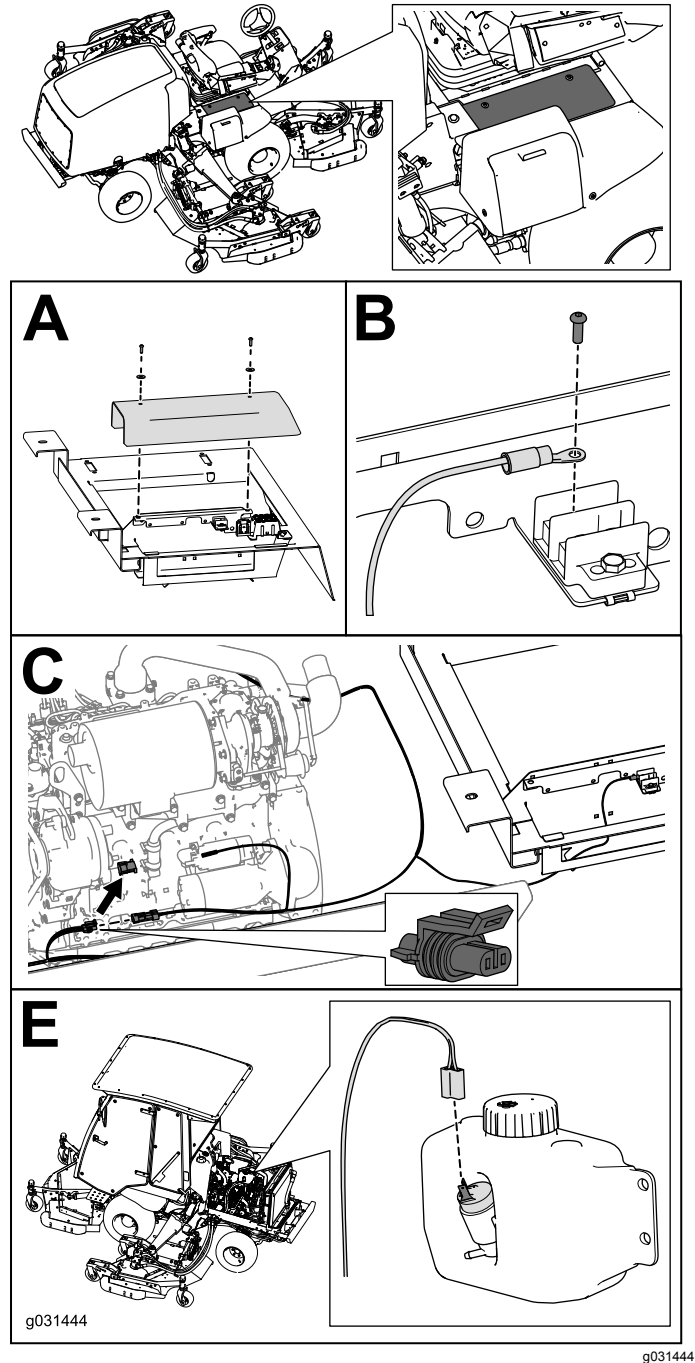

Figure 18

Important: Do not secure the hoses to the hot or moving parts.

9

Connecting the Wire Harness

No Parts Required

Procedure

Locate the wire harness under the machine frame and connect it to the wire harness on the cab (Figure 19).

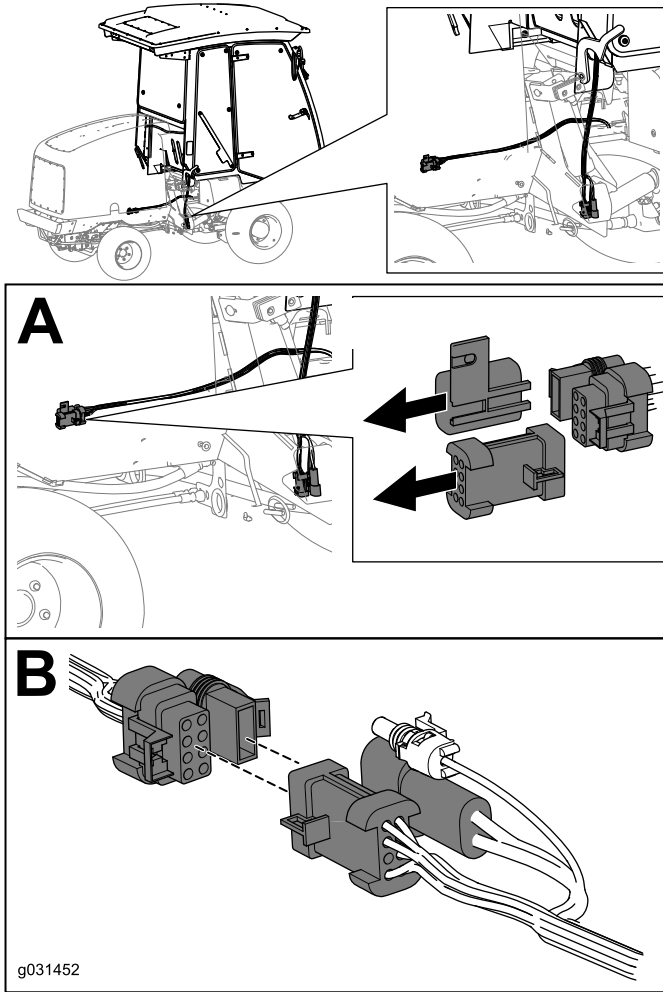

Figure 19

Note: Use cable ties to secure the wire harness into place.

Important: Do not secure the hoses to the hot or moving parts.

10

Completing the Installation

No Parts Required

Procedure

1. Add coolant to the machine; refer to the *Service Manual*
2. Check for leaks.
3. Route the drain hoses through the R-clamps on each side of the machine.
4. Check for parts that interfere with moving parts and make corrections before operating the machine.
5. Check the operation of all controls before operating the machine.
6. Use an assistant to adjust the rearview and side mirrors before operating the machine.
7. Remove the chocks from the wheels.

Product Overview

Controls

Cab Controls

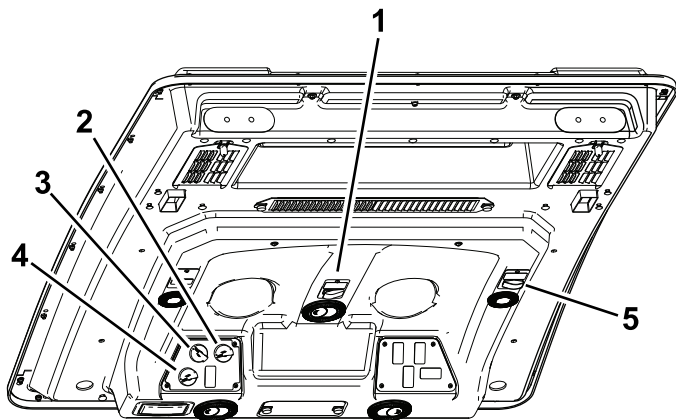

g030398
g030398

Figure 20

- | | |
|----------------------------|------------------------------|
| 1. Windshield-wiper switch | 4. Air-recirculation control |
| 2. Temperature control | 5. Power outlet |
| 3. Fan control | |

Windshield-Wiper Switch

Use this switch to turn the windshield wipers on or off (Figure 20).

Temperature Control

Rotate the temperature-control knob to regulate the air temperature in the cab (Figure 20).

Fan Control

Rotate the fan-control knob to regulate the speed of the fan (Figure 20).

Air Recirculation Control

Sets the cab to either recirculate the air in the cabin or to draw air into the cabin from outside (Figure 20).

Windshield Latch

Lift up the latches to open the windshield (Figure 21). Press the latch in to lock windshield to the open position. Pull out and down on the latch to close and secure the windshield.

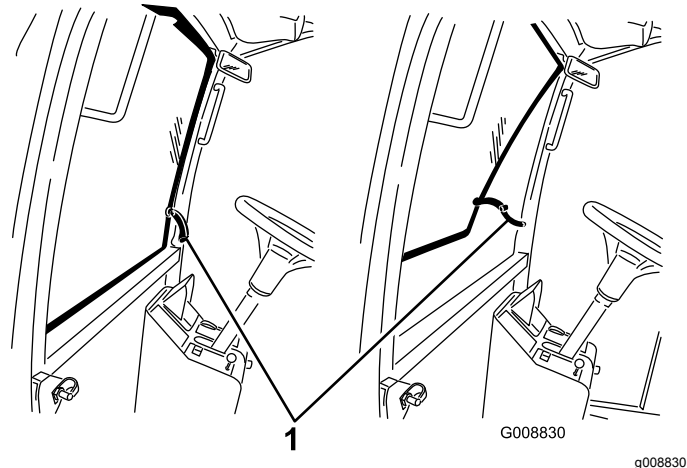

Figure 21

1. Windshield latch

Rear-Window Latch

Lift up on the latches to open the rear window. Pull the latch up and out to lock the window in the open position. Pull the latch out and down to close and secure the window (Figure 21).

Important: Close the rear window before you open the hood to prevent any damage.

Maintenance

Recommended Maintenance Schedule(s)

Maintenance Service Interval	Maintenance Procedure
After the first 250 hours	• Clean the cab air filters (replace them if they are torn or excessively dirty).

Cleaning the Air Filter

⚠ CAUTION

If you leave the key in the ignition switch, someone could accidentally start the engine and seriously injure you or other bystanders.

Remove the key from the ignition before you do any maintenance.

Cleaning the Air Filters

Service Interval: After the first 250 hours (replace them if they are torn or excessively dirty).

1. Remove the thumb screws and the grates from both the in-cab and rear-cab air filters (Figure 22).

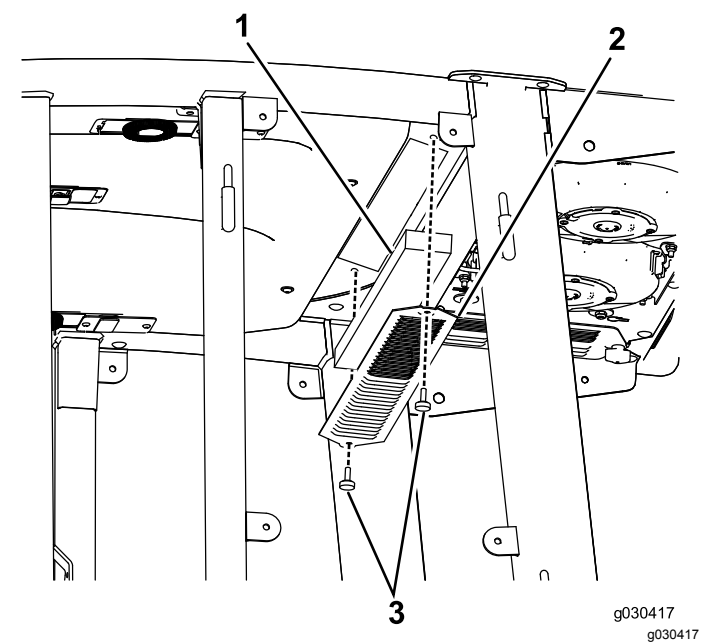

Figure 22

1. Filter
2. Grate
3. Thumb screw

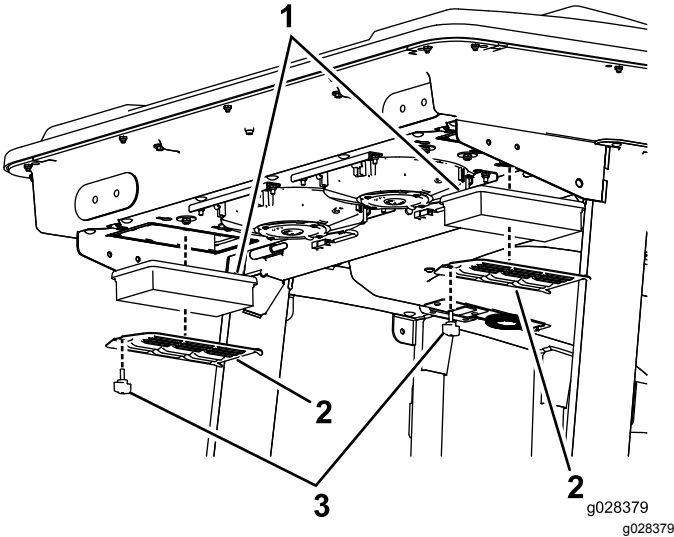

Figure 23

1. Filters
2. Grate
3. Thumb screw

2. Clean the filters by blowing clean, oil-free, compressed air through them.
Important: If either filter has a hole, tear, or other damage, replace it.
3. Install the filters and grate, securing them with the thumb screws.

Cleaning the Cab

Important: Use care around the cab seals and lights (Figure 24). If you are using a pressure washer, keep the washer wand at least 0.6 m (2 ft) away from the machine. Do not use the pressure washer directly on the cab seals and lights or under the rear overhang.

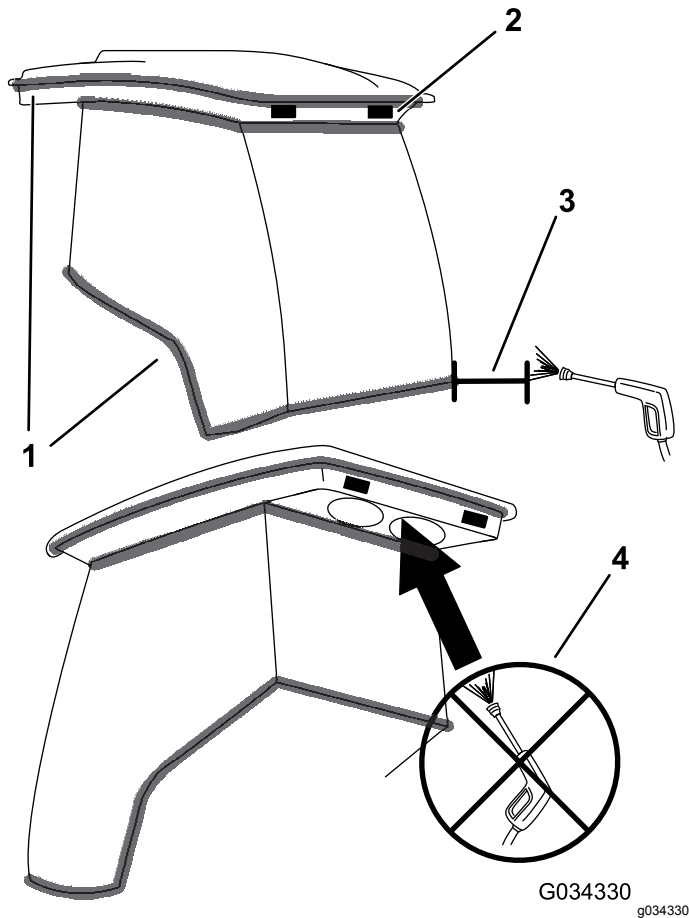

Figure 24

- | | |
|----------|--|
| 1. Seal | 3. Keep wand 0.6 m (2 ft) away. |
| 2. Light | 4. Do not pressure-wash under the rear overhang. |

Storage

Remove the cab unit for storage during the warmer months.

Preparing the Machine for Cab Removal

1. Move the machine underneath the cab hoist, shut the engine off, and remove the key from the ignition.
2. Chock the wheels to prevent the machine from moving during the installation.
3. Allow the engine to cool before you start the procedure.
4. Drain the engine coolant.

Removing the Cab

1. Connect the cab hoist to the 4 lift points on the cab (Figure 7).
2. Disconnect the heater hoses, install the appropriate dust cover into the hose ends, and install the engine plugs to the ports (Figure 11) and (Figure 13).
3. Remove the bolts, the washers, and the locknuts securing the cab to the machine (Figure 8).

Note: Return the all of the hardware you removed to the original mounting location in the order that it is used to secure the cab to the machine. This will prevent losing the mounting hardware and simplify installation.

4. Raise the cab to a height that will allow you to safely move the machine away from the cab.
5. Move the machine away from the cab.
6. Lower the cab onto a carrier to allow you to move it to a storage location.

Note: Secure the wiring harness and hoses to prevent damage when lowered or stored. Cover the cab to prevent dust and debris from accumulating on it during storage.

7. Install the ROPS to the machine before operating the machine.

Declaration of Incorporation

Model No.	Serial No.	Product Description	Invoice Description	General Description	Directive
31231	316000001 and Up	Heated (Only) Cab Kit, 2015 and After Groundsmaster 4100-D Rotary Mower	GM4100 T4 REMOVABLE HEATED CAB	Utility Vehicle	2006/42/EC
31232	316000001 and Up	Heated (Only) Cab Kit, 2015 and After Groundsmaster 4000-D Rotary Mower	GM4000 T4 REMOVABLE HEATED CAB	Utility Vehicle	2006/42/EC

Relevant technical documentation has been compiled as required per Part B of Annex VII of 2006/42/EC.

We will undertake to transmit, in response to requests by national authorities, relevant information on this partly completed machinery. The method of transmission shall be electronic transmittal.

This machinery shall not be put into service until incorporated into approved Toro models as indicated on the associated Declaration of Conformity and in accordance with all instructions, whereby it can be declared in conformity with all relevant Directives.

Certified:



John Heckel
Sr. Engineering Manager
8111 Lyndale Ave. South
Bloomington, MN 55420, USA
March 14, 2019

Authorized Representative:

Marcel Dutrieux
Manager European Product Integrity
Toro Europe NV
Nijverheidsstraat 5
2260 Oevel
Belgium

EEA/UK Privacy Notice

Toro's Use of Your Personal Information

The Toro Company ("Toro") respects your privacy. When you purchase our products, we may collect certain personal information about you, either directly from you or through your local Toro company or dealer. Toro uses this information to fulfil contractual obligations - such as to register your warranty, process your warranty claim or to contact you in the event of a product recall - and for legitimate business purposes - such as to gauge customer satisfaction, improve our products or provide you with product information which may be of interest. Toro may share your information with our subsidiaries, affiliates, dealers or other business partners in connection these activities. We may also disclose personal information when required by law or in connection with the sale, purchase or merger of a business. We will never sell your personal information to any other company for marketing purposes.

Retention of your Personal Information

Toro will keep your personal information as long as it is relevant for the above purposes and in accordance with legal requirements. For more information about applicable retention periods please contact legal@toro.com.

Toro's Commitment to Security

Your personal information may be processed in the US or another country which may have less strict data protection laws than your country of residence. Whenever we transfer your information outside of your country of residence, we will take legally required steps to ensure that appropriate safeguards are in place to protect your information and to make sure it is treated securely.

Access and Correction

You may have the right to correct or review your personal data, or object to or restrict the processing of your data. To do so, please contact us by email at legal@toro.com. If you have concerns about the way in which Toro has handled your information, we encourage you to raise this directly with us. Please note that European residents have the right to complain to your Data Protection Authority.



The Toro Warranty

Two-Year or 1,500 Hours Limited Warranty

Conditions and Products Covered

The Toro Company and its affiliate, Toro Warranty Company, pursuant to an agreement between them, jointly warrant your Toro Commercial product ("Product") to be free from defects in materials or workmanship for 2 years or 1,500 operational hours*, whichever occurs first. This warranty is applicable to all products with the exception of Aerators (refer to separate warranty statements for these products). Where a warrantable condition exists, we will repair the Product at no cost to you including diagnostics, labor, parts, and transportation. This warranty begins on the date the Product is delivered to the original retail purchaser.

* Product equipped with an hour meter.

Instructions for Obtaining Warranty Service

You are responsible for notifying the Commercial Products Distributor or Authorized Commercial Products Dealer from whom you purchased the Product as soon as you believe a warrantable condition exists. If you need help locating a Commercial Products Distributor or Authorized Dealer, or if you have questions regarding your warranty rights or responsibilities, you may contact us at:

Toro Commercial Products Service Department
Toro Warranty Company
8111 Lyndale Avenue South
Bloomington, MN 55420-1196

952-888-8801 or 800-952-2740
E-mail: commercial.warranty@toro.com

Owner Responsibilities

As the product owner, you are responsible for required maintenance and adjustments stated in your *Operator's Manual*. Repairs for product issues caused by failure to perform required maintenance and adjustments are not covered under this warranty.

Items and Conditions Not Covered

Not all product failures or malfunctions that occur during the warranty period are defects in materials or workmanship. This warranty does not cover the following:

- Product failures which result from the use of non-Toro replacement parts, or from installation and use of add-on, or modified non-Toro branded accessories and products.
- Product failures which result from failure to perform recommended maintenance and/or adjustments.
- Product failures which result from operating the Product in an abusive, negligent, or reckless manner.
- Parts consumed through use that are not defective. Examples of parts which are consumed, or used up, during normal Product operation include, but are not limited to, brake pads and linings, clutch linings, blades, reels, rollers and bearings (sealed or greasable), bed knives, spark plugs, castor wheels and bearings, tires, filters, belts, and certain sprayer components such as diaphragms, nozzles, and check valves.
- Failures caused by outside influence, including, but not limited to, weather, storage practices, contamination, use of unapproved fuels, coolants, lubricants, additives, fertilizers, water, or chemicals.
- Failure or performance issues due to the use of fuels (e.g. gasoline, diesel, or biodiesel) that do not conform to their respective industry standards.
- Normal noise, vibration, wear and tear, and deterioration. Normal "wear and tear" includes, but is not limited to, damage to seats due to wear or abrasion, worn painted surfaces, scratched decals or windows.

Countries Other than the United States or Canada

Customers who have purchased Toro products exported from the United States or Canada should contact their Toro Distributor (Dealer) to obtain guarantee policies for your country, province, or state. If for any reason you are dissatisfied with your Distributor's service or have difficulty obtaining guarantee information, contact your Authorized Toro Service Center.

Parts

Parts scheduled for replacement as required maintenance are warranted for the period of time up to the scheduled replacement time for that part. Parts replaced under this warranty are covered for the duration of the original product warranty and become the property of Toro. Toro will make the final decision whether to repair any existing part or assembly or replace it. Toro may use remanufactured parts for warranty repairs.

Deep Cycle and Lithium-Ion Battery Warranty

Deep cycle and Lithium-Ion batteries have a specified total number of kilowatt-hours they can deliver during their lifetime. Operating, recharging, and maintenance techniques can extend or reduce total battery life. As the batteries in this product are consumed, the amount of useful work between charging intervals will slowly decrease until the battery is completely worn out. Replacement of worn out batteries, due to normal consumption, is the responsibility of the product owner. Note: (Lithium-Ion battery only): Pro-rated after 2 years. Refer to the battery warranty for additional information.

Lifetime Crankshaft Warranty (ProStripe 02657 Model Only)

The ProStripe which is fitted with a genuine Toro Friction Disc and Crank-Safe Blade Brake Clutch (integrated Blade Brake Clutch (BBC) + Friction Disc assembly) as original equipment and used by the original purchaser in accordance with recommended operating and maintenance procedures, are covered by a Lifetime Warranty against engine crankshaft bending. Machines fitted with friction washers, Blade Brake Clutch (BBC) units and other such devices are not covered by the Lifetime Crankshaft Warranty.

Maintenance is at Owner's Expense

Engine tune-up, lubrication, cleaning and polishing, replacement of filters, coolant, and completing recommended maintenance are some of the normal services Toro products require that are at the owner's expense.

General Conditions

Repair by an Authorized Toro Distributor or Dealer is your sole remedy under this warranty.

Neither The Toro Company nor Toro Warranty Company is liable for indirect, incidental or consequential damages in connection with the use of the Toro Products covered by this warranty, including any cost or expense of providing substitute equipment or service during reasonable periods of malfunction or non-use pending completion of repairs under this warranty. Except for the Emissions warranty referenced below, if applicable, there is no other express warranty. All implied warranties of merchantability and fitness for use are limited to the duration of this express warranty.

Some states do not allow exclusions of incidental or consequential damages, or limitations on how long an implied warranty lasts, so the above exclusions and limitations may not apply to you. This warranty gives you specific legal rights, and you may also have other rights which vary from state to state.

Note Regarding Emissions Warranty

The Emissions Control System on your Product may be covered by a separate warranty meeting requirements established by the U.S. Environmental Protection Agency (EPA) and/or the California Air Resources Board (CARB). The hour limitations set forth above do not apply to the Emissions Control System Warranty. Refer to the Engine Emission Control Warranty Statement supplied with your product or contained in the engine manufacturer's documentation.