



Mulching Kit

GrandStand® Mower With 91cm Rear Discharge TURBO FORCE® Cutting Unit

Model No. 134-3217

Installation Instructions

Safety

Rear Discharge or Mulch Grass

⚠ WARNING

Without the grass guard mounted in place, you and others are exposed to blade contact and thrown debris. Contact with rotating mower blade(s) and thrown debris will cause injury or death.

- Never remove the grass guard from the mower because the grass guard routes material down toward the turf. If the grass guard is ever damaged, replace it immediately.
- Never put your hands or feet under the mower.
- Never try to clear the discharge area or mower blades unless you engage the parking brake, disengage the power take off (PTO) lever, shutoff the engine, remove the ignition key, and wait for all motion to stop. Also pull the wire off the spark plug(s).

Ensure that the mower has the rear grass guard to disperses clippings to the rearward and down toward the turf, while in rear discharge mode.

To mulch grass clippings, install the baffles on the mower deck as instructed in the following procedures.



Installation

Loose Parts

Use the chart below to verify that all parts have been shipped.

Procedure	Description	Qty.	Use
1	No parts required	–	Prepare the mower.
2	No parts required	–	Remove the existing blades.
3	No parts required	–	Drill the mower deck.
4	Left baffle (3 holes) Right baffle (4 holes) Carriage bolt (3/8 x 1 inch) Flange locknut (3/8 inch)	1 1 6 6	Install the baffles.
5	Kicker fitting Carriage bolt (3/8 x 1 inch) Flange locknut (3/8 inch)	2 4 4	Install the kicker fittings.
6	Recycler blades (sold separately)	2	Install the recycler blades.
7	Flange-head capscrews	6	Convert the deck for rear-discharge operation.

Note: Recycler blades (sold separately) are required to install this kit; refer to the *Parts Catalog* for your machine.

1

Preparing the Mower

No Parts Required

Procedure

Note: Determine the left and right sides of the machine from the normal operating position.

1. Park the machine on a level surface; disengage the cutting unit(s) and lower the cutting unit; engage the parking brake; shut off the engine and remove the key; and wait for all movement to stop.
2. Thoroughly clean the mower deck. Remove all debris to ensure that the baffles fit properly against the mower deck.
3. Repair all bent or damaged areas of the mower deck and replace any missing or damaged parts.

2

Removing the Existing Blades

No Parts Required

Procedure

1. Lift the machine so that you can access the bottom of the mower deck.
2. Remove the existing blades from the spindles; refer to the *Operator's Manual* for your machine.

Note: Save the blades for use when cutting grass in rear discharge mode.

You will use the blade bolt and washer for installing the recycler blades in [6 Installing the Recycler Blades \(page 6\)](#).

3

Drilling the Mower Deck

No Parts Required

Procedure

1. At the left side of the mower deck, drill the 4 pilot holes in the deck with a 10 mm (3/8 inch) drill bit as shown in [Figure 1](#).

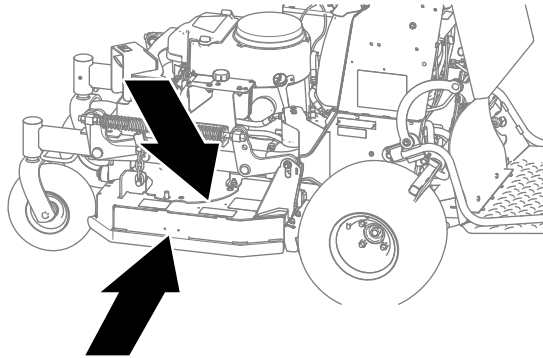

g283721

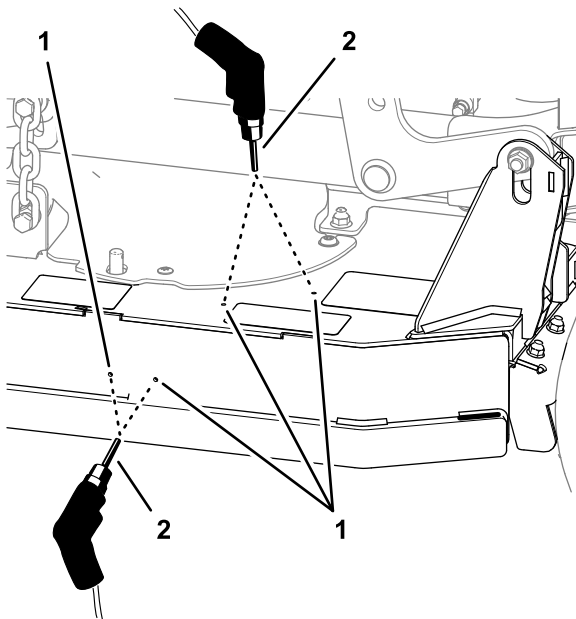

g283722

Figure 1

1. Pilot hole (mower deck)
2. 10 mm (3/8 inch) drill bit

2. Remove any burrs from the holes.
3. At the right side of the mower deck, drill the 2 pilot holes in the deck with a 10 mm (3/8 inch) drill bit as shown in [Figure 2](#).

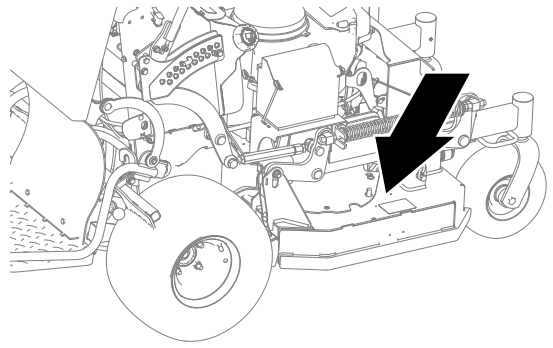

g283723

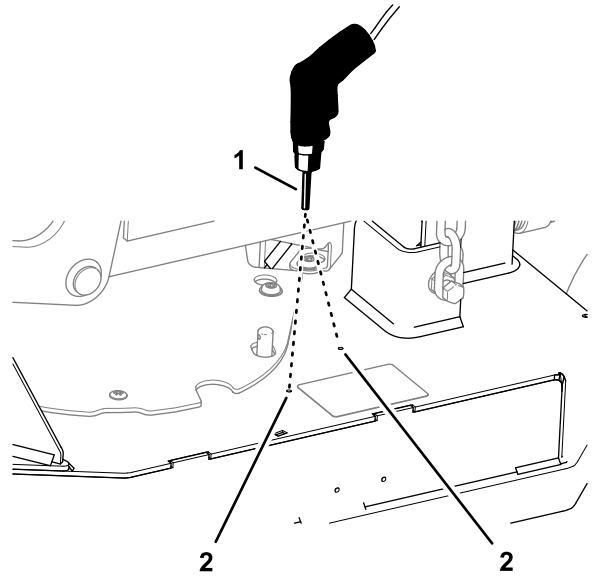

g283724

Figure 2

1. 10 mm (3/8 inch) drill bit
2. Pilot hole (mower deck)

4. Remove any burrs from the holes.

4

Installing the Baffles

Parts needed for this procedure:

1	Left baffle (3 holes)
1	Right baffle (4 holes)
6	Carriage bolt (3/8 x 1 inch)
6	Flange locknut (3/8 inch)

Procedure

Note: Determine the left and right sides of the machine from the normal operating position.

1. Align the end hole in the right baffle (4 holes) to the hole in the mulching-plate flange (Figure 3).

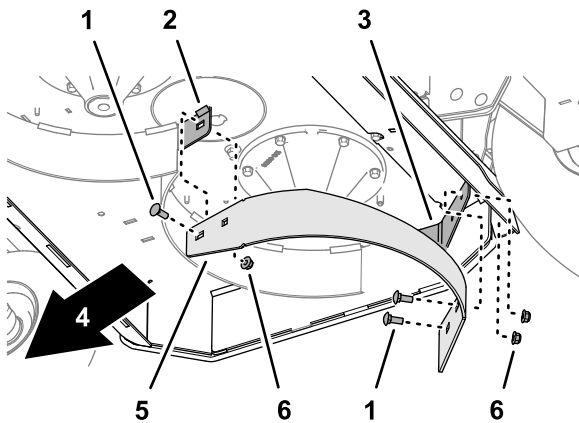

g283719

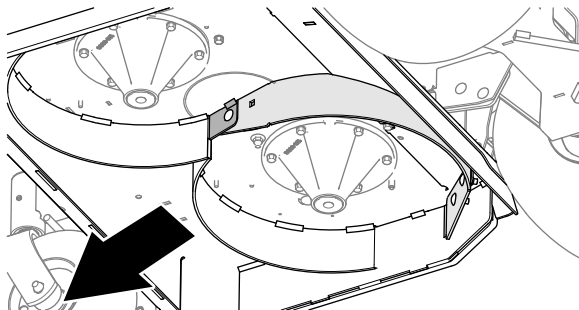

g283720

Figure 3

1. Carriage bolt (3/8 x 1 inch)
2. Mulching-plate flange
3. Small baffle (deck)
4. Front of the machine
5. Right baffle (4 holes)
6. Flange locknut (3/8 inch)

mower deck (Figure 3) with 3 carriage bolts (3/8 x 1 inch) and 3 flange locknuts (3/8 inch).

4. Align the holes in the left baffle (3 holes) with the 2 holes that you drilled in the side of the mower deck (Figure 4).

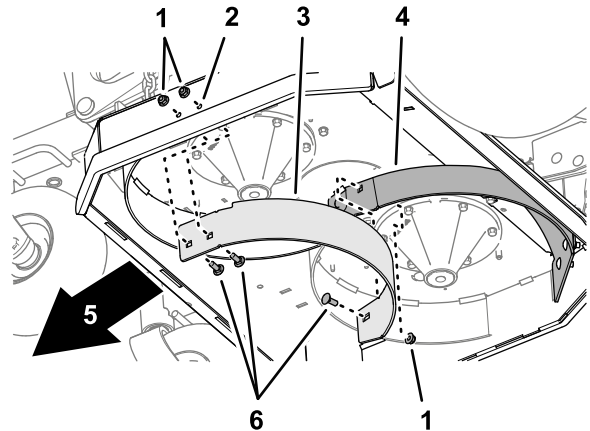

g283717

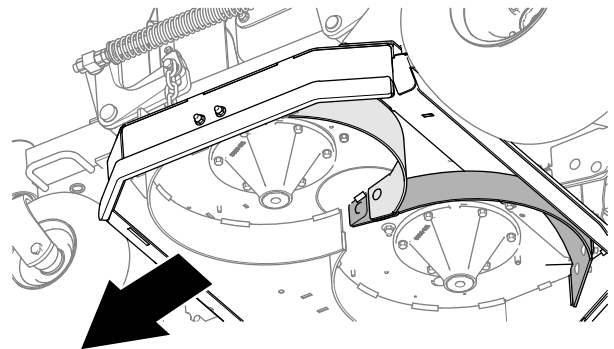

g283718

Figure 4

1. Flange locknut (3/8 inch)
2. 10 mm (3/8 inch) hole
3. Left baffle (3 holes)
4. Right baffle (4 holes)
5. Front of the machine (mower deck—side)
6. Carriage bolts (3/8 x 1 inch)

5. Align the hole in the other end of the left baffle with the open hole in the right baffle (Figure 4).
6. Loosely assemble the left baffle to the side of the deck and the right baffle (Figure 4) with 3 carriage bolts (3/8 x 1 inch) and 3 flange locknuts (3/8 inch).
7. Torque the flange locknuts to 37 to 45 N·m (27 to 33 ft·lb).

2. Align the 2 holes at the other end of the right baffle with the holes in the small baffle of the mower deck (Figure 3).
3. Loosely assemble the right baffle to the mulching-plate flange and the small baffle of the

5

Installing the Kicker Fittings

Parts needed for this procedure:

2	Kicker fitting
4	Carriage bolt (3/8 x 1 inch)
4	Flange locknut (3/8 inch)

Procedure

Note: Determine the left and right sides of the machine from the normal operating position.

1. At the right side of the mower deck, align the slots in the kicker fitting with the 2 holes 10 mm (3/8 inch) that you drilled into the mower deck (Figure 5).

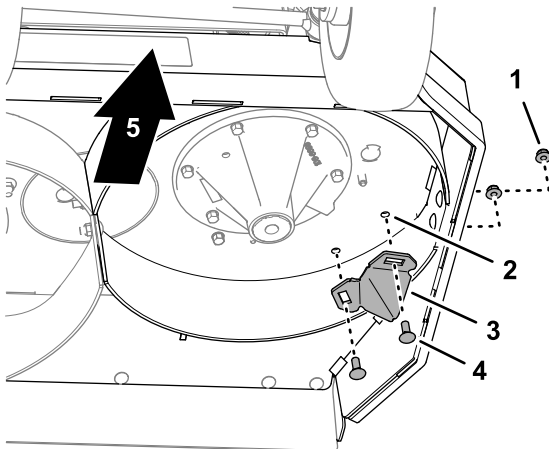

g283725

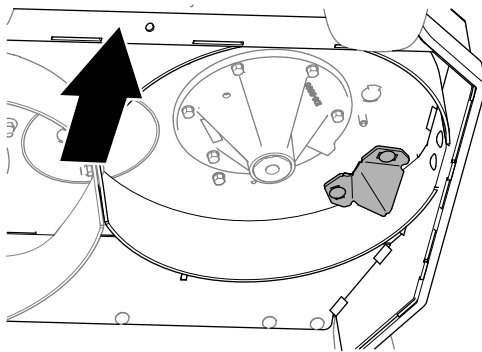

g283726

Figure 5

1. Flange locknut (3/8 inch)
2. 10 mm (3/8 inch) hole (mower deck)
3. Kicker fitting
4. Carriage bolt (3/8 x 1 inch)
5. Front of the machine

2. Assemble the kicker fitting to the deck (Figure 5) with 2 carriage bolts (3/8 x 1 inch) and 2 flange locknuts (3/8 inch).
3. Torque the flange locknuts to 37 to 45 N·m (27 to 33 ft-lb).
4. At the left side of the mower deck, align the slots in the kicker fitting with the 2 holes 10 mm (3/8 inch) that you drilled into the mower deck (Figure 6).

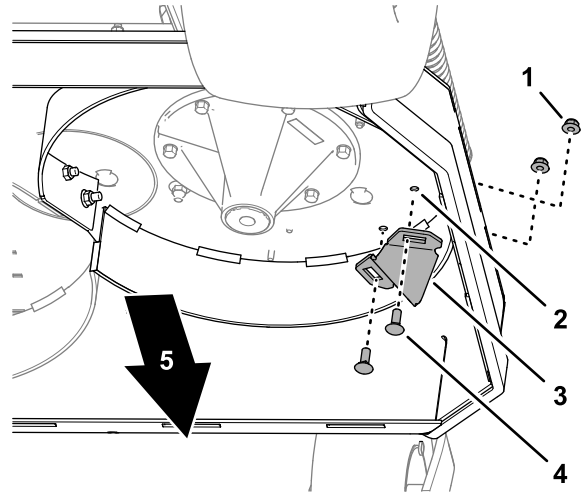

g283727

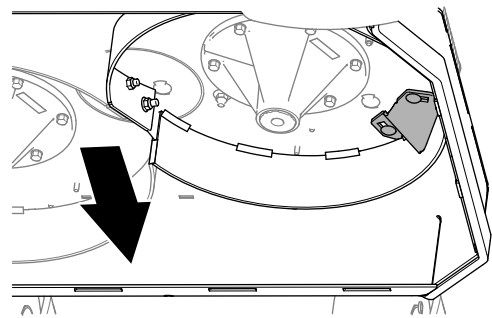

g283728

Figure 6

1. Flange locknut (3/8 inch)
2. 10 mm (3/8 inch) hole (mower deck)
3. Kicker fitting
4. Carriage bolt (3/8 x 1 inch)
5. Front of the machine

5. Repeat steps 2 and 3 for the left kicker fitting.

6

Installing the Recycler Blades

Parts needed for this procedure:

2	Recycler blades (sold separately)
---	-----------------------------------

Procedure

⚠ WARNING

A blade is sharp. Contact with a sharp blade can cause serious personal injury.

Wear gloves or wrap sharp edges of the blade with a rag.

Install the recycler blades onto the mower; refer to the *Parts Catalog* for your machine for the blade part number and the *Operator's Manual* for your machine for installation instructions.

7

Converting the Mower Deck for Rear-Discharge Operation

Parts needed for this procedure:

6	Flange-head capscrews
---	-----------------------

Preparing to Remove the Mulching Kit

1. Prepare the mower; refer to [1 Preparing the Mower \(page 2\)](#).
2. Remove the recycling blades; refer to the *Operator's Manual* for your machine.

Removing the Kicker Fittings

Note: Determine the left and right sides of the machine from the normal operating position.

1. At the bottom, left side of the mower deck, remove the 2 carriage bolts (3/8 x 1 inch) and 2 flange locknuts (3/8 inch) that secure the kicker

fitting to the deck, and remove the kicker fitting ([Figure 7](#)).

Note: Retain the carriage bolts and kicker fitting for installing the mulching kit.

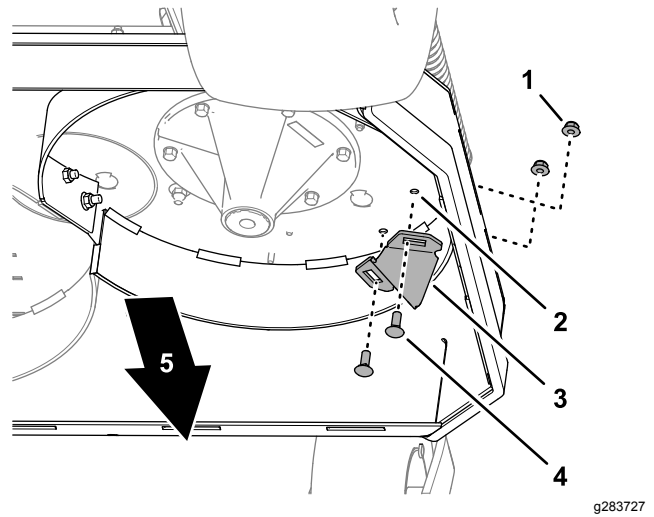

Figure 7

1. Flange locknut (3/8 inch)
2. 10 mm (3/8 inch) hole
3. Kicker fitting
4. Carriage bolt (3/8 inch)
5. Front of the machine (mower deck)

2. Install 2 flange-head capscrews (3/8 x 1 inch) into the 10 mm (3/8 inch) holes in the mower deck ([Figure 8](#)) and secure the capscrews with 2 flange locknuts (3/8 inch) that you removed in step 1.

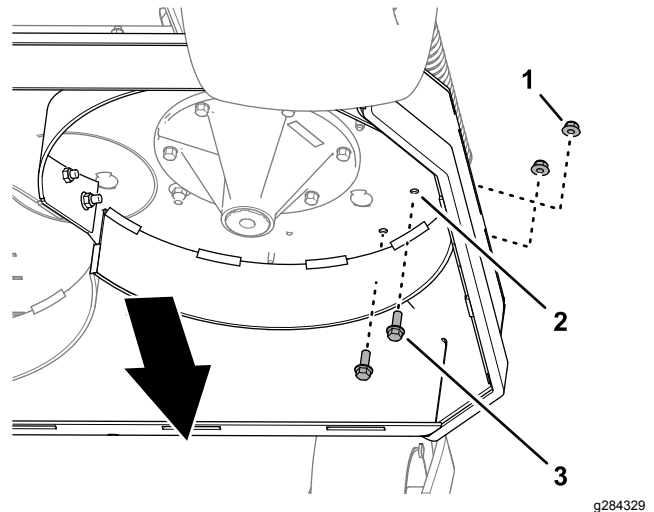

Figure 8

1. Flange locknut (3/8 inch)
2. 10 mm (3/8 inch) hole (mower deck)
3. Flange-head capscrew (3/8 x 1 inch)
3. At the bottom, right side of the mower deck, remove the 2 carriage bolts (3/8 x 1 inch) and 2

flange locknuts (3/8 inch) that secure the kicker fitting to the deck, and remove the kicker fitting (Figure 9).

Note: Retain the carriage bolts and kicker fitting for installing the mulching kit.

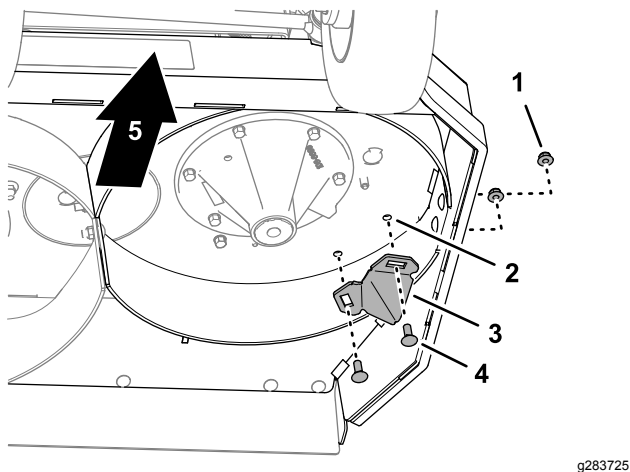

Figure 9

1. Flange locknut (3/8 inch)
2. 10 mm (3/8 inch) hole
3. Kicker fitting
4. Carriage bolt (3/8 x 1 inch)
5. Front of the machine

4. Install 2 flange-head capscrews (3/8 x 1 inch) into the 10 mm (3/8 inch) holes in the mower deck (Figure 10) and secure the capscrews with 2 flange locknuts (3/8 inch) that you removed in step 3.

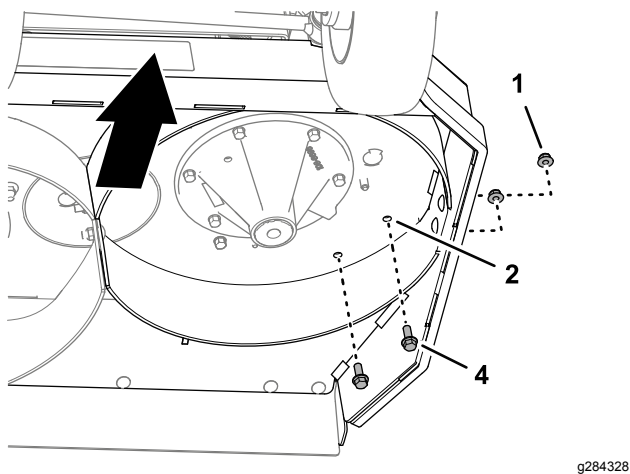

Figure 10

1. Flange locknut (3/8 inch)
2. 10 mm (3/8 inch) hole
3. Flange-head capscrew (3/8 x 1 inch)
4. Flange locknut (3/8 inch)

Removing the Baffles

Note: Determine the left and right sides of the machine from the normal operating position.

1. Remove the 3 carriage bolts (3/8 x 1 inch) and 3 flange locknuts (3/8) that secure the left baffle to the side of the deck and the right baffle, and remove the left baffle (Figure 11).

Note: Retain the carriage bolts, flange locknut, and baffle for installing the mulching kit.

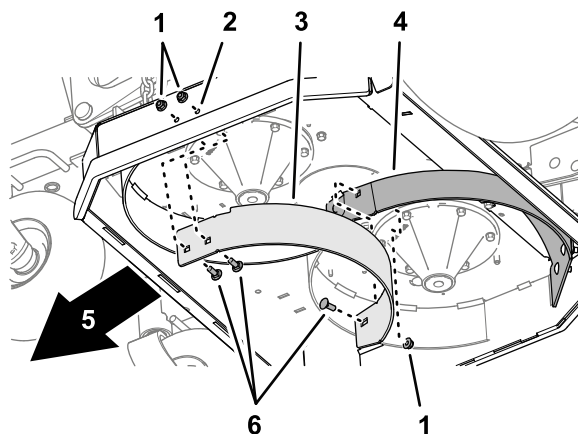

Figure 11

1. Flange locknut (3/8 inch)
2. 10 mm (3/8 inch) hole
3. Left baffle (3 holes)
4. Right baffle (4 holes)
5. Front of the machine

2. Install 2 flange-head capscrews (3/8 x 1 inch) into the 10 mm (3/8 inch) holes in the mower deck (Figure 12) and secure the capscrews with 2 flange locknuts (3/8 inch) that you removed in step 1.

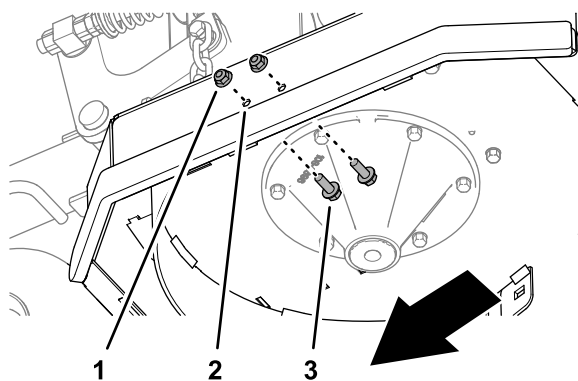

Figure 12

1. Flange locknut (3/8 inch)
2. 10 mm (3/8 inch) hole
3. Flange-head capscrew (3/8 x 1 inch)

3. Remove the 3 carriage bolts (3/8 x 1 inch) and 3 flange locknuts (3/8) that secure the right baffle

to the mulching-plate flange and the small baffle of the mower deck, and remove the left baffle (Figure 13).

Note: Retain the carriage bolts, flange locknuts, and baffle for installing the mulching kit.

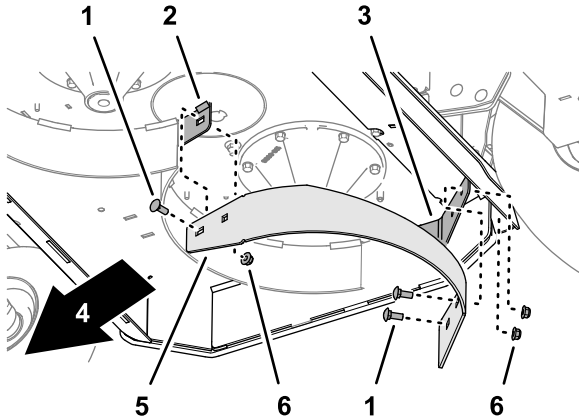

Figure 13

g283719

- | | |
|---------------------------------|------------------------------|
| 1. Carriage bolt (3/8 x 1 inch) | 4. Front of the machine |
| 2. Mulching-plate flange | 5. Right baffle (4 holes) |
| 3. Small baffle (deck) | 6. Flange locknut (3/8 inch) |

Finishing Converting the Mower Deck for Rear-Discharge Operation

Install the non-recycling blades; refer to the *Operator's Manual* for your machine.

Operation

Selecting the Proper Height of Cut

Remove approximately one inch or no more than 1/3 of the grass blade when cutting. In exceptionally lush and dense grass you may need to raise the height-of-cut setting or convert the mower deck for rear discharge operations.

Mowing in Extreme Conditions

Air is required to cut and recut grass clippings in the mower housing, so do not set the height-of-cut too low or fully surround the housing by uncut grass. Always try to keep the back of the mower deck free from uncut grass, allowing air to be drawn into the housing. When making an initial cut through the center of an uncut area, operate the machine slower and back the machine if the mower starts to clog.

Mowing at Proper Intervals

Under most normal conditions you will need to mow every 4 to 5 days. However, grass grows at different rates at different times. It is a good practice to maintain the same height-of-cut; therefore, you need to cut more frequently in early spring; as the grass growth rate slows in midsummer, cut every 8 to 10 days.

If you are unable to mow for an extended period due to weather conditions or other reasons, convert to the mower deck for rear discharge or mow first with the height-of-cut at a high level; then mow again 2 to 3 days later at a lower height setting.

Mowing with Sharp Blades

A sharp blade cuts cleanly and without tearing or shredding the grass. A dull blade tears and shreds the grass. Tearing and shredding causes the grass to turn brown at the edges, which impairs growth and increases susceptibility to disease.

Cleaning the Mower Deck

Service Interval: After each use

To ensure optimum performance, clean the underside of the mower deck after each use.

Note: If residue grass builds up in the mower deck, cutting performance decreases.