



Wheel Weight Kit

Groundsmaster® 3500 Series Rotary Mower or Reelsmaster 3100 Series Traction Unit

Model No. 136-3315

Form No. 3432-840 Rev A

Installation Instructions

Installation

Loose Parts

Use the chart below to verify that all parts have been shipped.

Description	Qty.	Use
Wheel weight	2	Install the wheel weight.
Wheel-weight adapter	4	
Threaded stud	4	
Washer	4	
Nut	4	

Installing the Wheel Weight

Note: Install a weight on each front wheel.

1. Park the machine on a level surface, lower the cutting units, engage the parking brake, shut off the engine, and remove the key.
2. Determine the 2 lug nuts to remove by ensuring that the valve stem is not covered.

Important: Ensure that the valve stem of the tire is accessible through the wheel-weight access hole.

3. Remove the 2 lug nuts from the machine.

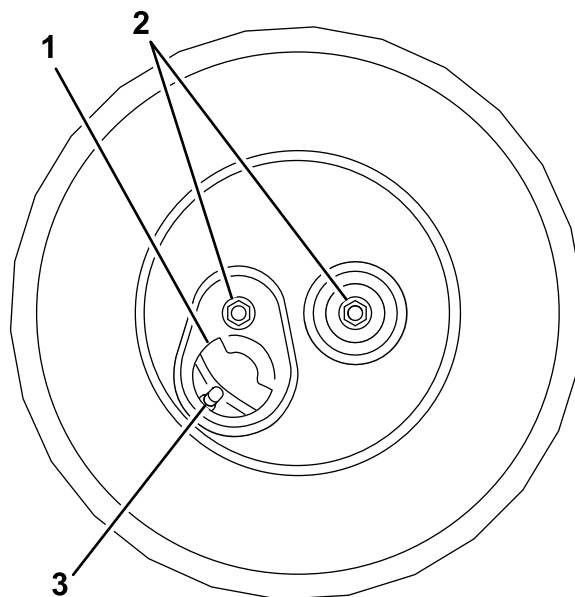

Figure 1

1. Valve stem access hole
2. Remove these lug nuts.
3. Valve stem

g290694



4. Install the threaded studs into the wheel-weight adapters until they bottom out ([Figure 2](#)).
5. Install the adapter assemblies onto the wheel studs where the lug nuts were removed ([Figure 2](#)).

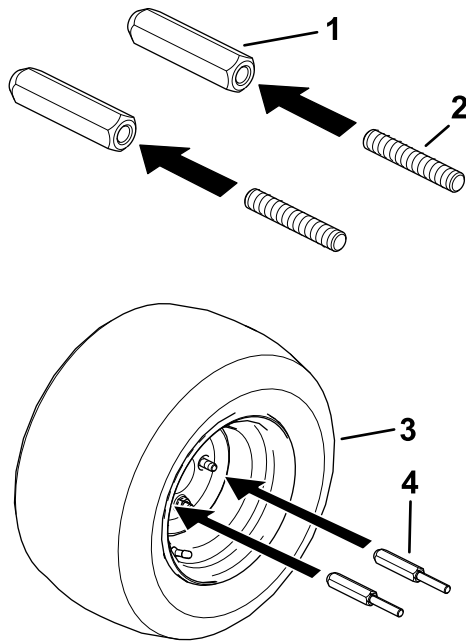

g290692

Figure 2

- | | |
|------------------|-----------------------|
| 1. Adapter | 3. Wheel |
| 2. Threaded stud | 4. Adapter assemblies |

6. Torque the adapter assemblies between 95 and 115 N·m (70 and 85 ft-lb).
7. Secure the weight to the wheel with 2 washers and 2 nuts ([Figure 3](#)).
8. Torque the nuts between 95 and 115 N·m (70 and 85 ft-lb).

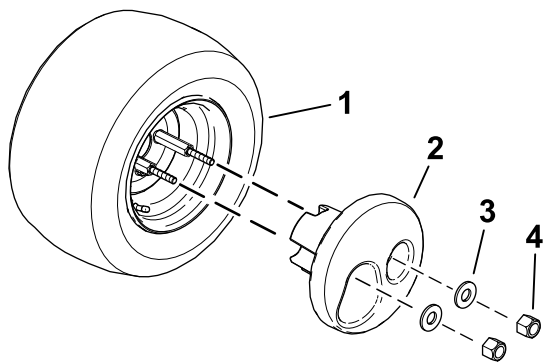

g290693

Figure 3

- | | |
|-----------|-----------|
| 1. Wheel | 3. Washer |
| 2. Weight | 4. Nut |