



MODEL NO. 08856

INSTALLATION
INSTRUCTIONS

SAND PRO SPIKER

1. Attach ball joint ends of spiking units to the mounting frame with the castellated nuts and secure with cotter pins (Fig. 1).

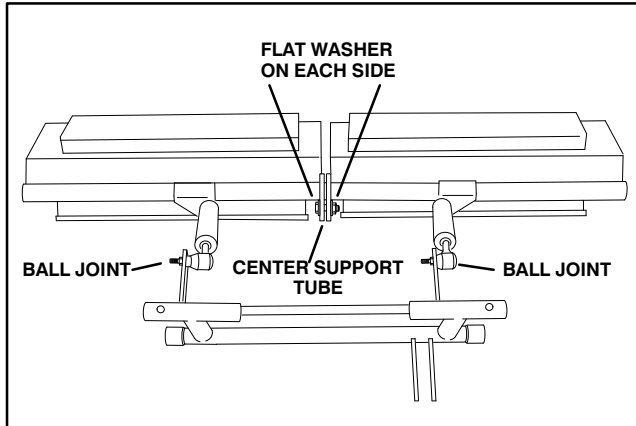

Figure 1

Note: Both ball joint ends face in the same direction to ease the removal of spiking units.

2. Secure center of spiking units together with a large capscrew, (2) flatwashers, center support tube and locknut (Fig. 1).

3. Assemble the springs and washers as shown in Figure 2. Assemble both springs and insert the long bolts from the bottom.

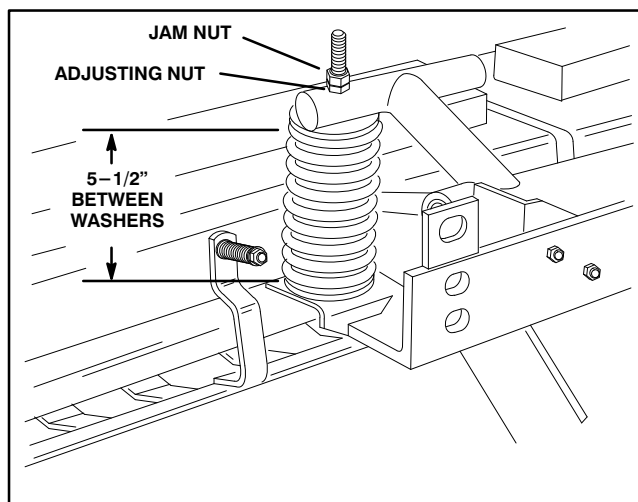

Figure 2

4. Using bottom nut, adjust spring length to 5-1/2" (between washers) and secure with jam nuts.

5. Back the Sand Pro up to the spiker and secure the mounting frame to the Sand Pro frame with (4) 1/2" x 1-1/4" lg. capscrews and flat washers as shown in figure 3.

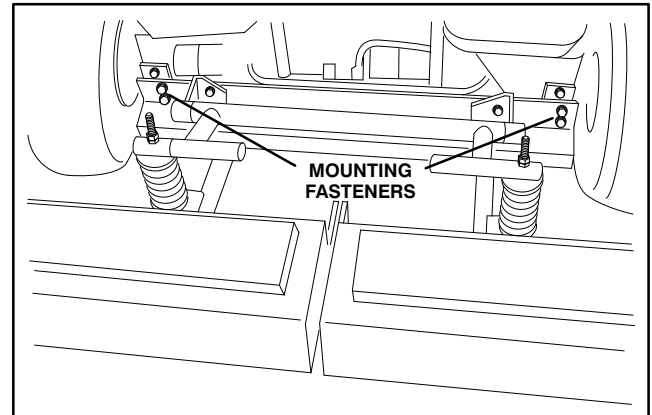

Figure 3

6. Secure cylinder rod to lift arms with pin and hairpin cotter.

Note: On the Sand Pro 5000 (Model No. 08881), the hydraulic cylinder is mounted to left side of cylinder bracket on the hitch and lift arm assembly with above fasteners plus a spacer, capscrew and locknut, as shown in figure 4.

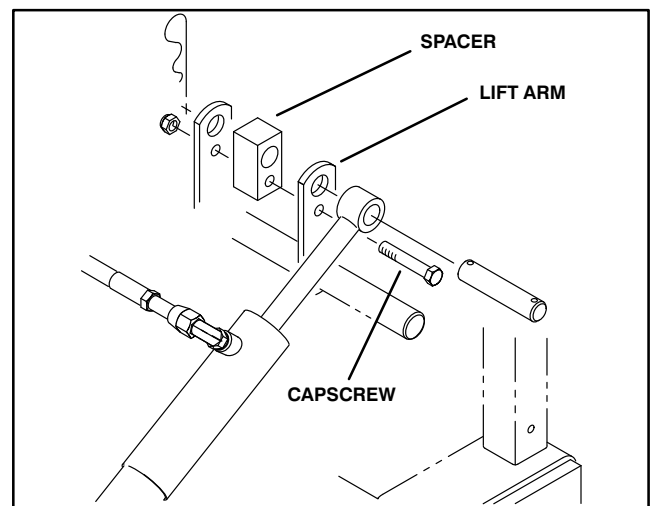

Figure 4