



## Mini Tine Head

### MultiCore-by-Toro/ProCore Aerators

MODEL NO. 09721

## INSTALLATION INSTRUCTIONS

### Preparing the Tractor

1. Park the tractor on a level surface and engage the parking brake.
2. Raise the aerator off of the ground and install the safety stand at the rear of the aerator. (Refer to the Aerator Operator's Manual.) Lower the aerator until the safety stand contacts the ground.
3. Ensure that the PTO is disengaged. Turn the engine off and remove the key.

### ⚠ CAUTION

#### POTENTIAL HAZARD

- If you leave the key in the ignition switch, someone could start the engine.

#### WHAT CAN HAPPEN

- Accidental starting of the engine could seriously injure you or other bystanders.

#### HOW TO AVOID THE HAZARD

- Remove the key from the ignition switch before you do any maintenance.

4. If there are existing tine heads mounted on the machine, remove the fasteners securing the tine heads to the tine arms and remove the tine heads.

**Note:** The aerator must be equipped with the proper turf guards before using the mini tine head. Refer to the Aerator Operator's Manual for turf guard requirements.

### Installing Tine Heads with 16mm Mounting Holes (Fig. 1)

If your tine heads have mounting holes that measure 16mm (Fig. 1), proceed with the following:

1. Slide the tines completely into the mini tine head (Fig. 1) and torque the set screws to 35–40 ft-lbs (50–55 N•m). When installing the tines, use a piece of wood or a metal plate to hold the tines into place until the set screws can be tightened.

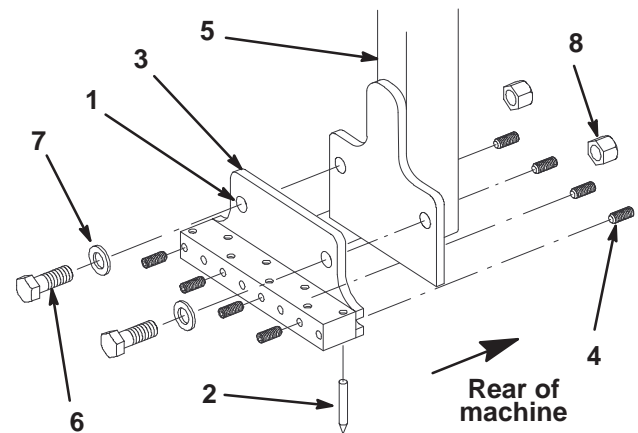

Figure 1

- |                       |                        |
|-----------------------|------------------------|
| 1. 16mm mounting hole | 5. Tine arm            |
| 2. Tine               | 6. M16 x 45mm capscrew |
| 3. Tine head          | 7. Flat washer         |
| 4. Set screw          | 8. Lock nut            |
2. Mount the tine heads to the tine arms with (2) M16 x 45mm capscrews, flat washers, and lock nuts (Fig. 1). Torque to 155–180 ft-lbs (205–245 N•m).

**Note:** If mounting the tine head to MultiCore Model No. 09697, 09698, or 09699, you will need parts listed in the table below which are not included in this kit. Press the spacers into the tine head mounting holes (Fig. 1) and use the fasteners stated in the table to mount the tine heads to the tine arms. Torque to 60–70 ft-lbs (85–95 N•m).

Part Number	Quantity	Description
100–7604	2	Spacer
33116–045	2	Capscrew
33096–00	2	Washer
33026–00	2	Lock nut

Installing Tine Heads with 12mm Mounting Holes (Fig. 2)

If your tine heads have mounting holes that measure 12mm (Fig. 2), proceed with the following:

- 1. Slide the tines completely into the mini tine head (Fig. 2) and torque the set screws to 35–40 ft-lbs (50–55 N•m). When installing the tines, use a piece of wood or a metal plate to hold the tines into place until the set screws can be tightened.
- 2. Mount the tine heads to the tine arms with (2) M12 x 35mm capscrews, lock washers, and flat washers (Fig. 2). Torque to 60–70 ft-lbs (85–95 N•m).

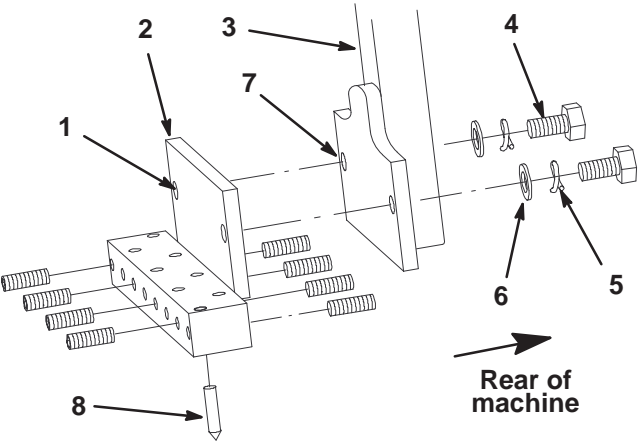

Figure 2

- 1. 12mm mounting hole
- 2. Tine head
- 3. Tine arm
- 4. M12 x 35mm capscrew
- 5. Lock washer
- 6. Flat washer
- 7. Press spacers here
- 8. Tine

**Note:** If mounting the tine head to ProCore Model No. 09700, 09701, or 09702, you will need parts listed in the table below which are not included in this kit. Press the spacers into the tine arm (Fig. 2) and use the fasteners stated in the table to mount the tine heads to the tine arms in the opposite direction shown in Figure 2. Torque to 60–70 ft-lbs (85–95 N•m).

Part Number	Quantity	Description
100–7604	2	Spacer
33116–045	2	Capscrew
33096–00	2	Washer
33026–00	2	Lock nut