



Wire Harness for Wireless Hour Meter Kit

Walk-Behind Greensmaster® Mower

Model No. 120-9690

Form No. 3433-442 Rev A

Installation Instructions

Installation

Preparing the Machine

1. Park the machine on a level surface.
2. Engage the parking brake.
3. Shut off the engine.
4. Remove the spark-plug wire from the spark plug.

Installing the Wire Harness

1. Unplug the machine wire harness from the interlock module and remove the module from the bracket.

Retain the hardware.

2. Unplug the power connections from the back of the engine.
3. Remove the 2 nuts that secure the fuel tank to the engine.
4. Remove the existing bracket.
5. Install the new bracket (Figure 1) with the 2 nuts that you previously removed.
6. Install the interlock module to the new bracket (Figure 1).
7. Install the voltage regulator to the new bracket (Figure 1).
8. If the unit is equipped with a light kit, disconnect the light power harness from the engine.
9. Install the wire harness as follows:

- Connect the wireless-hour-meter connector to the wireless hour meter.
- Connect the voltage-regulator connector to the voltage regulator.
- Use an existing engine mounting bolt to connect the ring terminal to the engine as a ground.
- Connect the wireless-hour-meter wire harness to the machine and engine wire harnesses per the following table:

WHM Wire Harness		
Yellow	Blue	Machine Wire Harness
Black	Black	
Yellow	Dark Blue	Engine Wire Harness
Black	Light Blue	

10. Use cable ties to secure the wire harness to the handle and out of the way of hot or sharp parts.

Note: If your machine is equipped with an hour meter, the wireless hour meter should be put in its place. Do not disconnect the old hour meter; secure it under the console shroud instead. If your machine is not equipped with an hour meter, the wireless hour meter should be secured under the console shroud.

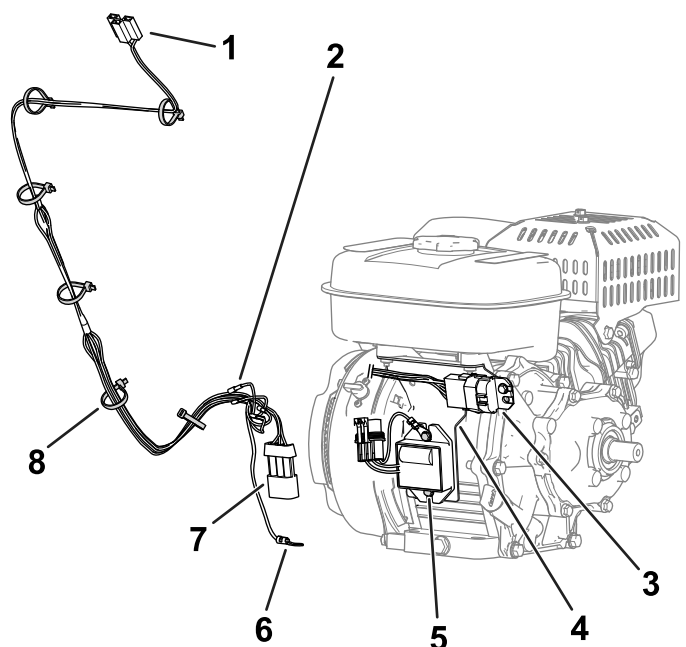

Figure 1

- | | |
|----------------------------------|----------------------------------|
| 1. Connector—wireless hour meter | 5. Voltage regulator |
| 2. Engine/machine connectors | 6. Ring terminal (engine ground) |
| 3. Interlock module | 7. Connector—voltage regulator |
| 4. Bracket | 8. Cable tie |

