



# Receiver Hitch Kit

Workman® 1100/2100/2110 and Twister® 1400/1600 Utility Vehicle

Model No. 07278

Model No. 07278R

## Installation Instructions

## Safety

### Safety and Instructional Decals



Safety decals and instructions are easily visible to the operator and are located near any area of potential danger. Replace any decal that is damaged or missing.

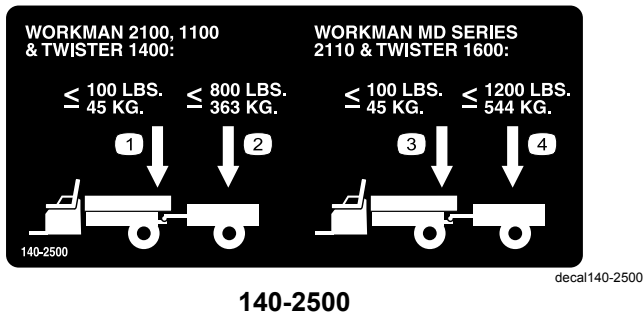

- For Workman 2100, 1100, and Twister 1400—maximum tongue weight is 45 kg (100 lb)
- For Workman 2100, 1100, and Twister 1400—maximum trailer weight is 363 kg (800 lb)
- For Workman MD series, 2110, and Twister 1600—maximum tongue weight is 45 kg (100 lb)
- For Workman MD series, 2110, and Twister 1600—maximum trailer weight is 544 kg (1,200 lb)

## Installation

### Installing the Receiver Hitch

#### For Workman 1100, 2100, and 2110 and Twister 1400 and 1600 Machines

- Remove the existing hitch from the rear frame.
- Attach the receiver hitch to the rear frame with 4 flange-head bolts and flange nuts ([Figure 1](#)).

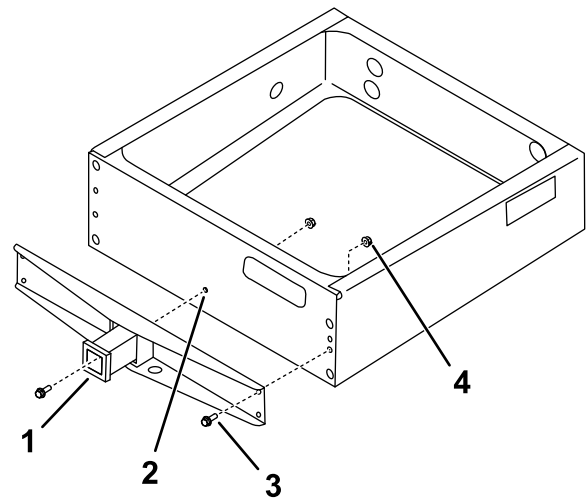

Figure 1

- Receiver hitch
- Drill a hole (3/8 inch) here using the hitch as a template if a hole is not present.
- Flange-head bolt
- Flange nut

g296023

**Note:** A 2-inch x 2-inch standard ball mount is not included with this kit. You can purchase a ball mount at a hitch dealer or automotive parts store.



## For Workman MD/MDX Machines

1. Remove the existing hitch from the rear swing arm.
2. Attach the receiver hitch to the rear swing arm with 5 flange-head bolts and flange nuts (Figure 2).

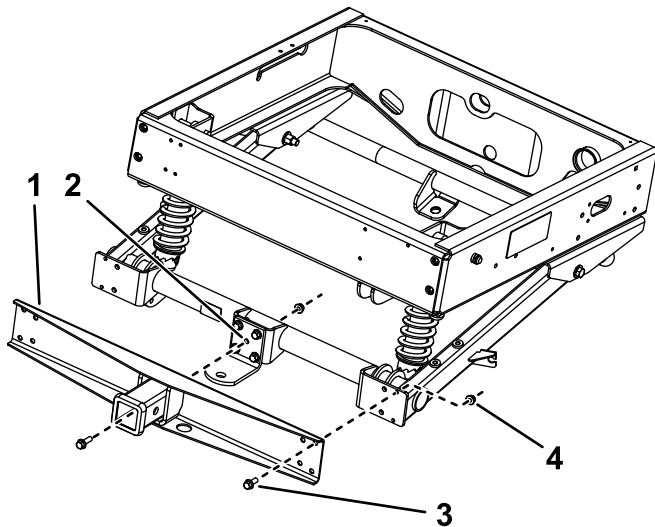

g295439

**Figure 2**

- |   |                     |
|---|---------------------|
| 1. Receiver hitch assembly  | 3. Flange-head bolt |
| 2. Drill a hole (3/8 inch) here using the hitch as a template if a hole is not present. | 4. Flange nut       |

---

**Note:** A 2-inch x 2-inch standard ball mount is not included with this kit. You can purchase a ball mount at a hitch dealer or automotive parts store.

## Operation

### Avoiding Hitch Interference

Because ball mounts vary in design and shape, remove them from the receiver before lifting the cargo bed to avoid possible interference.

A tailgate lanyard kit for avoiding contact with the hitch is available.