



Front Weight Kit

Zero-Turn-Radius Riding Mower

Model No. 140-2050

Installation Instructions

Installation

Loose Parts

Use the chart below to verify that all parts have been shipped.

Procedure	Description	Qty.	Use
1	No parts required	—	Prepare the machine.
2	No parts required	—	Remove the guards (machines equipped with MyRide only).
3	Bolt (3/8 x 1 inch) Locknut (3/8 inch) Left weight-mounting bracket Right weight-mounting bracket Washer Bolt (5/8 x 2-3/4 inches) Suitcase weight	4 6 1 1 2 2 8	Install the weights.
4	No parts required	—	Install the guards (machines equipped with MyRide only).

1

Preparing the Machine

No Parts Required

Procedure

1. Park the machine on a level surface.
2. Disengage the blade-control switch.
3. Move the motion-control levers outward to the NEUTRAL-LOCK position to engage the parking brake.
4. Shut off the engine and remove the key.



2

Removing the Guards

Machines Equipped with MyRide® Only

No Parts Required

Procedure

Note: Retain all removed parts for later installation.

1. Remove the bolts securing the guards on the sides of the frame.
2. Remove the guards on both sides of the frame (Figure 1).

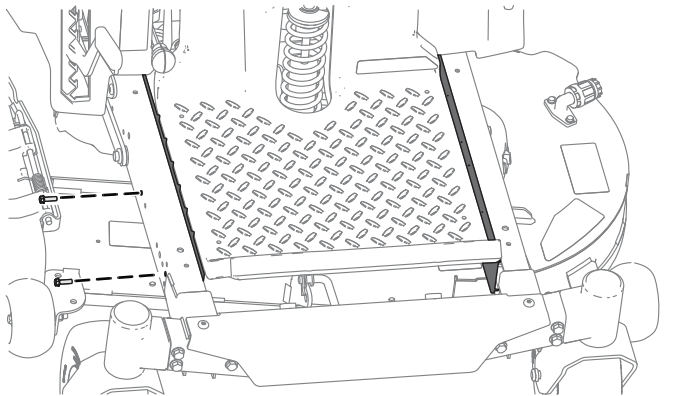

Figure 1

3

Installing the Weights

Parts needed for this procedure:

4	Bolt (3/8 x 1 inch)
6	Locknut (3/8 inch)
1	Left weight-mounting bracket
1	Right weight-mounting bracket
2	Washer
2	Bolt (5/8 x 2-3/4 inches)
8	Suitcase weight

Procedure

⚠ CAUTION

The bagger changes the weight distribution of the machine. Operating the machine without the front weights may cause an unstable condition, which could result in a loss of control.

Ensure the front weights are properly installed before operating the machine with the bagger attachment.

1. Install the weight-mounting brackets to the under side of the frame using 2 bolts (3/8 x 1 inch), and 2 locknuts (3/8 inch) as shown in Figure 2.
2. Install suitcase weights to the weight mounting brackets using 2 bolts (5/8 x 2-3/4 inches), 2 washers, and 2 locknuts (3/8 inch) as follows:
 - If your machine has a 42-inch stamped deck, install 8 suitcase weights.
 - If your machine has any other cutting deck, install 6 suitcase weights (Figure 3).
3. Once you have installed all the weights and brackets, ensure that all the fasteners are tight. Tighten as necessary.

Important: Whenever you remove the bagger attachment, remember to remove the front weights to return the proper stability to the machine.

4

Installing the Guards

Machines Equipped with MyRide Only

No Parts Required

Procedure

1. Insert the top of the guard under the deck; tilt the guard so that it slides under the frame and fit the guard into the notches ([Figure 4](#)).

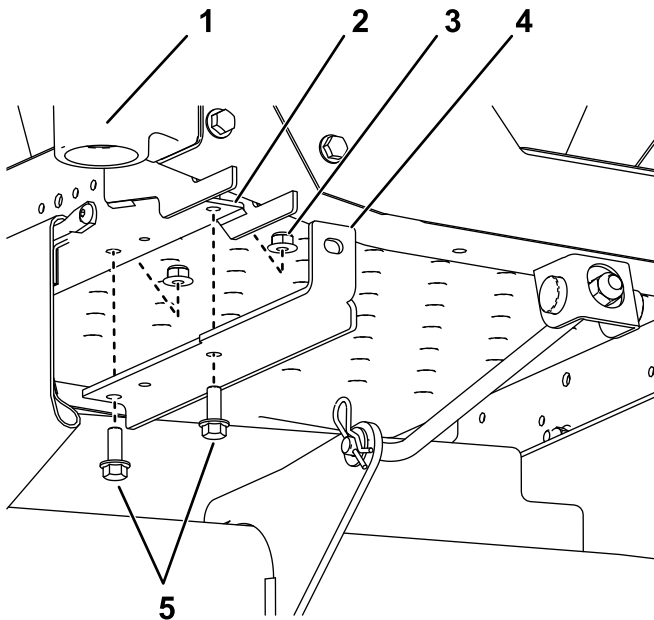

g299192

Figure 2

Castor fork and wheel not shown for clarity.

- | | |
|------------------------------------|---------------------------|
| 1. Front right caster | 4. Right mounting bracket |
| 2. Forward hole (right side shown) | 5. Bolts (3/8 x 1 inch) |
| 3. Locknut (3/8 inch) | |

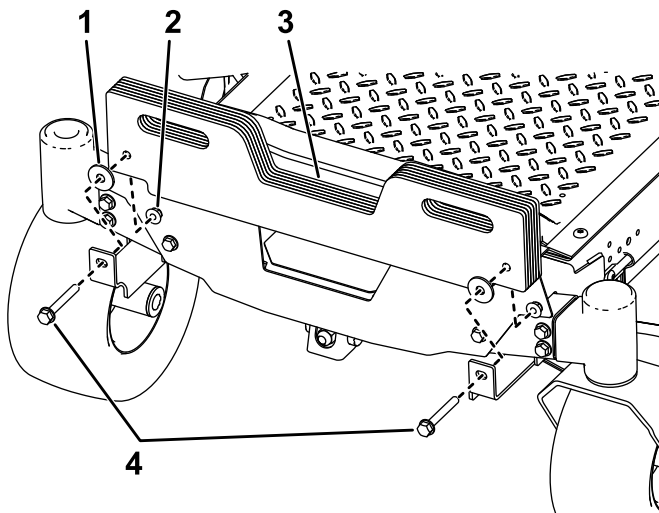

g299244

Figure 3

- | | |
|-----------------------|-------------------------------|
| 1. Spacer | 3. Suitcase weights |
| 2. Locknut (3/8 inch) | 4. Bolts (5/8 x 2-3/4 inches) |

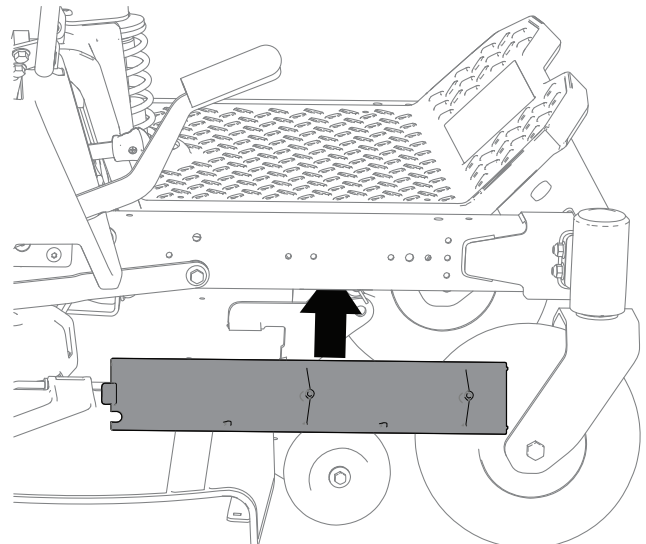

g308505

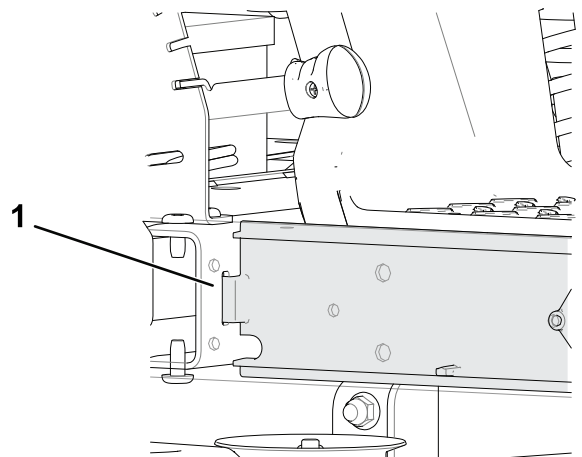

g308526

Figure 4

1. Notch
2. Secure the guards to the frame using the bolts removed in [2 Removing the Guards \(page 2\)](#) as shown in [Figure 1](#).



Count on it.