



Horn Kit

Workman® GTX Utility Vehicle

Model No. 133-3016
Model No. 133-3017

Installation Instructions

Installation

Loose Parts

Use the chart below to verify that all parts have been shipped.

| Procedure | Description | Qty. | Use |
|-----------|--|------|---------------------------------------|
| 1 | No parts required | – | Prepare the machine. |
| 2 | 12 V horn assembly (for Gasoline GTX vehicles) | 1 | Install the horn. |
| | 48 V horn assembly (for Electric GTX vehicles) | 1 | |
| | Hex-head screw (5/16 x 3/4 inch) | 1 | |
| | Flange nut (5/16 inch) | 1 | |
| 3 | Horn switch | 1 | Install the horn switch. |
| | Rubber button | 1 | |
| 4 | Fuse (30 A) | 1 | Install the fuse into the fuse block. |
| 5 | No parts required | – | Connect the battery. |
| 6 | No parts required | – | Test the horn function. |

Note: Determine the left and right sides of the machine from the normal operating position.



1

Preparing the Machine

No Parts Required

For Gasoline GTX Vehicles

1. Park the machine on a level surface, set the parking brake, shut off the engine, and remove the key.
2. Disconnect the negative-battery cable; refer to your *Operator's Manual*.

For Electric GTX Vehicles

1. Park the machine on a level surface, set the parking brake, shut off the machine, and remove the key.
2. Disconnect the main negative-battery cable (black) that connects the bank of batteries to the ground point of the machine; refer to your *Operator's Manual*.

2

Installing and Connecting the Horn

Parts needed for this procedure:

| | |
|---|--|
| 1 | 12 V horn assembly (for Gasoline GTX vehicles) |
| 1 | 48 V horn assembly (for Electric GTX vehicles) |
| 1 | Hex-head screw (5/16 x 3/4 inch) |
| 1 | Flange nut (5/16 inch) |

For Gasoline GTX Vehicles

1. Release the rubber straps on both sides of the hood and raise the hood.
2. Install the 12 V horn assembly to the existing hole in the dash bracket with the hex-head screw (5/16 x 3/4 inch) and flange nut (5/16 inch) as shown in [Figure 1](#).

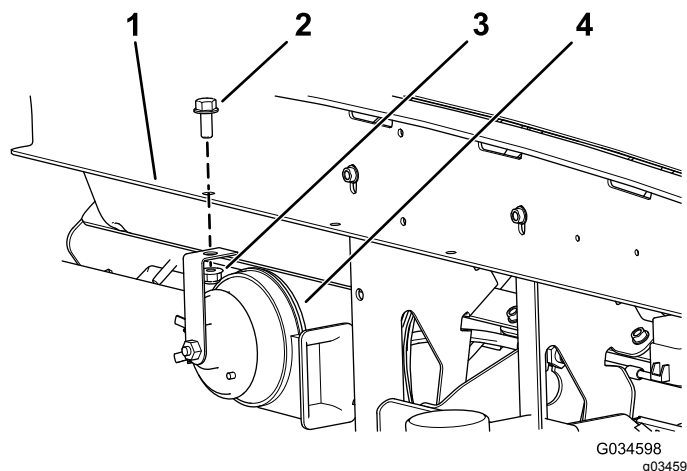

Figure 1

1. Dash bracket
2. Hex-head screw (5/16 x 3/4 inch)
3. Flange nut (5/16 inch)
4. 12 V horn assembly

3. Plug the 2 female connectors from the main wire harness into the 2 male connectors on the 12 V horn ([Figure 2](#)).

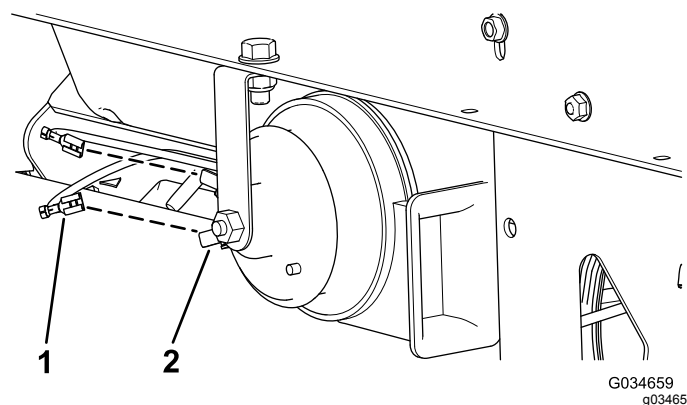

Figure 2

1. Female connector
2. Male connector

For Electric GTX Vehicles

1. Release the rubber straps on both sides of the hood and raise the hood.
2. Install the 48 V horn assembly to the existing hole in the dash bracket with the hex-head screw (5/16 x 3/4 inch) and flange nut (5/16 inch) as shown in [Figure 3](#).

Note: The bracket on the horn assembly and the flange nut (5/16 inch) are located on the inside of the dash bracket ([Figure 3](#)).

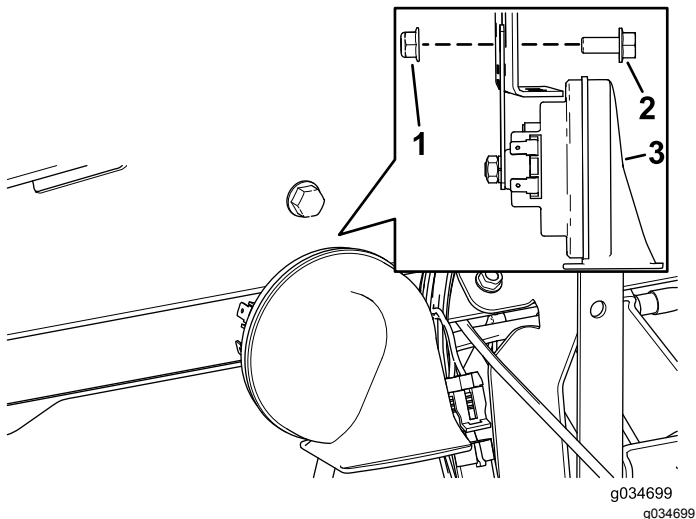

Figure 3

1. Flange nut (5/16 inch)
2. Hex-head screw (5/16 x 3/4 inch)
3. 48 V horn assembly

3. Plug the 2 female connectors from the main wire harness into the 2 male connectors on the 48 V horn ([Figure 4](#)).

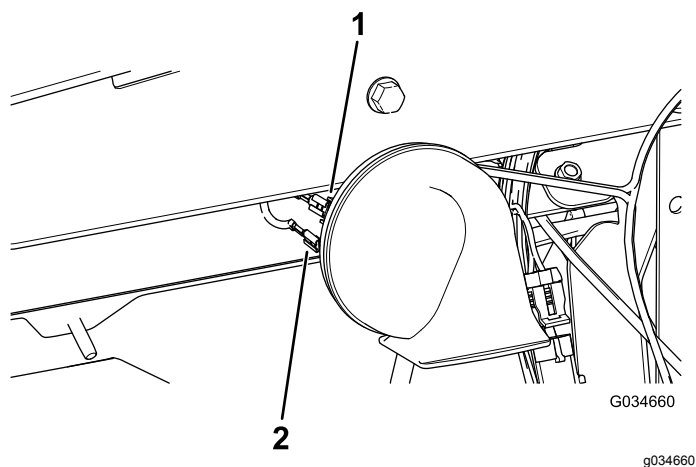

Figure 4

1. Male connector
2. Female connector

3

Installing and Connecting the Horn Switch

Parts needed for this procedure:

| | |
|---|---------------|
| 1 | Horn switch |
| 1 | Rubber button |

For Gasoline GTX Vehicles

1. Reach under the dash bracket and push the existing plastic plug out.
2. Reach under the dash bracket and install the horn switch into the opening ([Figure 5](#)).

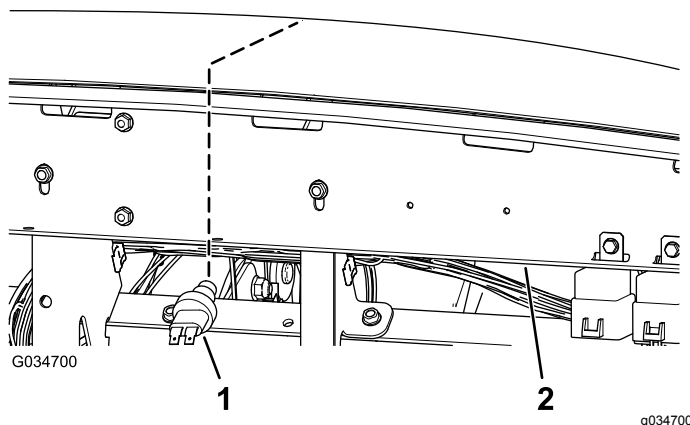

Figure 5

1. Horn switch
2. Dash bracket

3. Install the rubber button to the horn switch ([Figure 6](#)).

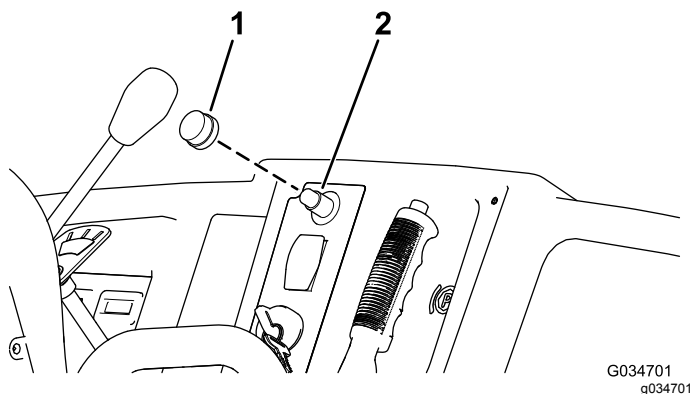

Figure 6

1. Rubber button
2. Horn switch

4. Plug the female connector from the main wire harness to the male connector on the horn switch (Figure 7).

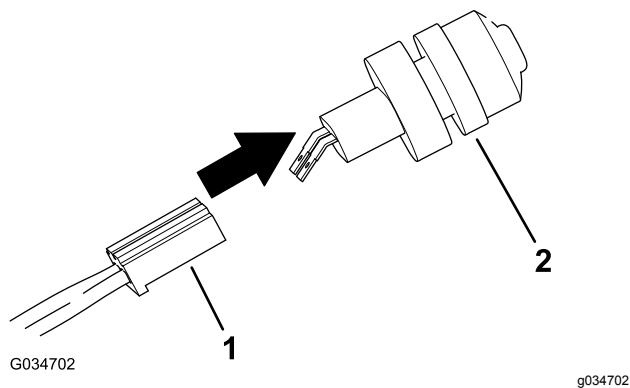

Figure 7

1. Female connector (main wire harness)
2. Male connector (horn switch)

For Electric GTX Vehicles

1. Reach under the dash bracket and push the existing plastic plug out.
2. Reach under the dash bracket and install the horn switch into the opening (Figure 5).
3. Install the rubber button to the horn switch (Figure 6).
4. Plug the female connector from the main wire harness to the male connector on the horn switch (Figure 7).

4

Installing the Fuse

Parts needed for this procedure:

| | |
|---|-------------|
| 1 | Fuse (30 A) |
|---|-------------|

For Gasoline GTX Vehicles

For machines with serial number 403999999 and before:

Install the fuse (30 A) into the opening in the fuse block (Figure 8).

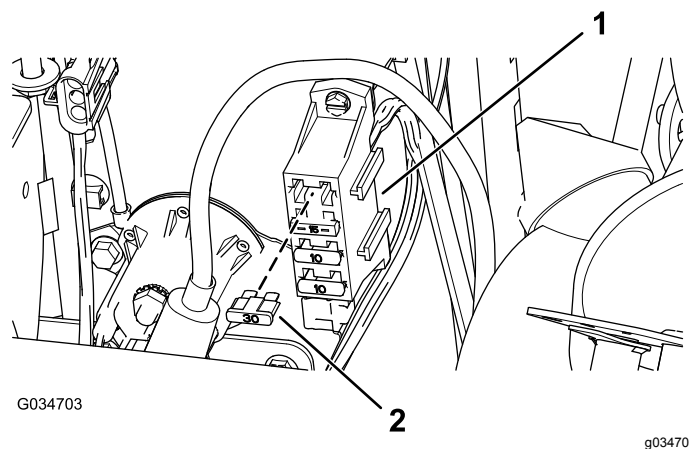

Figure 8

1. Fuse block
2. Fuse (30 A)

For machines with serial number 404000000 and after:

Install the fuse (30 A) into the opening in the fuse block (Figure 9).

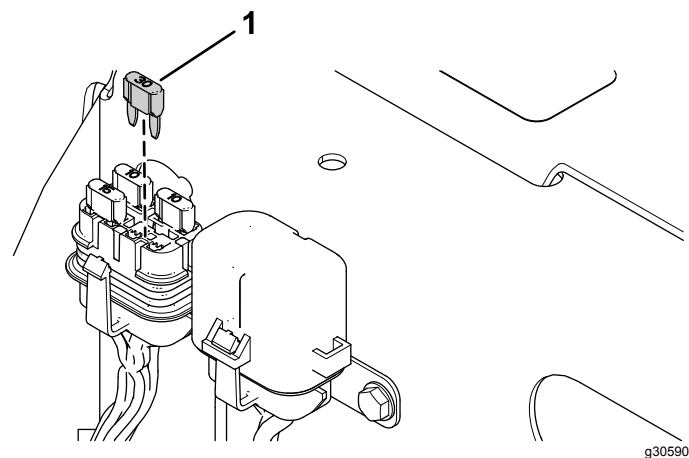

Figure 9

1. Fuse (30 A)

For Electric GTX Vehicles

For machines with serial number 403999999 and before:

Install the fuse (30 A) into the opening in the fuse block (Figure 10).

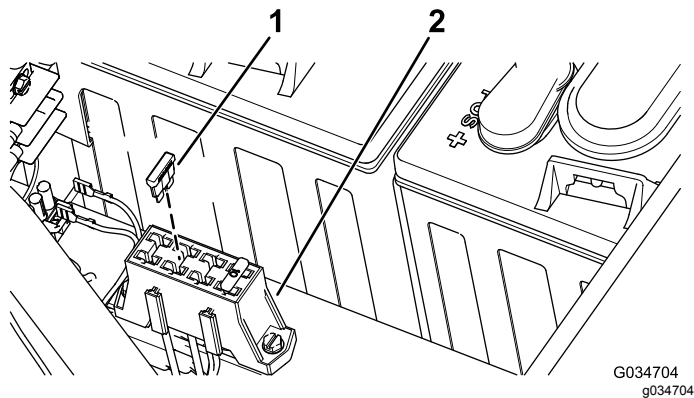

Figure 10

1. Fuse (30 A) 2. Fuse block
-

For machines with serial number 404000000 and after:

Install the fuse (30 A) into the opening in the fuse block (Figure 11).

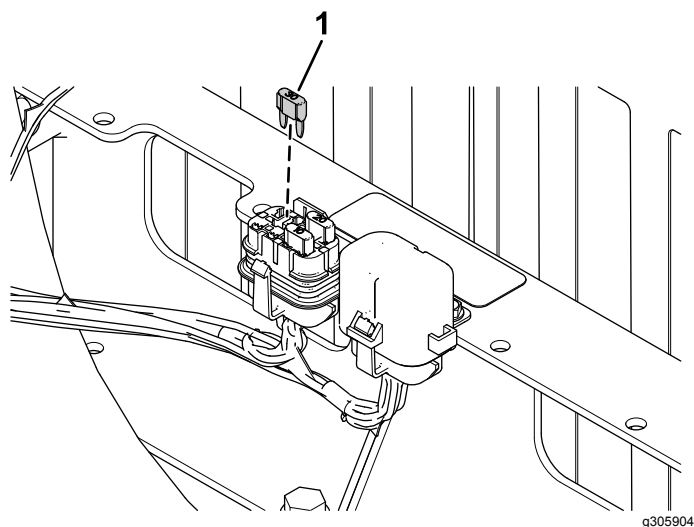

Figure 11

1. Fuse (30 A)
-

5

Connecting the Battery

No Parts Required

For Gasoline GTX Vehicles

Connect the negative-battery cable; refer to your *Operator's Manual*.

For Electric GTX Vehicles

Connect the main negative-battery cable (black) that connects the bank of batteries to the ground point of the machine; refer to your *Operator's Manual*.

6

Testing the Horn Function

No Parts Required

Procedure

Confirm that the horn sounds when you press the horn button and stops when you release it.

Note: If the horn does not sound, ensure that the wire-harness connectors are secure.

Notes:



Count on it.