



Aluminum Spindle Blower Adapter Kit

Grandstand® or Z Master® Mower

Model No. 140-4961

Installation Instructions

Installation

Loose Parts

Use the chart below to verify that all parts have been shipped.

| Description | Qty. | Use |
|-----------------------|------|---------------------------------------|
| No parts required | — | Prepare the machine. |
| Pulley assembly | 1 | Install the pulley assembly and belt. |
| Pulley-plate mount | 1 | |
| Flange nut (3/8 inch) | 3 | |

Note: Determine the left and right sides of the machine from the normal operating position.

Preparing the Machine

Perform the following procedure to prepare the machine for attaching the blower and finishing kit.

1. Disengage the PTO, move the motion-control levers to the NEUTRAL-LOCK position, and set the parking brake.
2. Shut off the engine, remove the key, and wait for all moving parts to stop before leaving the operating position.
3. Repair all bent or damaged areas of mower deck and replace any missing parts.
4. Clean the machine of any debris on the deck or rear part of the machine to ease installation.



Installing the Pulley Assembly and Belt

1. Remove the top nut, washer, and sheave from the spindle (Figure 1).

Note: Note the orientation of the sheave when you remove it from the spindle to ensure that you install it properly later in the process.

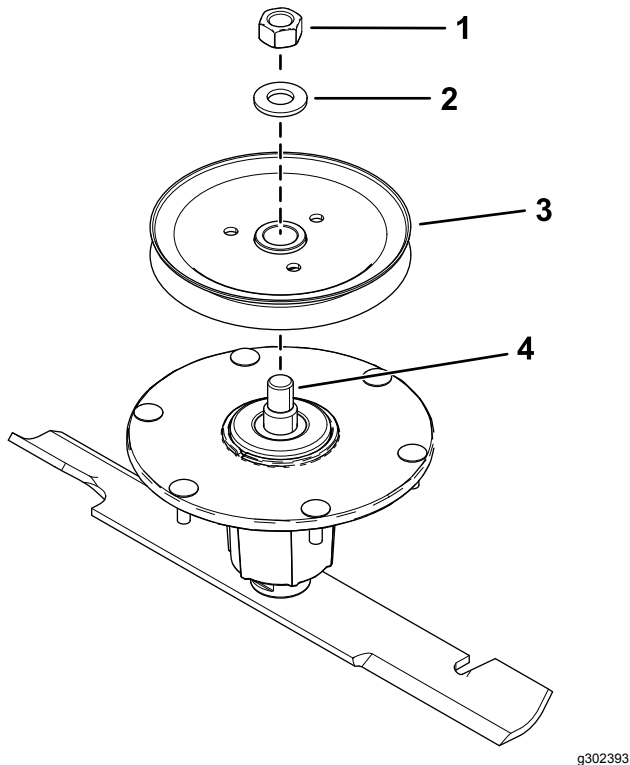

Figure 1

- | | |
|------------|------------|
| 1. Top nut | 3. Sheave |
| 2. Washer | 4. Spindle |

2. Insert the pulley-plate mount studs into the holes in the sheave (Figure 2).

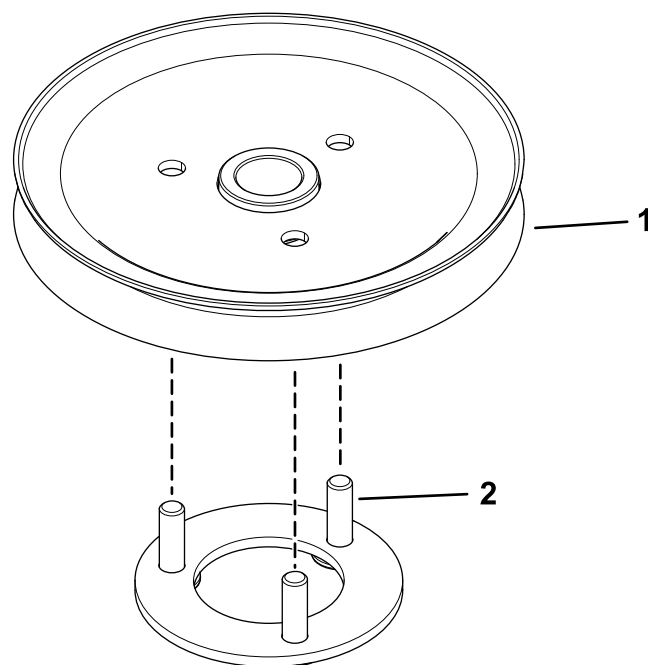

Figure 2

- | | |
|-----------|-----------------------------|
| 1. Sheave | 2. Pulley-plate mount studs |
|-----------|-----------------------------|

3. Loosely install the 3 nuts to the studs (Figure 3). Leave a clearance of 5 mm (3/16 inch) between the nut and sheave.

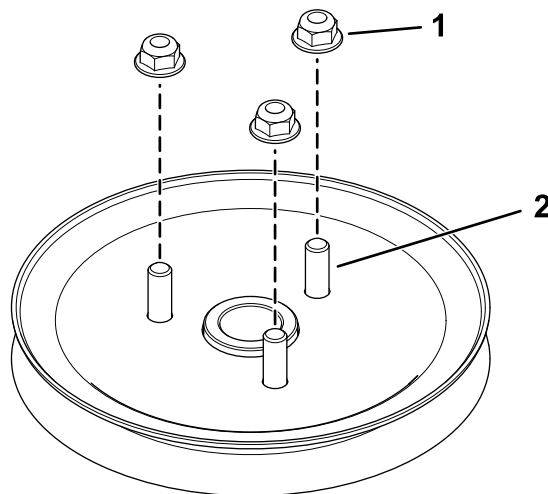

Figure 3

- | | |
|--------|---------|
| 1. Nut | 2. Stud |
|--------|---------|

4. Install the sheave assembly to the spindle using the washer and top nut (Figure 4).

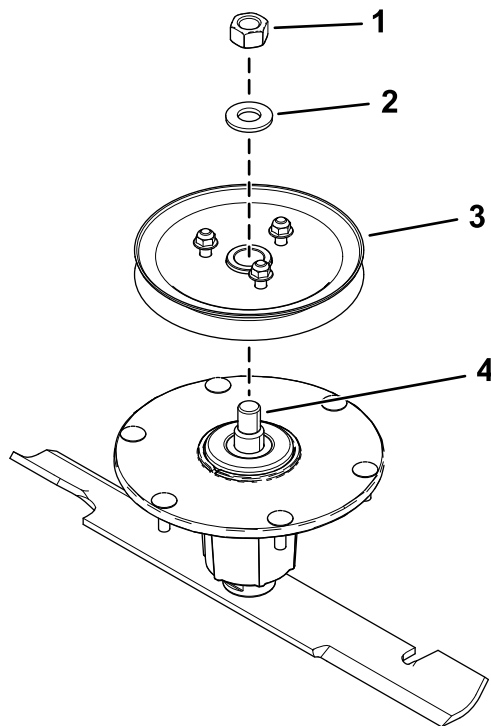

Figure 4

- | | |
|------------|--------------------|
| 1. Top nut | 3. Sheave assembly |
| 2. Washer | 4. Spindle |

5. Torque the top nut to 176 to 217 N·m (130 to 160 ft-lb).

Note: Ensure that the sheave spins freely.

6. Align the new pulley assembly so that the openings fit over the nuts (Figure 5).

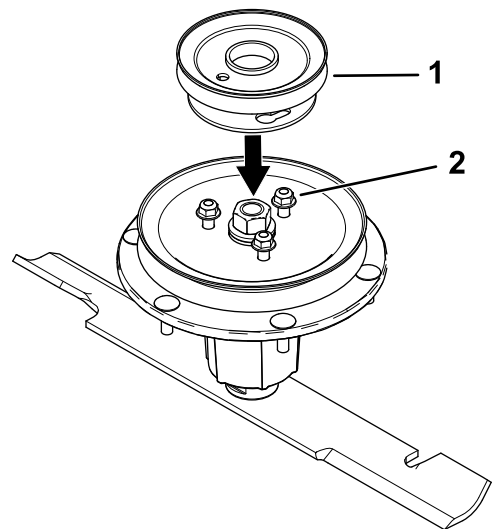

Figure 5

- | | |
|--------------------|---------|
| 1. Pulley assembly | 2. Nuts |
|--------------------|---------|

7. Turn the pulley to lock it into position (Figure 6).

Note: If the pulley does not turn, loosen the nuts more to raise the nuts and allow the pulley to lock into position.

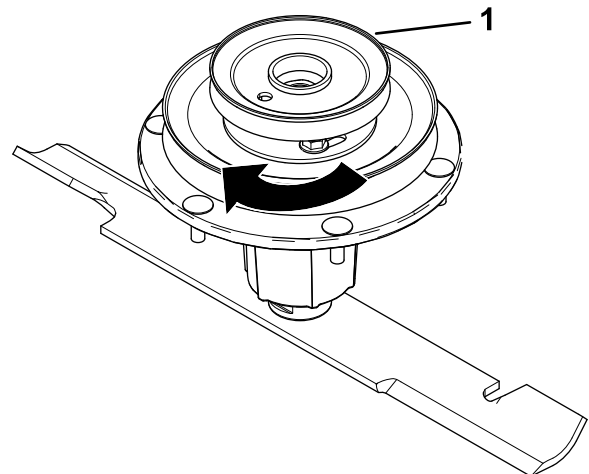

Figure 6

- | |
|--------------------|
| 1. Pulley assembly |
|--------------------|

8. After the new pulley assembly is in position, tighten the nuts to secure new pulley assembly. Torque the 3 nuts to 28 to 34 N·m (21 to 25 ft-lb).
9. Install the deck belt.



Count on it.