



# STX-38 Stump Grinder

Model No. 23212—Serial No. 313000001 and Up

Model No. 23214—Serial No. 314000001 and Up

Form No. 3436-297 Rev A

## Cleaning Guide

# Maintenance

## Pre-Maintenance Procedures

**Important:** The fasteners on the covers of this machine are designed to remain on the cover after removal. Loosen all fasteners on each cover a few turns so that the cover is loose but still attached, then go back and loosen them until the cover comes free. This prevents you from accidentally stripping the bolts free of the retainers.

## Removing the Front Cover

**Important:** The fasteners on the covers of this machine are designed to remain on the cover after removal. Loosen all fasteners on each cover a few turns so that the cover is loose but still attached, then go back and loosen them until the cover comes free. This prevents you from accidentally stripping the bolts free of the retainers.

1. Park the machine on a level surface, engage the parking brake, and lower the hydraulic lift.
2. Shut off the engine, remove the key, and allow the engine to cool.

### **⚠ WARNING**

If the machine has been running, both the cover and the muffler under the cover will be hot and can cause severe burns if you touch them.

Allow the machine to cool before removing the cover.

3. Loosen the 2 bolts securing the front cover to the machine (Figure 1).

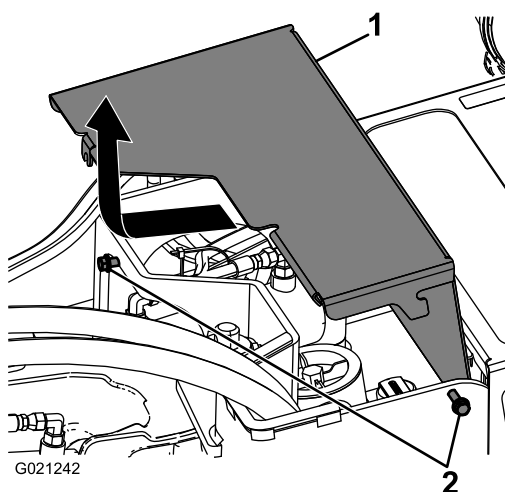

Figure 1

g021242

1. Cover

2. Bolts



4. Slide the cover forward slightly and pull up to remove the cover ([Figure 1](#)).
5. To install the front cover, slide the front cover into place and tighten the 2 bolts that you loosened previously ([Figure 1](#)).

## Removing the Muffler Cover

1. Remove the front cover; refer to [Removing the Front Cover \(page 1\)](#).
2. Remove the 4 bolts, 4 washers, and 4 nuts securing the muffler cover.

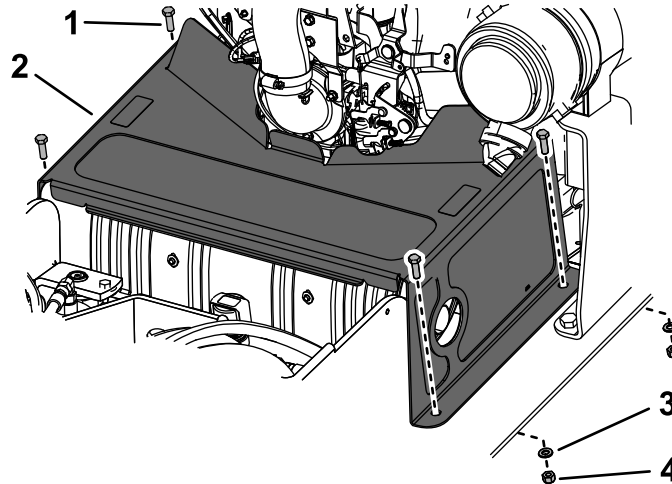

Figure 2

g250400

- |                  |               |
|------------------|---------------|
| 1. Bolt (4)      | 3. Washer (4) |
| 2. Muffler cover | 4. Nut (4)    |

3. Remove the muffler cover.

## Clearing Debris from the Machine

Wood chips and debris accumulate around the muffler and engine area when operating the stump grinder.

**Important:** It is preferable to blow dirt out, rather than washing it out. If you use water, keep it away from electrical items and hydraulic valves. Do not use a high-pressure washer. High-pressure washing can damage the electrical system and hydraulic valves or deplete grease.

## Cleaning the Machine Before and After Rental

Clean the area around the muffler to remove any wood chips or accumulated debris; refer to [Pre-Maintenance Procedures \(page 1\)](#).

## Cleaning the Machine During Rental

Refer to [Pre-Maintenance Procedures \(page 1\)](#).

Instruct the operator to monitor the machine for wood chips or debris in the muffler area.

Accumulation of wood chips or debris around the muffler area occur due to, rate of cut, type of wood, age and hardness of wood, etc.

Conditions change from one stump to another.

- Dry conditions, dull cutter teeth, and other situations produce smaller chips or sawdust.
- Windy conditions and extended periods of continuous use increase the accumulation of wood chips in the muffler area.

Instruct the operator to monitor the muffler area more frequently in these situations and to clean out accumulation of wood chips or debris more often.