



# Bucket Mount Kit

## Titan® Riding Mower

Model No. 140-2066

### Installation Instructions

# Installation

## Loose Parts

Use the chart below to verify that all parts have been shipped.

Description	Qty.	Use
No parts required	–	Prepare the machine.
Bucket-support bracket	1	Install the bucket mount kit.
Upper bucket bracket	1	
Lower bucket bracket	1	
Rubber bumper	1	
Locking pin	1	
Carriage bolt (5/16 x 7/8 inch)	1	
Handle knob	1	
Flange-head bolt (5/16 x 3/4 inch)	2	
Flange nut (5/16 inch)	2	
Spring	1	

## Preparing the Machine

1. Park the machine on a level surface.
2. Disengage the blade-control switch.
3. Engage the parking brake.
4. Move the motion-control levers outward to the NEUTRAL-LOCK position.
5. Shut off the engine and remove the key.

## Installing the Bucket Mount Kit

1. Insert the rubber bumper into the bucket-support bracket (Figure 1).

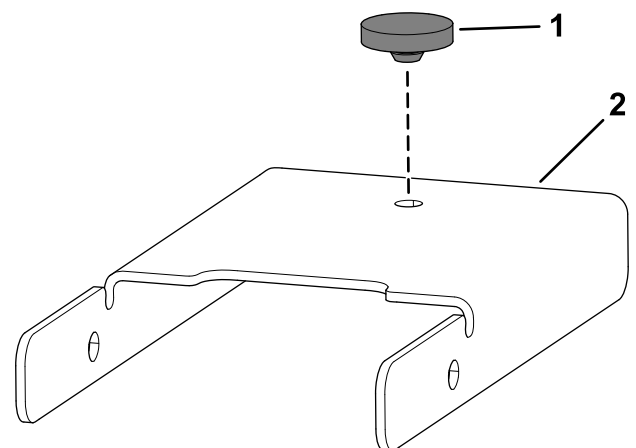

Figure 1

g307623

1. Rubber bumper
2. Bucket-support bracket



- Secure the lower bucket bracket to the bucket-support bracket using the spring and locking pin (Figure 2).

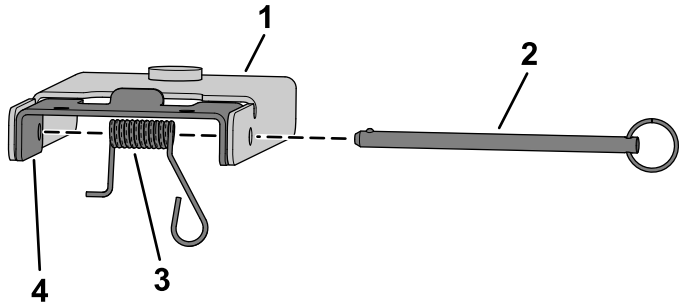

g308283

**Figure 2**

- |                           |                         |
|---------------------------|-------------------------|
| 1. Bucket-support bracket | 3. Spring               |
| 2. Locking pin            | 4. Lower bucket bracket |

- Secure the assembled lower bucket bracket and bucket-support bracket to the engine guard using 2 flange-head bolts (5/16 x 3/4 inch) and 2 flange nuts (5/16 inch) as shown in Figure 3.

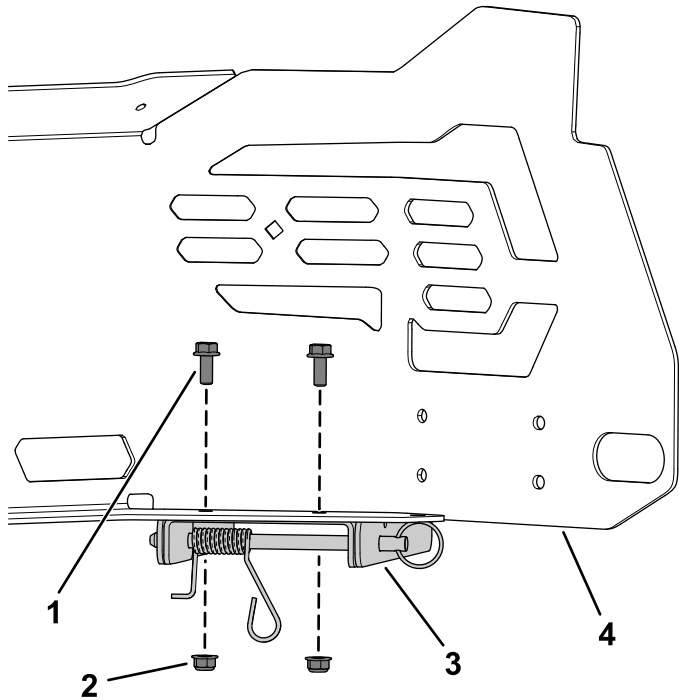

g308282

**Figure 3**

- |                                       |                      |
|---------------------------------------|----------------------|
| 1. Flange-head bolt (5/16 x 3/4 inch) | 3. Assembled bracket |
| 2. Flange nut (5/16 inch)             | 4. Engine guard      |

- Secure the upper bucket bracket to the engine guard using the carriage bolt (5/16 x 7/8 inch) and handle knob (Figure 4).

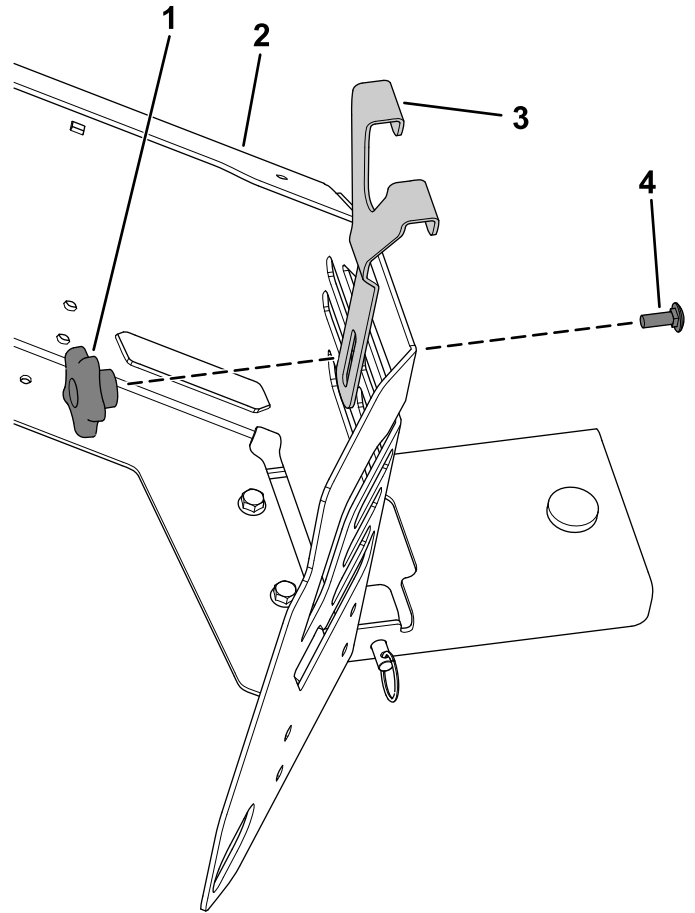

g307644

**Figure 4**

- |                 |                                    |
|-----------------|------------------------------------|
| 1. Handle knob  | 3. Upper bucket bracket            |
| 2. Engine guard | 4. Carriage bolt (5/16 x 7/8 inch) |