

TORO®**54in Fab Bagging Enhancement Kit****TimeCutter® Riding Mower**

Model No. 140-5054

Installation Instructions**⚠ WARNING****CALIFORNIA
Proposition 65 Warning**

Use of this product may cause exposure to chemicals known to the State of California to cause cancer, birth defects, or other reproductive harm.

Determine the left and right sides of the machine from the normal operating position.

Preparing the Machine

1. Park the machine on a level surface.
2. Disengage the blade-control switch.
3. Move the motion-control levers outward to the PARK position.
4. Shut off the engine and remove the key.
5. For easier access, raise the front of the machine and support it using jackstands rated for your machine.

⚠ WARNING

Mechanical or hydraulic jacks may fail to support the machine and cause serious injury.

Use jack stands when supporting the machine.

Installing the Kit

Install the left skirt, left plate, right skirt, and right plate to the mower deck using 10 bolts and 10 nuts.

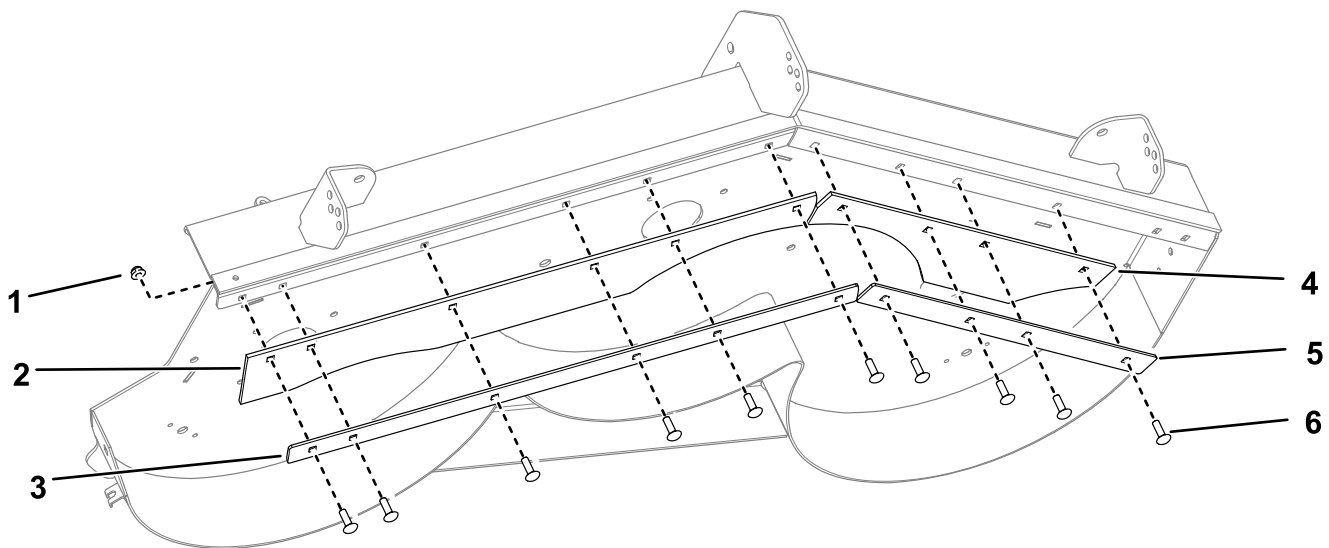

g307612

1. Nut (10)
2. Right skirt

3. Right plate
4. Left skirt

5. Left plate
6. Bolt (10)





Count on it.