



## Bed Liner Kit for Workman® Vehicles

Model No. 07331

### Installation Instructions

1. Park the vehicle on a level surface and engage the parking brake. Turn the engine off and remove the key.



### CAUTION

#### POTENTIAL HAZARD

- If you leave the key in the ignition switch, someone could start the engine.

#### WHAT CAN HAPPEN

- Accidental starting of the engine could seriously injure you or other bystanders.

#### HOW TO AVOID THE HAZARD

- Remove the key from the ignition switch before you do any maintenance.

2. Position bed liner onto bed so top of liner rests on top of side and rear panels.

**Note:** When installing bed liner onto a 2/3 flatbed, cut off liner at scribed line on bottom of liner.

**Note:** When installing bed liner onto a full area or 2/3 area flatbed equipped with Automatic Tailgate Release Kit, cut out area on bed liner as shown in Figure 1. Repeat on opposite side.

**Note:** If a stake side kit is to be installed, cut out scribed holes in under side of liner flange.

3. Using liner as a template, locate, mark and drill .288" dia. holes in top of rear and side panels.

**Note:** Holes may already be drilled in rear and side panels.

4. Secure liner to panels with capscrews, washers, spacers and flange nuts.

5. Repeat steps 3-4 and mount tailgate liner to top and front of tailgate.

**Note:** If bed dividers are to be required, use 2x4, 6 or 8 lumber cut to 50-1/2" long. Cut a 1" chamfer on each bottom corner of board to prevent damage to liner.

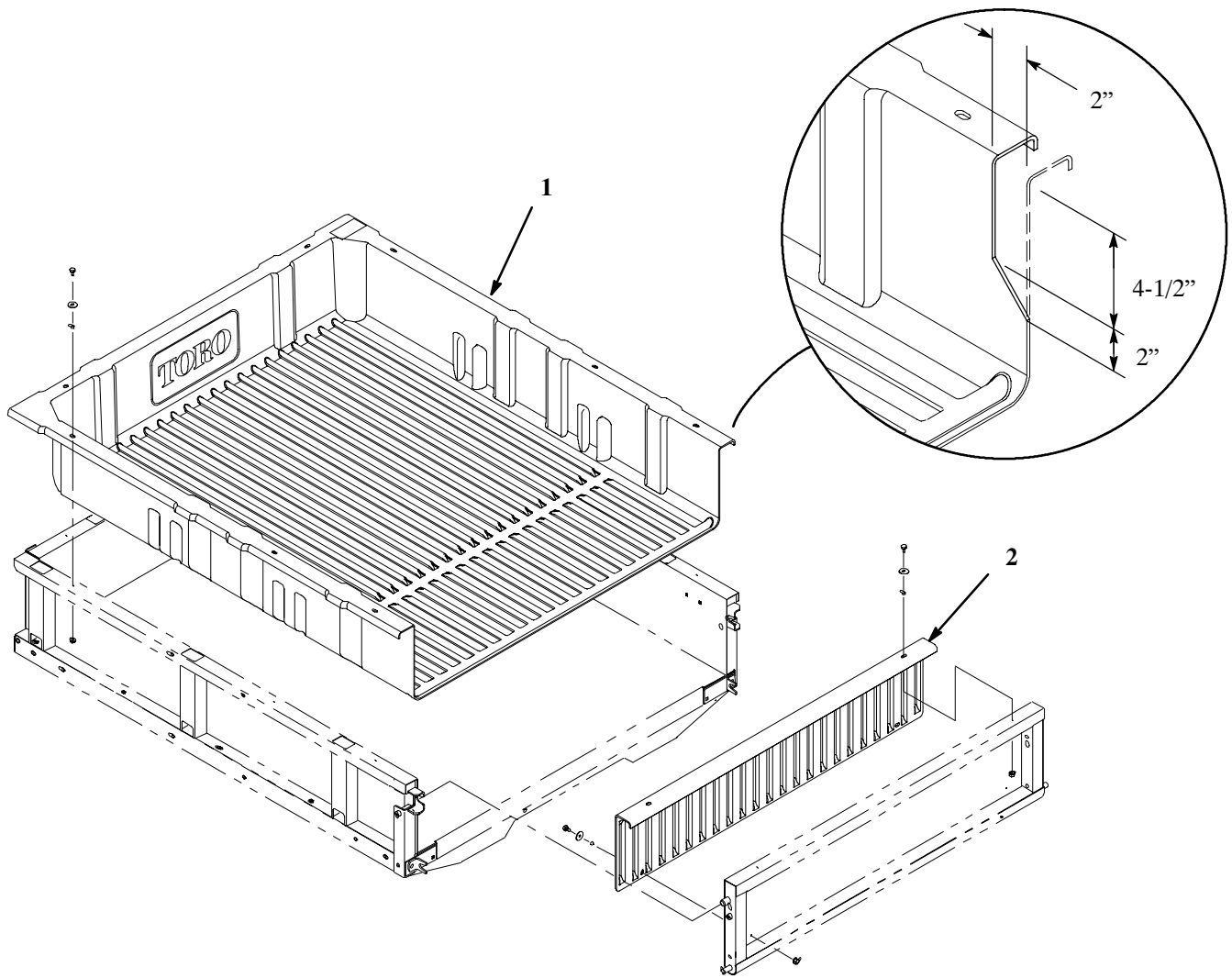

Figure 1

1. Bed liner                      2. Tailgate liner