



Mulching Kit

ProLine H800 Rotary Mower

Model No. 134-1718

Form No. 3437-543 Rev A

Installation Instructions

Note: Determine the left and right sides of the machine from the normal operating position.

Installation

1

Preparing the Machine

No Parts Required

Procedure

1. Rotate the cutting unit into the maintenance position; refer to your machine *Operator's Manual*.
2. Thoroughly clean the cutting unit. Remove all debris to ensure that the baffles fit properly against the cutting unit.

2

Removing the Existing Wing-Blade Assemblies

No Parts Required

Procedure

1. Remove the existing wing-blade assemblies; refer to the mower-deck maintenance section in your machine *Operator's Manual*.

Set aside the bolts, spring lock washers, and curved washers for the mulching-blade installation procedure.

Important: The right-blade assembly bolt has a left-handed thread. Turn the blade bolt clockwise to loosen it.

2. Save the existing wing-blade assemblies for use when you use the hopper for collection.

3

Installing the Discharge-Chute Plug

Parts needed for this procedure:

| | |
|---|----------------------|
| 1 | Discharge-chute plug |
| 1 | Bolt |
| 1 | Washer |
| 1 | Nut |

Procedure

1. Use a bolt, washer, and nut to install the discharge-chute plug over the discharge-chute opening (Figure 1).

If there is not a hole in the baffle, use the hole in the plug to drill a 9.5 mm (0.375 inch) hole in the baffle. Remove any burrs from the hole.

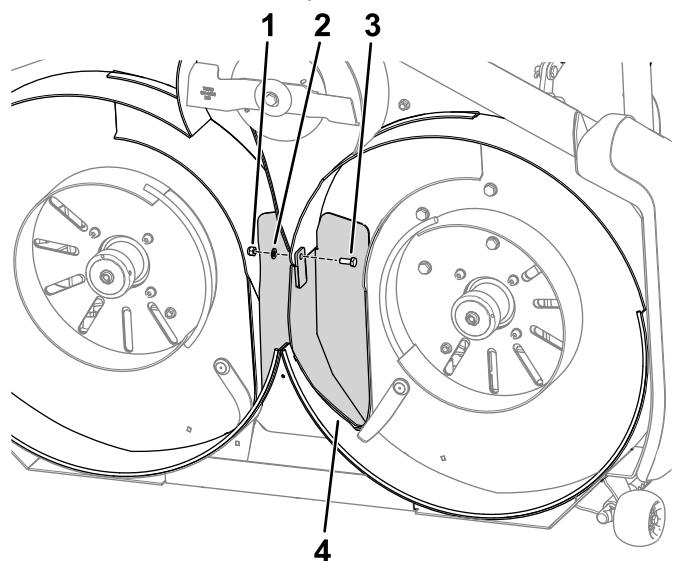

g314525

Figure 1

1. Nut
2. Washer
3. Bolt
4. Plug



2. Torque the bolt to 28 N·m (21 ft-lb).

4

Installing the Mulching Blades

Parts needed for this procedure:

| | |
|---|-----------------------------|
| 1 | Blade assembly (right side) |
| 1 | Blade assembly (left side) |
| 2 | Spacer |

Procedure

1. Hold a blade-assembly end using a cloth or a thickly-padded glove.
2. Use the previously-removed parts from the wing-blade-assembly removal procedure (bolts, spring lock washers, and curved washers) and spacers to install the blade assemblies to their respective sides ([Figure 2](#)).

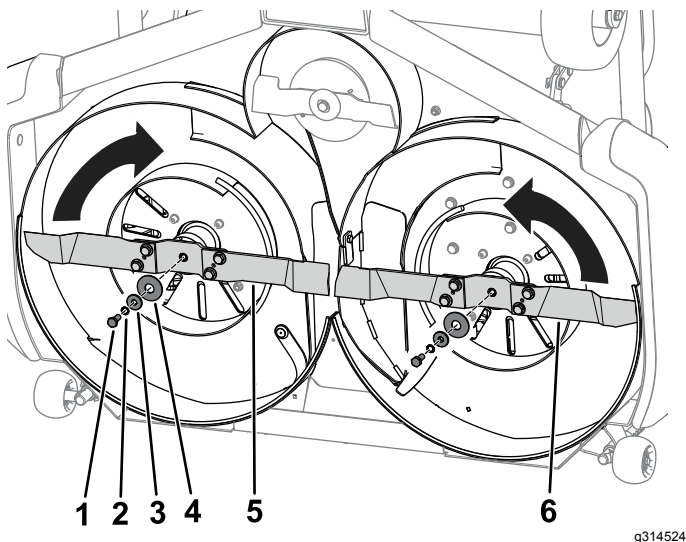

Figure 2

- | | |
|------------------|--------------------------------|
| 1. Bolt | 4. Curved washer |
| 2. Spring washer | 5. Blade assembly (right side) |
| 3. Spacer | 6. Blade assembly (left side) |

3. Torque the blade bolts to 53 N·m (39 ft-lb).

Important: The right-blade assembly bolt has a left-handed thread. Turn the blade bolt clockwise to loosen it.