



Vinyl Door

For Workman[®] 3000/4000 Series Vehicles

Model No. 07250

Parts Catalog

Ordering Replacement Parts

To order replacement parts, please supply: the part number, the quantity, and the description of each part desired.

Understanding Reference Numbers

Each identified part in an illustration has a reference number. The reference number for a part also appears in the parts list, along with other information about the part.

This catalog uses two special reference number formats, one to indicate parts in a service assembly and another to indicate the quantity of a given part in an illustration.

Service Assembly Reference Numbers

Parts in service assemblies have reference numbers in the form **a:b**. The **a** represents the reference number of the entire service assembly and the **b** represents a sequential number unique to each part within the service assembly.

For example, a wheel assembly might be identified by reference number **6**, the tire by **6:1**, the valve by **6:2**, and the wheel by **6:3**. When you order the assembly identified by reference number **6**, you receive all parts identified by reference numbers **6:1**, **6:2**, and **6:3**. However, you may also order any part individually.

Reference numbers of this type appear in illustrations and in part lists.

Reference Numbers Indicating Quantity

In an illustration, if a reference number indicates more than one part, the reference number has the form **nX y**. The **n** represents the quantity of the part, the **X** is the multiplication symbol, and the **y** represents the reference number.

For example, in an illustration, the reference number **2X 37** means that two of the parts identified by reference number **37** are indicated.

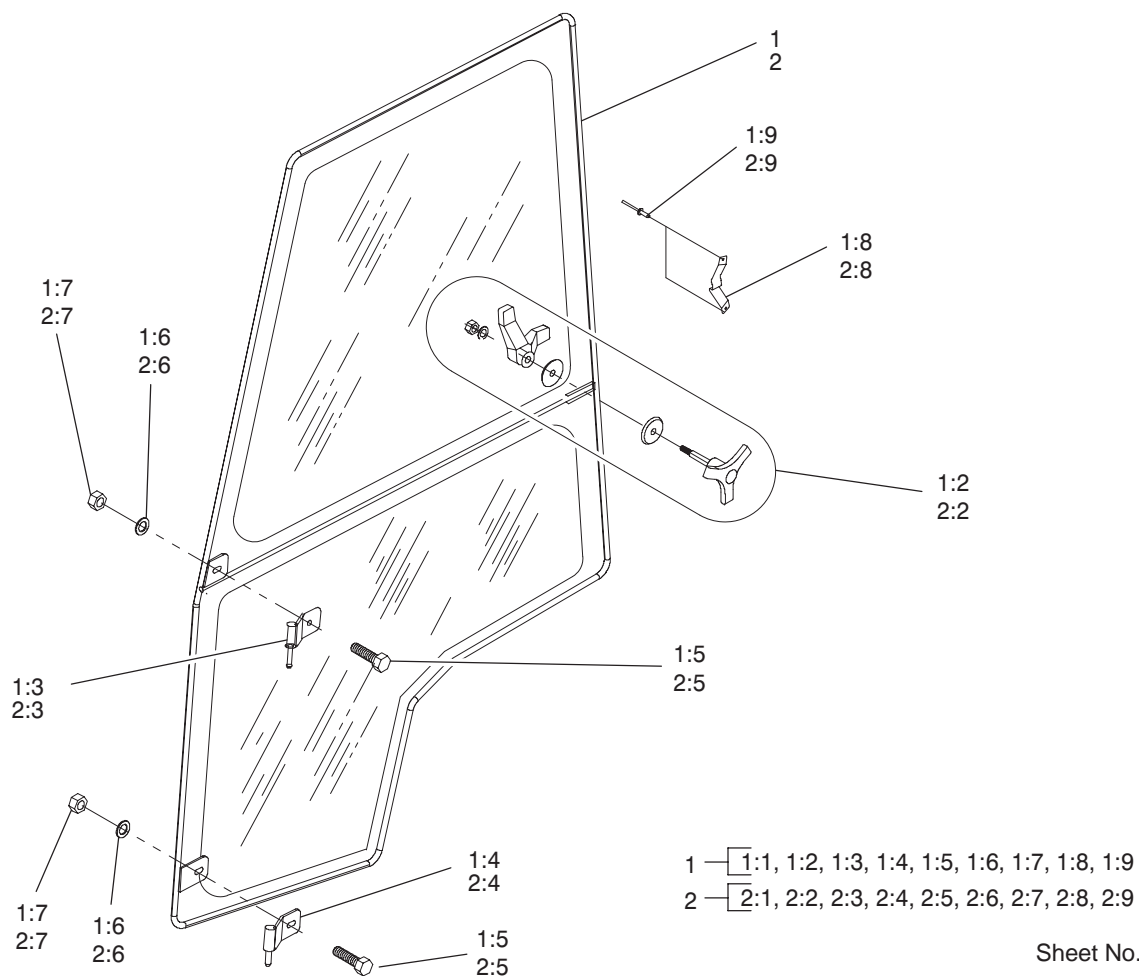

Sheet No.: 2

Vinyl Door Assembly

Ref. No.	Part No.	Qty.	Description
1	95-7359	1	Vinyl Door ASM – RH
1:1	95-7361	1	Door Frame – RH
1:2	95-7363	1	Buckle
1:3	95-7364	1	Hinge Above – RH
1:4	95-7366	1	Hinge Below – RH
1:5	66-3160	2	Screw-Cap
1:6	3256-23	2	Washer-Flat
1:7	48-9510	2	Nut
1:8	95-7368	1	Angel – RH
1:9	38-7430	2	Pop Rivot
2	95-7360	1	Vinyl Door ASM – LH
2:1	95-7362	1	Door Frame – LH
2:2	95-7363	1	Buckle
2:3	95-7365	1	Hinge Above – LH
2:4	95-7367	1	Hinge Below – LH
2:5	66-3160	2	Screw-Cap
2:6	3256-23	2	Washer-Flat
2:7	48-9510	2	Nut
2:8	95-7369	1	Angle – LH
2:9	38-7430	2	Pop Rivot

Ref. No.	Part No.	Qty.	Description