

TORO®

PART NO. 100-9920

INSTALLATION INSTRUCTIONS

REAR SCRAPER KIT For Reelmaster® 5500/6000

1. Place mower on a level surface.
 2. Remove capscrew and flange nut securing each end of rear roller to roller brackets. Discard capscrews but retain flange nuts.
 3. Mount appropriate scraper bracket (R.H. or L.H.) to each roller bracket with new capscrew and previously removed flange nut. Position brackets as shown in figure. Make sure roller is secure in roller brackets.
 4. Thread a locknut onto each end of scraper rod as shown in figure.
 5. Insert scraper rod into scraper brackets and loosely secure with locknuts as shown in figure.
 6. Adjust locknuts to attain .030"-.060" clearance between scraper bar and roller. Distance between bottom of bar and level surface should be slightly higher than height-of-cut.
 7. Assure scraper bar is parallel to roller and level surface.
- Note:** When scraper is properly installed, bottom of bar should just brush the turf.

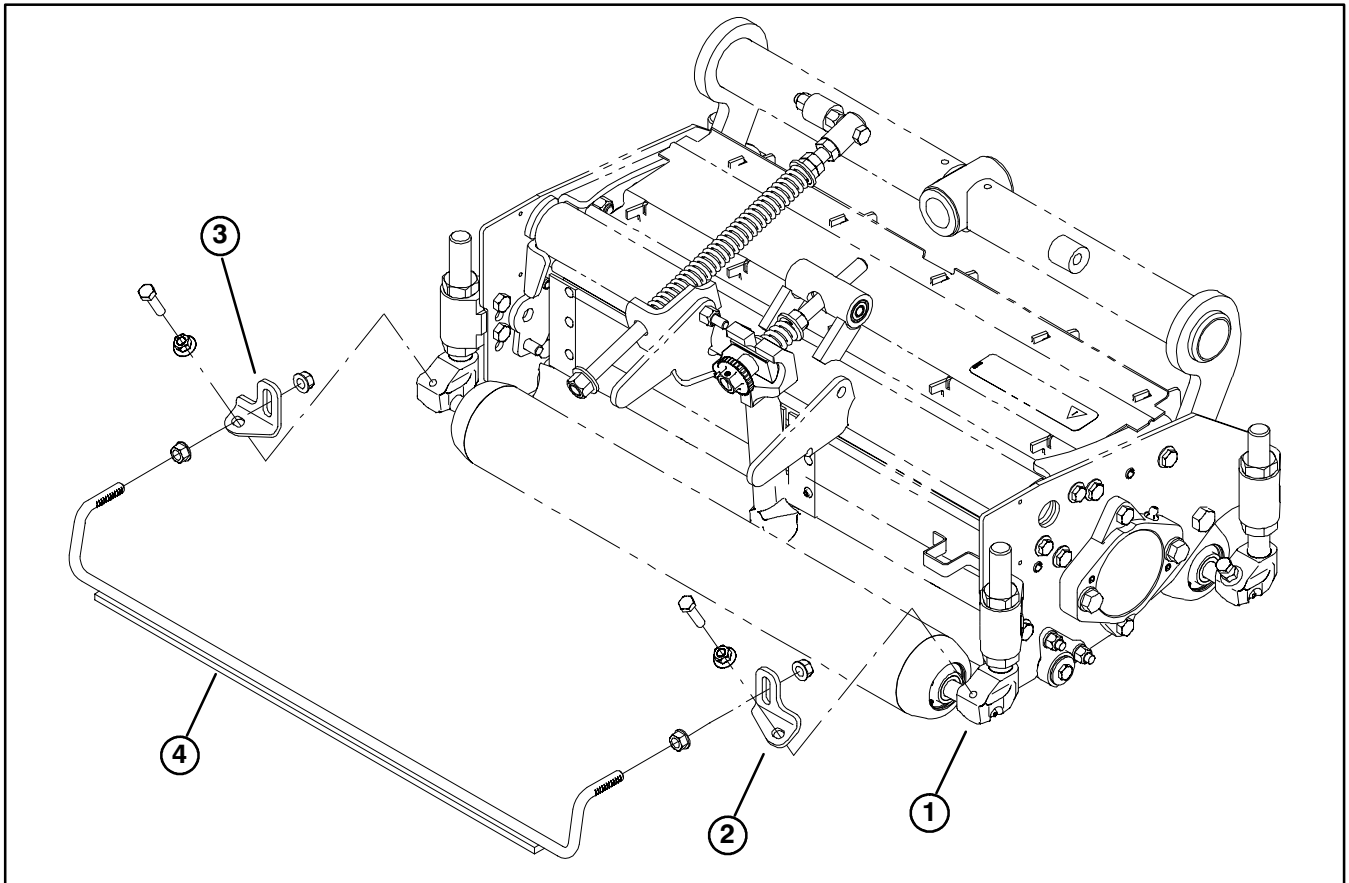

Figure 1

1. Roller bracket (R.H.)
2. Scraper bracket (R.H.)
3. Scraper bracket (L.H.)
4. Roller scraper