



# Height-of-Cut Bracket Kit

## ProLine Commercial Walk-Behind Mower

Model No. 139-4063

Form No. 3438-158 Rev A

### Installation Instructions

**Note:** Determine the left and right sides of the machine from the normal operating position.

## Safety

### Safety and Instructional Decals



Safety decals and instructions are easily visible to the operator and are located near any area of potential danger. Replace any decal that is damaged or missing.

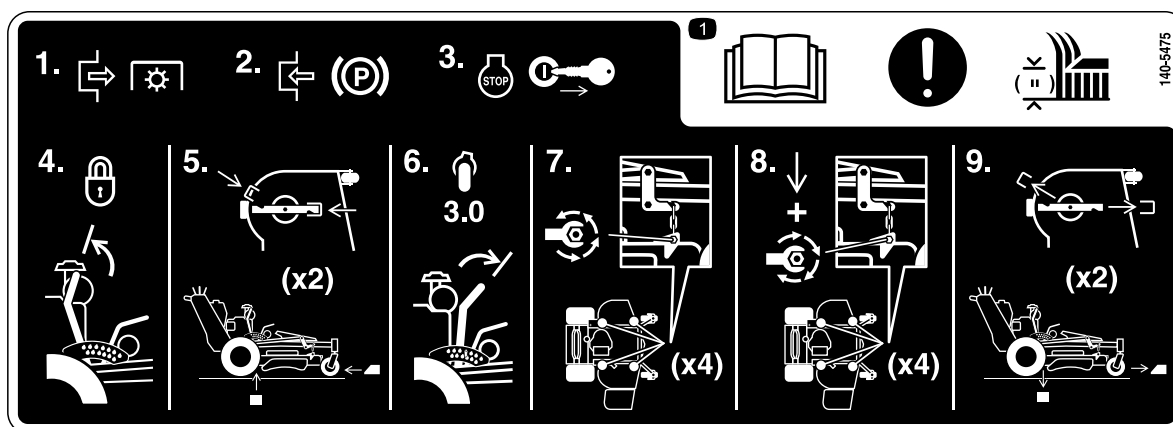

140-5475

decal140-5475

1. Attention—read the *Operator's Manual* for instructions on adjusting the height-of-cut; 1) Disengage the PTO; 2) Engage the parking brake; 3) Shut off the engine and remove the key; 4) Lock the height-of-cut lever in the transport position; 5) Install the brackets; 6) Insert the height-of-cut pin in the 76 mm (3 inch) location and lower the lever; 7) Loosen the adjustment bolts; 8) Apply downward pressure on the adjustment bolts/chains while tightening the adjustment bolts; 9) Remove the brackets.

## Installation

### Preparing the Machine

1. Park the machine on a level surface, disengage the PTO, and engage the parking brake.
2. Shut off the engine, remove the key, and wait for all moving parts to stop before leaving the operating position.
3. Check the air pressure in the rear tires; refer to the *Operator's Manual* for the machine.



# Correcting the Height of Cut

1. Move the height-of-cut lever to the TRANSPORT position ([Figure 1](#)).

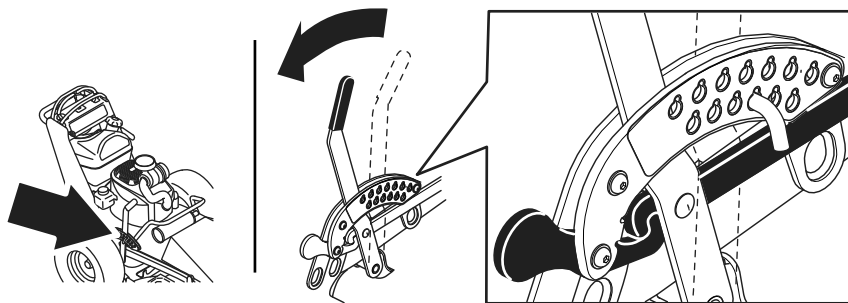

**Figure 1**

g315668

2. Rotate the blades until the ends face forward and backward.
3. Place the height-of-cut brackets below the mower deck so that the deck shell rests on the brackets when you lower the deck; refer to [Figure 2](#) and [Figure 3](#) for proper orientation.

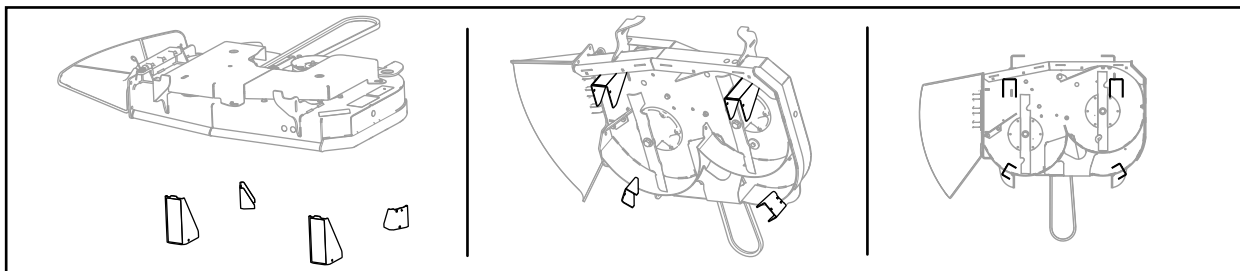

**Figure 2**

Bracket Orientation for 36-inch Decks

g315884

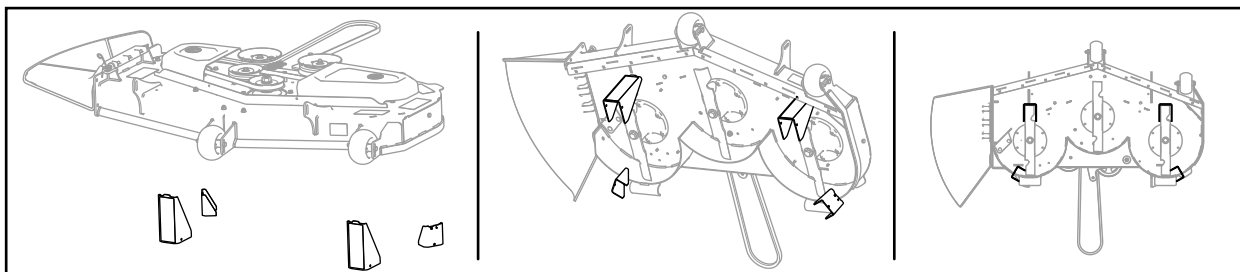

**Figure 3**

Bracket Orientation for 48-inch, 54-inch, and 60-inch Decks

g315885

4. Lower the deck onto the brackets.
5. Move the height-of-cut pin to the 76 mm (3 inch) position; refer to [Figure 4](#).

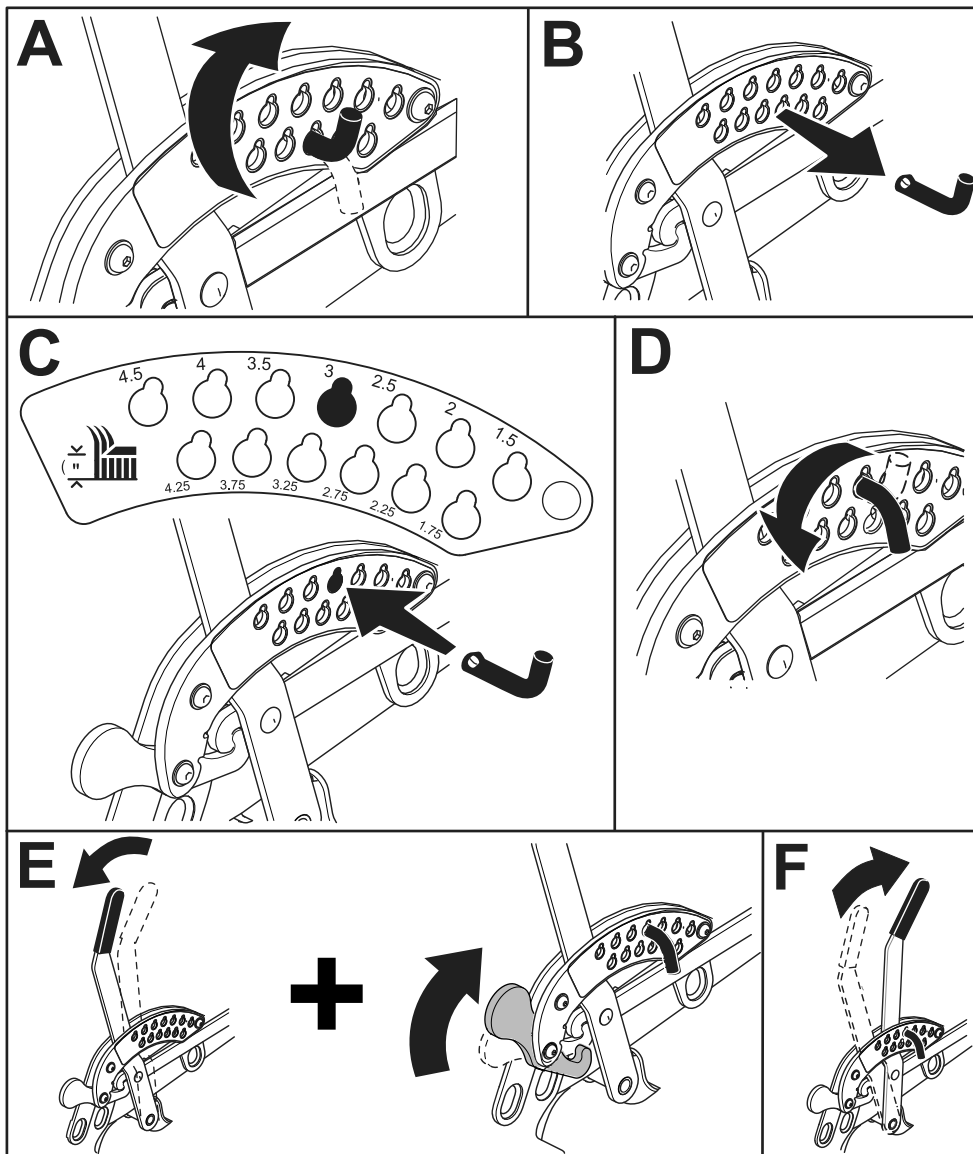
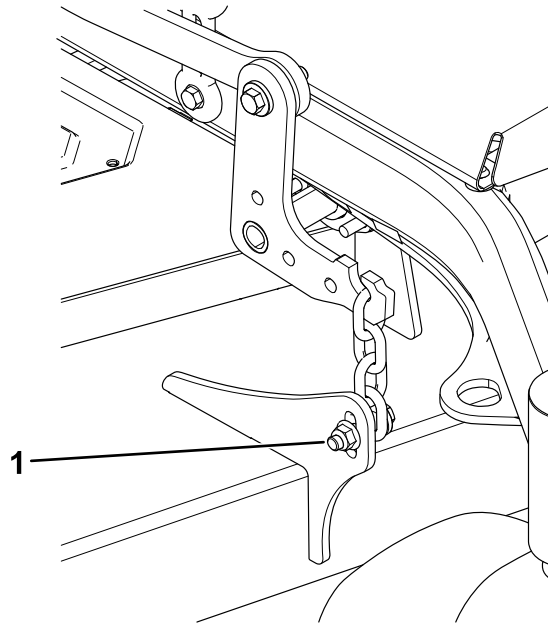

Figure 4

g315669

6. Loosen the adjustment bolts on all 4 corners of the deck so that the deck is sitting on all 4 brackets.



**Figure 5**

g300452

1. Adjustment bolt

- 
7. Verify that only the deck shell is resting on the brackets and the chains are not tight.
  8. Apply downward pressure on the adjustment bolts/chains while torquing the adjustment bolts to 37 to 44 N·m (27 to 33 ft-lb).

**Note:** Ensure that the chains remain tight after all bolts are torqued.

9. Verify that you can raise the deck to the TRANSPORT position.
10. Remove the brackets.