



Form No. 3433-937 Rev C

Count on it.

Operator's Manual

Sulky Mid-Size Mowers

Model No. 44401—Serial No. 400000000 and Up



⚠ WARNING

CALIFORNIA Proposition 65 Warning

Use of this product may cause exposure to chemicals known to the State of California to cause cancer, birth defects, or other reproductive harm.

Write the product model and serial numbers in the space below:

Model No. _____

Serial No. _____

This manual uses 2 words to highlight information. **Important** calls attention to special mechanical information and **Note** emphasizes general information worthy of special attention.

Introduction

Read this information carefully to learn how to operate and maintain your product properly and to avoid injury and product damage. You are responsible for operating the product properly and safely.

Visit www.Toro.com for product safety and operation training materials, accessory information, help finding a dealer, or to register your product.

Whenever you need service, genuine Toro parts, or additional information, contact an Authorized Service Dealer or Toro Customer Service and have the model and serial numbers of your product ready. [Figure 1](#) identifies the location of the model and serial numbers on the product. Write the numbers in the space provided.

Important: With your mobile device, you can scan the QR code on the serial number decal (if equipped) to access warranty, parts, and other product information.

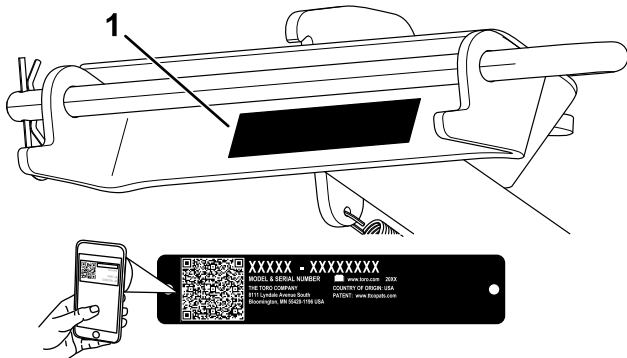

g294869

Figure 1

1. Model and serial number location

Contents

Safety	3
Safety and Instructional Decals	4
Setup	5
1 Preparing the Machine	5
2 Installing the Sulky	5
Operation	7
Using the Sulky	7
Using the Transport Position	7
Maintenance	8
Greasing the Sulky	8

Safety

- Ensure that the sulky is properly attached to the machine and is in good working order prior to use.
- Do not try to stabilize the machine by putting your foot on the ground. If you lose control of the machine, step off the sulky platform and away from the machine.
- Do not place your feet under the sulky.
- While using the sulky, do not move the machine unless you are standing with both feet on the platform and your hands are holding on to the reference bars.
- Do not operate the machine in reverse while standing on the platform. Step off the platform and allow the sulky to rotate 180 degrees around while moving the machine in reverse.
- Look behind and down before backing up to ensure that the path is clear.
- Allow only the machine operator on the platform.
- Do not allow untrained operators to use the sulky.
- Dismount and latch the sulky in the transport position when loading and unloading the machine and operating on hillsides.
- Slow down before turning. Sharp turns on any terrain may cause loss of control.
- Do not use the sulky on rough and uneven terrain.
- Ensure that you operate the sulky in areas where there are no obstacles nearby. Failure to maintain adequate distance from trees, walls, and other barriers may result in injury as the sulky backs up or turns during operation if the operator is not attentive to the surroundings. Operate the sulky only in areas where there is sufficient clearance for you to safely maneuver the sulky.
- Before performing any service, repairs, maintenance, or adjustments, do the following:
 - Park the machine on a level surface.
 - Disengage the power takeoff.
 - Engage the parking brake.
 - Shut off the engine and remove the key.
- Keep nuts and bolts tight. Keep equipment clean and in good condition.
- Use only genuine replacement parts.
- Do not modify the sulky or use it on non-approved machines.

Safety and Instructional Decals



Safety decals and instructions are easily visible to the operator and are located near any area of potential danger. Replace any decal that is damaged or missing.

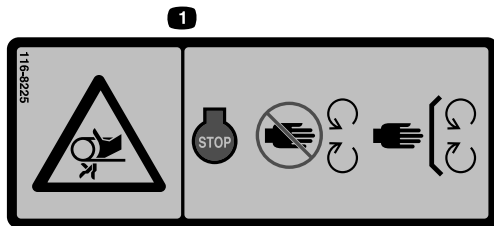

116-8225

decal116-8225

1. Entanglement hazard—Stop the engine before reaching underneath; stay away from moving parts; keep all guards in place.

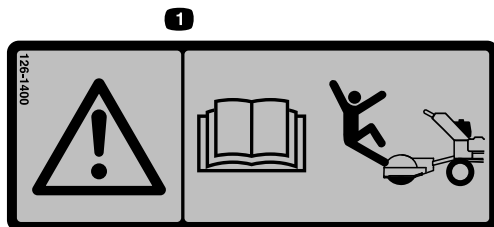

126-1400

decal126-1400

1. Warning—read the *Operator's Manual* for information about attachments; certain attachments can cause you to fall.



133-8061

decal133-8061

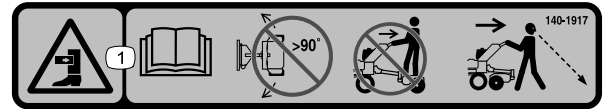

decal140-1917

140-1917

1. Crushing hazard of legs—read the *Operator's Manual*; do not turn more than 90°; do not stand on the attachment while moving in reverse; look behind you when moving in reverse.

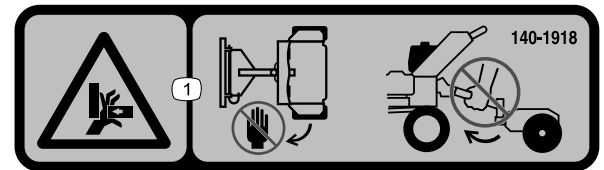

decal140-1918

140-1918

1. Crushing hazard of hands—do not insert hands between the attachment and the machine; do not hold onto the attachment rod.

Setup

Loose Parts

Use the chart below to verify that all parts have been shipped.

Procedure	Description	Qty.	Use
1	No parts required	–	Prepare the machine.
2	Mount plate Bolt Nut Pivot pin Hairpin cotter Transport pin Sulky	1 4 4 1 1 1 1	Install the sulky.

Important: A Weight Kit is required for 91 cm (36 inch) machines and is optional for other sizes. Contact your Authorized Service Dealer to obtain the kit, and install it before installing the sulky.

1

Preparing the Machine

No Parts Required

Procedure

1. Park the machine on a level surface.
2. Disengage the PTO and engage the parking brake.
3. Shut off the engine and remove the key.

2

Installing the Sulky

Parts needed for this procedure:

1	Mount plate
4	Bolt
4	Nut
1	Pivot pin
1	Hairpin cotter
1	Transport pin
1	Sulky

Procedure

1. Install the back plate to the lower rear frame of the machine using 4 bolts and 4 nuts ([Figure 2](#)).

Note: Use the lower holes in the bracket for 36-inch machines. Use the upper holes for all other machines.

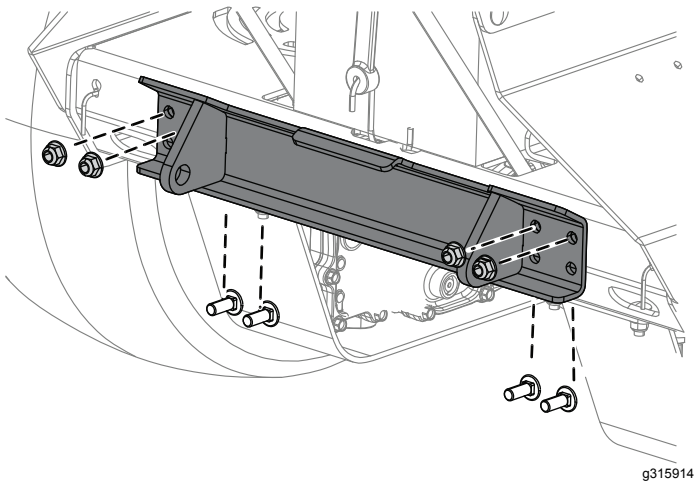

Figure 2

2. Attach the sulky to the bracket using the pivot pin and hairpin cotter (Figure 3).

Note: Ensure the J end of the pin rests on top of the plate (Figure 4).

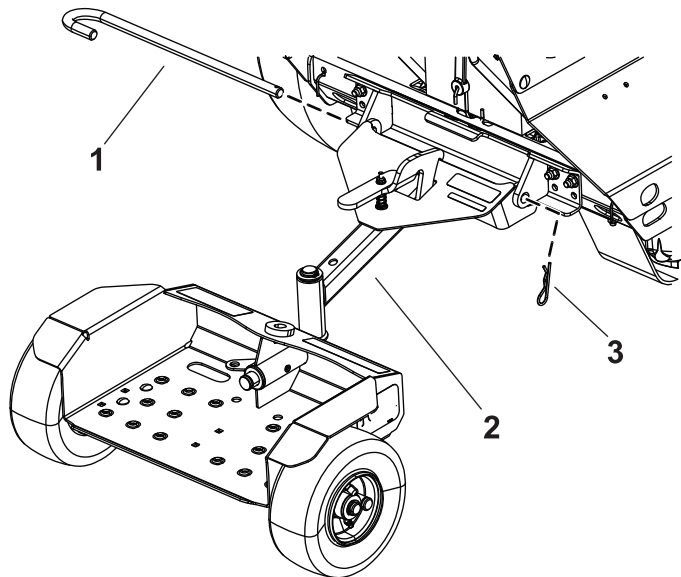

Figure 3

- | | |
|--------------|-------------------|
| 1. Pivot pin | 3. Hairpin cotter |
| 2. Sulky | |

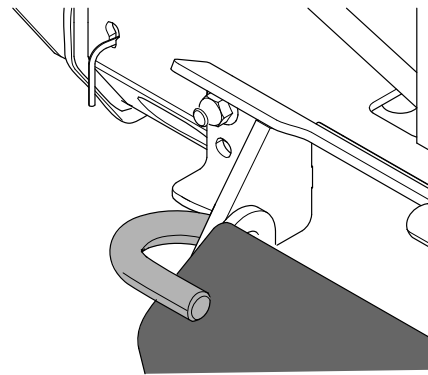

Figure 4

3. Store the transport pin in the pin plate shown in Figure 5.

Important: Do not store the transport pin in the drawbar tube while operating the machine.

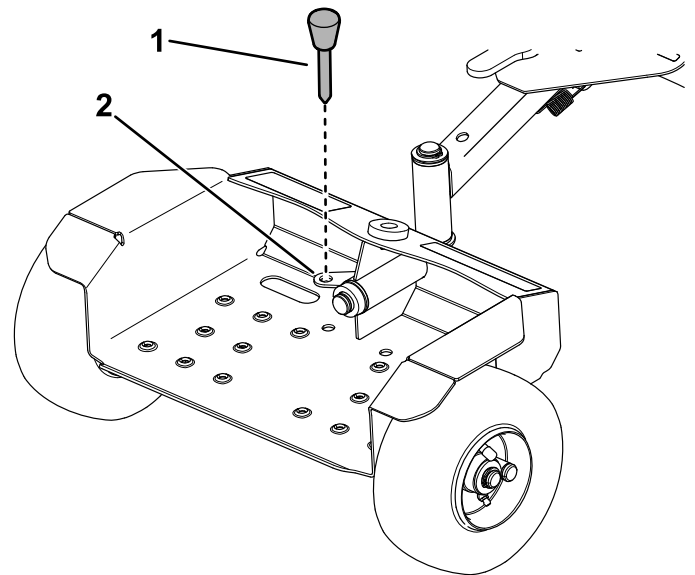

Figure 5

- | | |
|------------------|--------------|
| 1. Transport pin | 2. Pin plate |
|------------------|--------------|

Operation

⚠ WARNING

You could fall off the platform and be seriously injured during operation.

Do not move the machine forward unless you are standing with both feet on the platform and your hands are holding onto the reference bars. Step off the platform when moving the machine in reverse.

Using the Sulky

Step onto the sulky platform before starting the machine. Use the reference bars on the machine to stabilize yourself while riding on the platform.

Fully stop the machine and step off the platform before moving the machine in reverse. The sulky will rotate forward, under the drawbar, when you move the machine in reverse and rotate back to the operating position when you move the machine forward.

Using the Transport Position

1. Park the machine on a level surface, disengage the PTO, engage the parking brake, and move the motion-control levers outward to the NEUTRAL-LOCK position.
2. Shut off the engine and remove the key.
3. Remove the transport pin.
4. Rotate the platform forward and secure it using the transport pin (Figure 6).

Note: You can also move the machine in reverse to rotate the platform.

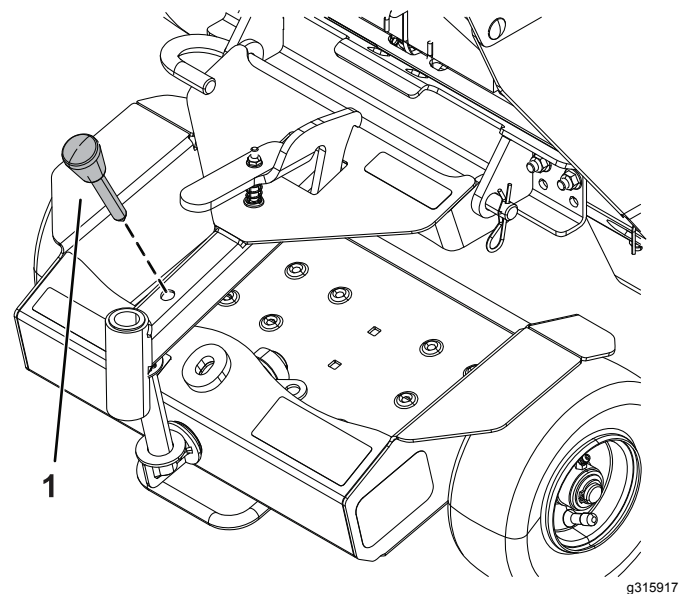

Figure 6

1. Transport pin

5. Grab the handle and raise the sulky until it latches on the bracket (Figure 6).

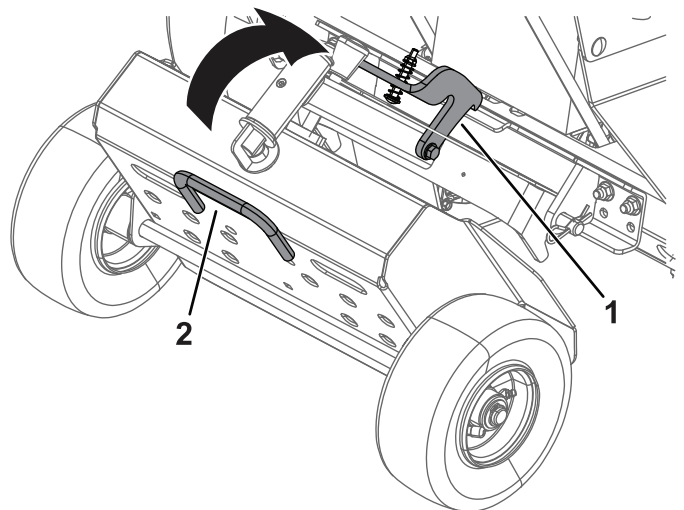

Figure 7

1. Latch
2. Handle

6. To lower the sulky, push the sulky forward, pull back on the latch, and use the handle to lower the sulky. Remove the transport pin and store it in the pin plate (Figure 5).

Maintenance

Greasing the Sulky

Service Interval: Before each use or daily—Inspect the grease fittings.

Every 40 hours—Grease the platform (grease immediately after each washing).

Grease type: General-purpose grease

1. Park the machine on a level surface, disengage the PTO, and engage the parking brake.
2. Shut off the engine and remove the key.
3. Clean the grease fittings with a rag.

Note: Make sure to scrape any paint off the front of the fitting(s).

4. Connect a grease gun to the fitting.
5. Pump grease into the fittings until grease begins to ooze out of the bearings.
6. Wipe up any excess grease.

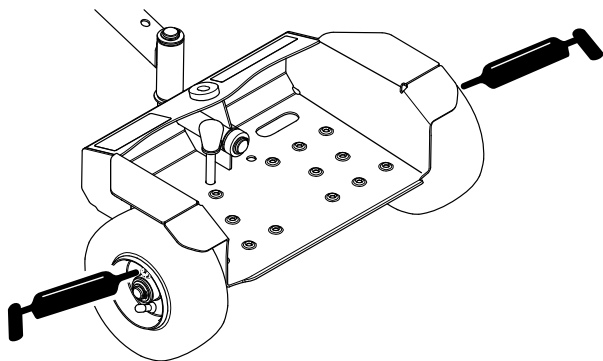

Figure 8

g295121

Notes:

Notes:

EEA/UK Privacy Notice

Toro's Use of Your Personal Information

The Toro Company ("Toro") respects your privacy. When you purchase our products, we may collect certain personal information about you, either directly from you or through your local Toro company or dealer. Toro uses this information to fulfil contractual obligations - such as to register your warranty, process your warranty claim or to contact you in the event of a product recall - and for legitimate business purposes - such as to gauge customer satisfaction, improve our products or provide you with product information which may be of interest. Toro may share your information with our subsidiaries, affiliates, dealers or other business partners in connection these activities. We may also disclose personal information when required by law or in connection with the sale, purchase or merger of a business. We will never sell your personal information to any other company for marketing purposes.

Retention of your Personal Information

Toro will keep your personal information as long as it is relevant for the above purposes and in accordance with legal requirements. For more information about applicable retention periods please contact legal@toro.com.

Toro's Commitment to Security

Your personal information may be processed in the US or another country which may have less strict data protection laws than your country of residence. Whenever we transfer your information outside of your country of residence, we will take legally required steps to ensure that appropriate safeguards are in place to protect your information and to make sure it is treated securely.

Access and Correction

You may have the right to correct or review your personal data, or object to or restrict the processing of your data. To do so, please contact us by email at legal@toro.com. If you have concerns about the way in which Toro has handled your information, we encourage you to raise this directly with us. Please note that European residents have the right to complain to your Data Protection Authority.

California Proposition 65 Warning Information

What is this warning?

You may see a product for sale that has a warning label like the following:



WARNING: Cancer and Reproductive Harm—www.p65Warnings.ca.gov.

What is Prop 65?

Prop 65 applies to any company operating in California, selling products in California, or manufacturing products that may be sold in or brought into California. It mandates that the Governor of California maintain and publish a list of chemicals known to cause cancer, birth defects, and/or other reproductive harm. The list, which is updated annually, includes hundreds of chemicals found in many everyday items. The purpose of Prop 65 is to inform the public about exposure to these chemicals.

Prop 65 does not ban the sale of products containing these chemicals but instead requires warnings on any product, product packaging, or literature with the product. Moreover, a Prop 65 warning does not mean that a product is in violation of any product safety standards or requirements. In fact, the California government has clarified that a Prop 65 warning "is not the same as a regulatory decision that a product is 'safe' or 'unsafe.'" Many of these chemicals have been used in everyday products for years without documented harm. For more information, go to <https://oag.ca.gov/prop65/faqs-view-all>.

A Prop 65 warning means that a company has either (1) evaluated the exposure and has concluded that it exceeds the "no significant risk level"; or (2) has chosen to provide a warning based on its understanding about the presence of a listed chemical without attempting to evaluate the exposure.

Does this law apply everywhere?

Prop 65 warnings are required under California law only. These warnings are seen throughout California in a wide range of settings, including but not limited to restaurants, grocery stores, hotels, schools, and hospitals, and on a wide variety of products. Additionally, some online and mail order retailers provide Prop 65 warnings on their websites or in catalogs.

How do the California warnings compare to federal limits?

Prop 65 standards are often more stringent than federal and international standards. There are various substances that require a Prop 65 warning at levels that are far lower than federal action limits. For example, the Prop 65 standard for warnings for lead is 0.5 µg/day, which is well below the federal and international standards.

Why don't all similar products carry the warning?

- Products sold in California require Prop 65 labelling while similar products sold elsewhere do not.
- A company involved in a Prop 65 lawsuit reaching a settlement may be required to use Prop 65 warnings for its products, but other companies making similar products may have no such requirement.
- The enforcement of Prop 65 is inconsistent.
- Companies may elect not to provide warnings because they conclude that they are not required to do so under Prop 65; a lack of warnings for a product does not mean that the product is free of listed chemicals at similar levels.

Why does Toro include this warning?

Toro has chosen to provide consumers with as much information as possible so that they can make informed decisions about the products they buy and use. Toro provides warnings in certain cases based on its knowledge of the presence of one or more listed chemicals without evaluating the level of exposure, as not all the listed chemicals provide exposure limit requirements. While the exposure from Toro products may be negligible or well within the "no significant risk" range, out of an abundance of caution, Toro has elected to provide the Prop 65 warnings. Moreover, if Toro does not provide these warnings, it could be sued by the State of California or by private parties seeking to enforce Prop 65 and subject to substantial penalties.