



Shredder Bar Kit

Model No. 134-4194—Serial No. 400000000 and Up

Form No. 3438-786 Rev A

Installation Instructions

Installation

Loose Parts

Use the chart below to verify that all parts have been shipped.

Procedure	Description	Qty.	Use
1	No parts required	—	Prepare the machine.
2	No parts required	—	Prepare the deck.
3	Shredder bar Carriage bolt (10 X 25 mm) Flange locknut (10 mm)	1 8 8	Install the kit.

1

Preparing the Machine

No Parts Required

Procedure

1. Park the machine on a level surface.
2. Engage the parking brake.
3. Raise the cutting unit.
4. Shut off the machine and remove the key.
5. Support the cutting unit with jack stands.

2

Preparing the Deck

No Parts Required

Procedure

1. Clean the top of the deck as shown in [Figure 1](#).

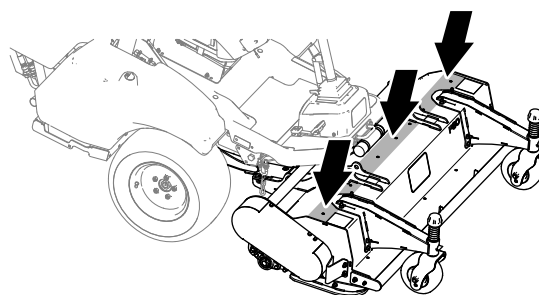

g317984

Figure 1

2. Clean the bottom of the deck as shown in [Figure 2](#).



3

Installing the Kit

Parts needed for this procedure:

1	Shredder bar
8	Carriage bolt (10 X 25 mm)
8	Flange locknut (10 mm)

Procedure

1. At the bottom of the deck, align the holes in the shredder bar to the holes in the deck ([Figure 4](#)).

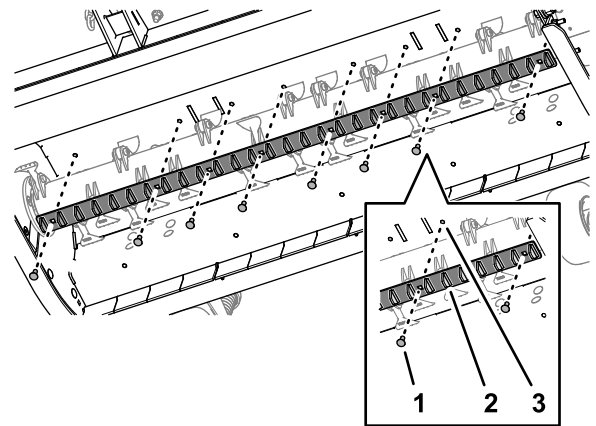
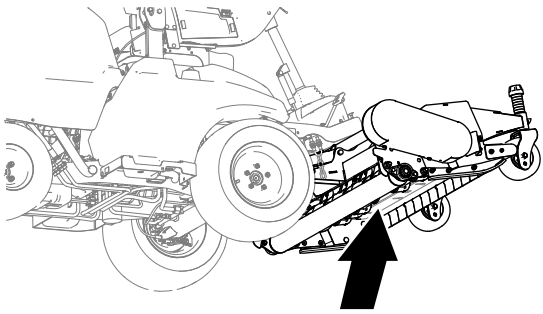

Figure 4

1. Carriage bolt
2. Fin (shredder bar)
3. Hole (bottom of the deck)

2. Loosely assemble the shredder bar to the deck ([Figure 4](#) and [Figure 5](#)) with a carriage bolt (10 X 25 mm) and flange locknut (10 mm).



g317987

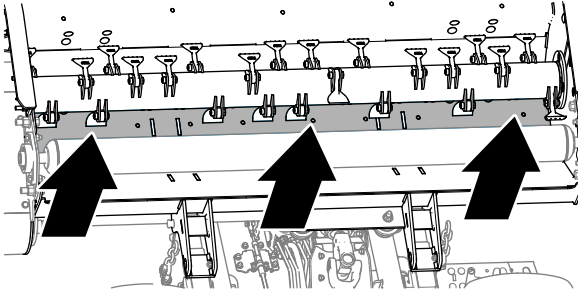

g317982

Figure 2

3. Identify the 8 knock-out plugs at the top of the deck ([Figure 3](#)).

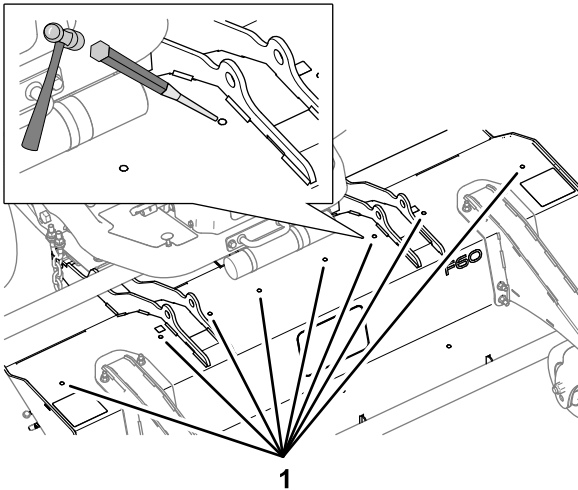

g318546

Figure 3

1. Knock-out holes

4. Use a punch and hammer to remove the 8 knock-out plugs from the deck top ([Figure 3](#)).
5. Use a file to remove burrs from the holes where you removed the knock-out plugs from the flange.

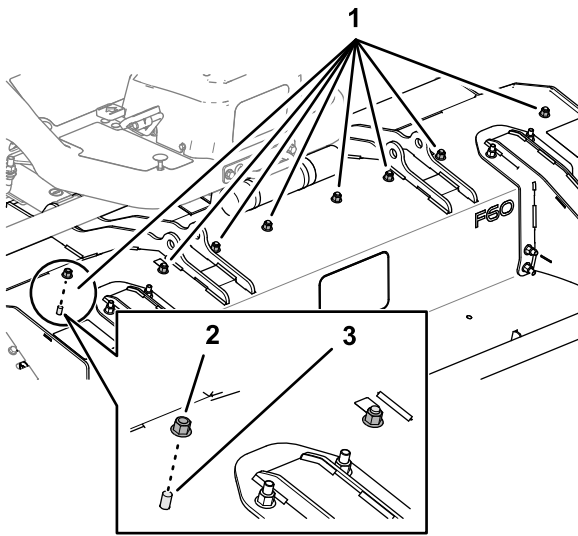

g318183

Figure 5

1. Carriage bolts and flange locknuts
 2. Flange locknut
 3. Carriage bolt locknuts
-
3. Assemble the other carriage bolts (10 X 25 mm) and flange locknuts (10 mm) to the holes in the fine cut baffle and deck.
 4. Torque the flange locknuts to 47 to 57 N·m (34 to 42 ft-lb).



Count on it.