

Attach-a-Matic® Kit	
Part No. 100-8716 Part No. TR100D8716	INSTALLATION INSTRUCTIONS

Loose Parts

**Note:** Use the chart below to identify parts for assembly.

DESCRIPTION	QTY.	USE
Attach-a-Matic®	1	Install Attach-a-Matic®
Bolts	4	
Nuts	4	

Installing Attach-a-Matic®

1. Remove the E-ring and all washers from the front axle pivot pin (Fig. 1). Remove muffler shield.
2. Install (4) 3/8 x 1" carriage bolts into the keyhole slots in the axle bracket. (Fig. 1).
3. Install the muffler shield and place the front hitch onto the tractor, securing it with (4) 3/8" locknuts (Fig. 1).
4. Reinstall enough washers to fill the space between hitch and E-ring groove. Install E-ring (Fig. 1).

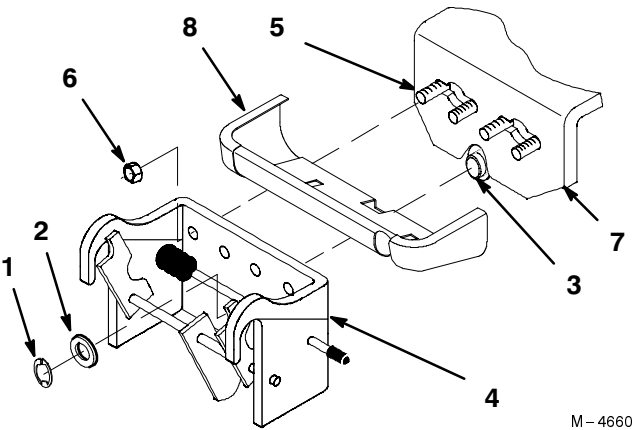

Figure 1

- |                 |                                       |
|-----------------|---------------------------------------|
| 1. E-ring       | 5. Carriage bolt 3/8 x 1" (installed) |
| 2. Thick Washer | 6. Locknut 3/8"                       |
| 3. Axle pivot   | 7. Front of Tractor                   |
| 4. Front hitch  | 8. Muffler Guard                      |