



## Windrower Attachment ProCore Aerators

MODEL NO. 09731  
MODEL NO. 09732

### INSTALLATION INSTRUCTIONS

1. Park the tractor on a level surface and engage the parking brake.
2. Raise the aerator off of the ground and install the safety stand at the rear of the aerator. (Refer to the Aerator Operator's Manual.) Lower the aerator until the safety stand contacts the ground.
3. Ensure that the PTO is disengaged. Turn the engine off and remove the key.

**Note:** If mounting attachment on a Model 09697, 09698 or 09699 aerator, proceed to step 6.

4. Remove (2) bolts, flat washers and lock washers securing the two outboard Rotalink assemblies to rear of aerator frame (Fig. 1). Discard bolt but retain washers.

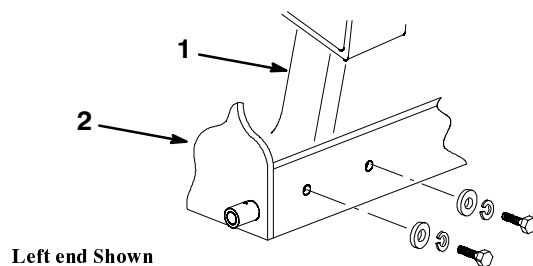

**Figure 1**

1. Rotalink arm assy.      2. Aerator frame

5. Mount the appropriate R.H. or L.H. support bracket to rear of aerator with (2) new longer bolts and washers removed. Brackets to be positioned downward and in middle of slots as shown in figure 2.

**Note:** When operating windrower on undulating terrain, float may be increased by moving support brackets

down in mounting slots. Increasing float will decrease ground clearance when aerator is lifted off ground.

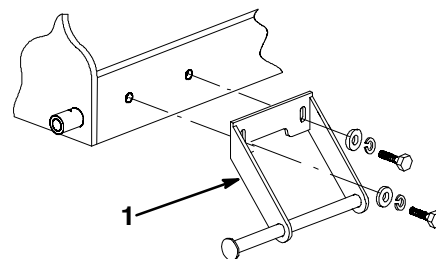

**Figure 2**

1. L.H. Support bracket

6. With the small holes toward the tractor, mount the blades to the arm assemblies with (2) M12 x 90mm screws, (4) M12 washers, (2) spacers and (2) M12 locknuts (Fig. 3). Tighten nuts securely. Blade should move freely on spacer

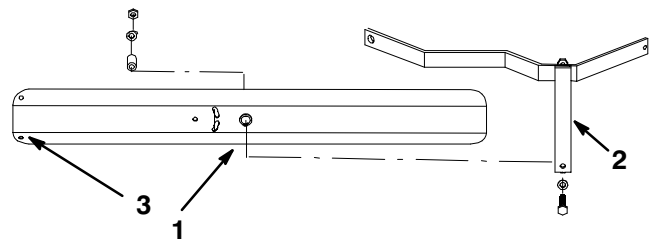

**Figure 3**

1. Blade      3. Small hole  
2. Arm assembly

**Use step 7 only on Windrower Attachments built prior to year 2000**

7. With the small holes toward the tractor, mount the blades to the arm assemblies with (2) M12 x 45mm screws, (6) M12 washers, and (2) M12

locknuts (Fig. 4). Do not over-tighten to ensure that the blade moves freely while following ground contours.

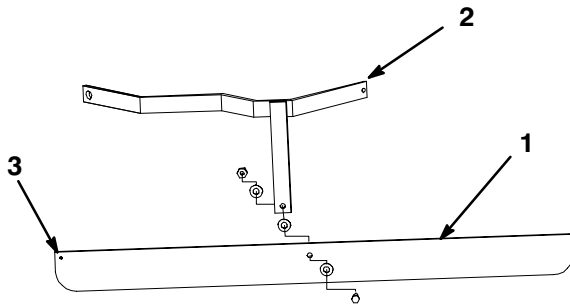

**Figure 4**

- 1. Blade
- 2. Arm assembly
- 3. Small holes

8. Using hole and top slot in each blade, mount a stop with (2) capscrews and flat washers (Fig. 5). Stop to be positioned in highest part of slot.

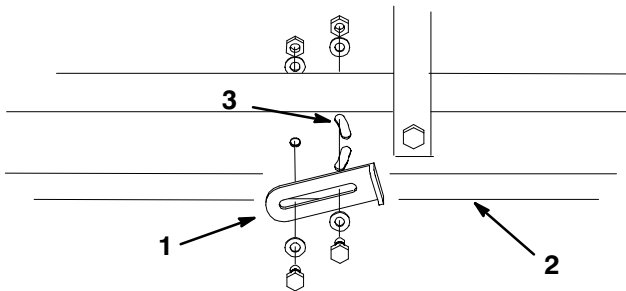
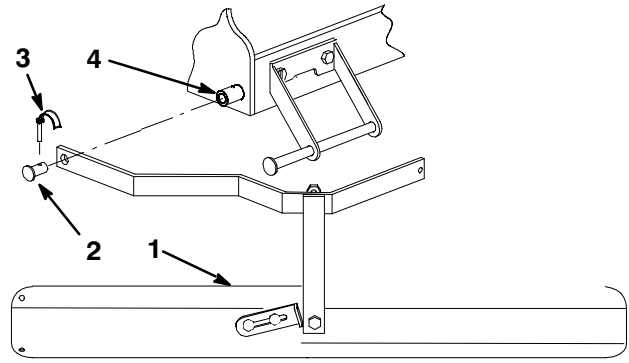

**Figure 5**

- 1. Stop
- 2. Blade
- 3. Upper slot

**Note:** The stop prevents the blade from rotating too far when lifting the aerator off the ground. To adjust stop, rotate it in the slot.

9. Secure the arm assemblies to the aerator frame with (2) pins. Slide the locking pins into the frame tubes and close the locking clip (Fig. 6).



**Figure 6**

- 1. Blade
- 2. Pin
- 3. Locking pin
- 4. Frame tube

10. Attach the chain to the arm assemblies with (2) M10 x 35mm screws, (4) M10 washers, and (2) M10 locknuts (Fig. 7).

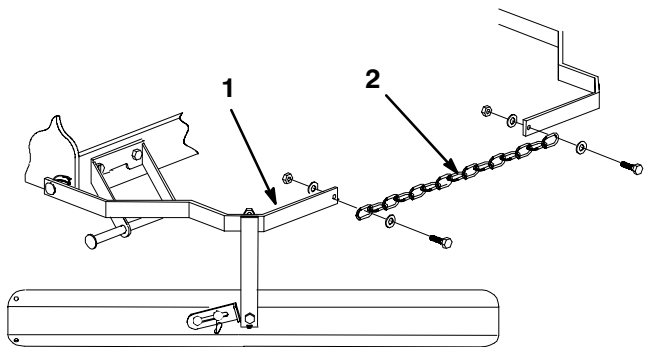

**Figure 7**

- 1. Arm assembly
- 2. Chain