



17-44 HXL Wheel Horse® Lawn Tractor

Model No. 71228—210000001 & Up

Setup Instructions

Loose Parts

Note: Use the chart below to verify all parts have been shipped.

DESCRIPTION	QTY.	USE
Bolt 1/4-20 x 3/4"	2	Install battery cables.
Wing nut	2	
Grass Deflector	1	Install grass deflector.
Spring	2	
Bolt 3/8-24 x 3-1/2"	2	
Lock nut 3/8"	2	
Spring Hook	1	Used to install lift assist spring.
Key	2	Use in ignition and KeyChoice™ switches
Washout Port Adapter	1	Use when washing underside of mower
Operator's Manual	1	Read and watch before operating tractor.
Engine Operator's Manual	1	
Safety Booklet	1	
Safety Video	1	
Registration Card	1	Fill out and mail the card.

Check Tire Pressure

Check the front and rear tires for proper inflation. Refer to the Operator's Manual Maintenance section under Tire Pressure for recommended inflation pressure.

Activate the Battery

1. Remove the battery and battery box from the tractor; refer to the Operator's Manual, Removing the Battery.
2. Remove the vent caps from the battery (Fig. 1).
3. Slowly pour electrolyte into each cell until the electrolyte level is up to the bottom of the vent wells (Fig. 1).

DANGER

POTENTIAL HAZARD

- Battery electrolyte contains sulfuric acid which is a deadly poison and it causes severe burns.

WHAT CAN HAPPEN

- If you carelessly drink electrolyte you could die or if it gets onto your skin you will be burned.

HOW TO AVOID THE HAZARD

- Do not drink electrolyte and avoid contact with skin, eyes or clothing. Wear safety glasses to shield your eyes and rubber gloves to protect your hands.
- Fill the battery where clean water is always available for flushing the skin.
- Follow all instructions and comply with all safety messages on the electrolyte container.

4. Wait five to ten minutes after filling the battery cells. Add electrolyte, if necessary, until the electrolyte level is back up to the bottom of the vent wells.

IMPORTANT: Do not overfill the battery because electrolyte (sulfuric acid) can cause severe corrosion and damage to the chassis.

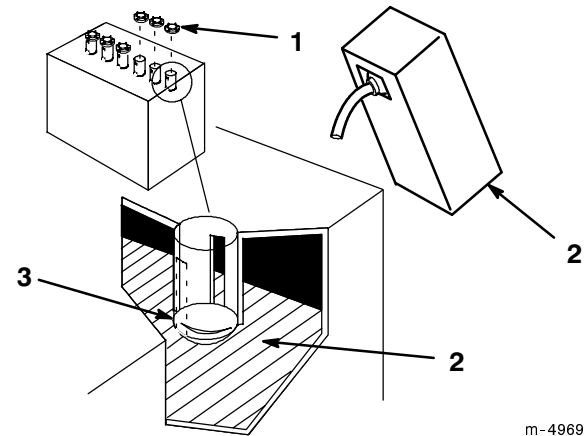

m-4969

Figure 1

1. Vent caps
2. Electrolyte
3. Bottom of vent well

5. Reinstall the battery vent caps.
6. Connect a battery charger to the battery posts. Charge the battery for 10 to 15 minutes at 25-30 amps or 30 minutes at 4-6 amps. Do not overcharge the battery.

WARNING

POTENTIAL HAZARD

- Charging the battery produces gasses.

WHAT CAN HAPPEN

- Battery gasses can explode.

HOW TO AVOID THE HAZARD

- Keep cigarettes, sparks and flames away from battery.

7. When the battery is fully charged, unplug the charger from the electrical outlet, then disconnect the charger leads from the battery posts.
8. Install the battery in the tractor; refer to the Operator's Manual, Installing the Battery.

Check Oil Level

The tractor is shipped from the factory with oil in the engine crankcase; however, it may be necessary to add oil. Refer to the Operator's Manual, Engine Oil Specifications for oil type, viscosity, and crankcase capacity. Add only enough oil to raise the level to the "FULL" mark on the dipstick.

Attach the Discharge Chute

1. Place the springs into the brackets on the mower with the hooked ends over the raised back (Fig. 2).
2. Align the grass deflector with the holes in the brackets and the spring straight ends in the space under the hinge and above the deflector (Fig. 2).

3. Secure the deflector to the bracket with bolts through grass deflector, springs, and brackets. Secure with lock nuts (Fig. 2).

Note: It may be helpful to press down near the end of the bolt with a 9/16" open end wrench to align the bolt with the second holes on the bracket and grass deflector.

4. Lift the grass deflector and check that it is spring loaded and pivots freely to the full down position.

IMPORTANT: The grass deflector must be spring loaded in the down position. Lift the deflector up to test that it snaps to the full down position.

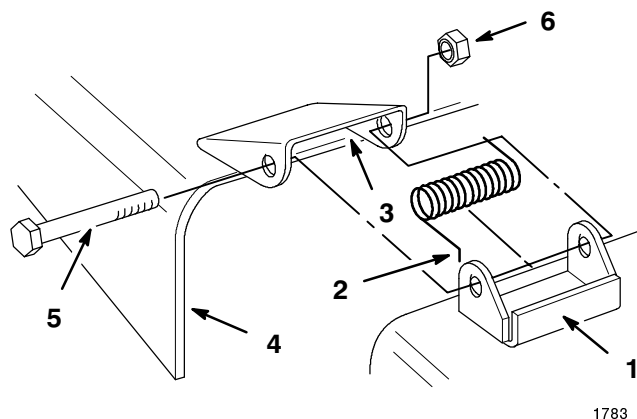

Figure 2

- | | |
|---------------------|--------------------|
| 1. Bracket | 4. Grass deflector |
| 2. Spring hook end | 5. Bolt |
| 3. Space for spring | 6. Lock nut |

Check the Mower Adjustment

The mower deck was leveled at the factory. If the mower is not cutting level, adjust the side-to-side level and front-to-rear blade slope. See the Operator's Manual for the proper procedure.

Lubrication

Make sure all of the necessary points on the tractor are lubricated; refer to Greasing and Lubrication in the Operator's Manual.

Read the Operator's Manual

Read the Operation section of the Operator's Manual before operating the tractor.

Check Safety System

Refer to the Operator's Manual, Testing the Safety System.

Purge the Hydro Transaxle

During shipping and handling air can be introduced into the hydro transaxle. To achieve proper performance, all trapped air must be removed.

1. Place the tractor on a flat level surface.
2. Place the drive control in the “Push” position (Fig. 3).

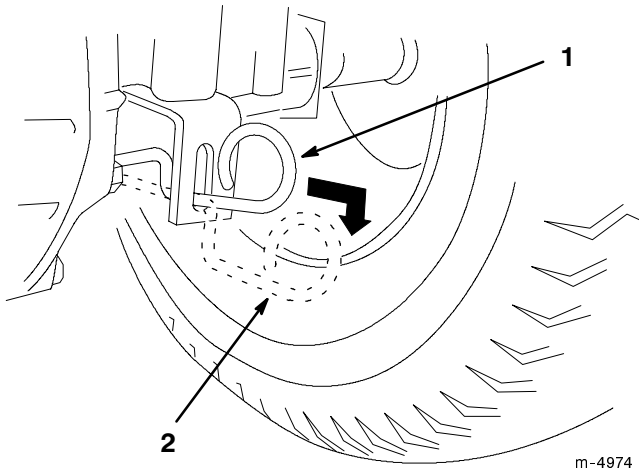

Figure 3

1. Operate position 2. Push position

3. Run the engine at a low idle and move the traction control pedal forward for five (5) seconds then reverse for five (5) seconds. Repeat three (3) times.
4. Place the drive control in the “Operate” position (Fig. 3). Drive the tractor forward then reverse approximately five (5) feet. Repeat three (3) times.

Check the Hydro Neutral Position

Ensure the neutral position is set properly. Adjustment is required if the tractor creeps (moves) without the traction control pedal being depressed.

1. Run the engine at a low idle and move the traction control pedal forward, then release. Move traction control pedal reverse, then release. If the tractor creeps adjust as follows:
2. With the engine off, raise the rear wheels off the ground and support them with jackstands.

Note: To gain access to the adjusting puck (Fig. 4), it may be necessary to remove the tire.

3. Loosen the adjusting puck screw (Fig. 4). Rotate the puck 5 degrees in the opposite direction the wheels rotate. Tighten the screw and torque to 250 to 320 in-lb.
4. Repeat steps 1 through 3 until the tractor no longer creeps.

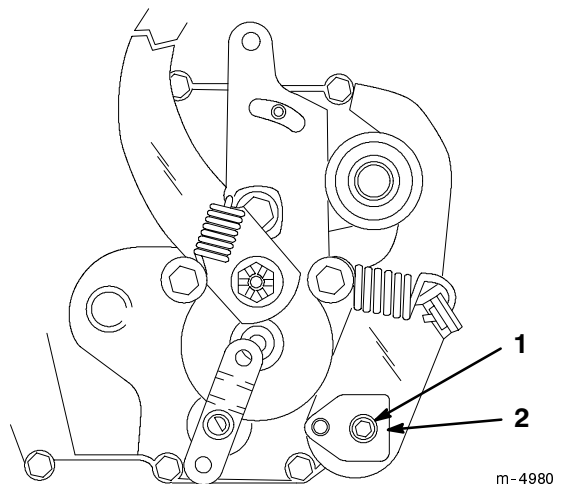

Figure 4

1. Adjusting puck screw 2. Adjusting puck

Check the Traction Control Pedal

The traction control pedal can be adjusted for optimum forward and reverse speeds.

1. Loosen the capscrews below the right footrest. Slide the pedal forward for faster reverse speed or backward for faster forward speed (Fig. 5).
2. Tighten the capscrews and recheck the traction control pedal.

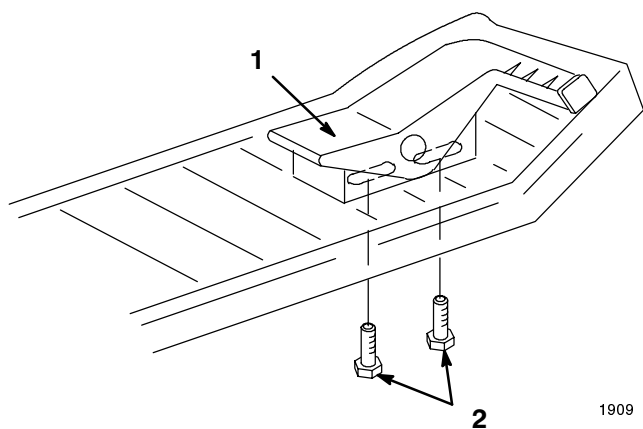

Figure 5

1. Traction control pedal

2. Adjusting capscrews

Test Drive the Tractor

Make sure all electrical and mechanical systems are operating properly. See the Operator's Manual for proper control function.

