

TORO®

PART NO. 87-5420
PART NO. 87-5430

INSTALLATION INSTRUCTIONS

23" & 24" REAR FENDER KITS For Workman 3000 & 4000 Series

NOTE: If vehicle is equipped with optional 24" tires, make sure correct fender kit is being installed.

1. Jack up rear of vehicle and remove both rear tires (see Operator's Manual for jacking procedure).

CAUTION: Make sure vehicle is resting firmly on jack stands before removing wheels.

2. Remove (2) capscrews and locknuts securing left rear tail light to mounting plate. Discard mounting fasteners.

3. Remove capscrews, flat washers and locknuts securing left, rear, tail light, mounting plate to top of mounting bracket. Reinstall mounting plate to bottom of bracket using capscrews, washers, and locknuts, previously removed.

4. Loosely mount right, tail light, mounting plate (supplied in kit) to the bottom of the bracket on the right side of the vehicle with (2) 5/16-18 x 1" lg. capscrews, (2) flat washers and (2) locknuts.

5. Loosely mount a L-bracket to each side of vehicle frame with (2) 1/4-20 x 1" lg. capscrews and locknuts. Mounting location is just behind front spring mounts. R.H. bracket shown in figure.

NOTE: The fenders are symmetrical and can be installed on either side of the vehicle.

6. Loosely secure front of left fender to L-bracket and rear of fender and tail light to tail light mounting plate with (4) 1/4-20 x 1" lg. capscrews, (4) flat washers and (2) locknuts.

7. Loosely secure front of right fender to L-bracket and rear of fender to tail light mounting plate with (4) 1/4-20 x 1" lg. capscrews, (4) flat washers and (2) locknuts.

8. Loosely secure side of each fender to vehicle frame with (3) truss head screws and 3/8 - 16 locknuts.

9. Tighten all fasteners.

10. Install rear wheels and lower vehicle to the ground.

CAUTION: Do not use fenders as a step.

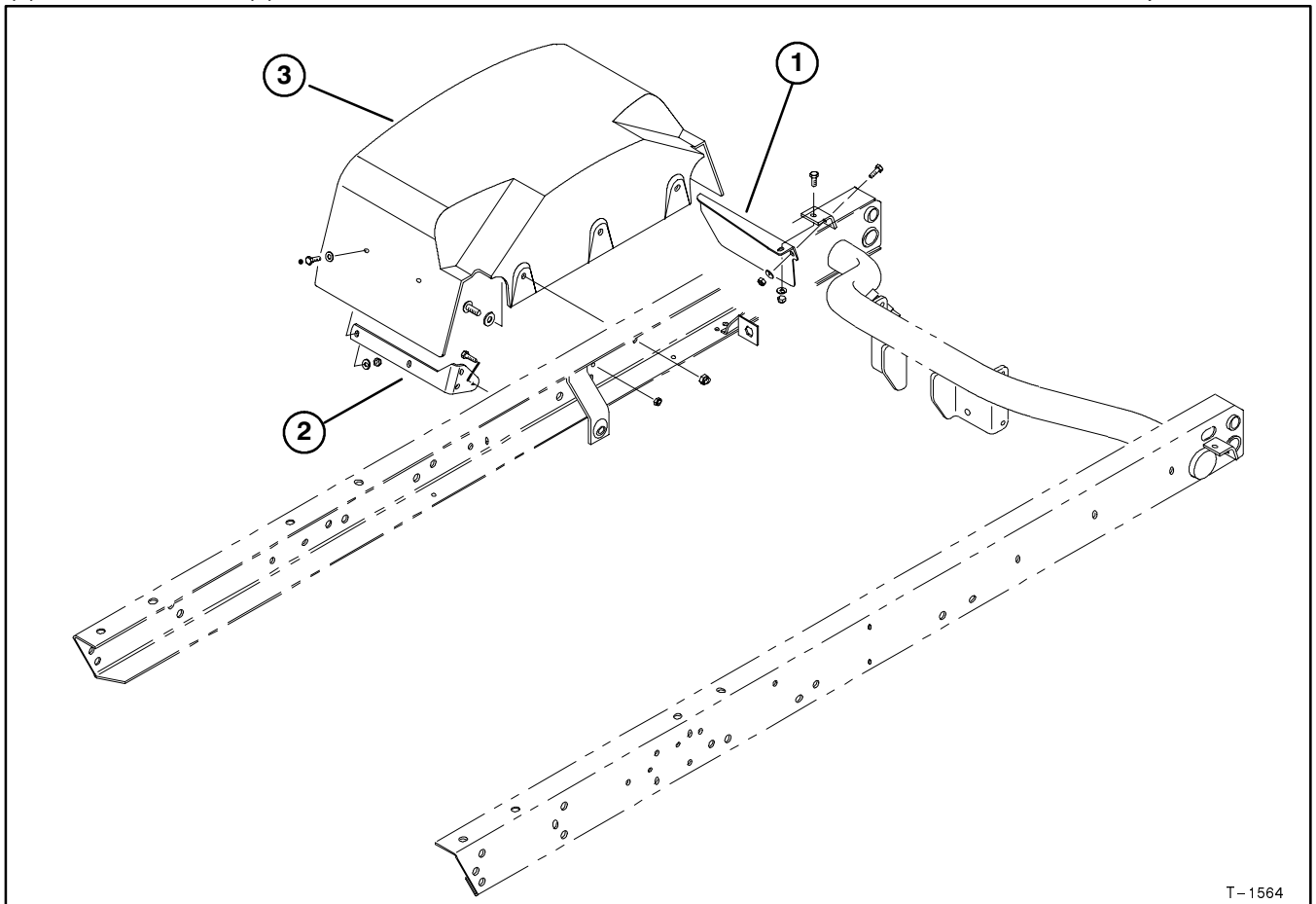

T-1564

Figure 1

1. Tail light mounting plate 2. L-bracket 3. Fender

©The Toro Company-1996

TPS