



Backhoe Rework Template

Dingo® Backhoe

Part number: 100-7265

Installation
Instructions

To improve the safety of the backhoe, you need to cut a small area of steel out of the rear support plates (Fig. 1).

IMPORTANT: This procedure requires you to have and be fully trained in the use and safe operation of an oxyacetylene torch. *Do not attempt this procedure if you do not have the right tools or expertise.*

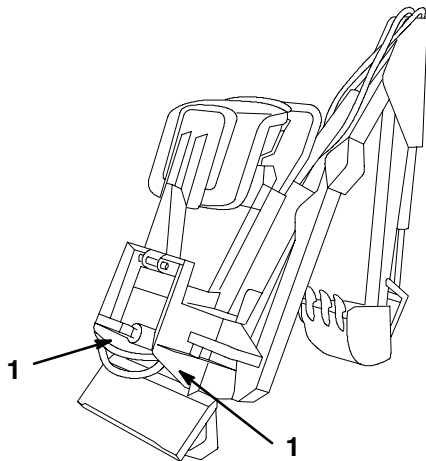

m-4955

Figure 1

1. Plates to be cut

1. Secure the boom and disconnect the backhoe from the traction unit.



CAUTION



POTENTIAL HAZARD

- If you attempt this procedure without properly securing the boom before disconnecting the backhoe, it could spring back or fall over during the procedure.

WHAT CAN HAPPEN

- You could be severely injured or burned if the backhoe moves during this procedure.

HOW TO AVOID THE HAZARD

- Install the two pins that lock the boom in place before disconnecting the backhoe. Refer to your *Backhoe Operator's Manual* for more information.

2. Push and secure the hydraulic hoses in the internal compartments up and into the backhoe, away from the area to be cut (Fig. 2).

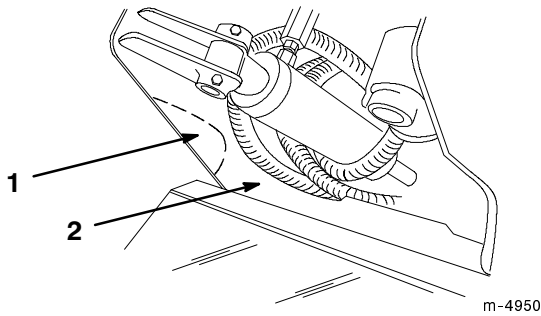

Figure 2

1. Area to be cut (inside view)
2. Hydraulic hoses



WARNING



POTENTIAL HAZARD

- High pressure hydraulic lines run behind the plate being cut and may be caught in the torch flame. The hoses could melt releasing the high pressure oil. The oil could ignite if released.
- Hydraulic fluid escaping under pressure can penetrate skin and cause injury.

WHAT CAN HAPPEN

- Burning oil sticks to skin and clothing and can cause severe burns and even death.
- Fluid accidentally injected into the skin must be surgically removed within a few hours by a doctor familiar with this form of injury or gangrene may result.

HOW TO AVOID THE HAZARD

- Move the hoses out of the way and cover them with a protective, fire resistant cloth or other material during this procedure.
- Keep a fire extinguisher capable of extinguishing a petroleum fire close by during this procedure.
- Keep flammable materials away from the work area.

IMPORTANT: If you burn the hoses, they must be replaced. These hoses are difficult and costly to replace.

3. Clean all oil, deposits, and debris from the area being cut.
4. Cover and protect the internal hydraulic hoses and other structures with a fire-resistant cloth or other material.

5. Clamp the template to the outside of one of the plates to be cut (Fig. 3)

IMPORTANT: The front/bottom edge of the template must be flush with the front/bottom edge of the plate.

IMPORTANT: If the weld on the top of the plate prevents you from clamping the template securely to the plate, grind down top of the plate until it fits around the weld.

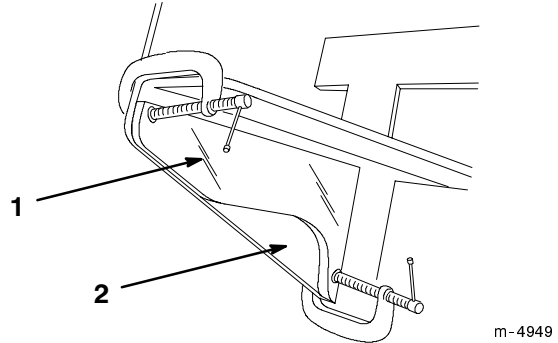

Figure 3

1. Template
2. Area to be cut (outside view)

6. Using an oxyacetylene torch, follow along the lower, curved edge of the template, cutting out the area indicated in Figure 3.
7. Remove the template.
8. Using a grinder, grind the cut edge of the plate smooth.
9. Repeat steps 5 through 8 for the plate on the other side.
10. When everything has cooled, prime the bare metal surfaces and then paint them with Toro red paint.
11. Remove the protective cloths.
12. Reposition the hoses in the backhoe to their original positions.
13. Check all hose fittings on the backhoe to ensure that all are tight.