



824

Snowthrower

Model No. 38053—200000001 and Up

Operator's Manual



Contents

	Page
Introduction	2
Safety	3
General Snowthrower Safety	3
Toro Snowthrower Safety	4
Sound Pressure Level	5
Sound Power Level	5
Vibration Level	5
Symbol Glossary	6
Assembly	9
Loose Parts	9
Installing the Handle	9
Installing the Speed Selector Rod	10
Installing the Traction Rod	11
Installing the Auger/Impeller Drive Control Linkage	11
Installing the Discharge Chute	12
Installing the Chute Control Rod	12
Securing the Chute Deflector	13
Before Starting	13
Filling the Engine Crankcase with Oil	13
Filling the Fuel Tank with Gasoline	14
Checking the Tire Pressure	15
Operation	15
Controls	15
Removing the Heater Box	16
Installing the Heater Box	17
Starting the Engine	17
Stopping the Engine	17
Free Wheeling or Self-propel Drive	17
Snowthrowing Tips	18
Maintenance	19
Recommended Maintenance Schedule	19
Checking the Engine Oil Level	20
Changing the Engine Oil	20
Checking the Auger Gear Box Grease	21
Adjusting the Traction Drive	21
Replacing the Traction Belt	21
Adjusting the Auger/Impeller Drive Belt	23
Replacing the Auger/Impeller Drive Belt	23
Adjusting the Skids and the Scraper	24
Adjusting the Speed Selector	25
Lubricating the Snowthrower	25
Replacing the Spark Plug	26
Emptying the Fuel Tank	26
Troubleshooting	28
Storage	30

Preparing the Fuel System	30
Preparing the Engine	30
Preparing the Snowthrower	30
Accessories	30

Introduction

Thank you for choosing a Toro product. We want you to be completely satisfied with your new purchase.

Read this manual carefully to learn how to operate and maintain your product properly. The information in this manual can help you and others avoid injury and product damage. Although Toro designs and produces safe products, you are responsible for operating the product properly and safely.

Whenever you contact your Authorized Service Dealer or the factory for help with service, genuine Toro parts, or additional information, have the model number and the serial number of your product handy. You will find the model number and serial number decal on the product as illustrated in Figure 1.

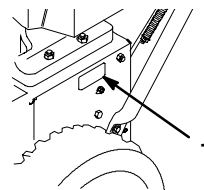

m-4038

Figure 1

1. Model number and serial number decal

Write the product model number and serial number in the space below:

Model No. _____

Serial No. _____

This manual identifies potential hazards and has special safety messages that help you and others avoid personal injury and even death. **DANGER**, **WARNING**, and **CAUTION** are words used to identify the level of hazard.

DANGER signals an extreme hazard that will cause serious injury or death if you do not follow the recommended precautions.

WARNING signals a hazard that may cause serious injury or death if you do not follow the recommended precautions.

CAUTION signals a hazard that may cause minor or moderate injury if you do not follow the recommended precautions.

This manual uses two other words to highlight information. **Important** calls attention to special mechanical information and **Note** emphasizes general information worthy of special attention.

The left and right side of the machine is determined by standing behind the handle in the normal operating position.

Safety

This snowthrower meets or exceeds the B71.3 specifications of the American National Standards Institute and the ISO standard 8437 in effect at the time of production. However, improper use or maintenance by the operator or owner can result in injury. To reduce the potential for injury, comply with these safety instructions.

The snowthrower is designed and tested to offer reasonably safe service; however, **failure to comply with the following instructions may result in personal injury.**

To ensure maximum safety, best performance, and to gain knowledge of the product, it is essential that you and any other operator of the snowthrower read and understand the contents of this manual before the motor is ever started. Pay particular attention to the safety alert symbol  which means CAUTION, WARNING, OR DANGER — “personal safety instruction.” Read and understand the instruction because it has to do with safety. Failure to comply with instruction may result in personal injury.

General Snowthrower Safety

The following instructions have been adapted from the ANSI/OPEI standard B71.3—1995 and ISO standard 8437:1989. Information or terminology specific to Toro snowthrowers is enclosed in parenthesis.

Training

- Read the operator’s manual carefully. Be thoroughly familiar with the controls and the proper use of the equipment. Know how to stop the unit and disengage the controls quickly.
- Never allow children to operate the equipment. Never allow adults to operate the equipment without proper instruction.
- Keep the area of operation clear of all persons, particularly small children and pets.

- Exercise caution to avoid slipping or falling, especially when operating in reverse.

Preparation

- Thoroughly inspect the area where the equipment is to be used and remove all doormats, sleds, boards, wires, and other foreign objects.
- Disengage all clutches and shift into neutral before starting the engine.
- Do not operate the equipment without wearing adequate winter garments. Wear footwear which will improve footing on slippery surfaces.
- Handle fuel with care; it is highly flammable.
 - Use an approved fuel container.
 - Never add fuel to a running or hot engine.
 - Fill fuel tank outdoors with extreme care. Never fill fuel tank indoors.
 - Replace gasoline caps securely and wipe up spilled fuel.
- Use only the power cord supplied with the snowthrower and a receptacle appropriate for use with the cord for electric starting motors.
- Adjust the auger housing height to clear gravel or crushed rock surface. (This is not necessary on single-stage snowthrowers.)
- Never attempt to make any adjustments while the engine is running, except where specifically recommended by Toro.
- Let engine and machine adjust to outdoor temperatures before starting to clear snow.
- The operation of any powered machine can result in foreign objects being thrown into the eyes. Always wear safety glasses or eye shields during operation or while performing an adjustment or repair.

Operation

- Do not put hands or feet near or under rotating parts. Keep clear of the discharge opening at all times.
- Exercise extreme caution when operating on or crossing gravel drives, walks, or roads. Stay alert for hidden hazards or traffic.
- After striking a foreign object, stop the engine, remove the wire from the spark plug, thoroughly inspect the snowthrower for any damage, and repair the damage before restarting and operating the snowthrower.
- If the unit should start to vibrate abnormally, stop the engine and check immediately for the cause. Vibration is generally a warning of trouble.

- Stop the engine whenever you leave the operating position, before unclogging the auger/impeller housing or discharge chute, and when making any repairs, adjustments, or inspections.
- When cleaning, repairing, or inspecting, make certain that the auger/impeller or rotor blades and all moving parts have stopped. Disconnect the spark-plug wire, and keep the wire away from the plug to prevent someone from accidentally starting the engine.
- Do not run the engine indoors, except when starting it and for moving the snowthrower in or out of the building. Open the outside doors; exhaust fumes are dangerous.
- Do not clear snow across the face of slopes. Exercise extreme caution when changing direction on slopes. Do not attempt to clear steep slopes.
- Never operate the snowthrower without proper guards, plates, or other safety protective devices in place.
- Never operate the snowthrower near glass enclosures, automobiles, window wells, drop-offs, etc. without proper adjustment of the snow discharge angle. Keep children and pets away.
- Do not overload the machine capacity by attempting to clear snow at too fast a rate.
- Never operate the machine at high transport speeds on slippery surfaces. Look behind and use care when moving in reverse.
- Never direct discharge at bystanders or allow anyone in front of the unit.
- Disengage power to the auger/impeller or rotor blades when snowthrower is transported or not in use.
- Use only attachments and accessories approved by Toro, such as wheel weights, counterweights, cabs, etc. (Contact your Authorized Service Dealer for accessories available for your snowthrower.)
- Never operate the snowthrower without good visibility or light. Always be sure of your footing, and keep a firm hold on the handles. Walk; never run.

Maintenance and storage

- Check all fasteners at frequent intervals for proper tightness to be sure the equipment is in safe working condition.
- Never store the machine with fuel in the fuel tank inside a building where ignition sources are present such as hot water and space heaters, clothes dryers, etc. Allow the engine to cool before storing in any enclosure.
- Always refer to this operator's manual for important details if the snowthrower is to be stored for an extended period.

- Maintain or replace safety and instruction labels when necessary.
- Run the machine a few minutes after throwing snow to prevent freeze-up of the auger/impeller or rotor blades. With the engine running, stay in the operating position and disengage the auger/impeller or rotor blades, shift the traction into the neutral position, and pull the recoil starter handle several times to prevent it from freezing up. (Pulling on the recoil starter rope produces a loud, clattering sound. This does not harm the engine or the starter.)

Toro Snowthrower Safety

The following list contains safety information specific to Toro products or other safety information that you must know that is not included in the ANSI or ISO standards.

- **The rotating impeller/auger or rotor blades can cut off or injure fingers or hands.** Stay behind the handles and away from the discharge opening while operating the snowthrower. **Keep your face hands, feet, and any other part of your body or clothing away from concealed, moving, or rotating parts.**
- Before adjusting, cleaning, repairing, and inspecting the snowthrower, and before unclogging the discharge chute, **stop the engine, remove the key, and wait for all moving parts to stop.** Also, disconnect the wire from the spark plug and keep it away from the plug to prevent someone from accidentally starting the engine.
- Use a stick, **not your hands**, to remove obstructions from the discharge chute.
- **Before** leaving the operator's position behind the handles, stop the engine, remove the key, and wait for all moving parts to stop.
- Do not wear loose-fitting clothing that could get caught in moving parts.
- If a shield, safety device, or decal is damaged, illegible, or lost, repair or replace it before beginning operation. Also, tighten any loose fasteners.
- **Do not** smoke while handling gasoline.
- For two-stage snowthrowers, use the lower gear and, for Power Shift snowthrowers, the rear wheel position when operating on slopes.
- **Do not** use the snowthrower on a roof.
- Do not touch the engine while it is running or soon after it is stopped because the engine will be hot enough to cause a burn. Do not add oil or check the oil level in the crankcase when the engine is running.
- Perform only those maintenance instructions described in this manual. Before performing any maintenance, service, or adjustment, stop the engine, remove the key and disconnect the wire from the spark plug, keeping it

away from the plug to prevent someone from accidentally starting the engine. If major repairs are ever needed, contact your Authorized Service Dealer.

- Do not change the governor settings on the engine.
- When storing the snowthrower for more than 30 days, drain the gasoline from the fuel tank to prevent a potential hazard. Store gasoline in an approved fuel container. Remove the key from the ignition switch before storing the snowthrower.
- To ensure the best performance and safety, purchase only genuine Toro replacement parts and accessories.

Sound Pressure Level

This unit has a sound pressure at the operator's ear of 93 dB(A), based on measurements of identical machines per Directive 81/1051/EEC.

Sound Power Level

This unit has a sound power level of 104 LwA, based on measurements of identical machines per Directive 79/113/EEC.

Vibration Level

This unit has a maximum hand-arm vibration level of 9.9 m/s², based on measurements of identical machines per EN 1033.

Before Operating

Read and understand the contents of this manual before operating the snowthrower. Become familiar with all controls and know how to stop the engine quickly.

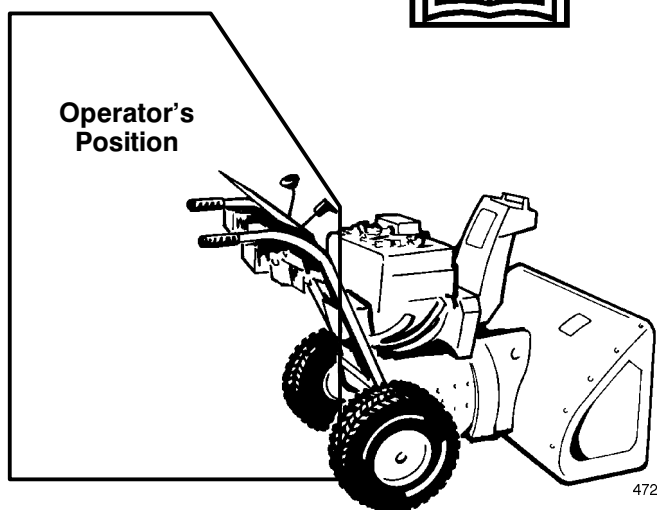
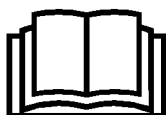

Caution: Improper use may result in loss of fingers, hands, or feet.

There is a high-speed impeller within two inches of the opening.

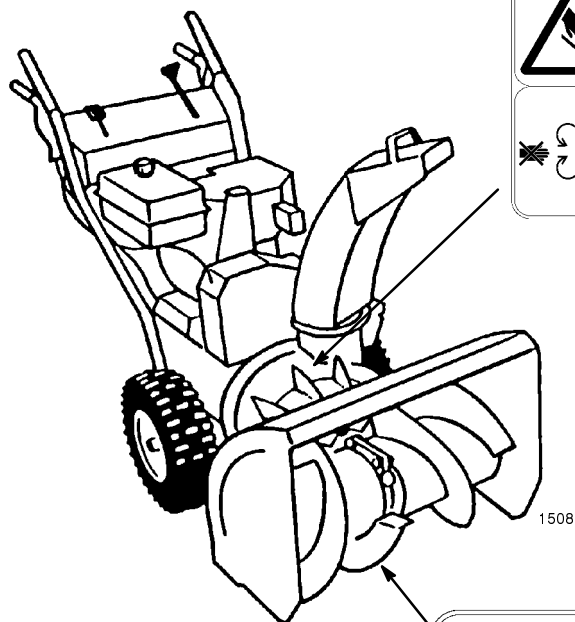

The low-speed auger has a moving pinch point close to the opening.

Symbol Glossary

Safety alert triangle - symbol within triangle indicates a hazard



Safety alert symbol



Read operator's manual



Consult technical manual for proper service procedures



Shut off engine and remove key before performing maintenance or repair work

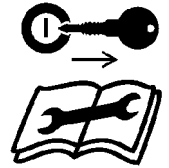

Shut off engine and remove key before leaving operator position - single stage snowthrower



Shut off engine and remove key before leaving operator position - two stage snowthrower



Severing of fingers or hand - impeller blade



Do not open or remove safety shields while engine is running

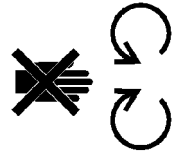

Stay a safe distance from the machine

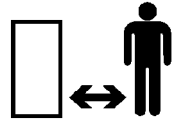

Stay a safe distance from the machine - single stage snowthrower



Stay a safe distance from the machine - two stage snowthrower

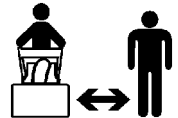

Thrown or flying objects - Whole body exposure

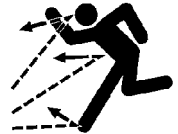

Electrical shock - electrocution



Cutting or entanglement of foot - rotating auger



Electric start



**Hot surfaces - burns
to fingers or hands**



Machine loss of control - uphill slope



**Caustic liquids -
chemical burns to
fingers or hands**



**Machine loss of control -
downhill slope**



Do not tip battery

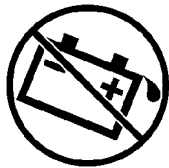

Traction drive



Keep dry



**Snowthrower collector
auger**

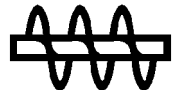

**Machine travel
direction - forward**



Engage

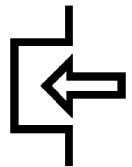

**Machine travel
direction - rearward**



Disengage

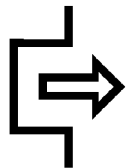

On/start



Choke

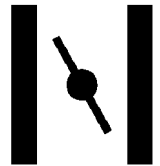

Off/stop

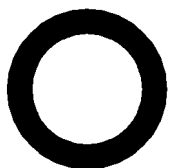

**Engine speed
(Throttle)**



Fast



Neutral



Slow



Snowthrower collector
auger/impeller



Decreasing/Increasing



Lock



Engine start

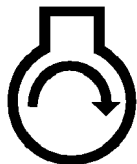

Unlock



Engine stop



Lever operation



Snowthrower chute
direction



Lever operation

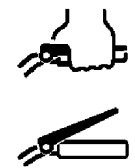

Primer (start aid)



Unleaded fuel



Primer operation

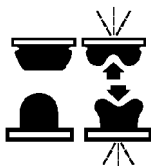

Cutting of fingers or hand



Throttle operation

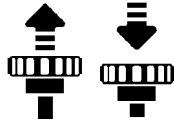

Cutting of foot



PowerShift operation

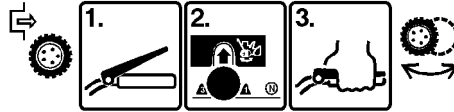

Assembly

Note: Determine the left and right sides of the snowthrower by standing in the normal operating position.

Loose Parts

Part	Qty	Use
Cap screws and curved washers	4	Installing the handle
Cotter pin	1	Installing the speed selector rod
Flat washer	1	
Lower link	1	Installing the auger and traction drive control rod
Hex flange nut	1	
Flange locknuts	2	
Compression spring	1	
Worm gear	1	Installing the chute control rod
Bracket	1	
Carriage screw	1	
Flat washer	1	
Screw	1	
Locknuts	2	
Key	1	Starting and stopping the engine

Installing the Handle

1. Remove the tie straps that secure the control rods to the handle.
2. Remove the axle pins from both wheels (Fig. 2) and slide the wheels outward on the axle approximately one inch (2.5 cm).

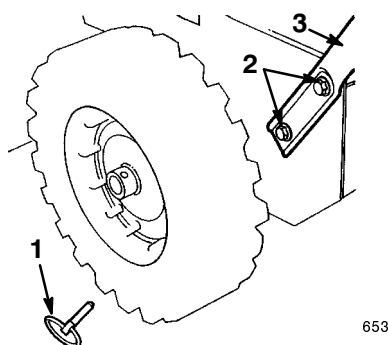

Figure 2

1. Axle pin
2. Cap screws and curved washers
3. Handle

3. Hold the handles in the installation position and insert the traction rod through the loop in the lower traction rod (Fig. 7).

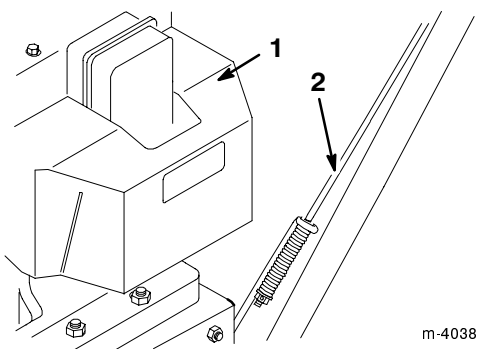

Figure 3

1. Engine
2. Traction rod

4. Position the left handle against the left side of the snowthrower, align the handle mount holes with the holes in the side plate, and secure the handle with two cap screws and curved washers until they are finger tight (Fig. 2).

Note: The concave side of the curved washer goes against the outside of the handle.

5. Position the right handle against the right side of the snowthrower, align the handle mount holes with the holes in the side plate, and secure the handle with two cap screws and curved washers until they are finger tight.

6. Make sure that the handles are in line with each other and then tighten the cap screws that secure both handles.

7. Slide the wheels inward and install the axle pin through the holes in the wheel hub and through the **inner** hole of the axle (Fig. 4).

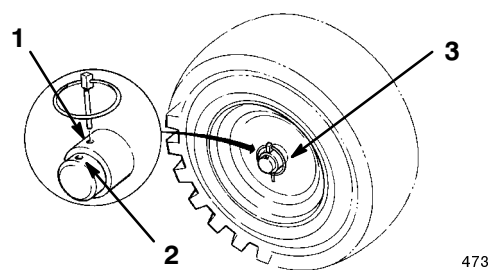

Figure 4

1. Inner axle hole and wheel hub
2. Outer axle hole
3. Axle pin

Note: If the snowthrower comes with optional tire chains, install the axle pin through the **outer** axle holes.

Installing the Speed Selector Rod

1. Pull the speed selector arm (Fig. 5) to the most outward position.

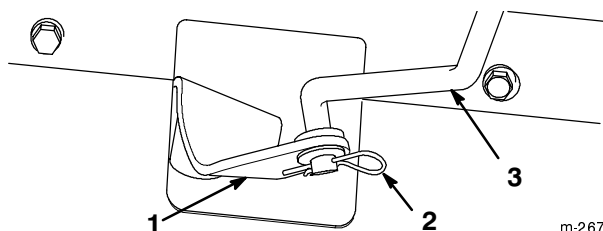

Figure 5

1. Speed selector arm
2. Flat washer and cotter pin
3. Speed selector rod

2. Move the speed selector (Fig. 17) on the control panel to the R₂ (reverse) position.

3. Rotate the speed selector rod in the trunnion (Fig. 6) until the bottom end of the rod can slip into the hole in the speed selector arm (Fig. 5).

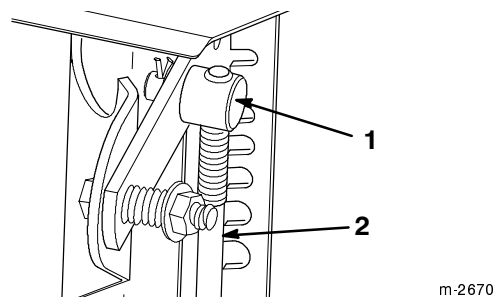

Figure 6

1. Trunnion
2. Speed selector rod

4. Install the speed selector rod into the selector arm, add one flat washer on the rod, and secure it with a cotter pin (Fig. 5).

Note: If the speed selector does not move into third gear or does not meet your speed requirements, adjust the speed selector. Refer to *Adjusting the Speed Selector* on page 25.

Installing the Traction Rod

1. Slide the spring onto the bottom of the traction control rod (Fig. 7).

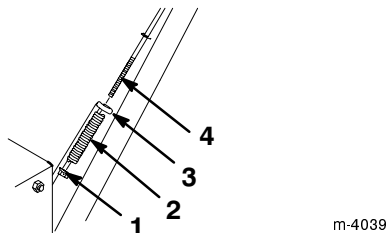

Figure 7

- | | |
|-------------------|-----------------------|
| 1. Flange locknut | 3. Lower traction rod |
| 2. Spring | 4. Traction rod |

2. Thread a flange locknut (flange side up) onto the bottom of the traction control rod below the spring (Fig. 7).
3. Adjust the flange locknut up or down on the traction control rod until the distance between the top of the handgrip and the bottom of the traction control lever is approximately five inches (12.7 cm) (Fig. 8).

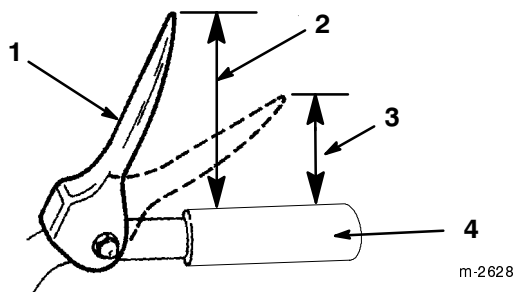

Figure 8

- | | |
|-------------------------------------|--|
| 1. Traction control lever | 3. Three to four inches (7.6 to 10.2 cm) |
| 2. Approximately 5 inches (12.7 cm) | 4. Handgrip |

4. Move the speed selector (Fig. 17) into third gear.
5. Slowly pull the snowthrower backward while pressing the traction control lever toward the handle.

The adjustment is correct when the wheels stop rolling backward and the distance between the top of the handgrip and the bottom of the traction control lever is three to four inches (7.6 to 10.2 cm) (Fig. 8).

6. Adjust the flange locknut, if necessary, to obtain this dimension, then tighten the flange locknut securely.

Installing the Auger/Impeller Drive Control Linkage

1. Thread a flange nut (flange side down) onto the upper control rod located on the right handle (Fig. 9).

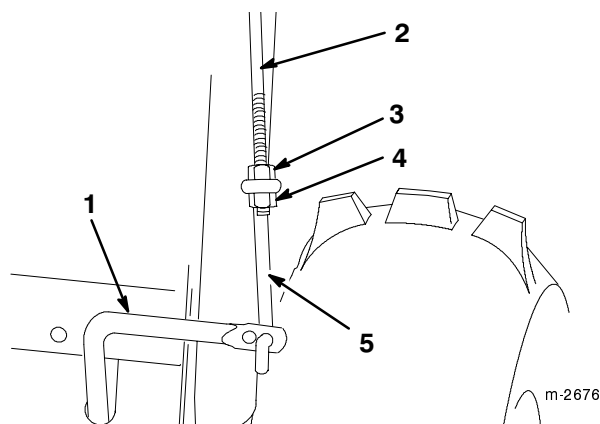

Figure 9

- | | |
|----------------------|-------------------|
| 1. Lower control rod | 4. Flange locknut |
| 2. Upper control rod | 5. Lower link |
| 3. Flange nut | |

2. Install the lower link through the outer hole in the lower control rod (Fig. 9).
3. Insert the upper control rod through the loop in the lower link control rod (Fig. 9).
4. Thread a flange locknut (flange side up) onto the bottom of the upper control rod below the loop in the lower link (Fig. 9).
5. Check the distance between the top of the handgrip and the bottom of the auger/impeller drive control lever. The distance should be approximately four inches (10.2 cm) (Fig. 10).

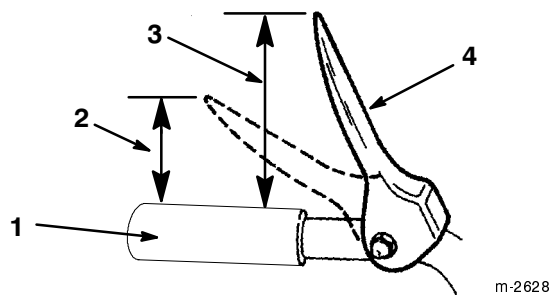

Figure 10

1. Handgrip
2. Two inches (5 cm)
3. Approximately four inches (10.2 cm)
4. Auger/impeller control lever

6. Press the auger/impeller drive control lever slowly toward the handgrip.

Note: The amount of force to compress the lever increases noticeably when you remove the slack from the drive belt (approximately one-half of the lever movement). The adjustment is correct when the force **begins** to increase and the distance between the top of the handgrip and the bottom of the auger/impeller drive control lever is two inches (5 cm) (Fig. 10).

Note: If the force does not noticeably increase, remove the belt cover (refer to *Replacing the Auger/Impeller Drive Belt*, steps 1 and 2 on page 23) and measure two inches (5 cm) above the handgrip at the point where you remove the slack from the auger/impeller drive belt.

7. Adjust the two nuts, if necessary, to obtain this dimension, then tighten the nuts securely (Fig. 9).

Installing the Discharge Chute

1. Lightly grease the chute ring (Fig. 11).

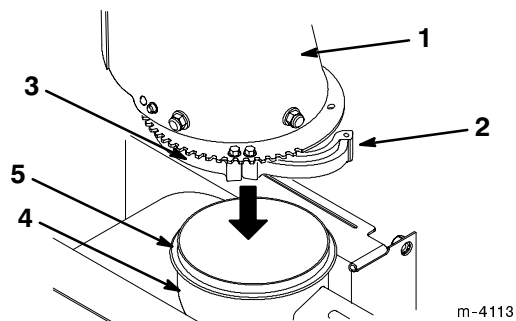

Figure 11

1. Chute
2. Loose chute retainer
3. Fixed chute retainer
4. Auger housing
5. Chute ring

2. Rotate the loose chute retainer on the bottom of the chute outward (Fig. 11).
3. Lower the chute over the opening on the top of the auger housing (Fig. 11).
4. Make sure that the chute ring fits into the grooves in the fixed chute retainers (Fig. 11).
5. Rotate the loose chute retainer inward onto the chute ring and secure it with a No. 10-4 x 5/8 inch (1.5 cm) screw (Fig. 12).

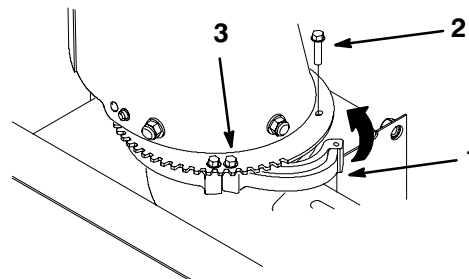

Figure 12

1. Chute retainer
 2. No. 10-4 x 5/8 in. (1.5 cm) screw
 3. Tighten screw
6. Tighten the other screw to secure the chute retainer (Fig. 12).

Installing the Chute Control Rod

1. Assemble the chute control bracket and rod to the left side of the handle with the cap screw and the locknut. Leave the locknut loose (Fig. 13).

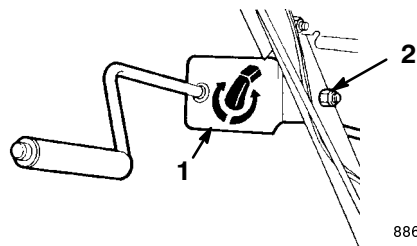
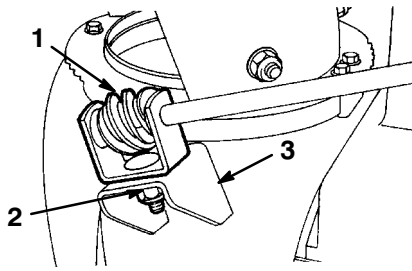

Figure 13

1. Chute control bracket and rod
 2. Cap screw and locknut rod
2. Apply No. 2 general purpose grease to the worm gear.
 3. Loosely mount the worm gear and the bracket to the mounting flange with a bolt, a pyramidal washer, and a locknut (Fig. 14).



658

Figure 14

- | | |
|--|--------------------|
| 1. Worm gear and bracket | 3. Mounting flange |
| 2. Bolt, pyramidal washer, and locknut | |

- Slide the worm gear into the teeth of the chute retaining ring and tighten the locknut (Fig. 14).
- Tighten the locknut that secures the chute control bracket (Fig. 13).
- Check the operation of the chute control rod, moving the worm gear slightly outward if it binds.

Securing the Chute Deflector

- Pivot the deflector upward and back until the deflector stop passes over the lip on the top of the chute.
- Secure the left side of the deflector to the discharge chute using the parts as illustrated in Figure 15.

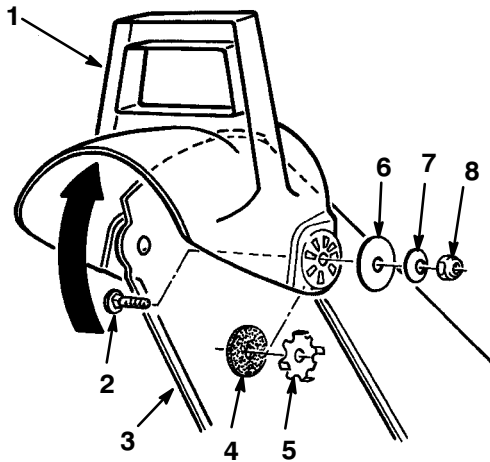

667

Figure 15

- | | |
|------------------|----------------------|
| 1. Deflector | 5. Friction plate |
| 2. Carriage bolt | 6. Large flat washer |
| 3. Chute | 7. Curved washer |
| 4. Rubber washer | 8. Locknut |

Note: Make sure that you position the rubber washer and the friction plate between the chute and deflector, and that the friction plate tabs fit into the holes in the deflector.

Note: The concave side of the curved washers go against the large flat washers.

- Tighten the nuts on both sides of the deflector. Do not overtighten the nuts.

Before Starting

Filling the Engine Crankcase with Oil

The engine comes from the factory with only a few ounces of oil in the crankcase. Before starting the engine, add oil. The crankcase holds 26 ounces (0.77 liters) of oil; however, because there is some oil in the crankcase, do not add the full amount at one time. Gradually add the oil according to the following procedure:

- Move the snowthrower to a level surface to ensure an accurate oil level reading.
- Clean the area around the dipstick (Fig. 16).

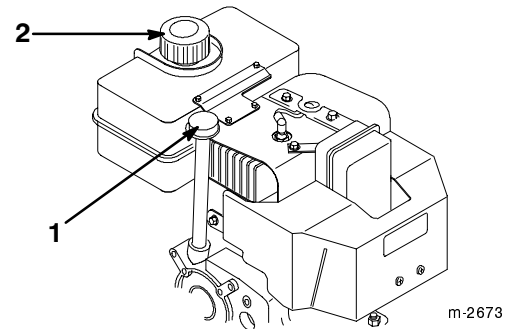

m-2673

Figure 16

- | | |
|-------------|------------------|
| 1. Dipstick | 2. Fuel tank cap |
|-------------|------------------|

- Remove the dipstick from the crankcase (Fig. 16).
- Slowly pour 3/4 of the total capacity of oil into the crankcase.

Use only a high-quality, SAE 5W-30 or SAE 10 weight detergent oil that has the American Petroleum Institute (API) "service classification"—SF, SG, SH, or SJ. For extremely cold conditions (below 0°F or -18°C), use 0W-30 weight detergent oil that has the American Petroleum Institute (API) "service classification"—SF, SG, SH, or SJ.

- Wipe the dipstick clean with a clean cloth.
- Fully install the dipstick.

Note: To ensure an accurate oil level reading, you must fully install the dipstick.

7. Remove the dipstick.
8. Read the oil level on the dipstick.
9. If the oil level is below the *Full* mark, slowly add oil, checking the level frequently (steps 5 through 8), until the dipstick reads *Full*.

IMPORTANT: Do not overfill the crankcase and run the engine; engine damage will result. Drain the excess oil until the oil level on the dipstick reads *Full*.

Filling the Fuel Tank with Gasoline

Use clean, fresh lead-free gasoline (including *oxygenated* or *reformulated* gasoline) with an octane rating of 87 or higher. To ensure freshness, purchase only the quantity of gasoline that can be used in 30 days. Using unleaded gasoline results in fewer combustion chamber deposits and longer spark plug life.

IMPORTANT: Do not use methanol, gasoline containing methanol, gasohol containing more than 10% ethanol, premium gasoline, or white gas. Using these fuels can damage the engine's fuel system.



DANGER



POTENTIAL HAZARD

- In certain conditions gasoline is extremely flammable and highly explosive.

WHAT CAN HAPPEN

- A fire or explosion from gasoline can burn you and others and cause property damage.

HOW TO AVOID THE HAZARD

- Fill the fuel tank outdoors, in an open area, and when the engine is cold. Wipe up any gasoline that spills.
- Do not fill the fuel tank completely full. Add gasoline to the fuel tank until the level is 1/4 to 1/2 inch (6 mm to 13 mm) below the bottom of the filler neck. This empty space in the tank allows the gasoline to expand.
- Never smoke when handling gasoline, and stay away from an open flame or where a spark may ignite gasoline fumes.
- Store gasoline in an approved fuel container and keep it out of the reach of children.
- Never buy more than a 30-day supply of gasoline.



DANGER



POTENTIAL HAZARD

- When fueling, under certain circumstances, a static charge can develop, igniting the gasoline.

WHAT CAN HAPPEN

- A fire or explosion from gasoline can burn you and others and cause property damage.

HOW TO AVOID THE HAZARD

- Always place gasoline containers on the ground away from your vehicle before filling.
- Do not fill gasoline containers inside a vehicle or on a truck or trailer bed because interior carpets or plastic truck bed liners may insulate the container and slow the loss of any static charge.
- When practical, remove gas-powered equipment from the truck or trailer and refuel the equipment with its wheels on the ground.
- If this is not possible, then refuel such equipment on a truck or trailer from a portable container rather than from a gasoline dispenser nozzle.
- If you must use a gasoline dispenser nozzle, keep the nozzle in contact with the rim of the fuel tank or container opening at all times until fueling is complete.

Use a fuel stabilizer/conditioner regularly during operation and storage. A stabilizer/conditioner cleans the engine during operation and prevents gum-like varnish deposits from forming in the engine during storage.

IMPORTANT: Do not use fuel additives except a fuel stabilizer during storage. Do not use fuel stabilizers with an alcohol base such as ethanol, methanol, or isopropanol.

1. Clean the area around the fuel tank cap (Fig. 16).
2. Remove the cap from fuel tank.
3. Using unleaded, regular gasoline, fill the tank to within 1/4 to 1/2 inch (6 to 13 mm) from the top of the tank, not into the filler neck.

IMPORTANT: Do not fill the tank with gasoline into the filler neck. This space is for fuel expansion. Do not fill the tank completely full.

4. Install the fuel tank cap.
5. Wipe up any spilled gasoline.

Checking the Tire Pressure

Check the pressure of the tires because they are over-inflated at the factory for shipping. Reduce the pressure equally in both tires to between 7-15 psi (48-103 kPa).

Operation

Controls

- **Auger/Impeller Drive Control Lever** (Fig. 17)—To engage both the auger and impeller, press the lever against the right handgrip. To disengage, release the lever.

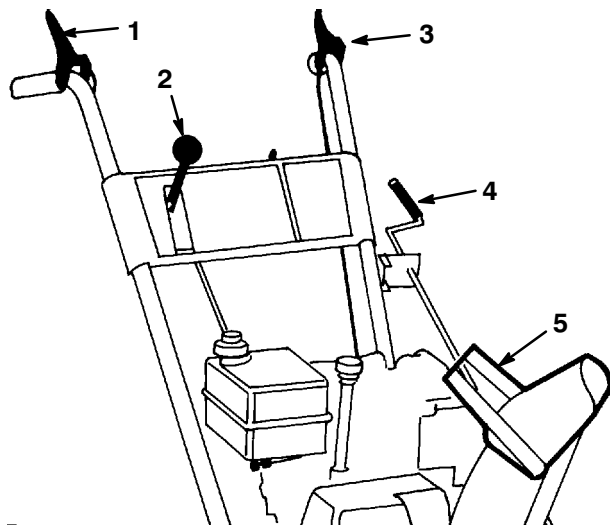

Figure 17

- | | |
|---------------------------------------|----------------------------|
| 1. Auger/impeller drive control lever | 3. Traction control lever |
| 2. Speed selector | 4. Discharge chute control |
| | 5. Chute deflector handle |

- **Speed Selector** (Fig. 17)—This control has five positions: two reverse and three forward gears. To change speeds, move the speed selector to the desired position. The lever locks in a notch at each speed selection. The speed selector may shift with difficulty in heavy load conditions.

Note: Before shifting gears into or out of reverse, you must release the traction control lever. You may shift on-the-go between any of the **forward** speeds without releasing the traction control lever.

- **Traction Control Lever** (Fig. 17)—To engage the traction (wheel drive), press the lever against left handgrip. To stop traction, release the lever.

- **Discharge Chute Control** (Fig. 17)—Rotate the discharge chute control clockwise to move the discharge chute to the left; counterclockwise to move the chute to the right.
- **Chute Deflector Handle** (Fig. 17)—Move the deflector handle forward to move the snow stream down; rearward to move the snow stream up.
- **Ignition Switch** (Fig. 18)—Insert the key before starting the engine. To stop the engine, remove the key.

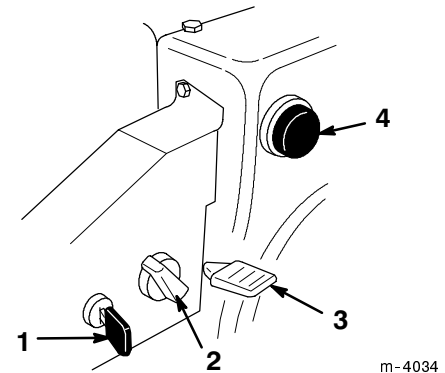

Figure 18

- | | |
|--------------------|-------------|
| 1. Ignition switch | 3. Throttle |
| 2. Choke | 4. Primer |

- **Choke** (Fig. 18)—Rotate the choke clockwise to the *On* position to start a cold engine. As engine warms up, gradually rotate the choke counterclockwise to the *Off* position.
- **Throttle** (Fig. 18)—Move the throttle upward to increase engine speed and downward to decrease engine speed.
- **Primer** (Fig. 18)—Press the primer to pump a small amount of gasoline into the engine for improved cold-weather starting.
- **Fuel Shutoff Valve** (Fig. 19)—Close the valve by rotating it clockwise. Open the valve by rotating it counterclockwise. Close the valve when you do not use the snowthrower.

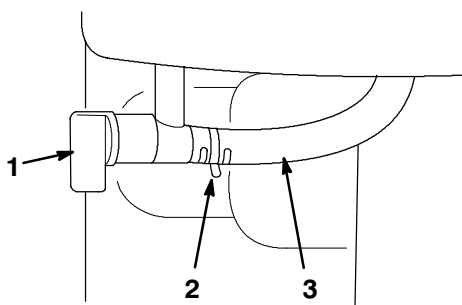

Figure 19

- | | |
|-----------------------|--------------|
| 1. Fuel shutoff valve | 3. Fuel line |
| 2. Hose clamp | |

- **Recoil Starter** (Fig. 20)—The recoil starter is on the back side of the engine. Pull the recoil starter to start the engine.

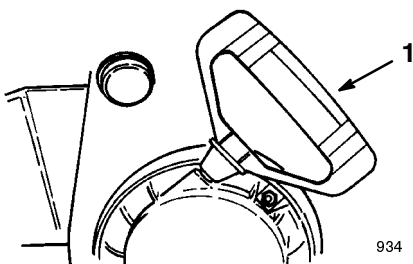

Figure 20

- | |
|-------------------|
| 1. Recoil starter |
|-------------------|

Removing the Heater Box

If you operate the engine when the air temperature is above 40°F (4°C), remove the carburetor heater box (Fig. 21).

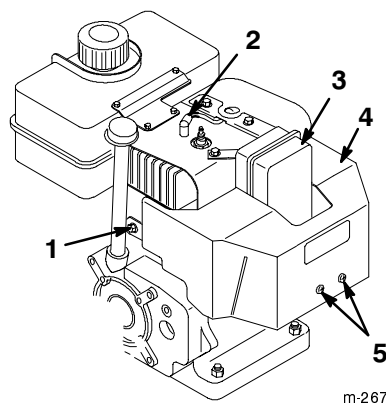

Figure 21

- | | |
|-----------------------------------|--------------------------|
| 1. Hex head screw and lock washer | 3. Hex head screw |
| 2. Spark plug wire | 4. Carburetor heater box |
| | 5. Phillips screws |

1. Disconnect the wire from the spark plug and make sure that the wire does not contact the plug (Fig. 21).
2. Remove the key from the ignition switch (Fig. 18).
3. Pull the choke knob off (Fig. 18).
4. Remove two Phillips screws, two hex head screws, and one lock washer that secure the carburetor heater box in place (Fig. 21).
- Note:** Install these fasteners in their holes for safe keeping.
5. Lift the heater box up and away from the engine.
6. Disconnect the green ground wire clip under the throttle (Fig. 22).

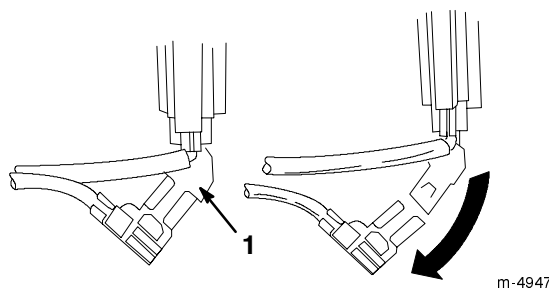

Figure 22

- | |
|---------------------------|
| 1. Green ground wire clip |
|---------------------------|

7. Install the choke knob.
8. Connect the wire to the spark plug.

IMPORTANT: Use the heater box as a reference for the choke and throttle positions.

Installing the Heater Box

To install the heater box, reverse steps 1 through 8 of *Removing the Heater Box* on page 16. Make sure that you remove the fasteners from their holes before installing the heater box.

Starting the Engine

IMPORTANT: Make sure that the auger/impeller and the discharge chute contain no obstructions before you operate the snowthrower. *Use a stick, not your hand, to remove an obstruction from the discharge chute.*

1. Move the throttle to the *Fast* position.
2. Make sure that the auger/impeller drive control lever and the traction control lever are in the *Disengaged* position (Fig. 17).
3. Open the fuel shutoff valve below the fuel tank (Fig. 19).
4. Rotate the choke (Fig. 18) to the *On* position.
5. Insert the ignition key (Fig. 18).

IMPORTANT: Do not use the primer if the engine has been running and is hot. Excessive priming may flood the engine and prevent it from starting.

6. Cover the hole in the center of the primer (Fig. 18) with your thumb and push in the primer slowly three times.
7. Grasp the recoil starter handle (Fig. 20) and pull it out slowly until positive engagement results; then pull the handle vigorously to start the engine.
8. Keep a firm grip on the starter handle and return the rope slowly.

Note: If the engine does not start or if the air temperature is -10°F (-23°C) or below, the engine may need additional priming. After pushing in the primer, try to start the engine before priming again.

9. After the engine starts, immediately rotate the choke (Fig. 18) to the 3/4 position. As the engine warms up, rotate the choke to the 1/2 position. When the engine warms up sufficiently, rotate the choke to the *Off* position.

10. Move the speed selector (Fig. 17) to first gear, squeeze the traction control lever to the handgrip, and then release the traction control lever. If the snowthrower moves forward before engaging the traction drive control lever or after releasing the lever, see *Adjusting the Traction Drive* on page 21.

IMPORTANT: Do not operate the snowthrower if the auger and impeller rotate when you disengage the auger/impeller drive control lever.

Stopping the Engine

1. Engage the auger to clear any remaining snow from inside the housing.
2. Run the engine for a few minutes to dry off any accumulated moisture.
3. With the engine running, pull the recoil starter with a rapid, continuous, full arm stroke three or four times. This helps prevent the recoil starter from freezing up.

Note: Pulling the starter rope produces a loud, clattering sound. This does not harm the engine or the starter.

4. Release the traction control and the auger/impeller drive control levers (Fig. 17).
5. Stop the engine by doing one of the following:
 - A. Move the throttle to the *Slow* position, and remove the key from the ignition switch.
 - B. Move the throttle to the *Stop* position.
6. Close the fuel shutoff valve (Fig. 19).
7. Wait for all moving parts to stop before leaving the operating position.

Free Wheeling or Self-propel Drive

You can operate the snowthrower with the self-propelling feature engaged or disengaged (freewheeling). There are two holes in each end of the axle. When you insert the axle pins through the outer axle holes and not through the wheel hubs (Fig. 4), the snowthrower freewheels. When you insert the axle pins through the holes in the wheel hubs and the inner axle holes (Fig. 4) and engage the traction control lever, the snowthrower propels itself.

Snowthrowing Tips



DANGER



POTENTIAL HAZARD

- When the snowthrower is in operation, the impeller and auger can be rotating.

WHAT CAN HAPPEN

- The rotating auger/impeller can cut off or injure hands and feet.

HOW TO AVOID THE HAZARD

- Before adjusting, cleaning, repairing, and inspecting the snowthrower, and before unclogging the discharge chute, *stop the engine and wait for all moving parts to stop*. Disconnect the wire from the spark plug and keep it away from the plug to prevent someone from accidentally starting the engine.
- Use a stick, *not your hands*, to remove an obstruction from the discharge chute.
- Stay behind the handles and away from the discharge opening while operating the snowthrower.
- Keep face, hands, feet, and any other part of your body or clothing away from concealed, moving, or rotating parts.



WARNING



POTENTIAL HAZARD

- Stones, toys and other foreign objects may be picked up and thrown by the auger/impeller.

WHAT CAN HAPPEN

- Thrown objects can cause serious personal injury to the operator or to bystanders.

HOW TO AVOID THE HAZARD

- Keep the area to be cleared free of all objects that could be picked up and thrown by the auger/impeller.
- Keep all children and pets away from the area of operation.

- When you are not using the snowthrower, close the fuel shutoff valve and remove the key.
- Remove snow as soon as possible after it falls. This produces the best snow removal results.
- Adjust the skids to match the type of surface being cleaned. Refer to *Adjusting the Skids and the Scraper Blade* on page 24.
- There are times when the front of the snowthrower may tend to ride up. If this happens, reduce the forward speed by shifting into a lower gear. If the front still tends to ride up, lift up on both handles to hold down the front of snowthrower.
- Discharge the snow downwind whenever possible.
- Overlap each swath to ensure complete snow removal.
- If the wheels slip, shift the snowthrower into a lower gear to reduce the forward speed.
- Run the snowthrower for a few minutes after clearing the snow so that moving parts do not freeze. Engage the auger to clear any remaining snow from inside the housing.
- Do not overload the snowthrower by clearing snow at too fast a rate. If the engine slows down, shift the snowthrower into a lower gear to reduce the forward speed.
- Always use the *Fast* throttle position when throwing snow.
- In wet or slushy conditions, maintain maximum engine speed, and do not overload the engine to prevent clogging the discharge chute.
- In snowy and cold weather conditions, some controls and moving parts may freeze. Therefore, whenever any control becomes hard to operate, stop the engine and wait for all moving parts to stop; then check all parts for freeze up. **Do not use excessive force when trying to operate frozen controls.**

Maintenance

Recommended Maintenance Schedule

Service Item	Service Operation	Initial	5 Hours	10 Hours	15 Hours	25 Hours	100 Hours	At Storage
Check the engine oil level	Check the oil level before each use and add oil if necessary.	X	X	X	X	X		X
Change the engine oil	Change the engine oil after the first two operating hours. Thereafter, as indicated.					X		X
Auger gear box	Check the auger gear box grease. Add grease if necessary.	X		X				X
Adjust the traction drive	Adjust the traction drive after the first hour of operation. Thereafter, as indicated.	X	X		X	X		
Replace the traction belt	Replace the traction drive belt as needed.							
Adjust the auger/impeller drive belt	Adjust the auger/impeller drive belt after the first hour of operation. Thereafter, as indicated.	X	X		X	X		
Replace the auger/impeller drive belt	Replace the auger/impeller drive belt as needed.							
Skids and the scraper	Adjust the skids and the scraper blade.	X			X			
Speed selector	Adjust the speed selector as needed.	X						
Lubricating the snowthrower	Oil and grease the internal moving parts.				X			X

Service Item	Service Operation	Initial	5 Hours	10 Hours	15 Hours	25 Hours	100 Hours	At Storage
Spark plug	Clean, inspect, and gap. Replace if necessary.						X	
Fuel tank	Drain the gasoline and run the engine to dry out the tank and the carburetor.							X

!
!

CAUTION

POTENTIAL HAZARD

- If you leave the wire on the spark plug, someone could start the engine.

WHAT CAN HAPPEN

- Someone accidentally starting the engine could seriously injure you or other bystanders.

HOW TO AVOID THE HAZARD

- Disconnect the wire from the spark plug before you do any maintenance. Set the wire aside so that it does not accidentally contact the spark plug.

Checking the Engine Oil Level

Check the oil level every five operating hours or each time you use the snowthrower.

1. Move the snowthrower to a level surface.
2. Clean the area around the dipstick (Fig. 16).
3. Remove the dipstick from the crankcase (Fig. 16).
4. Wipe the dipstick clean with a clean cloth.
5. Fully install the dipstick.

Note: To ensure an accurate oil level reading, you must fully install the dipstick.

6. Remove the dipstick from the crankcase.
7. Read the oil level on the dipstick.
8. If the oil level is below the *Full* mark, slowly add oil, checking the level frequently, until the dipstick reads *Full*.

Use only a high-quality, SAE 5W-30 or SAE 10 weight detergent oil that has the American Petroleum Institute (API) “service classification”—SF, SG, SH, or SJ. For extremely cold conditions (below 0°F or -18°C), use 0W-30 weight detergent oil that has the American Petroleum Institute (API) “service classification”—SF, SG, SH, or SJ.

IMPORTANT: Do not overfill the crankcase and run the engine; engine damage will result. Drain the excess oil until the oil level on the dipstick reads *Full*.

9. Install the dipstick.

Changing the Engine Oil

Initially, change the oil after the first two hours of engine operation; thereafter, under normal conditions, change the oil as given in the *Recommended Maintenance Schedule* on page 19. If possible, run the engine just before changing the oil because warm oil flows better and carries more contaminants.

1. Disconnect the wire from the spark plug and make sure that the wire does not contact the spark plug (Fig. 21).
2. Clean the area around the oil drain plug (Fig. 23).

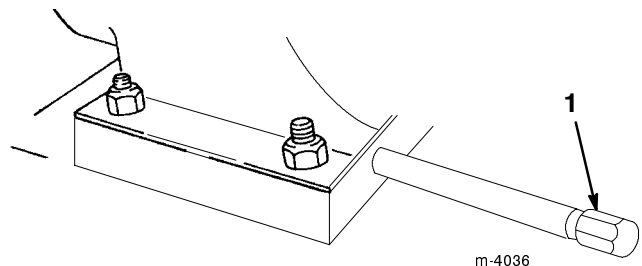

Figure 23

1. Drain plug

3. Slide an oil drain pan under the drain extension and remove the oil drain plug (Fig. 23).

4. After draining the oil, install the oil drain plug.
5. Fill the crankcase with oil. *Refer to Filling the Engine Crankcase with Oil on page 13.*
6. Wipe up any spilled oil.

Checking the Auger Gear Box Grease

Check the auger gear box grease initially, after every ten operating hours, and upon removal from annual storage.

1. Position the snowthrower on a level surface.
2. Disconnect the wire from the spark plug and make sure that the wire does not contact the spark plug (Fig. 21).
3. Clean the area around the pipe plug to remove any dirt (Fig. 24).

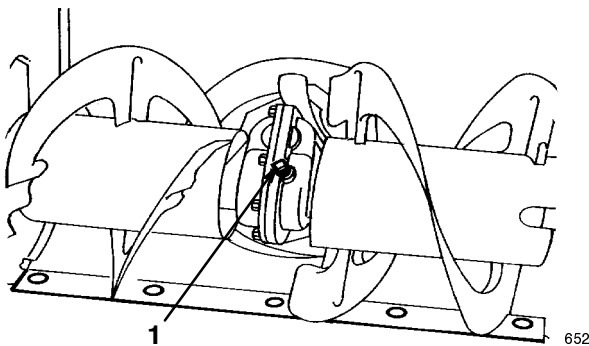

Figure 24

1. Pipe plug

4. Remove the pipe plug from the gear box (Fig. 24).
5. Check the level of grease in the gear box. The grease must be visible through the opening.
6. If the level of grease is low, add *Lubriplate MAG-1* grease (a low temperature, high-pressure grease) to the gear box until the point of overflow.
7. Install the pipe plug in the gear box.

Adjusting the Traction Drive

If the speed selector shifts properly but the snowthrower does not drive in the forward or reverse speeds, adjust the traction drive.

1. Disconnect the wire from the spark plug and make sure that the wire does not contact the plug (Fig. 21).

2. Check adjustment according to steps 3 and 6 of *Installing the Traction Rod on page 11*. Make any needed adjustments.
3. If the linkage is properly adjusted and the problem persists, contact your local Authorized Service Dealer.

Replacing the Traction Belt

If the traction belt (Fig. 27) becomes worn, oil-soaked, or otherwise damaged, replace the belt. You can purchase a new belt from your Authorized Service Dealer.

1. Disconnect the wire from the spark plug and make sure that the wire does not contact the plug (Fig. 21).
2. Remove the three screws that hold the belt cover in place and set the cover aside (Fig. 25).

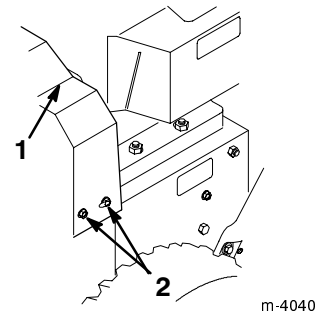

Figure 25

1. Upper belt cover
2. Screws

3. Loosen the auger brake arm assembly by loosening the rear screw and removing the front screw (Fig. 26).

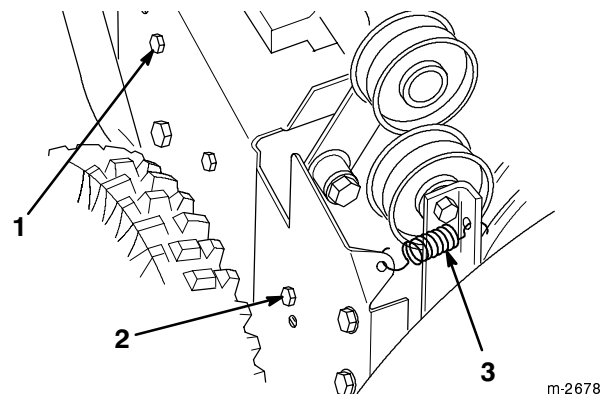

Figure 26

1. Rear screw
2. Front screw
3. Idler pulley spring

4. Remove the idler pulley spring (Fig. 26). Let the brake arm assembly hang free but out of the way.

5. Remove two screws, two washers, and two lock washers that secure the belt guide (Fig. 27).

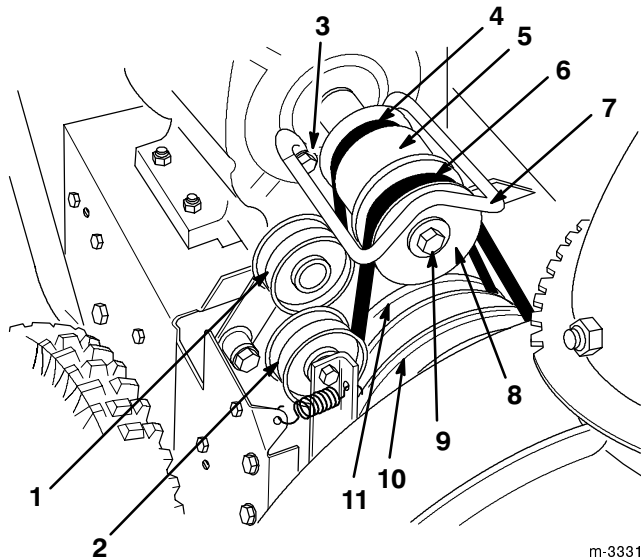

Figure 27

- | | |
|-----------------------------------|---|
| 1. Traction idler pulley | 7. Belt guide |
| 2. Idler pulley | 8. Engine pulley sheave |
| 3. Screw, washer, and lock washer | 9. Engine crankshaft screw, lock washer, and washer |
| 4. Traction belt | 10. Large auger/impeller pulley |
| 5. Engine pulley | 11. Traction pulley |
| 6. Auger/impeller drive belt | |

6. Remove the engine crankshaft screw, lock washer, and washer (Fig. 27).
7. Separate and remove the engine pulley sheave (Fig. 27).
8. Remove the auger/impeller drive belt, leaving it looped around the large auger/impeller pulley.
9. Remove the engine pulley (Fig. 27).
10. Remove the traction belt from the traction pulley and the engine crankshaft (Fig. 27).
11. Pull the traction idler pulley outward and install a new traction belt (Fig. 27).
12. Install the engine pulley.

Note: Make sure not to pinch the auger/impeller drive belt (Fig. 28).

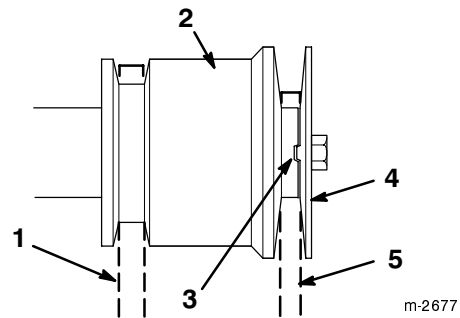

Figure 28

- | | |
|-----------------------------------|------------------------------|
| 1. Traction belt | 4. Engine pulley sheave |
| 2. Engine pulley | 5. Auger/impeller drive belt |
| 3. Indexing rib in indexing notch | |

13. Pull the idler pulley outward and loop the auger/impeller drive belt in front of the engine pulley, making sure that the belt is on the inside of the idler pulley (Fig. 27).

14. Install the engine pulley sheave, washer, lock washer, and crankshaft screw. Make sure that the indexing rib in the engine pulley sheave aligns with the indexing notch in the engine pulley (Fig. 28).

15. Make sure that the brake pad is properly installed on the brake arm. Position the angled cutoff on the brake pad as shown in Figure 29.

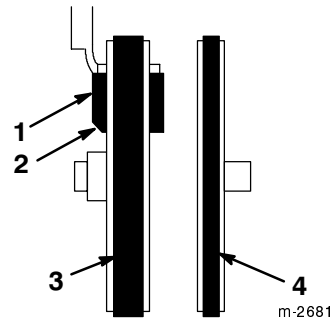

Figure 29

View from left side of unit

- | | |
|------------------|------------------------------|
| 1. Brake pad | 3. Auger/impeller drive belt |
| 2. Angled cutoff | 4. Traction belt |

16. Install the two screws that secure the auger brake arm assembly. Make sure that the tabs fit into the holes in the left side of the snowthrower (Fig. 30).

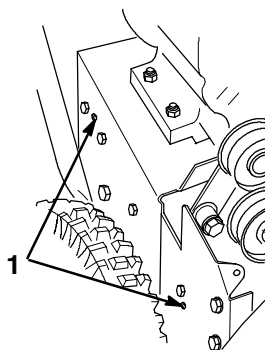

Figure 30

1. Tabs in holes

17. Have someone squeeze the auger/impeller drive control lever (Fig. 17) against the handgrip, and install the belt guide using two screws, two washers, and two lock washers.
18. Check and adjust the belt guide, making sure that it does not contact any part of the engine pulley.
19. Check and adjust the auger/impeller drive control linkage. Refer to steps 5 through 7 of *Installing the Auger/Impeller Drive Control Linkage* on page 11.
20. Install the idler pulley spring.
21. Install the belt cover with the three screws.

IMPORTANT: Do not operate the snowthrower if the auger and the impeller rotate when you disengage the auger/impeller drive control lever.

Adjusting the Auger/Impeller Drive Belt

Operating you snowthrower with an auger/impeller drive belt that slips decreases the snowthrowing performance and damages the belt.



DANGER



POTENTIAL HAZARD

- Improper adjustment may cause injury if the auger/impeller turns when disengaged.

WHAT CAN HAPPEN

- The rotating impeller or auger can cut off or injure fingers or hands.

HOW TO AVOID THE HAZARD

- Keep your face, hands, feet, and any other part of your body or clothing away from concealed, moving, or rotating parts.
- Make sure that the impeller brake arm clearance is maintained.
- Do not adjust the auger/impeller drive belt too tight because it may cause the auger/impeller to turn when the control lever is in the *Disengaged* position. If this occurs, decrease the belt tension.

IMPORTANT: Check the new auger/impeller drive belt for proper tension after the first hour, then after five to ten operating hours.

1. Disconnect the wire from the spark plug and make sure that the wire does not contact the plug (Fig. 21).
2. Check the adjustment according to steps 5 through 7 of *Installing the Auger/Impeller Drive Control Linkage* on page 11. Make any needed adjustments.
3. Check the belt tension by operating the auger.
4. If the belt still slips, replace it.
5. If the auger and the impeller rotate while the engine runs and the auger/impeller drive control lever is disengaged, immediately stop the engine and take the snowthrower to an Authorized Service Dealer for repair.

IMPORTANT: Do not operate the snowthrower if the auger and the impeller rotate when you disengage the auger/impeller drive control lever.

Replacing the Auger/Impeller Drive Belt

If the auger/impeller drive belt becomes worn, oil-soaked, or otherwise damaged, replace the belt.

IMPORTANT: After five to ten hours of operation with a new auger/impeller drive belt, check the belt to ensure the proper belt tension.

1. Disconnect the wire from the spark plug and make sure that the wire does not contact the plug (Fig. 21).

2. Remove the three screws that hold the belt cover in place and set the cover aside (Fig. 25).
 3. Loosen the auger brake arm assembly by loosening the rear screw and removing the front screw that fasten the auger brake arm assembly to the frame (Fig. 26).
 4. Remove the idler pulley spring (Fig. 26). Let the brake arm assembly to hang free but out of the way.
 5. Remove the two screws, two washers, and two lock washers that secure the belt guide (Fig. 27).
 6. Remove the engine crankshaft screw, lock washer, and washer (Fig. 27).
 7. Separate and remove the engine pulley sheave (Fig. 27).
 8. Remove the auger/impeller drive belt (Fig. 27).
 9. Pull the idler pulley outward and install a new belt around the large auger/impeller pulley (Fig. 27).
 10. Loop the belt in front of the engine pulley, making sure that the belt is on the inside of the idler pulley (Fig. 27).
 11. Install the engine pulley sheave, the washer, the lock washer, and the engine crankshaft screw.
- Note:** Make sure that the indexing rib in the engine pulley sheave aligns with the indexing notch in the center engine pulley. Also, make sure not to pinch the drive belt (Fig. 28).
12. Make sure that the brake pad is properly installed on the brake arm. Position the angled cutoff on the brake pad as shown in Figure 29.
 13. Install the two screws that secure the auger brake arm assembly. Make sure that the tabs fit into the holes in the left side of the snowthrower (Fig. 30).
 14. Have someone squeeze the auger/impeller drive control lever against the handgrip, install the belt guide using the two screws, two washers, and two lock washers.
 15. Check and adjust the belt guide. Make sure that the belt guide is about 1/8 inch (0.3 cm) from the belt or the engine pulley.
 16. Check and adjust the auger/impeller drive control linkage. Refer to steps 5 through 7 of *Installing the Auger/Impeller Drive Control Linkage* on page 11.
 17. Install the idler pulley spring.
 18. Install the belt cover with the three screws.

IMPORTANT: Do not operate the snowthrower if the auger and the impeller rotate when you disengage the auger/impeller drive control lever.

Adjusting the Skids and the Scraper

Adjust the skids and the scraper to compensate for wear and to make sure that the auger does not contact the pavement.

1. Disconnect the wire from the spark plug and make sure that the wire does not contact the plug (Fig. 21).
2. Check the tire pressure in the tires. Refer to *Checking the Tire Pressure* on page 15.
3. Move the snowthrower to a level surface.
4. Loosen the four flange nuts that secure both skids to the auger side plates (Fig. 31) until the skids slide up and down easily.

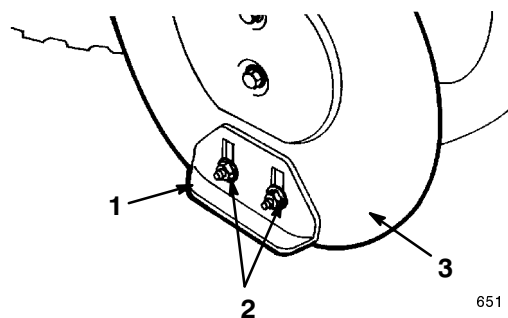

Figure 31

- | | |
|----------------|---------------------|
| 1. Skid | 3. Auger side plate |
| 2. Flange nuts | |

5. Support the **auger blades** so that they are 1/8 inch (3 mm) off the ground (Fig. 32).

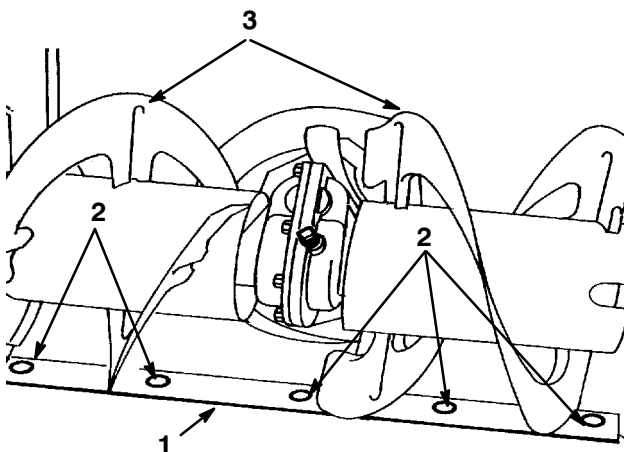

Figure 32

- | | |
|--------------------|-----------------|
| 1. Scraper | 3. Auger blades |
| 2. Mounting screws | |

6. Check the scraper adjustment. The scraper should be 1/8 inch (3 mm) above and parallel to a level surface.

For Concrete and Asphalt Surfaces:

If the snowthrower does not clear the snow close enough to the pavement, adjust the skids to lower the scraper; if the pavement surfaces are cracked, rough, or uneven, adjust the skids to raise the scraper.

For Gravel Surfaces:

Support the auger blades a few inches (centimeters) above the ground, and adjust the skids to prevent the snowthrower from picking up rocks.

7. To adjust the scraper, loosen the five mounting screws (Fig. 32), level the blade, and tighten the mounting screws.
8. Move the skids down as far as possible.
9. Tighten the four flange nuts that secure both skids to the auger side plates (Fig. 31).

Adjusting the Speed Selector

If the snowthrower is slow, the No.1 speed selection has no speed, or the speed selector does not move into the No. 3 speed selection, adjust the speed selector linkage.

1. Disconnect the wire from the spark plug and make sure that the wire does not contact the plug (Fig. 21).
2. Move the speed selector (Fig. 17) on the control panel to the R_2 (Reverse) position.
3. Remove the cotter pin and the washer. Pull the speed selector rod out of the hole in the speed selector arm (Fig. 5).
4. Adjust the forward speed by rotating the speed selector rod in the trunnion (Fig. 6).

Note: Lengthening the rod makes the forward speed faster; shortening the rod makes the forward speed slower.

5. Insert the speed selector rod into the speed selector arm and secure it with the washer and cotter pin.

Lubricating the Snowthrower

Lightly lubricate all moving parts of the snowthrower according to the *Recommended Maintenance Schedule* on page 19.

IMPORTANT: Do not get oil or grease on the rubber wheel or friction drive plate because the wheel will slip and the rubber may deteriorate.

1. Disconnect the wire from the spark plug and make sure that the wire does not contact the plug (Fig. 21).
2. Drain the gasoline from the fuel tank; refer to *Emptying the Fuel Tank* on page 26.
3. Tip the snowthrower forward onto its auger housing and block it so that it cannot fall.
4. Remove the eight screws that hold the back and the bottom covers in place and remove the covers (Fig. 33).

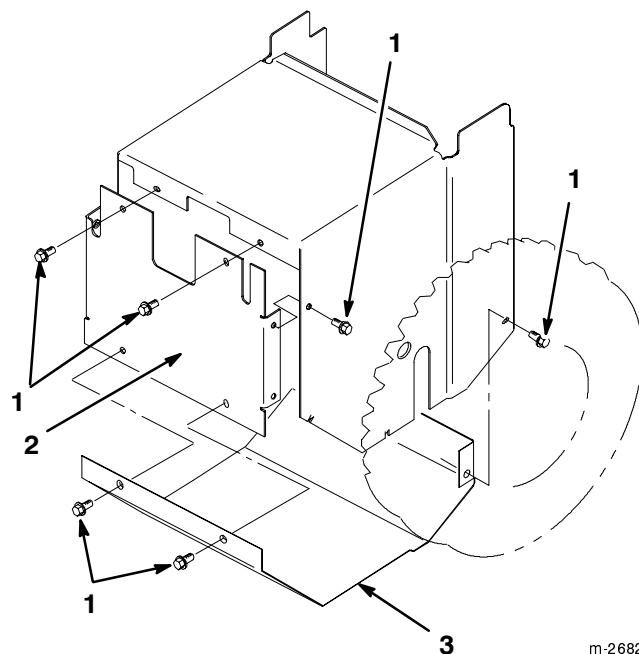

Figure 33

1. Screws
2. Back cover
3. Bottom cover

5. Lightly lubricate the snowthrower with light oil as shown in Figures 34 and 35.

IMPORTANT: Do not get oil or grease on the rubber wheel or the friction drive plate. This can cause the wheel to slip and the rubber to deteriorate.

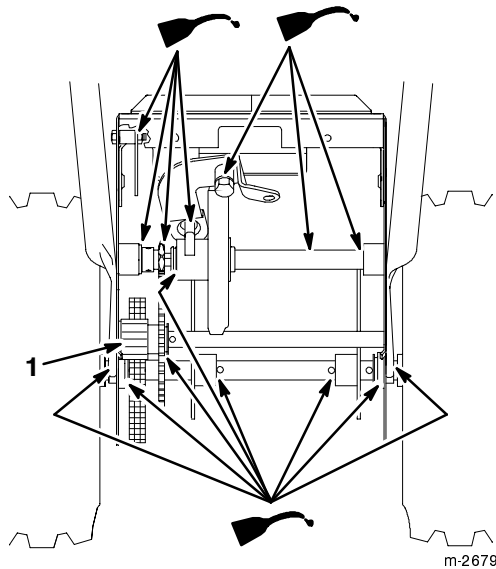

Figure 34

1. Axle gear

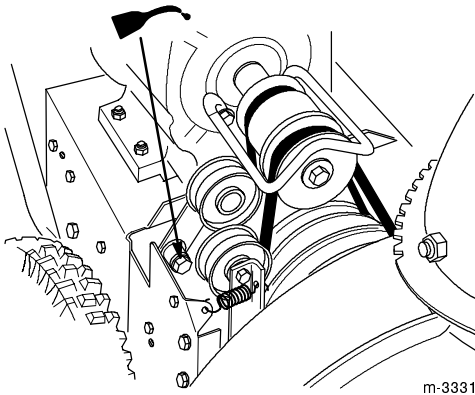

Figure 35

6. Wipe up any excess oil.
7. Lightly grease the axle gear (Fig. 34).
8. Wipe up any excess grease.
9. Install the back and the bottom covers.

Replacing the Spark Plug

Use a *Champion RJ-19LM* spark plug or equivalent. Since the air gap between the center and the side electrodes of the spark plug increases gradually during normal engine operation, install a new plug after every 100 operating hours.

1. Clean the area around the spark plug so that foreign matter does not fall into the cylinder when removing the spark plug.
2. Disconnect the wire from the spark plug (Fig. 21) and remove the plug from the cylinder head.

IMPORTANT: Replace a cracked, fouled, or dirty spark plug. Do not sandblast, scrape, or clean the electrodes because grit may eventually release from the plug and fall into the cylinder and cause engine damage.

3. Set the air gap between the spark plug electrodes at 0.030 inch (0.76 mm) (Fig. 36).

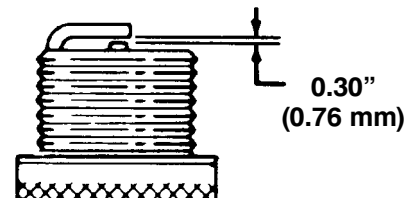

Figure 36

4. Install the spark plug in the cylinder head.
5. Torque the spark plug to 15 ft-lb (20.4 N·m).
6. Connect the wire to the spark plug.

Emptying the Fuel Tank

1. Disconnect the wire from the spark plug (Fig. 21)
2. Close the fuel shutoff valve (Fig. 19).



WARNING



POTENTIAL HAZARD

- Gasoline is highly flammable.

WHAT CAN HAPPEN

- Gasoline can ignite and cause serious personal injury.

HOW TO AVOID THE HAZARD

- Drain gasoline outdoors.
- Drain gasoline from a cold engine only.
- Wipe up any gasoline that may have spilled.
- Do not drain gasoline near any open flame or where gasoline fumes may be ignited by a spark.
- Do not smoke a cigar, a cigarette, or a pipe when handling gasoline.

3. Place a clean drain pan under the fuel shutoff valve.
4. Loosen the hose clamp that secures the fuel line to the valve and slide the line off the valve (Fig. 19).

5. Open the fuel shutoff valve by rotating it counterclockwise to allow the fuel to flow into the drain pan.
6. Install the fuel line and secure it with a hose clamp.
7. Connect the wire to the spark plug.
8. Start the snowthrower and run the engine until it stops.



Troubleshooting

Toro designed and built your snowthrower for trouble-free operation. Check the following components and items carefully, and refer to *Maintenance* on page 19 for more information. If a problem continues, see your Authorized Service Dealer.

PROBLEM	POSSIBLE CAUSES	CORRECTIVE ACTION
Electric starter does not crank (electric start models only)	<ol style="list-style-type: none"> 1. The power cord is disconnected at the outlet or the snowthrower. 2. The power cord is worn, corroded, or damaged. 3. The power outlet is not energized. 	<ol style="list-style-type: none"> 1. Connect the power cord to the outlet and/or the snowthrower. 2. Replace the power cord. 3. Have a qualified electrician energize the power outlet.
Engine does not start or starts hard	<ol style="list-style-type: none"> 1. The key is not in the ignition or is in the <i>Off</i> position. 2. The choke is in the <i>Off</i> position and the primer has not been pressed. 3. The fuel shutoff valve is not open. 4. The throttle is not in the <i>Fast</i> position. 5. The fuel tank is empty or the fuel system contains stale fuel. 6. The spark plug wire is loose or disconnected. 7. The spark plug is pitted, fouled, or the gap is incorrect. 8. The fuel cap vent is restricted. 9. The engine oil level in the engine crankcase is too low or too high. 10. The air temperature is above 40°F (4°C) and the heater box is on the snowthrower. 	<ol style="list-style-type: none"> 1. Insert the key into the ignition and turn it to the <i>On</i> position. 2. Move the choke to the <i>On</i> position and press the primer three times. 3. Open the fuel shutoff valve. 4. Move the throttle to the <i>Fast</i> position. 5. Drain and/or fill the fuel tank with fresh gasoline (not more than 30 days old). If the problem persists, contact your Authorized Service Dealer. 6. Connect the wire to the spark plug. 7. Clean the spark plug and check and adjust the spark plug gap. Replace the spark plug if it is damaged. 8. Remove the vent restriction or replace the fuel cap. 9. Add or drain the oil level in the engine crankcase to the <i>Full</i> mark on the dipstick. 10. Remove the heater box if you operate the snowthrower when the air temperature is above 40°F (4°C).

PROBLEM	POSSIBLE CAUSES	CORRECTIVE ACTION
Engine runs rough	<ol style="list-style-type: none"> 1. The choke is in the <i>On</i> position. 2. The fuel shutoff valve is not completely open. 3. The fuel tank is nearly empty or contains stale fuel. 4. The spark plug wire is loose. 5. The spark plug is pitted, fouled, or the gap is incorrect. 6. The engine oil level in the engine crankcase is too low or too high. 7. The air temperature is above 40°F (4°C) and the heater box is on the snowthrower. 	<ol style="list-style-type: none"> 1. Move the choke to the <i>Off</i> position. 2. Open the fuel shutoff valve. 3. Drain and fill the fuel tank with fresh gasoline (not more than 30 days old). If the problem persists, contact your Authorized Service Dealer. 4. Connect the wire to the spark plug. 5. Clean the spark plug and check and adjust the spark plug gap. Replace the spark plug if it is damaged. 6. Add or drain the oil level in the engine crankcase to the <i>Full</i> mark on the dipstick. 7. Remove the heater box if you operate the snowthrower when the air temperature is above 40°F (4°C).
Engine runs, but the snowthrower discharges snow poorly or not at all	<ol style="list-style-type: none"> 1. The throttle is not in the <i>Fast</i> position when throwing snow. 2. The snowthrower is moving too fast to clear the snow. 3. You are trying to remove too much snow per swath. 4. The discharge chute is plugged. 5. You are trying to remove extremely heavy or wet snow. 6. The auger/impeller drive belt is loose or is off the pulley. 7. The auger/impeller drive belt is worn or broken. 	<ol style="list-style-type: none"> 1. Move the throttle to the <i>Fast</i> position when throwing snow. 2. Shift the snowthrower into a lower gear. 3. Reduce the amount of snow removed for per swath. 4. Stop the engine, wait for all moving parts to stop, and use a stick to remove the snow from the discharge chute. 5. Don't overload the snowthrower with extremely heavy or wet snow. 6. Install and/or adjust the auger/impeller drive belt. 7. Replace the auger/impeller drive belt.
Snowthrower does not properly clear the snow off the surface	<ol style="list-style-type: none"> 1. The tire pressure is low. 2. The skids and/or the scraper is not properly adjusted. 	<ol style="list-style-type: none"> 1. Check the pressure in the tires and adjust it if necessary. 2. Adjust the skids and the scraper.

Storage

**WARNING**

POTENTIAL HAZARD

- Gasoline fumes are highly flammable, explosive, and dangerous if inhaled.

WHAT CAN HAPPEN

- If the product is stored in an area with an open flame, the gasoline fumes may be ignited, causing an explosion.

HOW TO AVOID THE HAZARD

- Do not store the snowthrower in a house (living area), basement, or any other area where ignition sources may be present, such as hot water and space heaters, clothes dryers, furnaces, and other like appliances.

Preparing the Fuel System

1. Add stabilizer/conditioner to the fuel in the fuel tank as directed.
2. Run the engine for ten minutes to distribute conditioned fuel through the fuel system.
3. Stop the engine, allow it to cool, and drain the fuel tank or run the engine until it stops.
4. Start the engine and run it until it stops.
5. Choke or prime the engine, start it a third time, and run the engine until it will not start.
6. Dispose of unused fuel properly. Recycle it according to local codes.

Note: Do not store stabilized gasoline for more than 90 days.

Preparing the Engine

1. Remove the spark plug from the cylinder head.
2. Pour two teaspoons of oil into the spark plug hole.
3. Install the spark plug, but do not connect the wire to the plug.
4. Pull the recoil starter slowly to distribute the oil on the inside of the cylinder.
5. Change the engine oil. Refer to *Changing the Engine Oil* on page 20.

Preparing the Snowthrower

1. Lubricate the snowthrower. Refer to *Lubricating the Snowthrower* on page 25.

2. Clean the snowthrower.
3. Touch up chipped surfaces with paint available from an Authorized Service Dealer. Sand affected areas before painting, and use a rust preventative to prevent the metal parts from rusting.
4. Tighten all screws and nuts. Repair or replace any damaged parts.
5. Cover the snowthrower and store it in a clean, dry place out of the reach of children. Allow the engine to cool before storing it in any enclosure.

Accessories

You can obtain the following snowthrower accessories from your Authorized Service Dealer:

- 230-Volt Electric Starter
- Tire Chain Kit
- Drift Breaker Kit
- Light Kit
- Snow Cab Kit

