



# 60V Pole Saw Harness

Model No. 88622

Form No. 3443-380 Rev A

## Installation Instructions

# Installation

## Installing the Harness

**Important:** If you are operating pole saw Model 51870/T with battery pack Model 88640, 88660, or 88675, you must install this harness for proper support and balance.

Connect the metal hook on the shoulder harness to the strap collar on the pole saw handle (Figure 1).

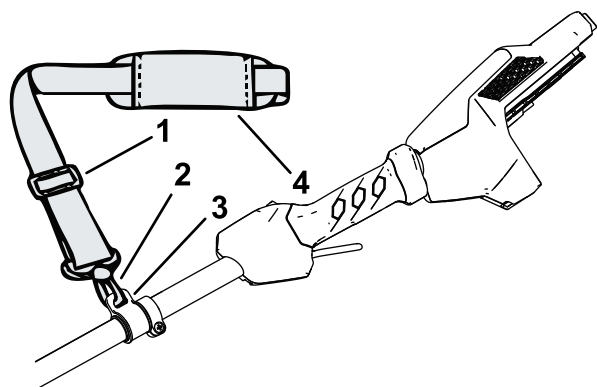

g340476

Figure 1

- |                     |                   |
|---------------------|-------------------|
| 1. Strap adjuster   | 3. Strap collar   |
| 2. Metal strap hook | 4. Shoulder strap |

The strap length is adjustable; slide the strap adjuster up to decrease the length of the strap, or down to increase the length of the strap (Figure 1).

If there is ever an emergency and you need to rapidly remove the harness, disconnect the quick-release buckle as follows:

1. Press in on the sides of the buckle (A of Figure 2).
2. Allow the buckle to disconnect (B of Figure 2).

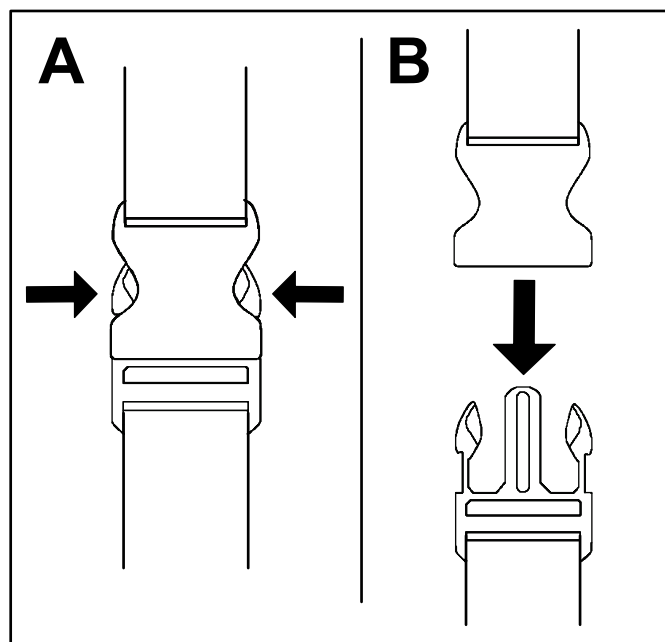

g340477

Figure 2





**Count on it.**