



518xi, 520xi & 522xi Wheel Horse® Garden Tractors

Model Numbers 73471, 73542,
and 73561—210000001 & Up

Setup
Instructions

Loose Parts

Note: Use the chart below to identify parts for assembly.

DESCRIPTION	QTY.	USE
Bolt, 1/4-20 x 0.88 in.	2	Attaching the battery cables
Washer, 1/4 in.	2	
Hex Nut, 1/4-20 in.	2	
Hitch Pin	1	Installing the drawbar hitch pin
Hairpin Cotter	1	
Flat Washer, 0.50 in inside diameter	1	
Key	2	Use in ignition and KeyChoice™ switches
Operator's Manual	1	Read before operating the tractor
Engine Operator's Manual	1	Read before operating the tractor
Riding Mower Safety Video	1	Watch before operating the tractor

Checking Front Wheel Toe-in

With the tractor on a level surface, check to make sure the front wheel toe-in is between 1/8 and 1/4 in. For instructions on adjusting toe-in, refer to the Maintenance section in the tractor *Operator's Manual*.

Check to Ensure that the Steering Linkage is Centered

1. With the tractor on a level surface, turn the steering wheel fully to the left and check the clearance of the left hand spindle stop to the stop on the front axle.

There should be a slight clearance between the stops (Fig. 1).

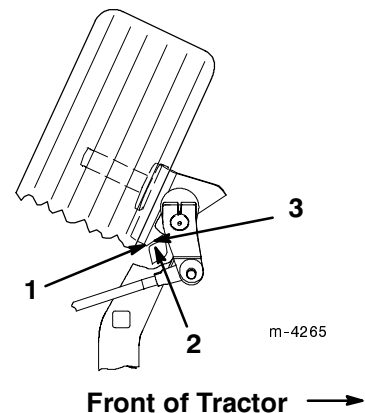

Figure 1

1. Left hand spindle stop
2. Axle stop
3. Clearance

2. Repeat for the right front tire in a right turn.

- If the stops on one side hit, and on the other side have clearance, shorten the tie rod on the side that hits, and equally lengthen the tie rod on the opposite side until both sides have clearance.
- Check the toe-in adjustment.

Checking Tire Pressure

Check front and rear tire pressure. The correct front and rear tire pressure is 20 psi (138 kPa).

Activating the Battery



Warning



Battery posts, terminals, and related accessories contain lead and lead compounds, chemicals known to the State of California to cause cancer and reproductive harm. Wash hands after handling.

Bulk electrolyte with 1.265 specific gravity must be purchased from a local battery supply outlet.



Danger



Battery electrolyte contains sulfuric acid which is a deadly poison and causes severe burns.

- Do not drink electrolyte and avoid contact with skin, eyes or clothing. Wear safety glasses to shield your eyes and rubber gloves to protect your hands.
- Fill the battery where clean water is always available for flushing the skin.

- Remove the battery from the tractor.
 - Clean the top of the battery with a paper towel.
- Note:** Never fill the battery with electrolyte while the battery is installed in the tractor. Electrolyte could be spilled on other parts and cause corrosion.
- Remove the vent caps from the battery (Fig. 2).
 - Slowly pour electrolyte into each battery cell until the level is up to the upper line (Fig. 2) on the battery case.

Important Do not overfill the battery because electrolyte (sulfuric acid) can cause severe corrosion and damage to the chassis.

- Wait five to ten minutes after filling the battery cells. Add electrolyte, if necessary, until the electrolyte level is up to the upper line (Fig. 2) on the battery case.

- Install battery filler caps.

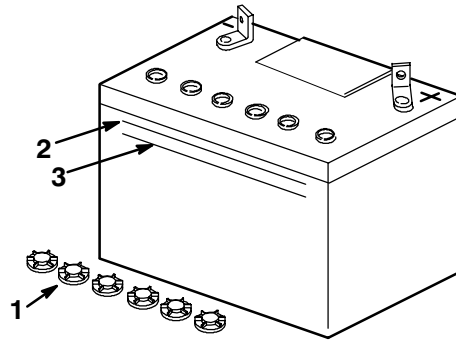

m-5004

Figure 2

- Filler caps
- Upper line
- Lower line

- Charge battery for 10 to 15 minutes at 25 to 30 amps or 30 minutes at 4 to 6 amps.



Warning



Charging the battery produces gasses that can explode.

Never smoke near the battery and keep sparks and flames away from battery.

- When the battery is fully charged, unplug the charger from the electrical outlet, then disconnect the charger leads from the battery posts (Fig. 3).

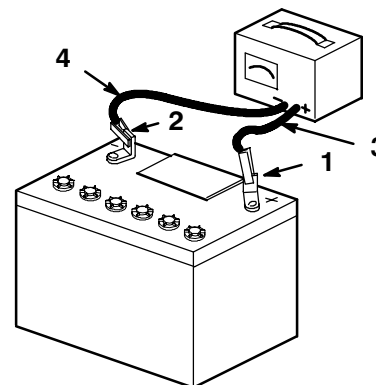

m-4970

Figure 3

- Positive Battery Post
- Negative Battery Post
- Red (+) Charger Lead
- Black (-) Charger Lead

- Install the battery in the tractor and connect the battery cables. (Refer to the Operator's Manual - Installing the Battery.)

Note: Do not run the tractor with the battery disconnected, electrical damage may occur.

Installing the Drawbar Hitch Pin

Insert the drawbar hitch pin into the drawbar hitch and secure it with a 0.50 in. inside diameter flat washer and hairpin cotter (Fig. 4).

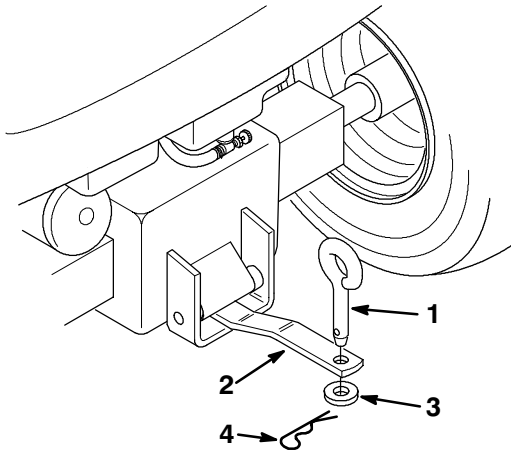

m-2481

Figure 4

- | | |
|----------------------|---------------------|
| 1. Drawbar hitch pin | 3. .50" Flat washer |
| 2. Drawbar hitch | 4. Hairpin cotter |

5. Open the fuel shutoff valve and check the fuel hose and fittings for leaks.
6. As applicable, check and test the operation of the following:
 - Engine, choke and throttle controls
 - Gauges
 - Headlights and taillights
 - Indicator lights
 - PTO clutch and brake
 - Lift system
 - Service and parking brakes
 - Transmission controls
 - Steering
 - Tractor operation in forward and reverse
7. Test the operation of the safety interlock system (refer to the tractor *Operator's Manual* for the correct procedure).

Checking the Wiring and Fasteners

- Inspect the tractor for any loose electrical connections and secure them as required.
- Check the wire routing to make sure moving parts do not interfere with wires and cause a short.
- Ensure that all fasteners are tight.

Test Driving the Tractor

1. Check the oil level in the crankcase (refer to Engine Oil in your tractor *Operator's Manual* for oil type, viscosity, and crankcase capacity).

Note: When checking the oil level, slide the dipstick all the way into the filler tube, but do not screw the dipstick onto the filler tube.

2. Check the oil level in the transaxle (refer to Transaxle Fluid in your tractor *Operator's Manual* for oil type, viscosity, and capacity).
3. Check to make sure all lubrication points have been greased as shown in the Maintenance section of tractor *Operator's Manual*.
4. Fill the tank with unleaded regular gasoline with an octane rating of at least 85.

