



---

# Parts Catalog

## QuickGroom 700 Standard

Model No. 46402AA—Serial No. 321000001 and Up



# Ordering Replacement Parts

To order replacement parts, please supply the part number, the quantity, and the description of each part desired.

## Understanding Reference Numbers

Each identified part in an illustration has a reference number. The reference number for a part also appears in the parts list, along with other information about the part.

This catalog uses two special reference number formats, one to indicate parts in a service assembly and another to indicate the quantity of a given part in an illustration.

## Service Assembly Reference Numbers

Parts in service assemblies have reference numbers in the form a:b. The a represents the reference number of the entire service assembly and the b represents a sequential number unique to each part within the service assembly.

For example, a wheel assembly might be identified by reference number 6, the tire by 6:1, the valve by 6:2, and the wheel by 6:3. When you order the assembly identified by reference number 6, you receive all parts identified by reference numbers 6:1, 6:2, and 6:3. However, you may also order any part individually. Reference numbers of this type appear in illustration and in parts lists.

## Reference Numbers Indicating Quantity

In an illustration, if a reference number indicates more than one part, the reference number has the form nX y. The n represents the quantity of the part, the X is the multiplication symbol, and the y represents the reference number.

For example, in an illustration, the reference number 2X 37 means that two of the parts identified by reference number 37 are indicated.

# Contents

Brush Assembly ..... 4

Attachments and Accessories ..... 6

# Brush Assembly

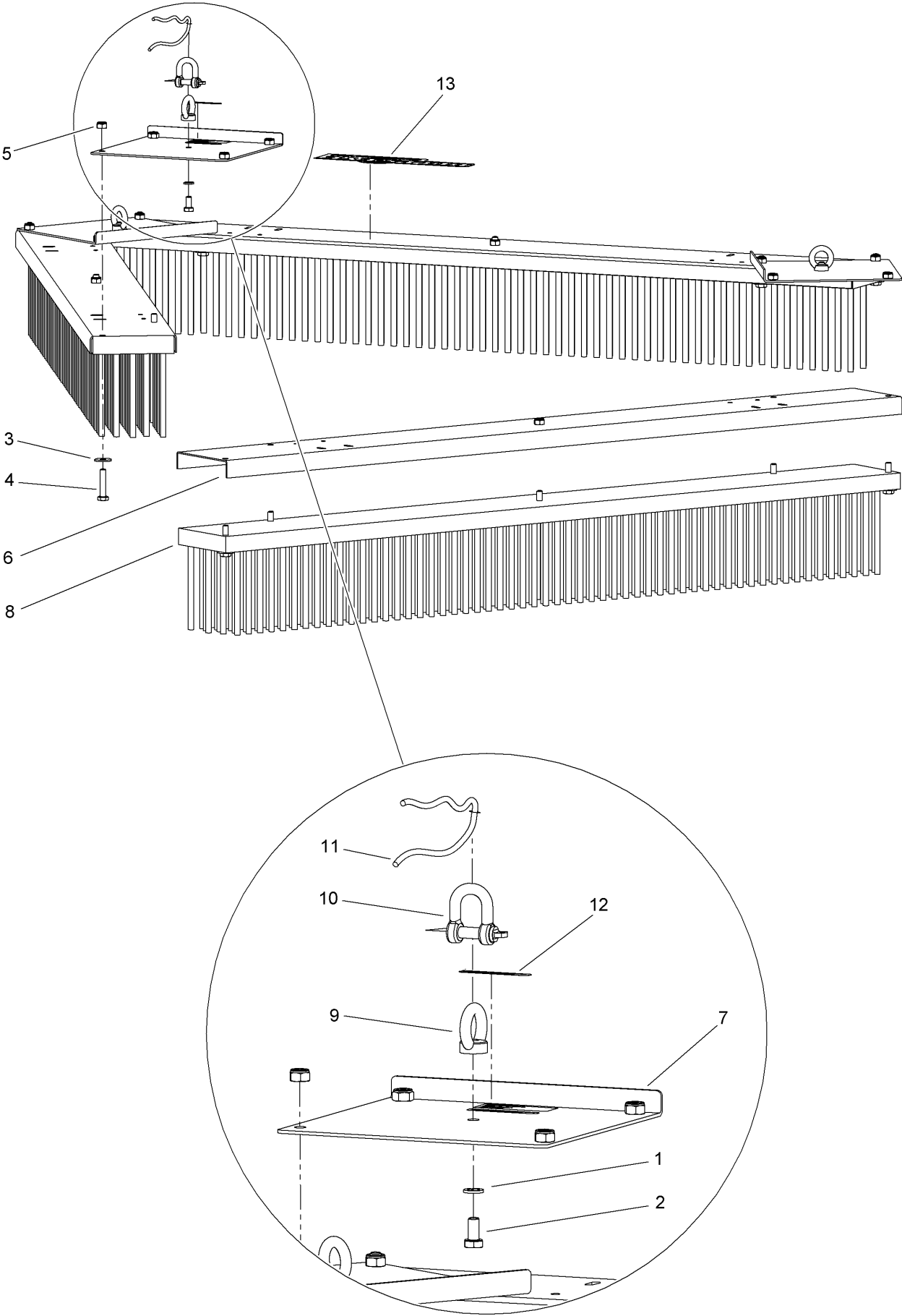

## Brush Assembly (continued)

<i>Ref.</i>	<i>Part Number</i>	<i>Qty.</i>	<i>Description</i>	<i>Ref.</i>	<i>Part Number</i>	<i>Qty.</i>	<i>Description</i>
1	144-7921	3	Spring Washer M10 - Din 127	7	144-7786	3	Connection Plate Qg700
2	144-8109	3	Bolt M10 X 20 - ISO 4017	8	144-7778	3	Brush
3	144-7946	15	Large Washer M10 - Din 9021	9	144-8111	3	Eye Nut M10 Din 582
4	144-8110	15	Bolt M10 X 50 - ISO 4014	10	144-8112	1	D-Shackle D1-10
5	144-7717	15	Nut, Self Locking - M 10	11	144-8113	1	Nylon Rope Ø10, L-2.5Mtr
6	144-7787	3	Mounting Plate Qg700	12	133-8061	2	Decal-Warning
				13	136-3653	1	Decal-Quickgroom 700

# Attachments and Accessories

For 46402AA QuickGroom 700 Standard

Product Name	Model/Part
Wheel Set .....	46403

**Notes:**

