



Parts Catalog

QuickGroom 700 Soft

Model No. 46402BA—Serial No. 321000001 and Up



Ordering Replacement Parts

To order replacement parts, please supply the part number, the quantity, and the description of each part desired.

Understanding Reference Numbers

Each identified part in an illustration has a reference number. The reference number for a part also appears in the parts list, along with other information about the part.

This catalog uses two special reference number formats, one to indicate parts in a service assembly and another to indicate the quantity of a given part in an illustration.

Service Assembly Reference Numbers

Parts in service assemblies have reference numbers in the form a:b. The a represents the reference number of the entire service assembly and the b represents a sequential number unique to each part within the service assembly.

For example, a wheel assembly might be identified by reference number 6, the tire by 6:1, the valve by 6:2, and the wheel by 6:3. When you order the assembly identified by reference number 6, you receive all parts identified by reference numbers 6:1, 6:2, and 6:3. However, you may also order any part individually. Reference numbers of this type appear in illustration and in parts lists.

Reference Numbers Indicating Quantity

In an illustration, if a reference number indicates more than one part, the reference number has the form nX y. The n represents the quantity of the part, the X is the multiplication symbol, and the y represents the reference number.

For example, in an illustration, the reference number 2X 37 means that two of the parts identified by reference number 37 are indicated.

Contents

Brush Assembly 4

Attachments and Accessories 6

Brush Assembly

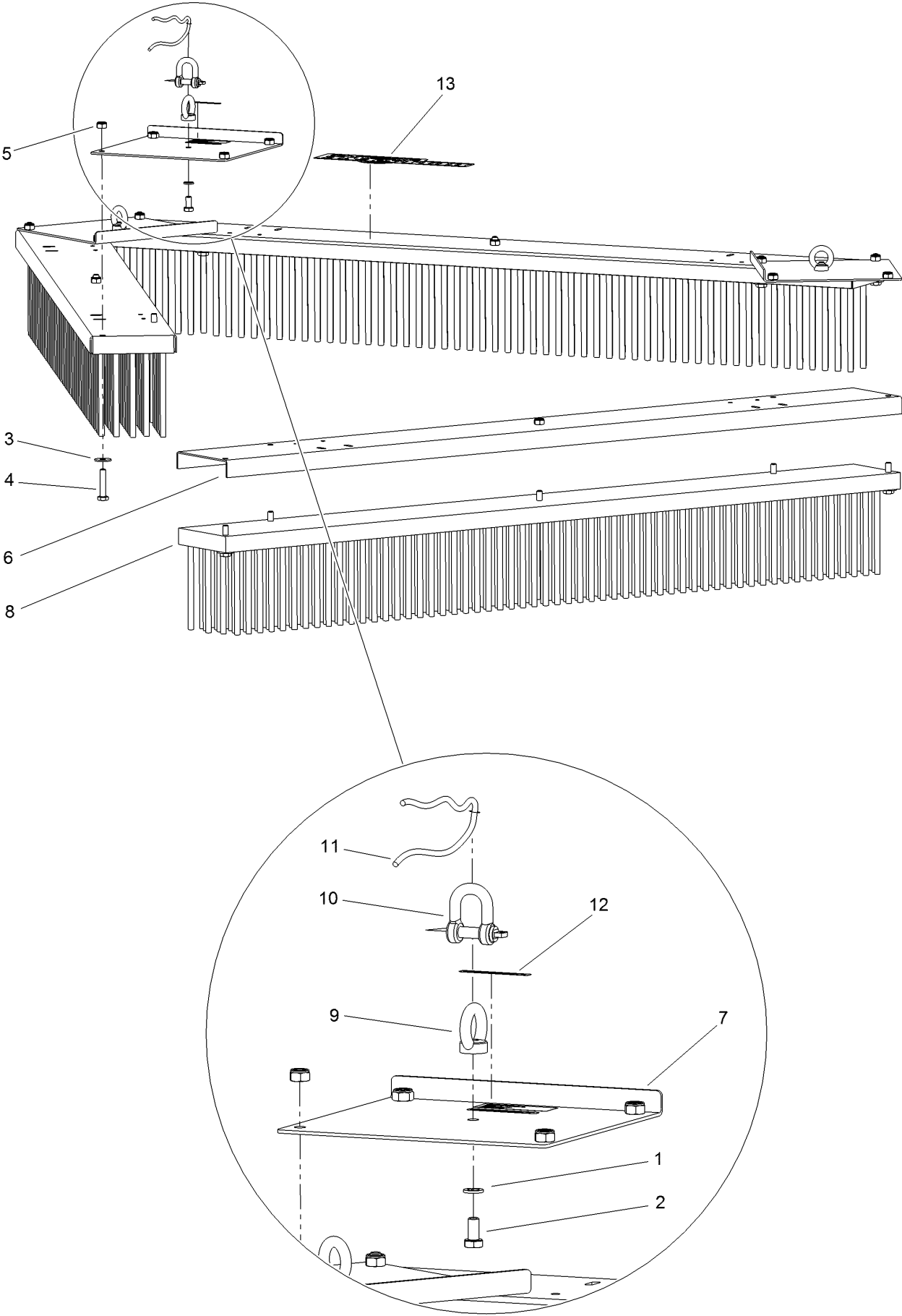

Brush Assembly (continued)

<i>Ref.</i>	<i>Part Number</i>	<i>Qty.</i>	<i>Description</i>	<i>Ref.</i>	<i>Part Number</i>	<i>Qty.</i>	<i>Description</i>
1	144-7921	3	Spring Washer M10 - Din 127	7	144-7786	3	Connection Plate Qg700
2	144-8109	3	Bolt M10 X 20 - ISO 4017	8	144-8114	3	Brush
3	144-7946	15	Large Washer M10 - Din 9021	9	144-8111	3	Eye Nut M10 Din 582
4	144-8110	15	Bolt M10 X 50 - ISO 4014	10	144-8112	1	D-Shackle D1-10
5	144-7717	15	Nut, Self Locking - M 10	11	144-8113	1	Nylon Rope Ø10, L-2.5Mtr
6	144-7787	3	Mounting Plate Qg700	12	133-8061	1	Decal-Warning
				13	136-3653	1	Decal-Quickgroom 700

Attachments and Accessories

For 46402BA QuickGroom 700 Soft

Product Name	Model/Part
Wheel Set	46403

Notes:

