



Sound Reducing Kit

Groundsmaster® 3200 or 3300 Series Traction Unit with Winter Enclosure

Model No. 140-6721

Installation Instructions

Installation

The Sound Reducing Kit can be installed on the following:

- Traction units (Models 31903 and 31909)
- Winter enclosure (Model 31990)

1

Preparing the Machine

No Parts Required

Procedure

1. Park the machine on a level surface.
2. Engage the parking brake.
3. Lower the attachment.
4. Shut off the engine and remove the key.
5. Disconnect the battery; refer to the electrical system maintenance section in your *Operator's Manual*.

2

Installing the Floor Components

Parts needed for this procedure:

1	Steering plug
1	Upper steering plug
1	Lower steering plug
1	Steering pad
3	Mounting-tab plug
1	Corner floor pad
1	Center floor pad
1	Brake plug—7.6 cm (3 inches) width
1	Brake plug—3.1 cm (1.22 inch) width
4	ROPS plug
1	Seat-base pad (thin)
1	Seat-base pad (thick)
1	Seat pad
1	Rear-window pad
1	Lower-firewall pad
1	Upper-firewall pad
1	Firewall tile pad
1	Upper brake foam
1	Lower brake foam
1	Right corner pad
1	Left corner pad



Installing the Steering Cover and Steering-Column Plugs

1. Remove the fasteners and lift the steering cover up out of the way (Figure 1).

Note: While you install the plugs/pads in this procedure, you can use string to secure the steering cover to the steering wheel.

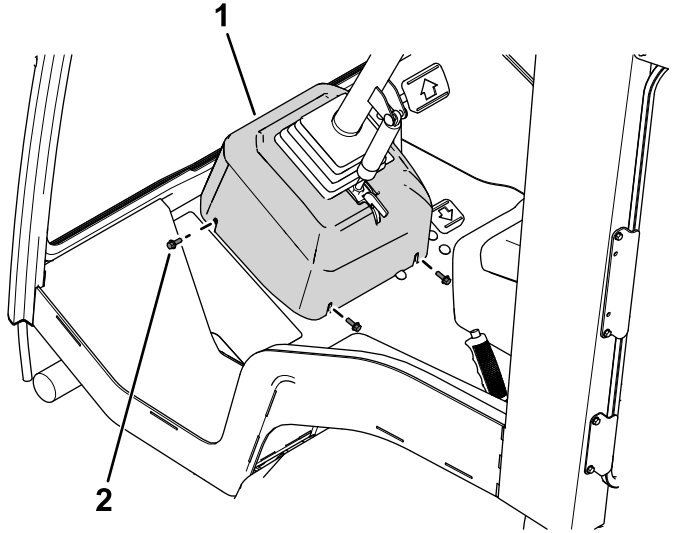

Figure 1

1. Steering cover
2. Bolt

2. Use a utility knife to cut the upper and lower steering column plugs as shown in Figure 2.

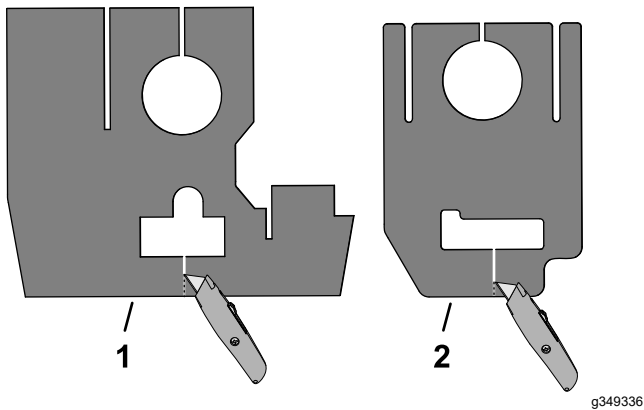

Figure 2

1. Upper steering column plug
2. Lower steering column plug

3. Remove the backing film from the pressure sensitive adhesive (PSA) side of the 2 plugs as shown in Figure 3.

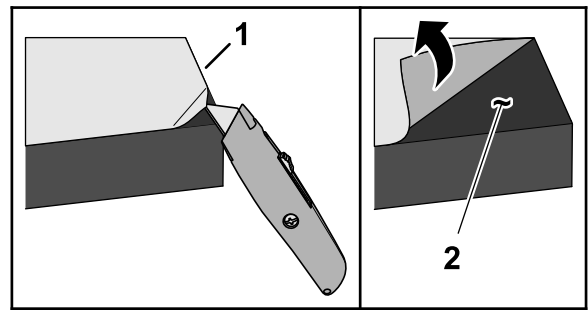

Figure 3

1. Backing film
2. Pressure sensitive adhesive (plug)

4. Install the upper steering plug (Figure 4).

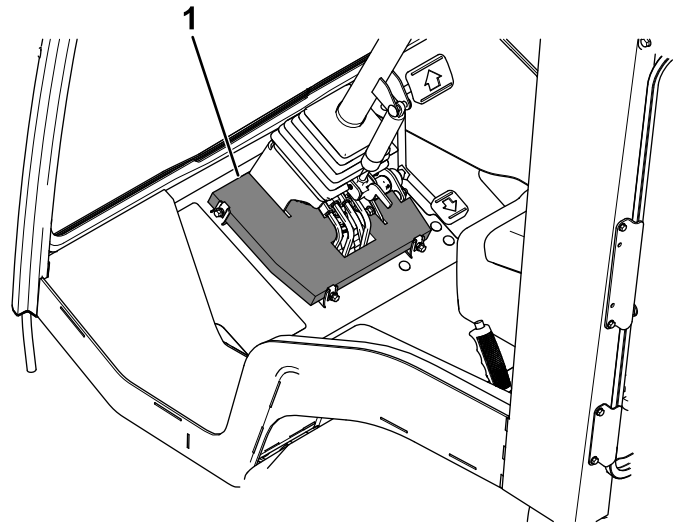

Figure 4

1. Upper steering plug (PSA)

5. Install the lower steering plug as shown in Figure 5. Ensure that it is adhered to upper steering plug.

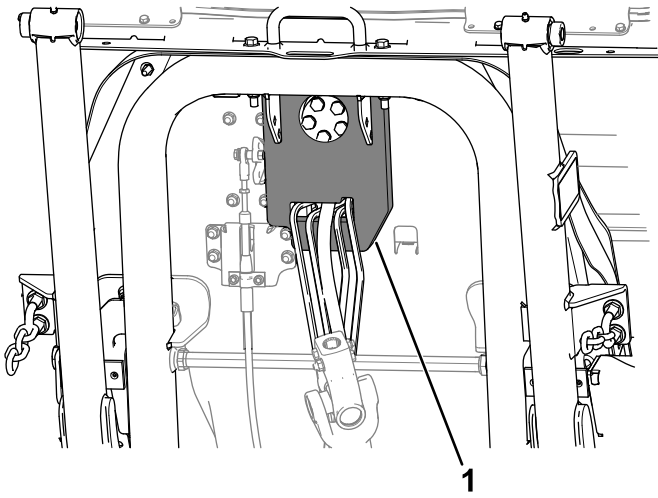

Figure 5

g330591

1. Lower steering plug (PSA)

6. Remove the backing film and install the steering pad (Figure 6).

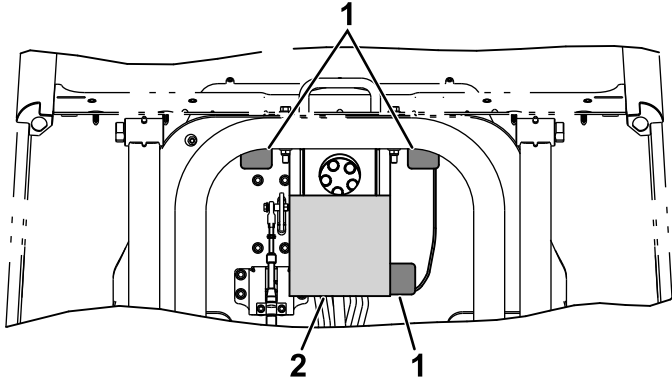

Figure 6

g330645

1. Mounting-tab plugs (PSA) 2. Steering pad (PSA)

7. Remove the backing film and install the 3 mounting-tab plugs over holes in floor pan. (Figure 6).
8. Remove the backing film and install the steering plug to the steering cover (Figure 7).

Figure 8 shows a top view of the installed steering plug in the steering cover.

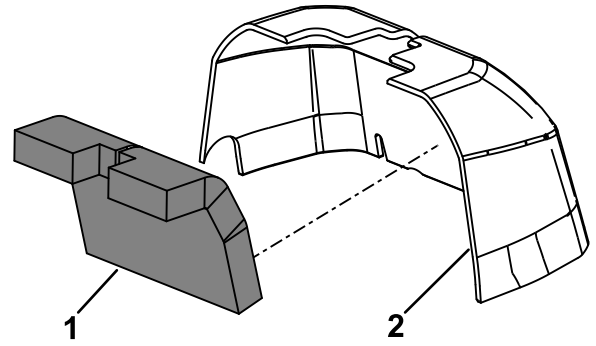

Figure 7

g331281

1. Steering plug (PSA)
2. Steering cover (cutaway view shown)

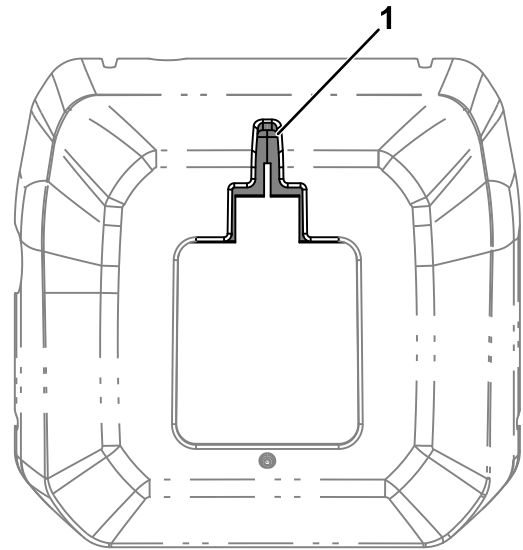

Figure 8

Top view

g331294

1. Steering plug

9. Install the steering cover (Figure 9).

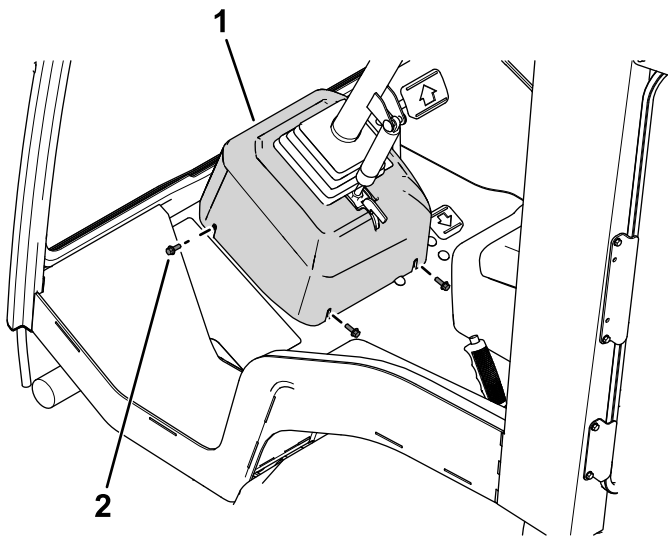

Figure 9

g330592

1. Steering cover 2. Bolt

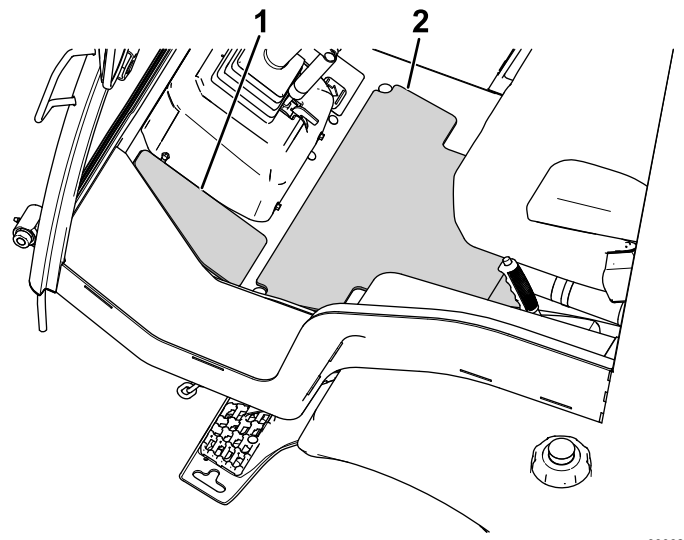

Figure 11

g330624

1. Corner floor pad (PSA) 2. Center floor pad (PSA)

Installing the Floor Pads

1. Remove the rubber floor mat (Figure 10).

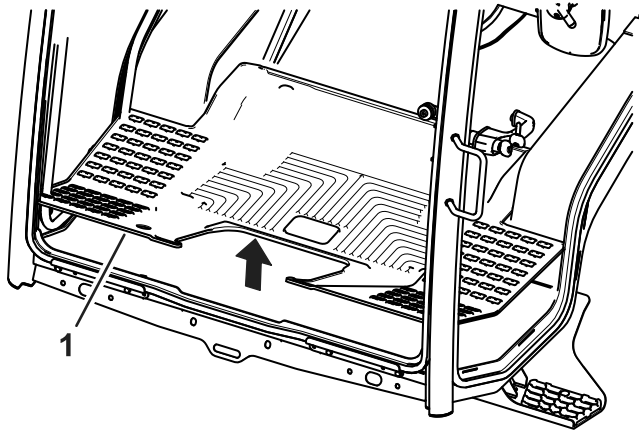

Figure 10

g331308

1. Rubber floor mat

2. Remove the backing film, and install the center and corner floor pads to the platform floor (Figure 11).

Removing the Seat

Perform the following steps to remove the seat from the seat base:

1. Remove the nuts that secures the seat to the seat base (Figure 12).

Note: Retain the nuts.

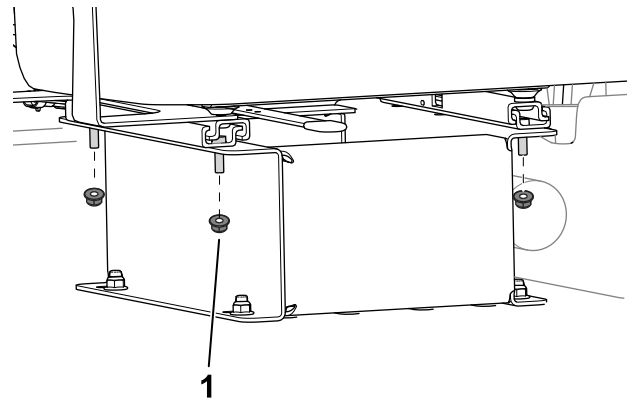

Figure 12

g299346

1. Nut

2. Remove any wire-harness connections from the seat.
3. Remove the seat from the seat base.
 - Note the position of the mounted seat to the seat base, as the seat needs to be re-installed in the same holes.
 - To install the seat pads (steps 1 through 3), have an assistant hold the seat above the seat base.

Installing the Brake Cover and Plugs

1. Remove the push-in fasteners that secure the brake cover to the floor (Figure 13).
 - Left side of the brake cover: Cut the plugs.
 - Right side of the brake cover: Pull the plugs out of the cover and retain the plugs.

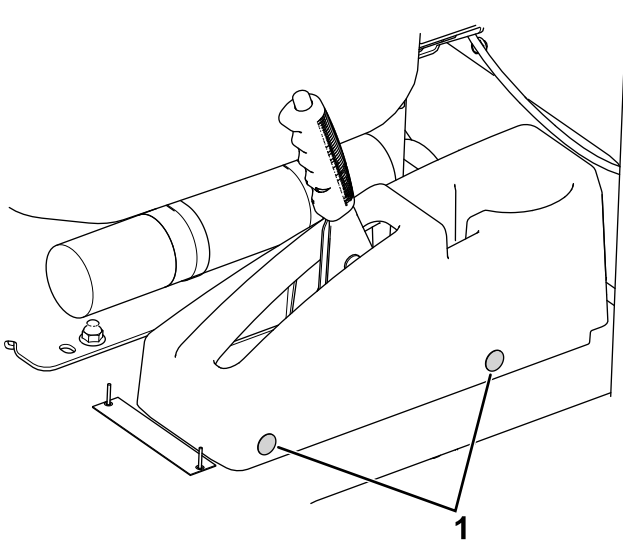

Figure 13

g301501

1. Plugs (4 total—2 shown)

2. Remove the brake cover.
3. If the optional USB charging kit is installed, perform the following steps:
 - A. Disconnect the 2 wire terminals from the USB port in the brake cover.
 - B. Remove the USB port from the brake cover.
4. Remove the backing film and install the brake plugs (Figure 14).

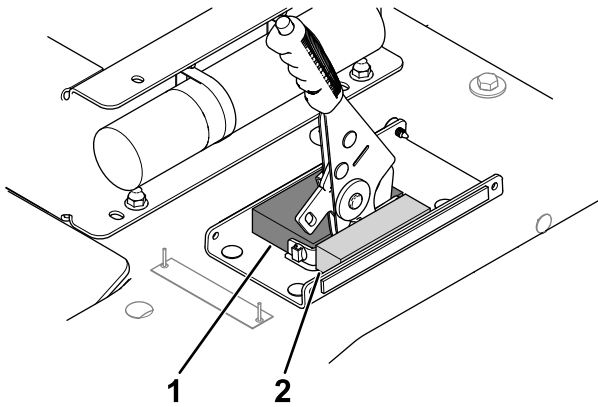

Figure 14

g330731

1. Brake plug (7.6 cm or 3 inches width—PSA)
2. Brake plug (3.1 cm or 1.22 inch width—PSA)

5. Remove the backing film from the top of the upper brake-cover foam, and install it to the brake cover (Figure 15).

Figure 16 shows a top and cutaway (side) view of the foam installed in the cover.

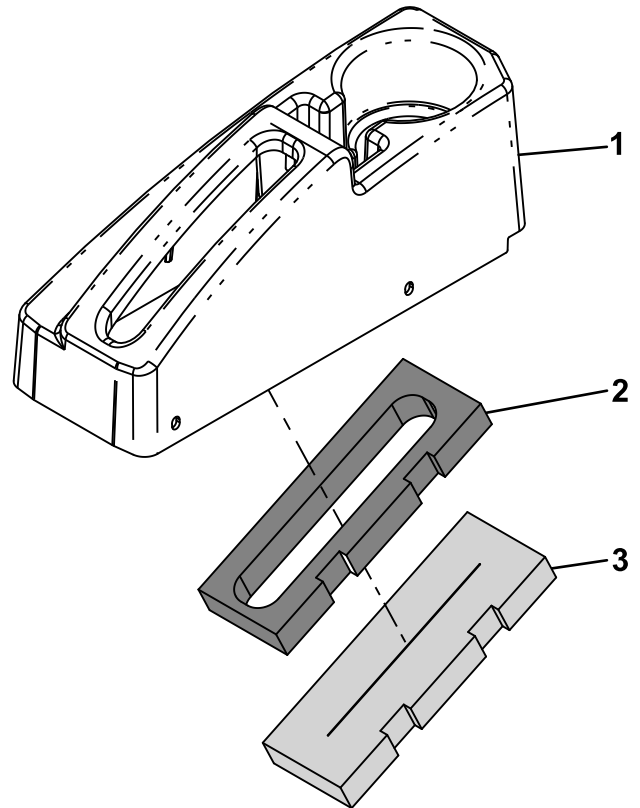
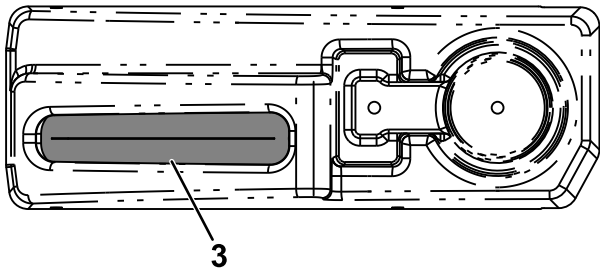

Figure 15

g331282

1. Brake cover
2. Upper brake foam (PSA)
3. Lower brake foam

1



2

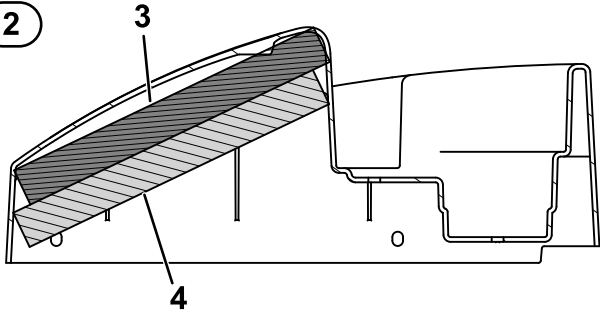

Figure 16

g331283

- 1. Top view
- 2. Cutaway (side) view
- 3. Upper brake foam (PSA—both sides)
- 4. Lower brake foam

- 6. Remove the backing film from the bottom side of the upper brake-cover foam (Figure 15).
- 7. Install the lower brake-cover foam onto the upper brake-cover foam (Figure 15 and Figure 16).
- 8. If the optional USB charging kit is installed, perform the following steps:
 - A. Install the USB port into the brake cover.
 - B. Connect the 2 wire terminals of the machine harness to the USB port.
- 9. Install the brake cover with the 2 previously removed push-in fasteners (Figure 13).

Installing the Firewall Pads

- 1. Remove the backing film and install the lower-firewall pad (Figure 17).

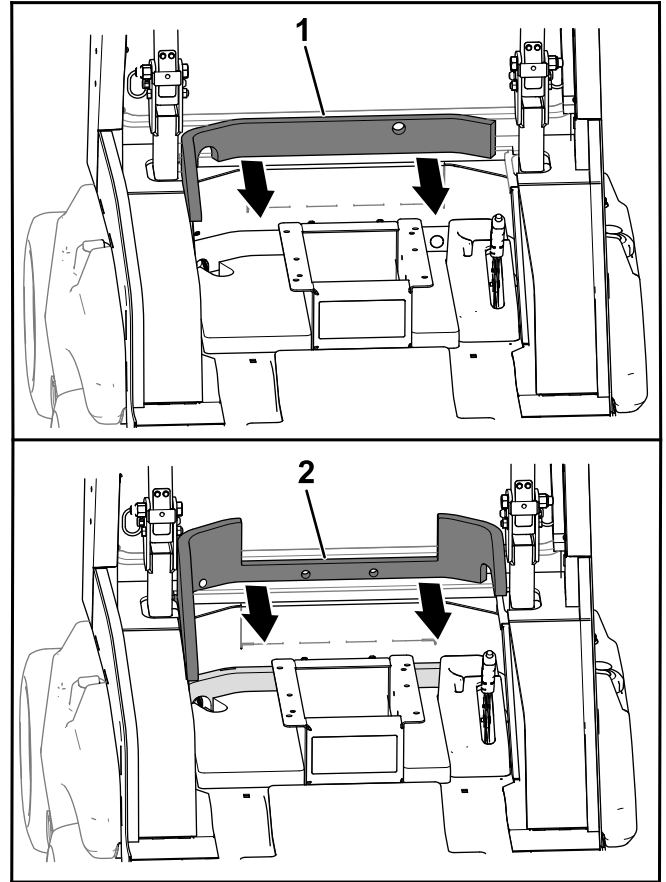

g330760

Figure 17

- 1. Lower-firewall pad (PSA)
- 2. Upper-firewall pad (PSA)

- 2. Remove the backing film and install the upper-firewall pad (Figure 17).
- 3. Remove the backing film and install the firewall tile pad (Figure 18).

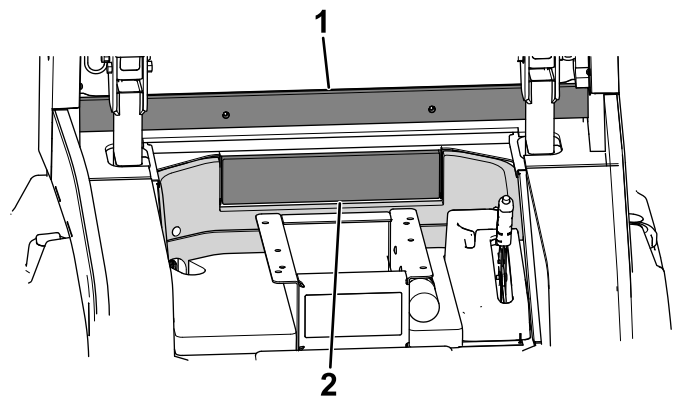

g330759

Figure 18

- 1. Rear-window pad (PSA)
- 2. Firewall tile pad (PSA)

- Remove the backing film and install the rear-window pad (Figure 18).

Installing the Seat Pads

- Install the seat-base pad (**thin**) inside of the seat base (Figure 19).

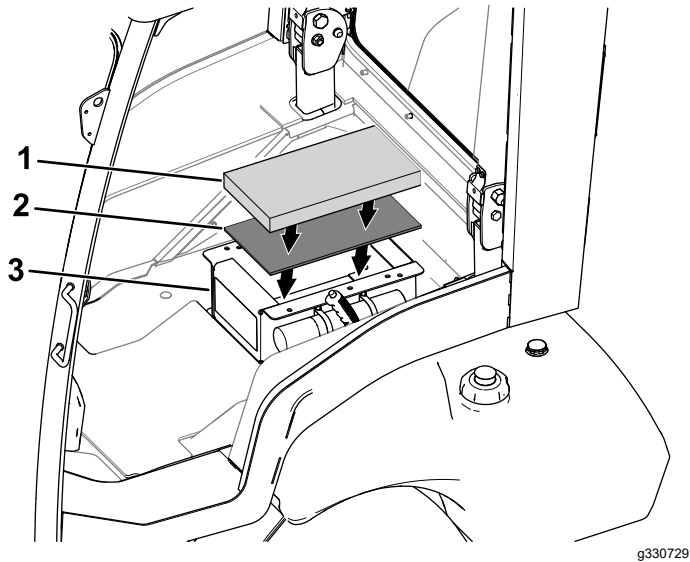

Figure 19

- Seat-base pad (**thick**)
- Seat-base pad (**thin**)
- Seat base

- Install the seat-base pad (**thick**) inside of the seat base (Figure 19).
- Install the seat pad around the seat base (Figure 20).

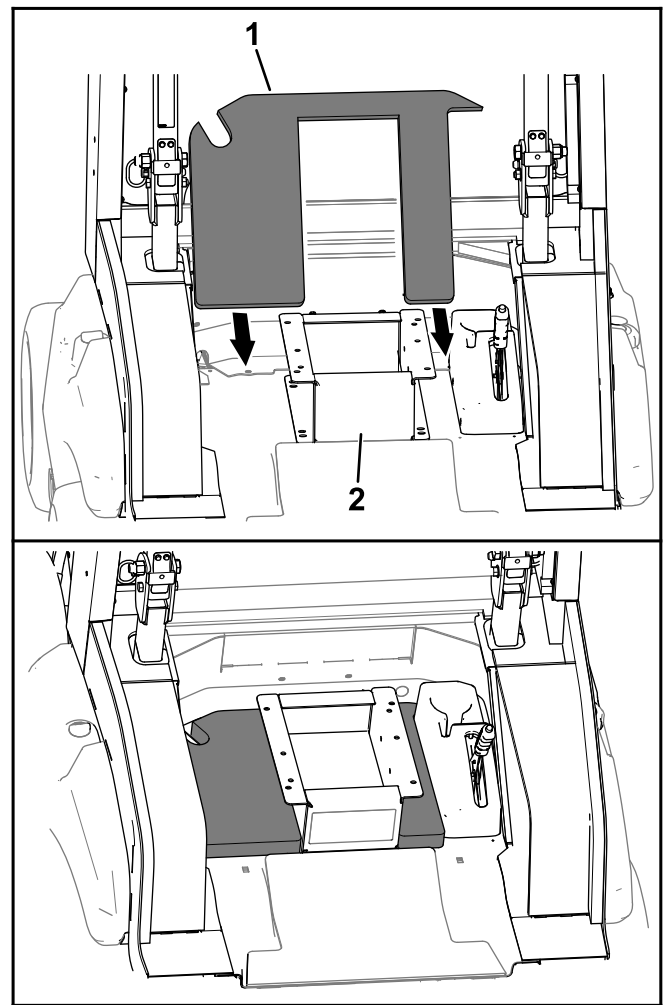

Figure 20

- Seat pad
- Seat base

Installing the Corner Pads

Remove the backing film and install the corner pads as shown in [Figure 21](#).

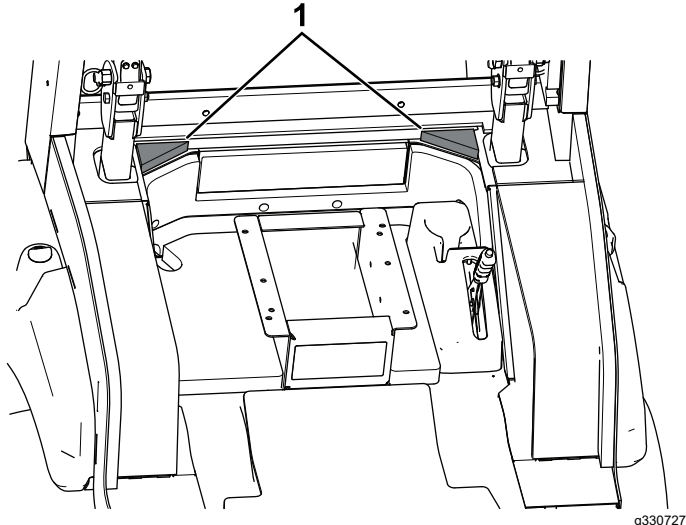

Figure 21

1. Corner pads (PSA)

Installing the ROPS Plugs

Place the ROPS plugs into the ROPS tubes ([Figure 22](#)).

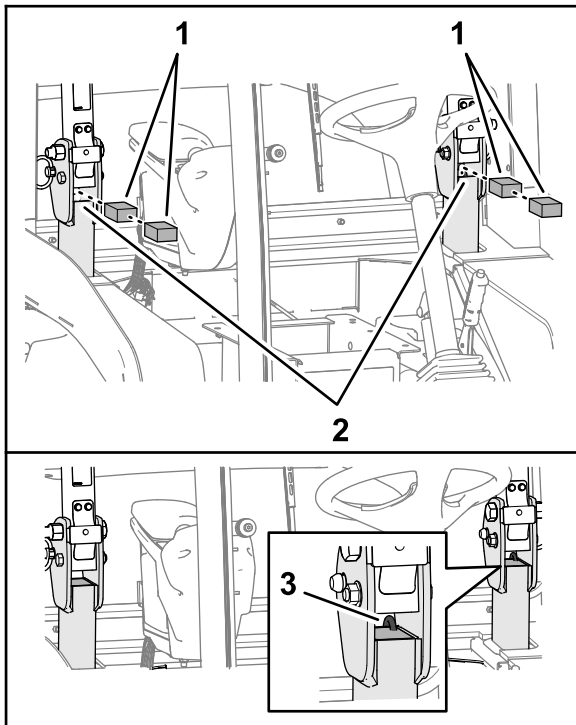

Figure 22

1. ROPS plugs
2. ROPS tubes
3. Plugs (positioned in the tube)

3

Installing the Upper-Frame Components

Parts needed for this procedure:

2	Rear-pillar pad
1	Left door-side pad
1	Right door-side pad
1	Upper-ceiling pad
1	Lower-ceiling pad
2	Mount-panel pad
1	Left rear-pillar cover
1	Right rear-pillar cover
1	Left sound-dampening panel
1	Right sound-dampening panel
1	Left outer-pillar pad
1	Right outer-pillar pad

Installing the Side-Panel Pads

1. Remove the cab rear-side covers ([Figure 23](#) and [Figure 24](#)).

Note: Retain the bolts.

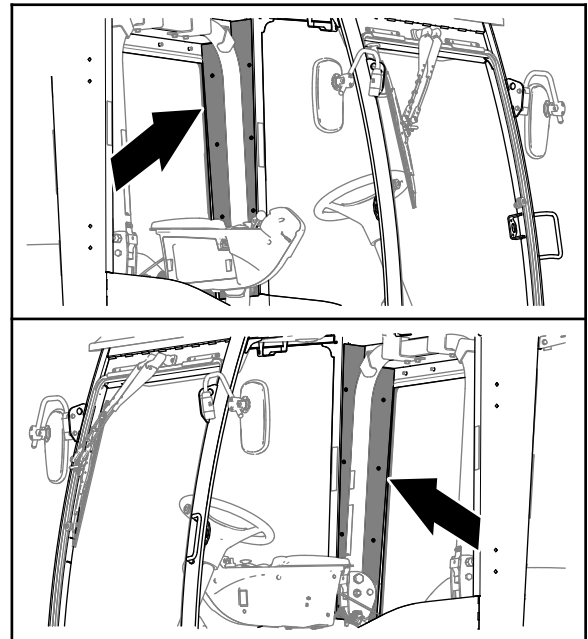
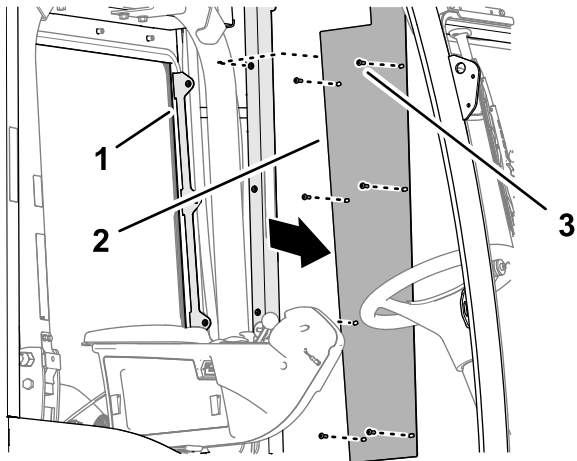

Figure 23
Rear-side covers

g330651



g330652

Figure 24
Left side shown

- 1. Mount-panel bracket
- 2. Rear-side cover
- 3. Bolt

- 2. Install the rear-pillar pads over the hoses and wire harness ([Figure 25](#)).

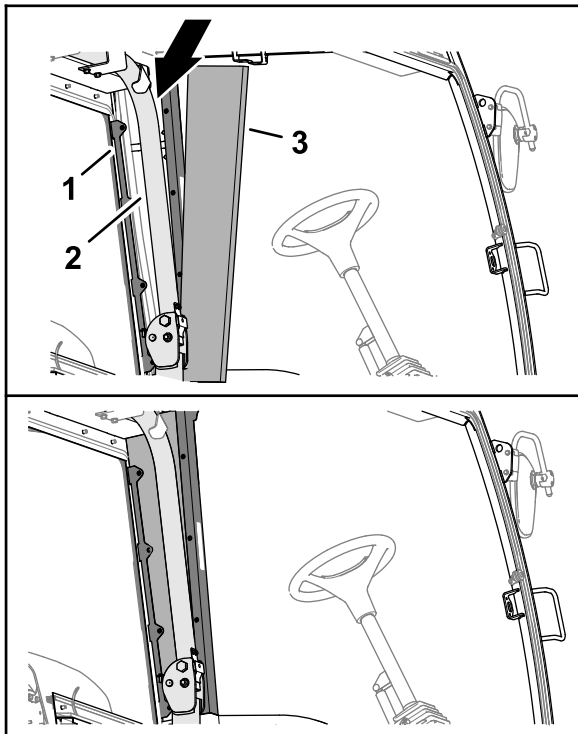

g330647

Figure 25
Left side shown

- 1. Mount-panel bracket
- 2. ROPS
- 3. Rear-pillar pad

- 3. Remove the backing film and assemble the sound-dampening panels and the outer-pillar pads to the rear-pillar covers as shown in [Figure 26](#) and [Figure 27](#).

[Figure 27](#) shows the proper dimensions for installing the outer-pillar pads and sound-dampening panels to the rear-pillar covers.

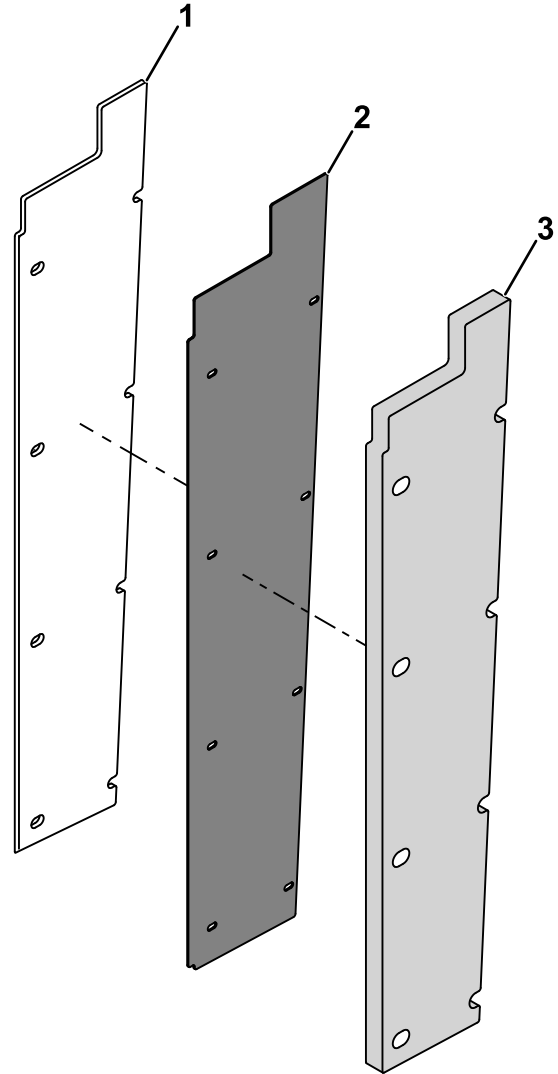

g331296

Figure 26
Left-sided panels/pads shown

- 1. Sound-dampening panel
- 2. Rear-pillar cover
- 3. Outer-pillar pad (PSA)

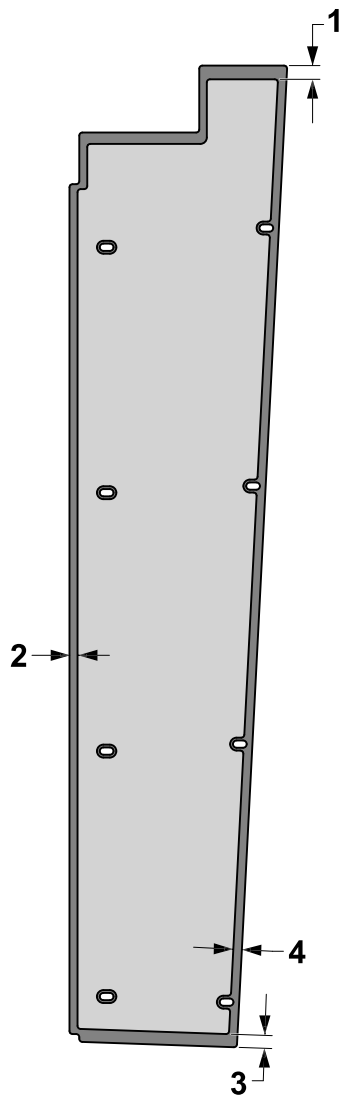

Figure 27

Left-sided panel shown

- | | |
|------------------------|------------------------|
| 1. 13.5 mm (0.53 inch) | 3. 12.7 mm (0.50 inch) |
| 2. 7.9 mm (0.31 inch) | 4. 8.4 mm (0.33 inch) |

4. Use the previously-removed bolts to install the rear-pillar-cover assembly (i.e., the outer-pillar pads, rear-pillar covers, and sound-dampening panels) to the mount-panel brackets (Figure 28). Install the assembly so that the outer-pillar pad is facing towards the operator.

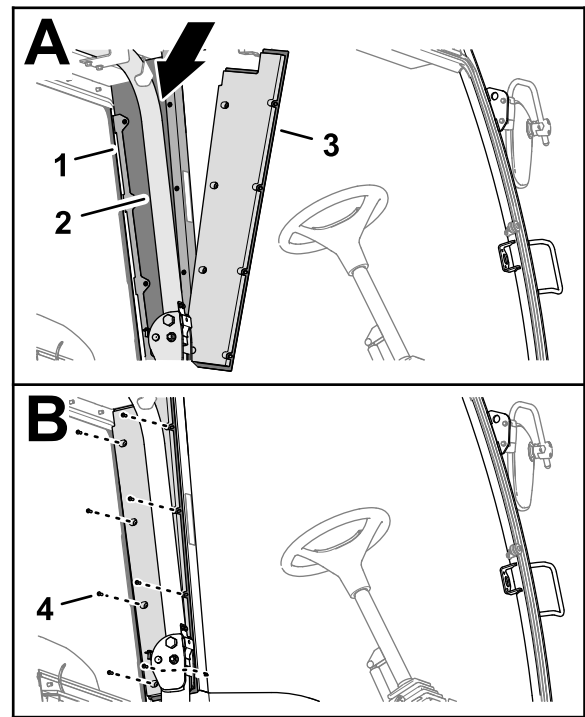

Figure 28

Left side shown

- | | |
|------------------------|-------------------------------|
| 1. Mount-panel bracket | 3. Rear-pillar-cover assembly |
| 2. Rear-pillar pad | 4. Bolt |

Installing the Ceiling Pads

1. Remove the backing film and install the ROPS pads to the ROPS mounts (Figure 29).

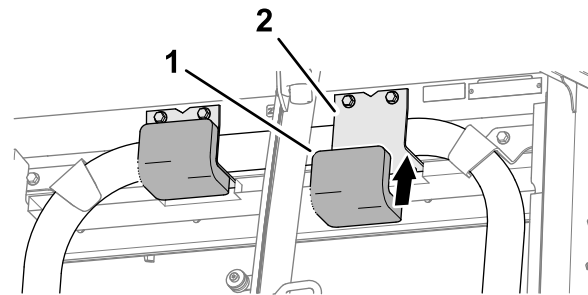
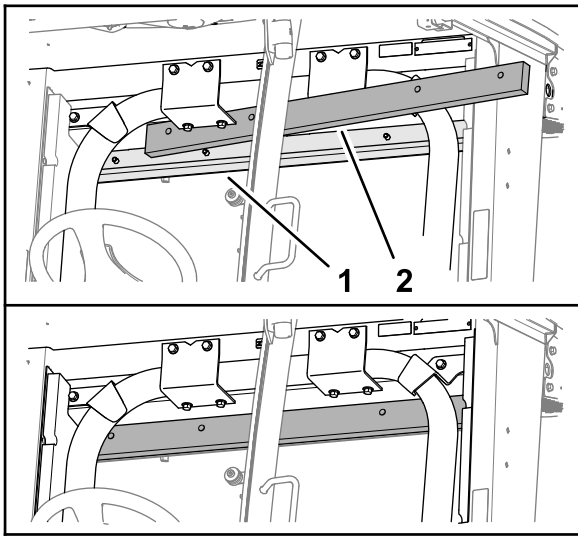

Figure 29

- | | |
|-------------------|---------------|
| 1. ROPS pad (PSA) | 2. ROPS mount |
|-------------------|---------------|

2. Remove the backing film and install the lower-ceiling pad above the rear cab window (Figure 30).



g330650

Figure 30

1. Rear cab window (PSA) 2. Lower-ceiling pad (PSA)

3. Remove the backing film and install the upper-ceiling pad to the ROPS mount bracket (Figure 31).

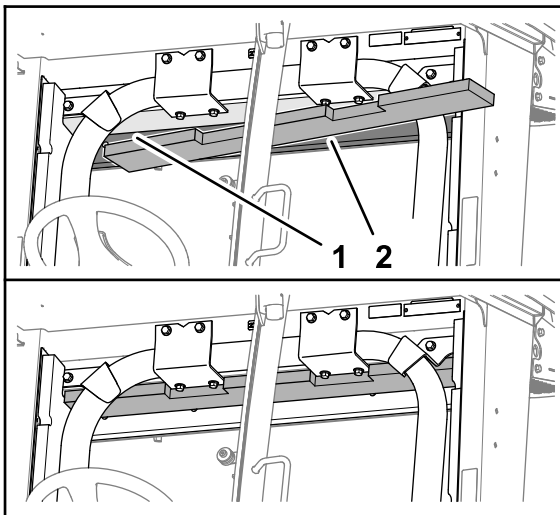

g330648

Figure 31

1. ROPS mount bracket 2. Upper-ceiling pad (PSA)

Installing the Door-Side Pads

Remove the backing film and install the door-side pads as shown in Figure 32.

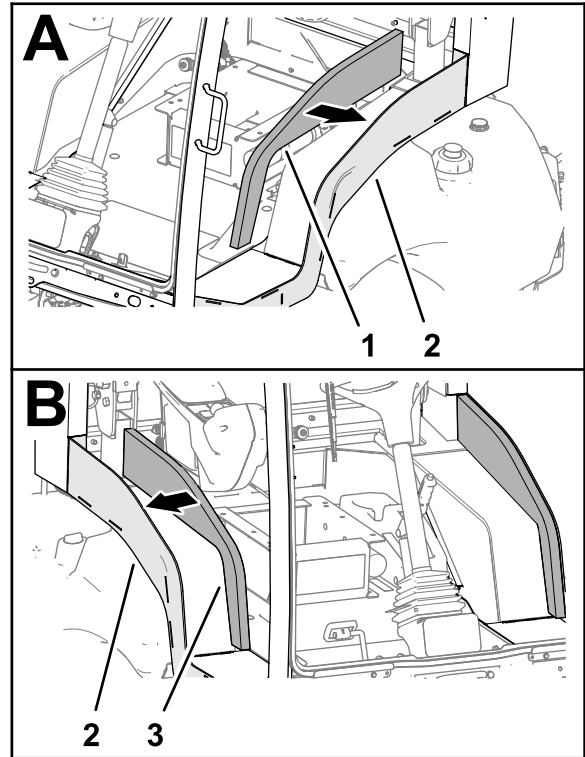

g330683

Figure 32

1. Left door-side pad (PSA) 3. Right door-side pad (PSA)
2. Side panel

Install the Mount-Panel Pads

Remove the backing film and install the mount-panel pads to the sides of the cab control panel as shown in [Figure 33](#).

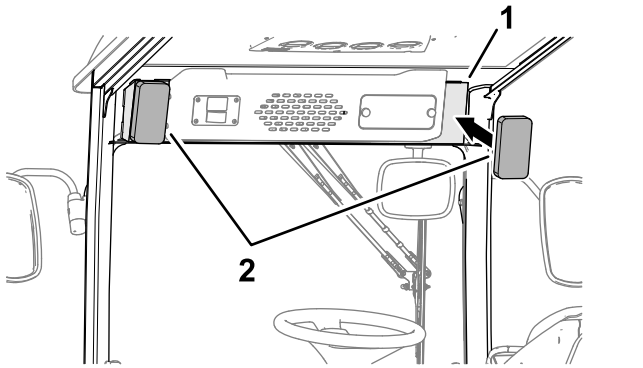

Figure 33

g330684

1. Cab-control panel
2. Mount-panel pads (PSA)

Installing the Rubber Floor Mat

Assemble the rubber floor mat to the floor of the machine ([Figure 35](#)).

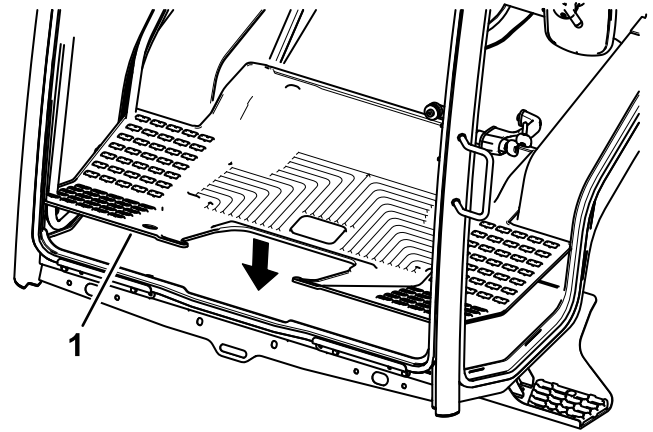

Figure 35

g332924

1. Rubber floor ma

4

Finishing Installing the Kit

No Parts Required

Installing the Seat

1. Use the previously removed nuts to secure the seat to the seat base.

The seat should be installed in the same holes that you removed the hardware from in [Removing the Seat \(page 4\)](#).

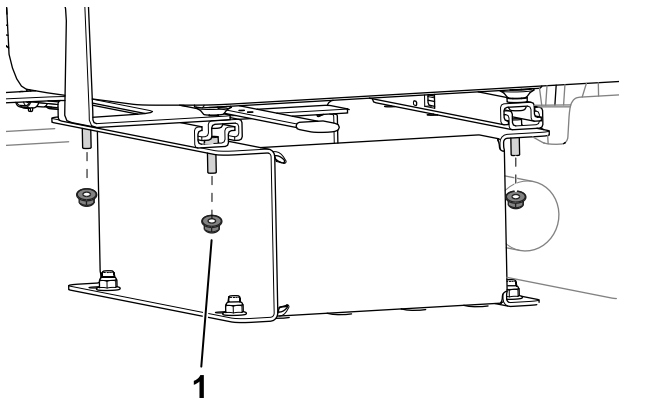

Figure 34

g299346

1. Nut
2. Install any previously disconnected wire-harness connections to the seat.