



Tool Rental Center

Tool Turn Guide

SGR-6 Stump Grinder
Model No. 22600HD—316000001 and Up



Supplier Technical Support #:
888-384-9939 (US and Canada)
Supplier Website: www.Toro.com

PURPOSE	Follow the directions below to maintain this tool.
SAFETY 	Refer to the product <i>Operator's Manual</i> for complete safety information.

Tool Inspection Process

Check the operating hours on the hour meter, then perform the necessary maintenance procedures as specified in the following table (for complete procedures, refer to the *Operator's Manual*):

Maintenance Service Interval	Maintenance Procedure
After each use	<ul style="list-style-type: none">• Check for missing or damaged parts, especially safety devices, shields, guards, and decals; ensure that the machine starts and operates properly.• Tighten all fasteners.• Check the engine oil level.• Grease the machine.• Check the air filter cyclone housing for a layer of dirt in the bottom of the container. Clean it if dirty.• Check the drive belt tension.• Check the condition of the teeth; rotate or replace any that are worn or damaged; torque the nuts for all teeth.• Remove debris from the machine.
After the first 25 hours	Change the engine oil.
Every 25 hours	Check the drive belt tension.

Maintenance Service Interval	Maintenance Procedure
Every 50 hours	Clean the air filter cyclone housing, air channels, and air intake screen.
Every 100 hours	<ul style="list-style-type: none"> • Change the engine oil. • Clean the fuel sediment cup. • Check the spark plugs. • Replace the drive belt.
Every 200 hours	Replace the air filter.
Yearly or before storage	<ul style="list-style-type: none"> • Change the engine oil. • Clean the sediment cup.

Important: Refer to the *Engine Operator's Manual* for additional maintenance procedures.

Tool Cleaning Process

Regular cleaning and washing will increase the life span of the machine. Clean the machine after use, before the dirt hardens. Check before cleaning that the fuel tank cap is properly in place to avoid getting water in the tank. Use care when using a high-pressure washer because it can damage decals, grease seals, and the engine.

Important: Lubricate the cutting wheel blade bearings after cleaning.

Rotating or Replacing a Tooth

Due to the high amount of wear placed on the teeth, you will need to rotate and replace them periodically (Figure 1). Before you rotate or replace them, inspect each tooth holder on the wheel, including the flat lands that prevent the teeth from rotating. If the tooth holder is damaged, replace the wheel. Torque the nuts 60 to 76 N·m (44 to 56 ft-lb) for any teeth that you are not rotating or replacing.

Each tooth is indexed with 3 positions so you can rotate it twice, exposing a new sharp edge before replacing the tooth. To rotate a tooth, loosen the nut securing the tooth (Figure 2). Push the tooth forward and rotate it 1/3 turn, bringing an unused edge to the outside. Torque the nut securing the tooth to 60 to 76 N·m (44 to 56 ft-lb).

To replace a tooth, remove the nut securing the tooth, then install a new tooth, washer, and nut in the same position (Figure 2). Torque the nut securing the tooth to 60 to 76 N·m (44 to 56 ft-lb).

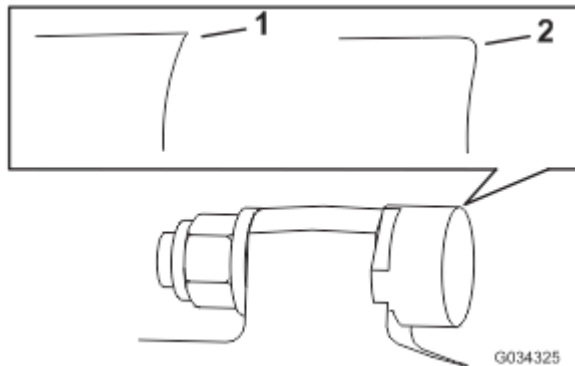

Figure 1

1. Sharp tooth

2. Worn tooth

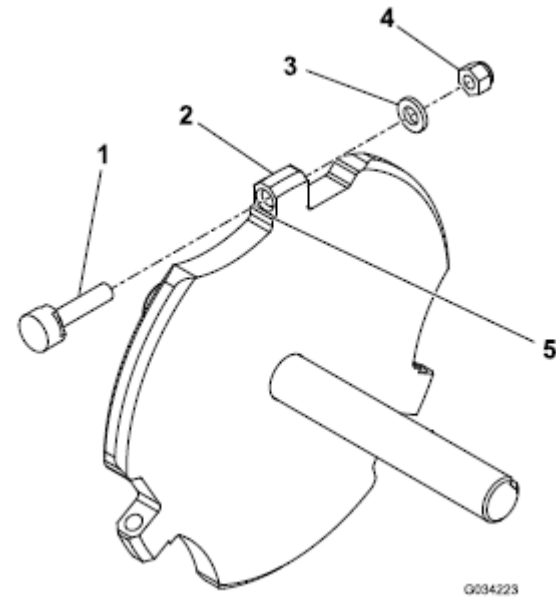

Figure 2

1. Tooth
2. Tooth holder
3. Washer

4. Nut
5. Flat land



Tool Rental Center

Spring Maintenance Guide

SGR-6 Stump Grinder
Model No. 22600HD—316000001 and Up



Supplier Technical Support #:
800-888-9926 (US and Canada)
Supplier Website: www.Toro.com

PURPOSE	Follow the directions below to maintain this tool.
SAFETY 	Refer to the product <i>Operator's Manual</i> for complete safety information.

Perform the necessary maintenance procedures as specified in the following tables (for complete procedures, refer to the *Operator's Manual*):

Tool Inspection Process

Action	Recommended Parts	
	Part Number	Description
Clean the air filter cyclone housing, air channels, and air intake screen.		
Check the condition of the teeth; rotate or replace any that are worn or damaged; torque the nuts for all teeth.		
Check condition of the chip control flaps.		
Check the drive belt tension	137-7683	V-belt

Action	Recommended Parts	
	Part Number	Description
Check for missing or damaged parts, especially safety devices, shields, guards, and decals; ensure that the machine starts and operates properly.		
Check operation of the operator presence switch.		
Check operation of the parking brake.		

Recommended Routine Maintenance:

Action	Recommended Parts	
	Part Number	Description
Change the engine oil.		
Replace the air filter.	Source from Honda	Air filter
Replace the spark plug.	Source from Honda	Spark plug