



Count on it.

Parts Catalog

GDC (Golf Decoder Controller) Series, Stand-Alone, PC-Model and 2-Wire Decoder

Model No. GDC SERIES

Ordering Replacement Parts

To order replacement parts, please supply the part number, the quantity, and the description of each part desired.

Understanding Reference Numbers

Each identified part in an illustration has a reference number. The reference number for a part also appears in the parts list, along with other information about the part.

This catalog uses two special reference number formats, one to indicate parts in a service assembly and another to indicate the quantity of a given part in an illustration.

Service Assembly Reference Numbers

Parts in service assemblies have reference numbers in the form a:b. The a represents the reference number of the entire service assembly and the b represents a sequential number unique to each part within the service assembly.

For example, a wheel assembly might be identified by reference number 6, the tire by 6:1, the valve by 6:2, and the wheel by 6:3. When you order the assembly identified by reference number 6, you receive all parts identified by reference numbers 6:1, 6:2, and 6:3. However, you may also order any part individually. Reference numbers of this type appear in illustration and in parts lists.

Reference Numbers Indicating Quantity

In an illustration, if a reference number indicates more than one part, the reference number has the form nX y. The n represents the quantity of the part, the X is the multiplication symbol, and the y represents the reference number.

For example, in an illustration, the reference number 2X 37 means that two of the parts identified by reference number 37 are indicated.

Contents

GDC - Stand-Alone, PC Models, 2-Wire Decoder Sys 4

GDC - Stand-Alone, PC Models, 2-Wire Decoder Sys

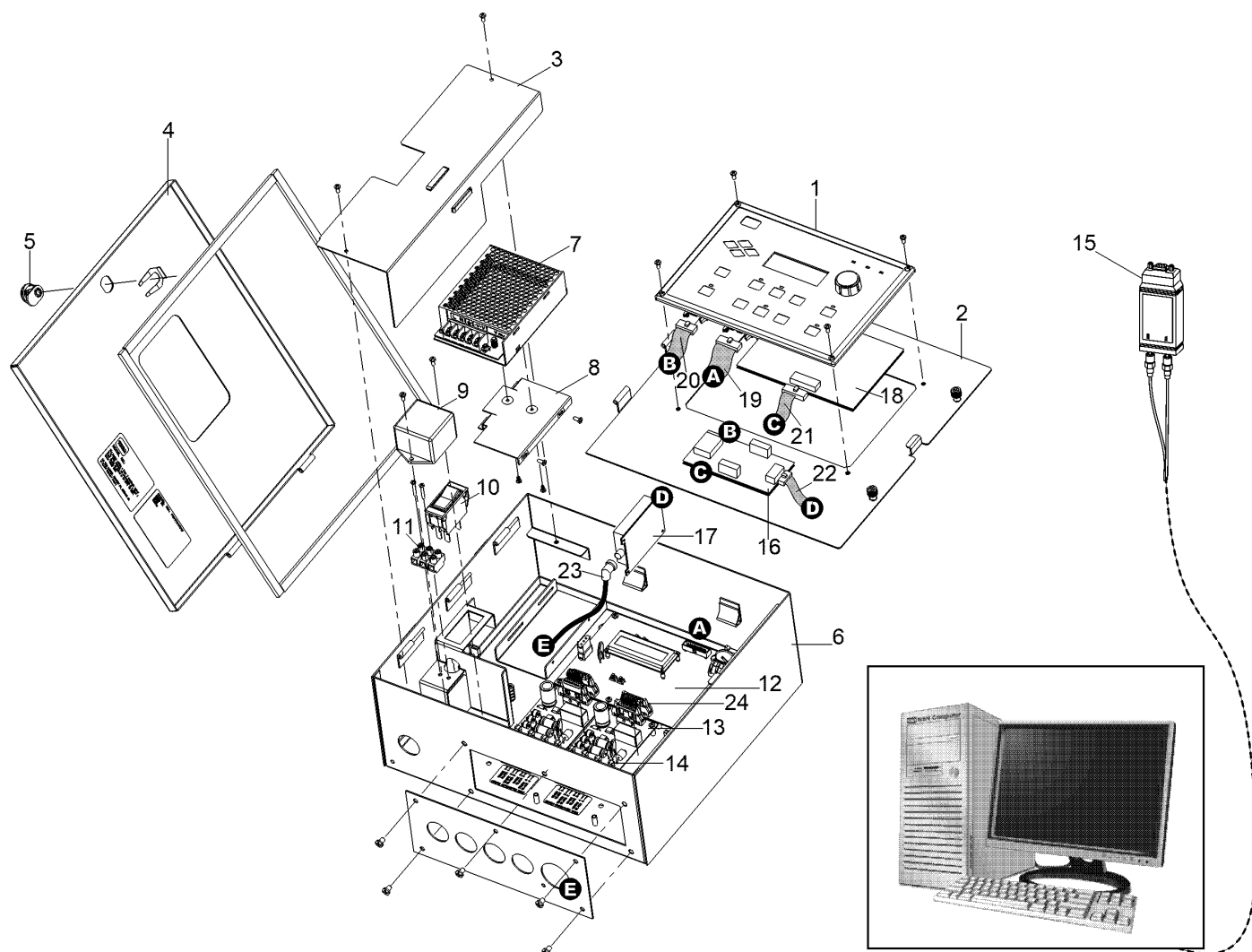

GDC - Stand-Alone, PC Models, 2-Wire Decoder Sys (continued)

<i>Ref.</i>	<i>Part Number</i>	<i>Qty.</i>	<i>Description</i>	<i>Ref.</i>	<i>Part Number</i>	<i>Qty.</i>	<i>Description</i>
1	102-5918SK	1	Timing Mechanism Assy., Gateway (Stand-Alone)	13	118-4718SK	1	Daughterboard Assembly, AC Decoder
1	118-4728SK	1	Timing Mechanism Assy., Gateway (Remote)	13	118-7097SK	1	Daughterboard, Lynx Smart Hub, Oct 2020 And Later
2	102-5049	1	Panel, Gateway, Decoder (Stand-Alone Models Only)	14	363-8506	8	Fuse, 5 X 20Mm, Fast, 3.15A, 250V
2	118-3736	1	Panel, Gateway, Downloadable/Remote	14	363-1020	8	Fuse, 2A, Mini Blade, Oct 2020 And Later
3	118-0496	1	Power Supply Cover, Gateway, Decoder	15	102-6461	1	Fiber Optic Converter Kit, Gateway To Central Computer
4	102-5048SK	1	Door, Gateway Decoder	16	118-3101SK	1	Digital Radio Interface Board, Gateway
5	363-3785	1	Lock Assy. W/Keys	17	118-3442SK	1	Radio Module, Transceiver, Rv-M7-UC
6	118-0880	1	Cabinet, Gateway Decoder	18	89-9026	1	Standard Modem, Svc.
7	118-0540	1	Power Supply, AC/DC, Gateway, Decoder	19	102-9176	1	Cable, 40-Pos (A To A)
8	118-0475	1	Power Supply Bracket, Upper	20	118-3329	1	Cable, Int Bd To Tm (B To B)
9	102-9741	1	Ttf, Filter Assembly	21	118-3330	1	Cable, Int Bd To Modem (C To C)
10	363-3361	1	Switch, Circuit Breaker, 1.5A	22	118-3103	1	Harness, Db9 (D To D)
11	102-4766SK	1	Wire Harness, Terminal Block To Switch	23	118-3104	1	Cable, Bnc To Bnc, Radio (E To E)
12	118-2750SK	1	Motherboard Assembly With Tricomm, Gateway Decoder	24	102-4598	2	Ribbon Cable, 16 Cond, F/F
12	118-4717SK	1	Motherboard Assembly, Gateway, AC Decoder	24	118-5804	2	Ribbon Cable, 20 Cond., F/F, Lynx Smart Hub, Oct 2020 And Later
12	118-7096SK	1	Motherboard, Lynx Smart Hub, Oct 2020 And Later				
13	118-2749SK	1	Pcb Assy., Gateway Daughterboard				

Notes:

Notes:



Count on it.