



Rear Attachment Receiver

Workman® GTX Series Utility Vehicle with Steel Cargo Bed

Model No. 07186

Installation Instructions

Note: Determine the left and right sides of the machine from the normal operating position.

Loose Parts

Use the chart below to verify that all parts have been shipped.

Procedure	Description	Qty.	Use
1	No parts required	–	Prepare the machine for installation.
2	Rear attachment receiver Jam nut Button-head bolt T-handle Locknut (3/8 inch) Carriage bolt (3/8 x 1 inch)	1 1 1 1 4 4	Install the kit.

1

Preparing the Machine

No Parts Required

Procedure

1. Park the machine on a level surface.
2. Engage the parking brake.
3. Shut off the engine and remove the key.

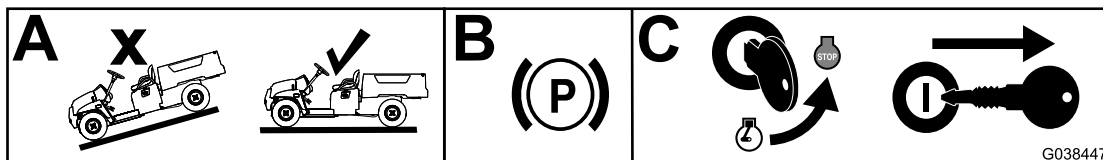

Figure 1

g038447



2

Installing the Kit

Parts needed for this procedure:

1	Rear attachment receiver
1	Jam nut
1	Button-head bolt
1	T-handle
4	Locknut (3/8 inch)
4	Carriage bolt (3/8 x 1 inch)

Procedure

1. Secure the T-handle to the rear attachment receiver using the jam nut and button-head bolt ([Figure 2](#)).

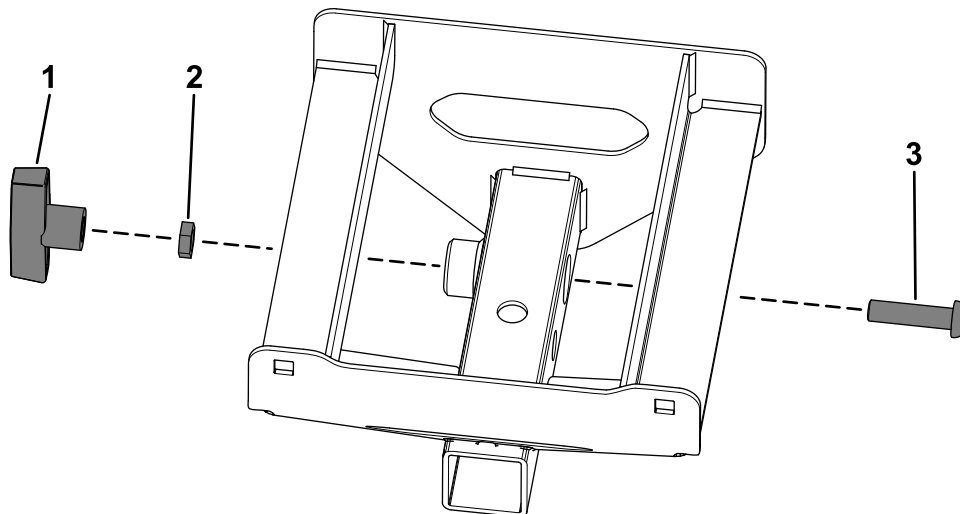
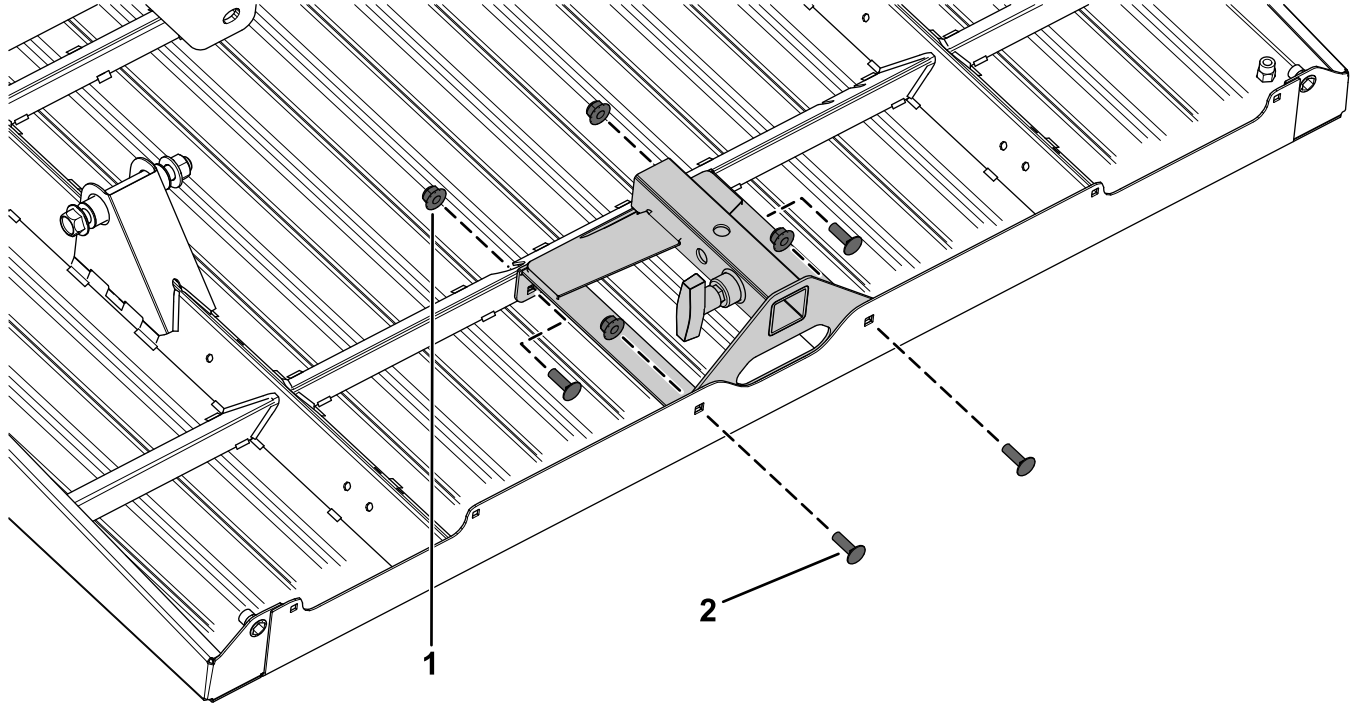

Figure 2

g355574

1. T-handle
2. Jam nut
3. Button-head bolt

2. Secure the rear attachment receiver to the bed using 4 carriage bolts (3/8 x 1 inch) and 4 locknuts (3/8 inch) as shown in [Figure 3](#).
3. Torque the 4 locknuts (3/8 inch) to 28 N·m (21 ft-lb).



g355573

Figure 3

1. Locknut (3/8 inch)

2. Carriage bolt (3/8 x 1 inch)



Count on it.