



**WHEEL HORSE<sup>®</sup>**  
**38" EASY-EMPTY**  
**GRASS CATCHER**

**for Lawn Tractors**

**Model No. 79117 – 8900001 & Up**

---

# **Operator's Manual**

**IMPORTANT:** Read this manual carefully. It contains information about your safety and the safety of others. Also become familiar with the controls and their proper use before you operate the product.



# Introduction

We want you to be completely satisfied with your new product, so feel free to contact your local Authorized Service Dealer for help with service, genuine replacement parts, or other information you may require.

Whenever you contact your Authorized Service Dealer or the factory, always know the model and serial numbers of your product. These numbers will help the Service Dealer or Service Representative provide exact information about your specific product. You will find the model and serial number plate located in a unique place on the product as shown below.

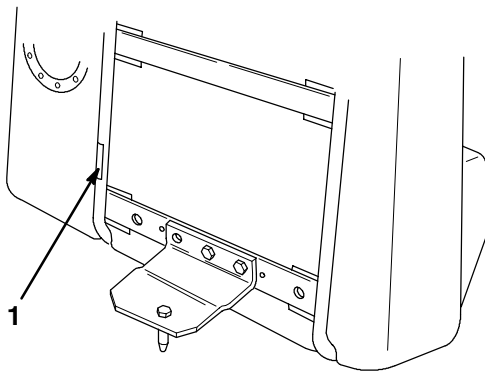

1. Model and Serial Number Plate

For your convenience, write the product model and serial numbers in the space below.

<b>Model No:</b> _____
<b>Serial No.</b> _____

The warning system in this manual identifies potential hazards and has special safety messages that help you and others avoid personal injury, even death. DANGER, WARNING and CAUTION are signal words used to identify the level of hazard. However, regardless of the hazard, be extremely careful.

**DANGER** signals an extreme hazard that will cause serious injury or death if the recommended precautions are not followed.

**WARNING** signals a hazard that may cause serious injury or death if the recommended precautions are not followed.

**CAUTION** signals a hazard that may cause minor or moderate injury if the recommended precautions are not followed.

Two other words are also used to highlight information. “Important” calls attention to special mechanical information and “Note” emphasizes general information worthy of special attention.

The left and right side of the machine is determined by sitting on the seat in the normal operator’s position.



# Contents

	Page		Page
Safety and Instruction Decals .....	2	Maintenance .....	8
Installation .....	3	Inspecting the Grass Catcher .....	8
Loose Parts .....	3	Inspecting the Mower Blades .....	8
Installing the Grass Catcher .....	3	Cleaning the Grass Catcher .....	8
Removing the Grass Catcher .....	5	Storing the Grass Catcher .....	8
Operation .....	6		
Emptying the Grass Basket .....	6		
Clearing Obstructions from Grass Catcher .....	6		
Operating and Bagging Tips .....	6		



## Safety and Instruction Decals



Safety decals and instructions are easily visible to the operator and are located near any area of potential danger. Replace any decal that is damaged or lost.



**ON GRASS BASKET  
(Part No. 92-2511)**



# Installation

## Loose Parts

DESCRIPTION	QTY.	USE
Upper Mounting Bracket	1	Install upper mounting bracket
Bolt (5/16" x 1")	2	
Locknut (5/16"-18)	2	
Hitch Plate	1	Install hitch plate and hitch pin
Bolt (5/16" x 1")	2	
Locknut (5/16"-18)	2	
Hitch Pin	1	
Bolt (5/16" x 5/8")	1	
Grass Basket with Frame	1	Assemble and install grass catcher
Dump Handle	1	
Handle Guide	1	
Bolt (1/4" x 2")	1	
Locknut (1/4"-20)	1	
Washer (1/4")	1	
Hairpin Cotter	2	
Chute	1	Install chute and discharge tube
Discharge Tube	1	
Locking Pin	1	

## Installing the Grass Catcher

### Installing the Upper Mounting Bracket

1. Install the upper mounting bracket to the rear of the tractor using two 5/16" x 1" bolts and 5/16"-18 locknuts (Fig. 1). Use the right most set of holes in the bracket when looking at the rear of the tractor.

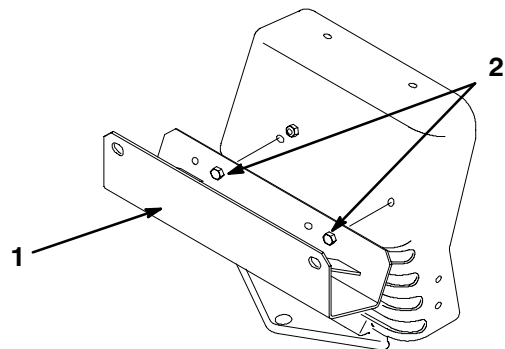

m-3414

**Figure 1**

1 Upper Mounting Bracket      2 Bolts (5/16" x 1")



## Installing the Hitch Plate

1. Align the holes in the hitch plate tab with the alignment hole on the mounting frame (Fig. 2).
2. Secure the hitch plate to the mounting frame using two 5/16" x 1" bolts and 5/16"-18 locknuts (Fig. 2).
3. Secure the hitch pin in the hole in the hitch plate using a 5/16" x 5/8" bolt (Fig. 2).

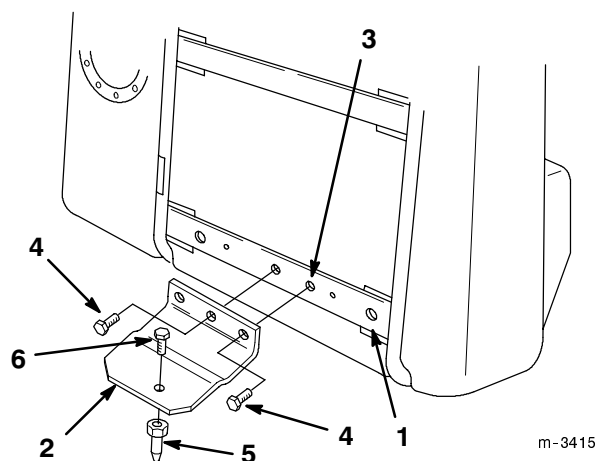

Figure 2

- |                  |                       |
|------------------|-----------------------|
| 1 Mounting Frame | 4 Bolt (5/16" x 1")   |
| 2 Hitch Plate    | 5 Hitch Pin           |
| 3 Alignment Hole | 6 Bolt (5/16" x 5/8") |

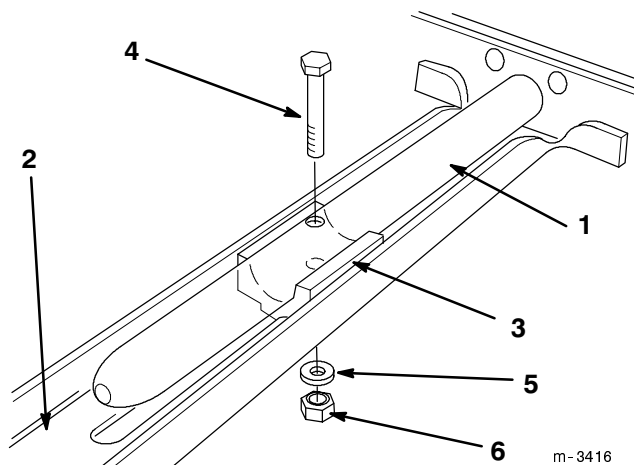

Figure 3

- |                  |                     |
|------------------|---------------------|
| 1 Dump Handle    | 4 Bolt (1/4" x 2")  |
| 2 Handle Channel | 5 Washer (1/4")     |
| 3 Handle Guide   | 6 Locknut (1/4"-20) |

4. Pull the dump handle up until it stops, then close the grass basket. Push the dump handle down until it stops.

**Note:** When the dump handle is pushed in completely, the basket should not be able to open. If the basket opens, either the dump handle is not pushed in far enough or the basket is not fully closed.

## Assembling and Installing the Grass Basket

1. Open the grass basket and slide the dump handle through the hole in the top of the basket and into the handle channel (Fig. 3). Ensure that the handle grip is positioned so that it will point toward the front of the tractor when installed.
2. Lift up on the end of the dump handle, positioning it on the handle guide in the channel with the holes in the handle and guide aligned (Fig. 3).
3. Secure the handle guide and dump handle to the channel with the 1/4" x 2" bolt, 1/4" washer, and 1/4"-20 locknuts (Fig. 3)

## Attaching the Grass Basket to the Tractor

1. Insert the hitch pin on the grass catcher into the mounting hole in the tractor hitch.
2. Rotate the grass catcher up so that the pins on the mounting frame slide through the mounting holes on the tractor. Secure the pins with the hairpin cotters.

## Assembling and Installing the Chute and Discharge Tube

1. Lift the mower deflector and slide the front of the chute into the locking position on the mower. Insert the locking pin (Fig. 4).



- Hook the flexible latch on the chute into the notched bracket on the back of the mower (Fig. 4).

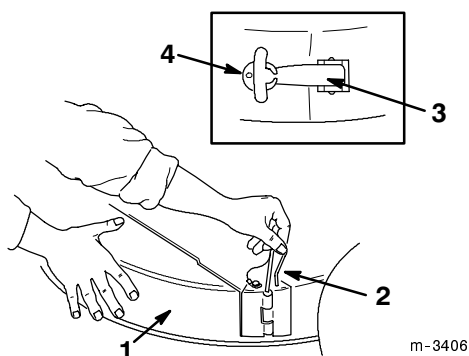

Figure 4

- |               |                   |
|---------------|-------------------|
| 1 Chute       | 3 Flexible Latch  |
| 2 Locking Pin | 4 Notched Bracket |

- Slide the discharge tube into the opening in the grass catcher (Fig. 5).
- Slide the discharge tube over the end of the chute, ensuring that the tab on the chute snaps into the square hole in the discharge tube (Fig. 5).

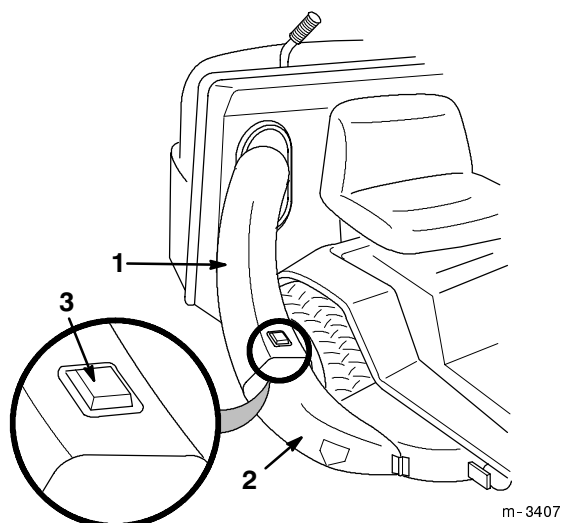

Figure 5

- |                  |       |
|------------------|-------|
| 1 Discharge Tube | 3 Tab |
| 2 Chute          |       |

## Testing the Installation

- Pull up on the dump handle and open the grass basket.
- Close the grass basket completely and push the dump handle down until it stops.
- Ensure that the grass basket will not open with the dump handle pushed down fully.

## Removing the Grass Catcher

### DANGER

#### POTENTIAL HAZARD

- Sometimes people are tempted to operate the tractor and mower with the discharge tube removed. This exposes you and others to thrown debris and blade contact.

#### WHAT CAN HAPPEN

- You and others may die or be injured severely if you are hit by thrown debris or cut by the blade.

#### HOW TO AVOID THE HAZARD

- Always operate the mower with the complete grass catcher mounted in place or use the mower to side discharge, making sure that the spring-loaded grass deflector is in the down position.

- Push on the tab on the chute and pull the discharge tube free from the chute and grass catcher (Fig. 5).
- Release the flexible latch and remove the locking pin securing the chute to the mower. Pull the chute out of the mower (Fig. 4).
- Remove the hairpin cotters securing the grass basket to the upper mounting bracket on the mower. Rock the grass basket backward, then pull it free of the mower hitch.
- Store all grass catcher parts in a convenient place.



# Operation

## CAUTION

### To Avoid Personal Injury:

- **Become familiar with all operating and safety instructions in the operator's manual for your tractor and mower before using this attachment.**
- **Never remove the grass catcher discharge tube, grass basket, or the chute while the engine is running.**
- **Always shut the engine off before clearing an obstruction from the grass catcher.**
- **Never do maintenance or repairs while the engine is running.**

## Emptying the Grass Basket

1. Disengage the power take off (PTO) by pushing the PTO control to OFF (this stops the mower blades), then back the tractor up to the area where you want to dump the grass clippings.
2. Stop the tractor, set the parking brake, and shut the engine off.
3. Pull up on the dump handle and swing the grass basket open.
4. Empty the grass basket
5. Close the grass basket completely and push the dump handle down until it stops. Ensure that the grass basket will not open.

## Clearing Obstructions from Grass Catcher

1. Stop the tractor, set the parking brake, and disengage the power take off (PTO) by pushing the PTO control to OFF (this stops the mower blades). Shut the engine off before you get off the tractor.
2. Check the grass basket and empty it if full.
3. Remove and separate the discharge tube and chute from the grass basket and mower. Using a stick or similar object, carefully remove and clear the obstruction from the mower, discharge tube, chute, and the grass basket.
4. After you remove the obstruction, install the grass catcher and resume operation.

## Operating and Bagging Tips

### Size

Remember that the tractor is longer and wider with this attachment installed. By turning too sharply in confined places you may damage the attachment.

### Trimming

Always trim with the left side of the mower. Do not trim with the right side of the mower because you could damage the chute and discharge tube.

### Cutting Height

Do not set the mower cutting height too low because long grass surrounding the mower can prevent air from getting under the mower and entering the grass catcher. If enough air doesn't get under the mower, the grass catcher will plug.



### Cutting Frequency

Cut the grass often, especially when it grows rapidly. You will have to cut your grass twice if it gets excessively long (refer to Bagging Long Grass, page 7).

### Cutting Technique

For best lawn appearance, be sure to slightly overlap the mower into the previously cut area. This helps reduce the load on the engine and reduces the chance of plugging the grass catcher.

### Grass Catching Speed

Most often you will catch grass with the tractor throttle in the FAST position and drive in 1st. gear, which is the slowest ground speed. However, in extremely dry and dusty grass, you may want to lower throttle speed and shift gear selector to a higher gear to maintain ground speed. The grass catcher may plug if you drive too fast, causing the engine to slow down with the extra work load.

### Catching Wet Grass

Always try to cut grass when it is dry because your lawn will have a neat appearance. If you must cut wet grass, use the conventional side discharge feature of the mower. Several hours later, when the clippings are dry, install the grass catcher and vacuum up the grass clippings.

### Signs of Plugging

As you are bagging, a small amount of grass clippings normally blow out the front of the mower. An excessive amount of clipping blow-out indicates that the bags are full or the system is plugged.

## CAUTION

### POTENTIAL HAZARD

- As the grass basket fills, extra weight is added to the back of the tractor.

### WHAT CAN HAPPEN

- If you stop and start suddenly on hills, you may lose steering control or the mower may tip.

### HOW TO AVOID THE HAZARD

- Do not start or stop suddenly when going uphill or downhill. Avoid uphill starts.
- If you do stop the mower when going uphill, push the PTO control to OFF (stop the mower blades). Then back down the hill using slow reverse speed.
- Do not change speeds or stop on slopes.

### Catching Long Grass

Excessively long grass is heavy and may not be propelled completely into the grass basket. If this happens, the discharge tube may plug. To avoid plugging the grass catcher, mow the grass at a high height-of-cut, then lower the mower to your normal cutting height and repeat the process.



# Maintenance

## Inspecting the Grass Catcher

Inspect the grass catcher after the first ten hours of operation and monthly thereafter.

1. Check the discharge tube, chute, and the grass basket. Replace these parts if they are cracked or broken.
2. Tighten all nuts bolts and screws.

## Inspecting the Mower Blades

1. Inspect the mower blades regularly and whenever a blade strikes a foreign object.
2. If blades are badly worn or damaged, install new blades. Refer to your tractor or mower operator's manual for complete blade maintenance.

## Cleaning the Grass Catcher

1. After each use, remove and wash the inside and outside of the grass basket, discharge tube, chute, and the underside of the mower, using water sprayed from a garden hose. Use a mild automotive detergent to remove stubborn dirt.



### CAUTION

#### POTENTIAL HAZARD

- If you store grass clippings in the grass basket, under the right conditions, spontaneous combustion (a fire-generating process that occurs without an external source of ignition) could occur.

#### WHAT CAN HAPPEN

- If a fire occurs, property could be damaged and/or someone could be injured.

#### HOW TO AVOID THE HAZARD

- The grass basket is not a storage container. Never store grass clippings and debris in the grass basket.

2. Make sure you remove matted grass from all parts.
3. After washing let all parts dry thoroughly.

## Storing the Grass Catcher

1. Clean the grass catcher (refer to Cleaning the Grass Catcher, page 8).
2. Inspect the grass catcher for damage (refer to Inspecting the Grass Catcher, page 8).
3. Store the grass catcher in a clean, dry place, out of direct sunlight. This protects the plastic parts and extends the life of the grass catcher. If you must store the grass catcher outside, cover it with a weatherproof cover.







