



Smooth Castor Wheel TimeCutter™ Z Riding Mowers

Part No. 105-1856

Installation Instructions

1. Remove the bolt and nut attaching the existing castor wheel (Fig. 1).
2. Remove the spanner from the existing wheel and insert it into the smooth castor wheel (Fig. 1).
3. Attach the smooth castor wheel to the castor fork with the existing bolt and nut (Fig. 1).
4. Repeat the procedure with the other castor wheel.

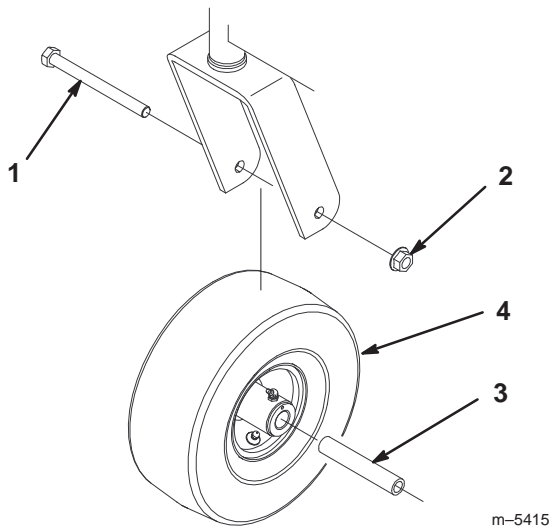

m-5415

Figure 1

- | | |
|---------|-----------------|
| 1. Bolt | 3. Spanner |
| 2. Nut | 4. Castor wheel |