



Light Kit

Dingo® TX 1000 Compact Tool Carrier

Model No. 144-7100

Installation Instructions

Installation

Loose Parts

Use the chart below to verify that all parts have been shipped.

Procedure	Description	Qty.	Use
1	No parts required	–	Prepare the machine.
2	Light Front light bracket Carriage bolt (5/16 x 1 inch) Bolt (1/4 x 5/8 inch) Lock washer Washer Nut (5/16 inch) Nut (1/4 inch)	1 1 1 4 1 4 1 4	Install the front light.
3	Light Rear light bracket Bolt (5/16 x 3/4 inch) Carriage bolt (5/16 x 1 inch) Lock washer Nut (5/16 inch)	1 1 1 1 1 1	Install the rear light.
4	Switch Switch bracket Bolt (1/4 x 3/4 inch) Locknut (1/4 inch)	1 1 2 2	Install the switch.
5	Wire harness Cable tie	1 2	Route the wire harness
6	Long reflector Short reflector	2 2	Install the reflectors.
7	No parts required	–	Complete the installation.



1

Preparing the Machine

No Parts Required

Procedure

1. Park the machine on a level surface.
2. Engage the parking brake.
3. Lower the loader arms.
4. Shut off the engine and remove the key.
5. Open the rear-access cover.
6. Turn the battery-disconnect switch to the OFF position.
7. Open the hood and secure the prop rod.
8. Remove the cover plate.

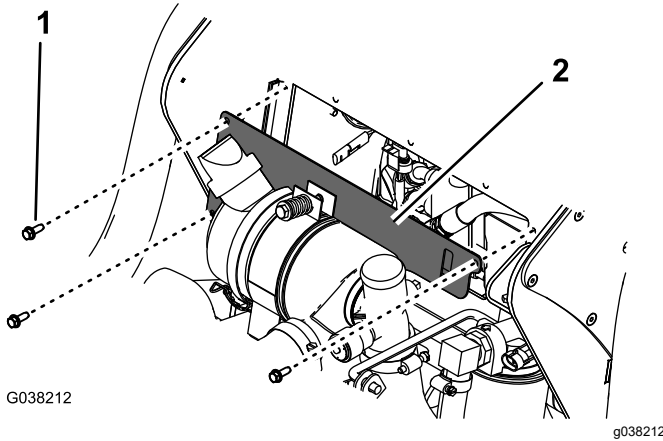

Figure 1

1. Bolt—1/4 x 3/4 inch (3) 2. Cover plate

2

Installing the Front Light

Parts needed for this procedure:

1	Light
1	Front light bracket
1	Carriage bolt (5/16 x 1 inch)
4	Bolt (1/4 x 5/8 inch)
1	Lock washer
4	Washer
1	Nut (5/16 inch)
4	Nut (1/4 inch)

Procedure

1. Install a light to the front bracket.

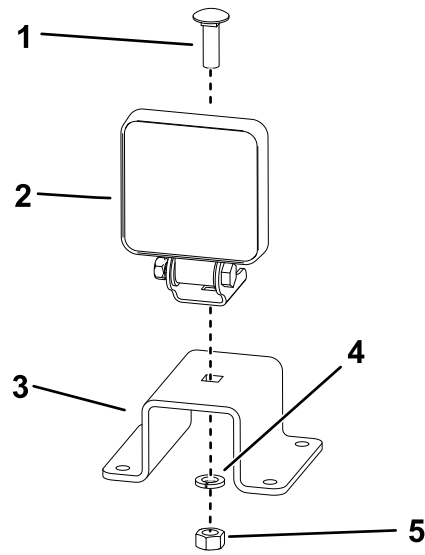

Figure 2

1. Carriage bolt (5/16 x 1 inch) 4. Lock washer
 2. Light 5. Nut (5/16 inch)
 3. Front bracket

2. Install the front light bracket in the center of the hood.

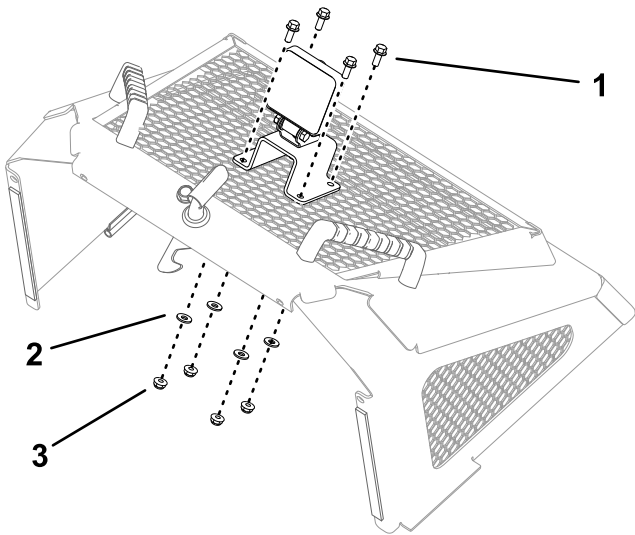

Figure 3

g341814

1. Bolt—1/4 x 5/8 inch (4)
2. Washer (4)
3. Nut—1/4 inch (4)

3

Installing the Rear Light

Parts needed for this procedure:

1	Light
1	Rear light bracket
1	Bolt (5/16 x 3/4 inch)
1	Carriage bolt (5/16 x 1 inch)
1	Lock washer
1	Nut (5/16 inch)

Procedure

1. Remove and discard the bolt securing the top of the right cushion.

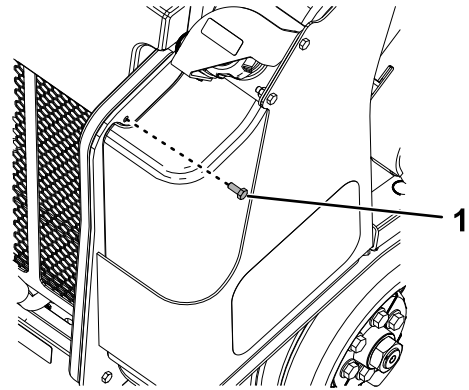

Figure 4

g341694

1. Bolt

2. Install the rear light bracket.

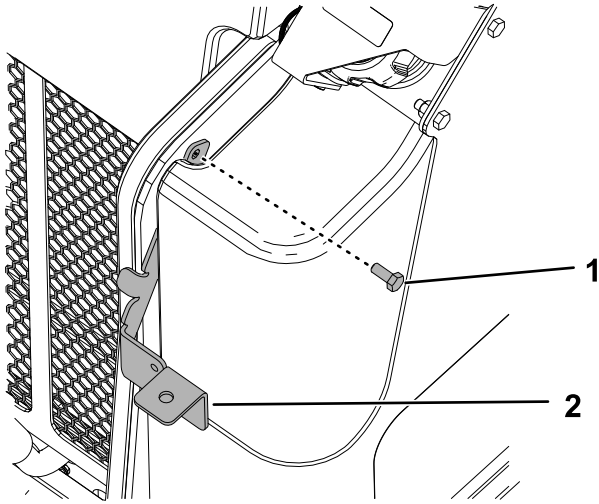

Figure 5

g341692

1. Rear light bracket 2. Bolt (5/16 x 3/4 inch)

3. Install a light to the bracket.

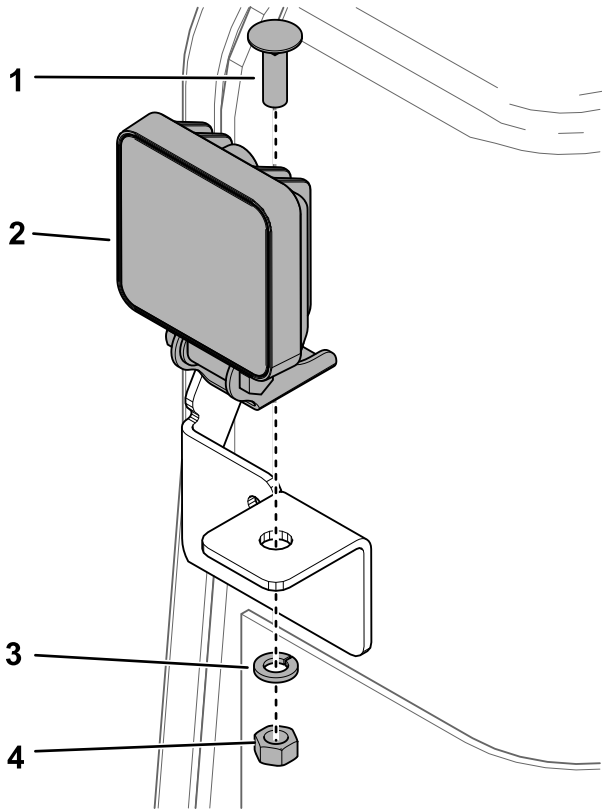

Figure 6

g341693

1. Carriage bolt (5/16 x 1 inch) 3. Lock washer
2. Light 4. Nut (5/16 inch)

4

Installing the Switch

Parts needed for this procedure:

1	Switch
1	Switch bracket
2	Bolt (1/4 x 3/4 inch)
2	Locknut (1/4 inch)

Procedure

1. Install the switch bracket to the left frame plate.

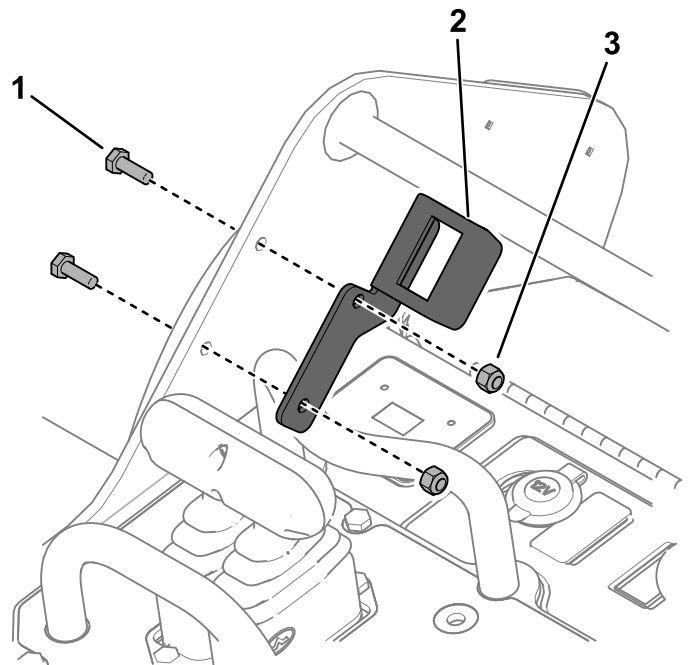
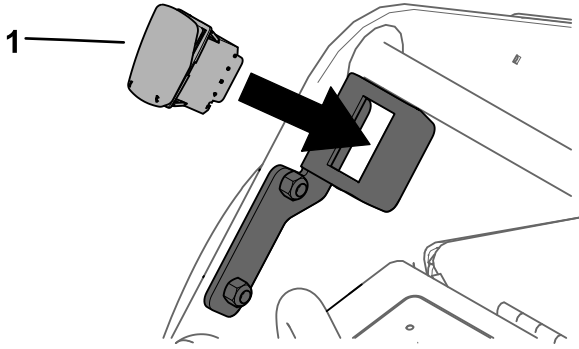

Figure 7

g341816

1. Bolt—1/4 x 3/4 inch (2) 3. Locknut—1/4 inch (2)
2. Switch bracket

2. Install the switch to the bracket.



g341817

Figure 8

1. Switch

5

Routing the Wire Harness

Parts needed for this procedure:

1	Wire harness
2	Cable tie

Procedure

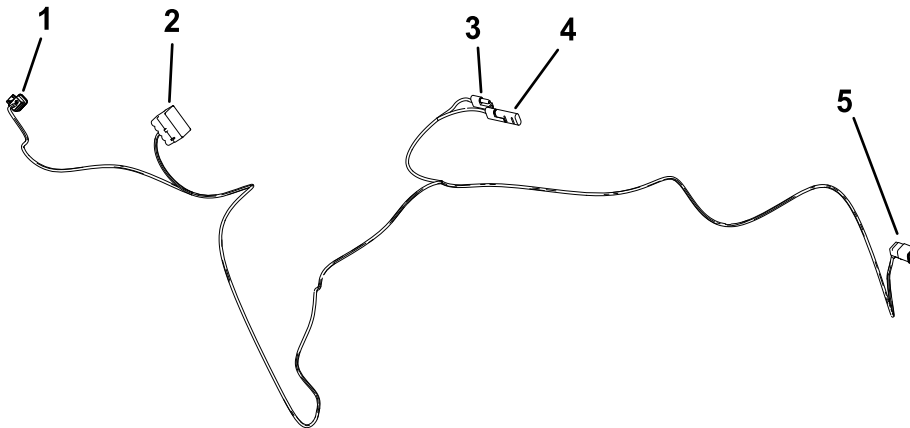
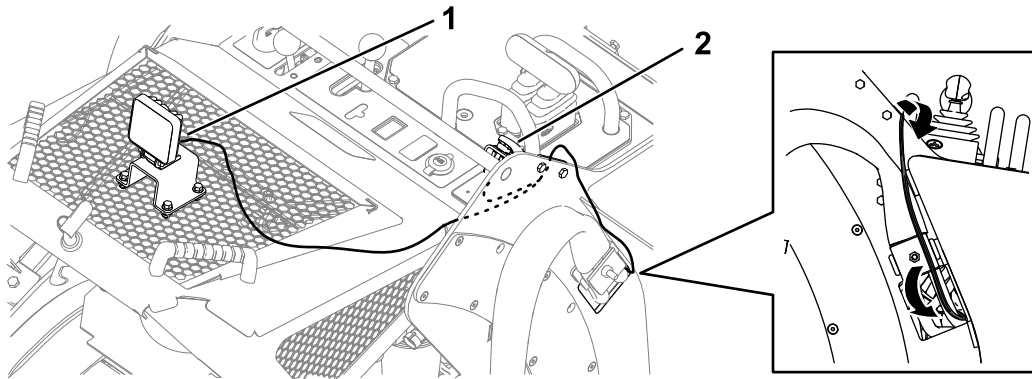

Figure 9

g341986

- | | | |
|----------------|------------------------------|---------------|
| 1. Front light | 3. Machine harness connector | 5. Rear light |
| 2. Switch | 4. Accessory connector | |

1. Connect the wire harness to the front light.



g341983

Figure 10

1. Front light
2. Switch

-
2. Route the cable over the hood and connect the switch connector to the switch.
 3. Route the cable over the left frame plate, and follow the hydraulic hoses through the hole.
 4. Follow the machine wire harness through the rear of the machine.

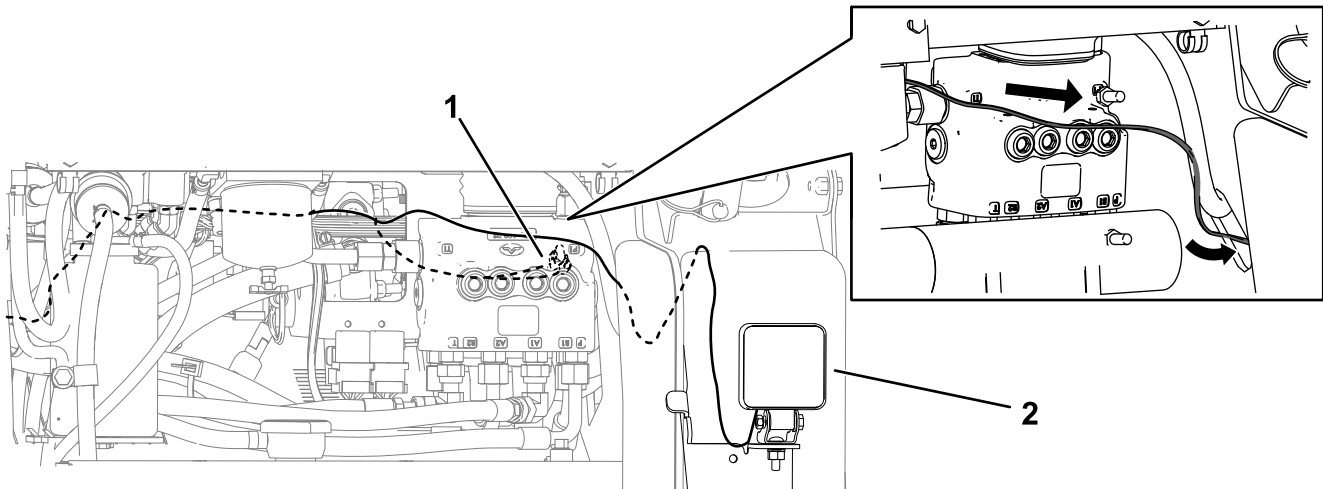

g341985

Figure 11

1. Accessory and machine harness connectors
2. Rear light

-
5. Route the connector for the right light through the hole on the right side of the machine and connect it to the light.

6. Inside the hood, connect the machine harness connector to the light kit connector (P15) on the machine wire harness.

Note: Use the accessory connector from the kit wire harness to connect any other powered accessories.

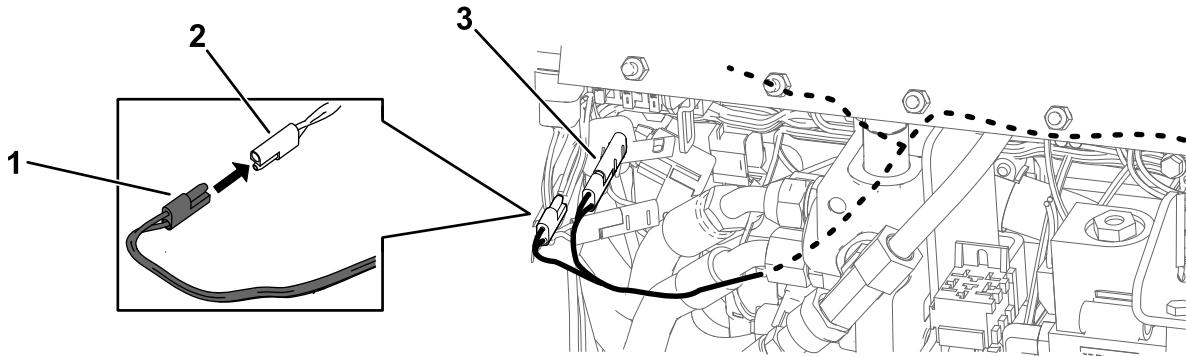

g341984

Figure 12

1. Machine harness connector from kit wire harness
2. Light kit connector from machine wire harness
3. Accessory connector

7. Close the hood.
8. Use 2 cable ties to secure the wire harness away from moving parts.

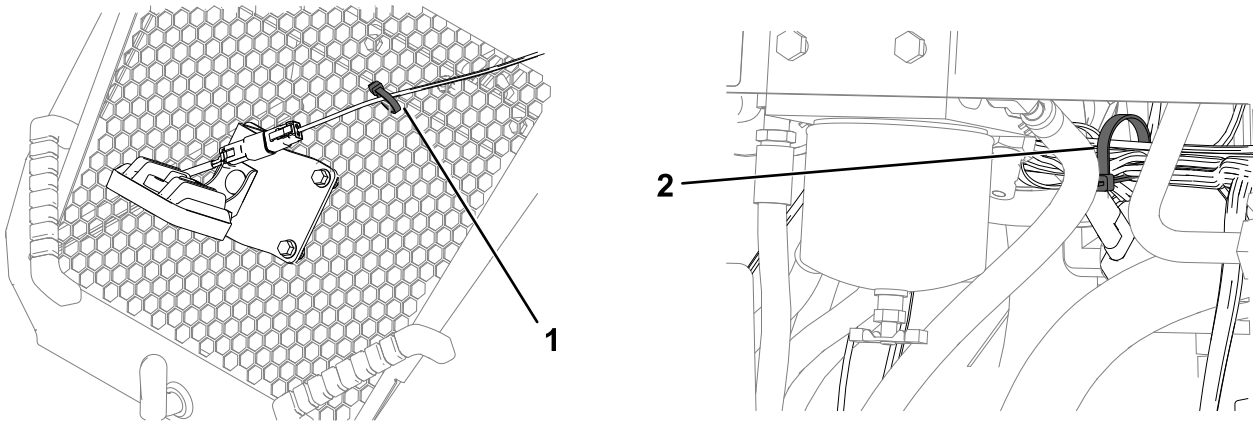

g341992

Figure 13

1. Secure the wire harness to the hood.
2. Secure the wire harness to the machine wire harness inside the machine.

6

Installing the Reflectors

Parts needed for this procedure:

2	Long reflector
2	Short reflector

Procedure

1. Install the front reflectors.

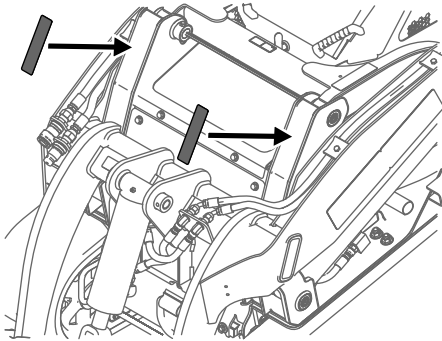

Figure 14

g341818

2. Install the rear reflectors.

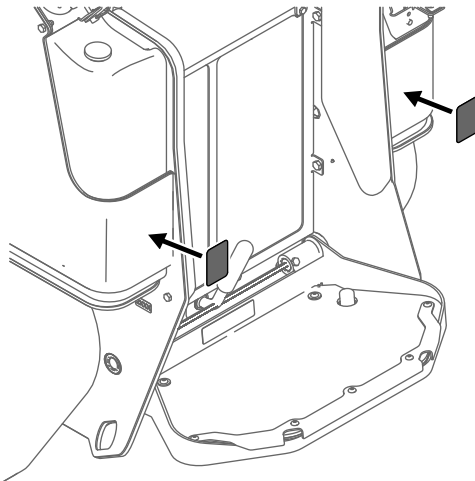

Figure 15

g341819

7

Completing the Installation

No Parts Required

Procedure

1. Turn the battery-disconnect switch to the ON position.
2. Close the rear-access cover.
3. Install the cover plate.

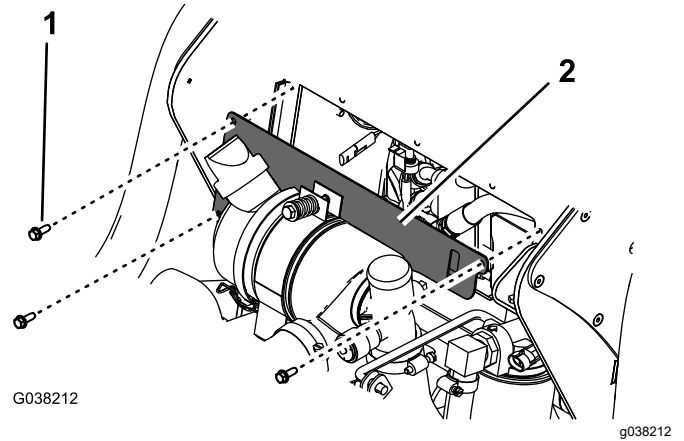

Figure 16

1. Bolt—1/4 x 3/4 inch (3)
2. Cover plate

4. Close the hood.
5. Start the machine and verify that the lights function using the switch.