

## 42" Snow Blade

Model No. 79150—4900001 and Up

### Installation Instructions

## Safety and Instruction Decals



Safety decals and instructions are easily visible to the operator and are located near any area of potential danger. Replace any decal that is damaged or lost.

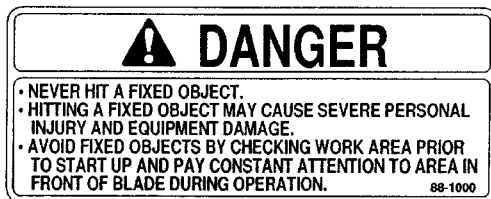

Part No. 88-1000

## Loose Parts

**Note:** Use the chart below to verify that all of the parts have been shipped.

Description	Qty.	Use
Template	1	Marking tractor frame hole locations of bracket holes
Brackets and braces	2	Mounting frame assembly to tractor frame
Center braces	2	Mounting frame assembly to brackets
Support rod and tube	1	Mounting braces to brackets
Frame assembly	1	Mounting blade to brackets
Blade assembly	1	Attach to frame assembly
Handle assembly	1	Pivot blade side to side
Lift lever assembly	1	Raises and lowers blade
Lift rod	1	Connect lift lever assembly to frame assembly.
Loose parts bag	1	All miscellaneous parts

## Preparation

1. Remove the mower deck; refer to the Operator's Manual for instructions. Also remove the deck suspension rod and trunnion.

**Note:** Save all mower deck mounting hardware for use when installing mower deck to tractor.

2. On 38 inch mower deck models only, remove the blade control cable (PTO) from the blade control lever (and bracket, if applicable) behind the dash (Fig. 1).

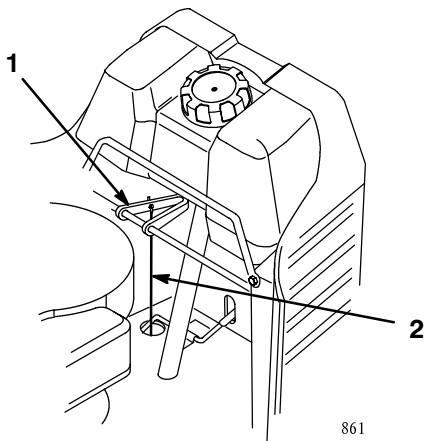

**Figure 1**

1. Blade control lever
2. Control cable (PTO)

3. If the tractor frame does not have holes drilled, in (Fig. 2), cut out the frame hole location template and fold the tabs along the dotted lines.

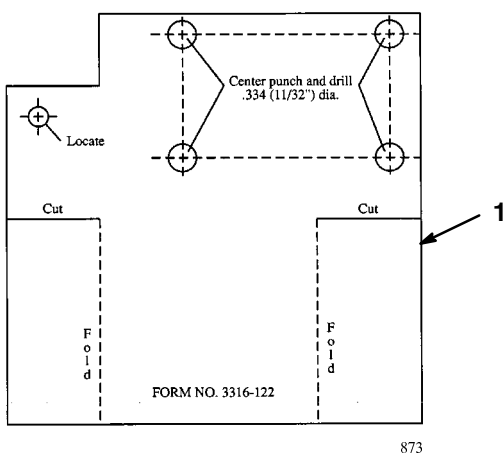
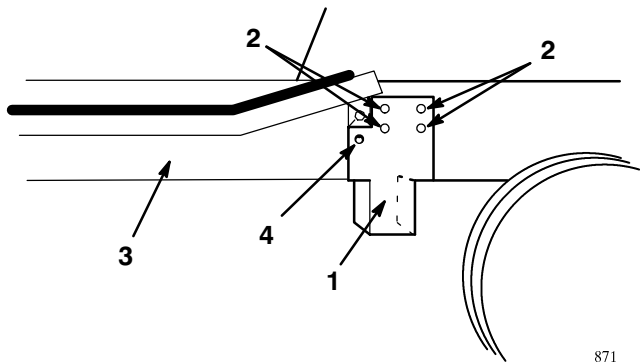

**Figure 2**

1. Template

4. Locate the template (Fig. 3) with folded wings below and against the bottom of the right frame rail. Align the hole, marked "Locate," over the 1/4 inch hole in the frame with the wire harness retainer sticking out.

5. Holding the template against the frame, center punch the location of the bracket mounting holes in the frame rail (Fig. 3).
6. Reverse fold the template tabs and hold the template below and against the left frame rail. Align the template hole, marked "Locate," with the 1/4 inch hole in the frame. Center punch the location of the bracket mounting holes in the frame rail.
7. Drill four 11/32 (.344) inch diameter holes in the left and right frame rails (Fig. 3).

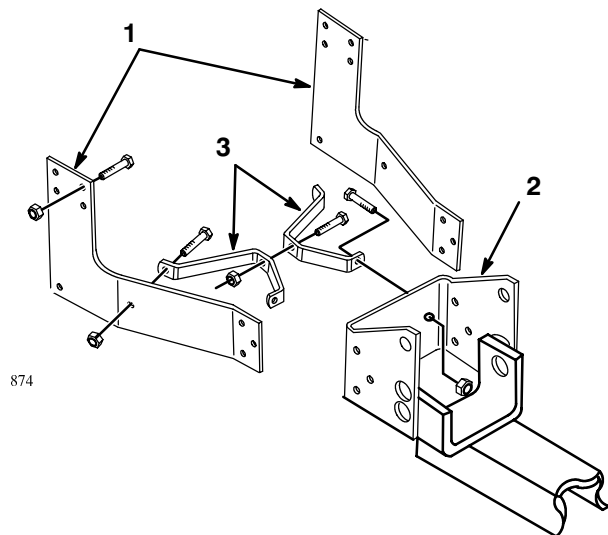

**Figure 3**

1. Template
2. Drill 11/32 (.344) inch holes
3. Frame
4. Location hole

## Installing the Blade Mount

1. Loosely attach the right and left side brackets to the frame rails with bolts (5/16 x 3/4 in.) and locknuts (Fig. 4).



**Figure 4**

1. Bracket
2. Frame mount
3. Center brace

- Loosely assemble the center braces to the brackets and the frame mount with bolts (5/16 x 3/4 in.) and locknuts (Fig. 4).
- Attach the braces to the left and right brackets with the support tube, support rod, and locknuts (5/16 in.) (Fig. 5).
- Move the braces up to the frame rails Figure 4. Using braces as a guide, locate holes 1/2 inch from the bottom of the frame rail. Drill 11/32 in. (.344 in.) diameter hole in the left and right frame rails, if required (Fig. 5).
- Secure the braces to the frame with bolts (5/16 x 3/4 in.) and locknuts.
- Tighten all bracket mounting hardware securely.

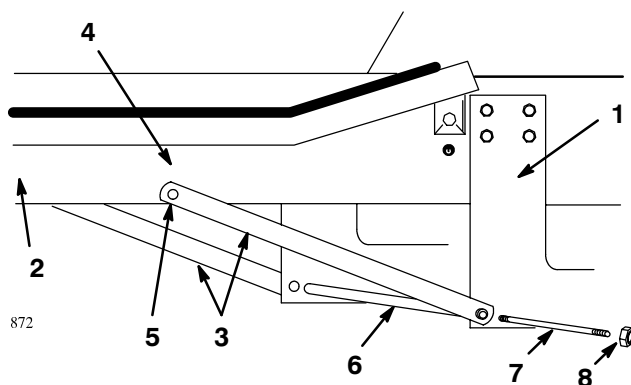
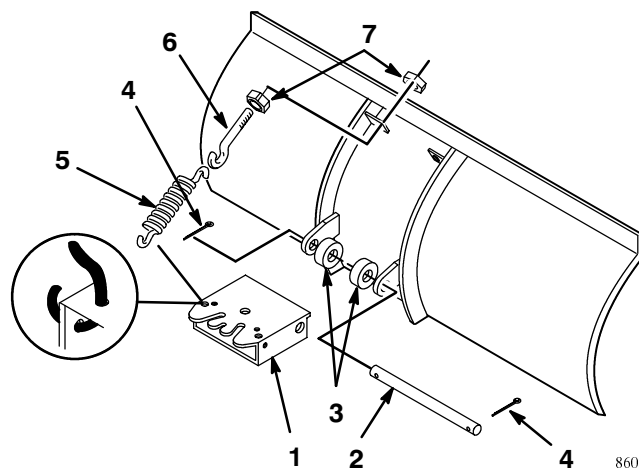

**Figure 5**

- |                   |   |
|-------------------|---|
| 1. Bracket        | 5. Drill 11/32 (.344) inch hole (if required) |
| 2. Frame rail     | 6. Support tube                               |
| 3. Brace          | 7. Support rod                                |
| 4. 1/2 inch space | 8. Nut  |

## Assembling the Blade

- Assemble the snow blade to the quadrant with the pivot rod and spacers. Retain them with cotter pins (Fig. 6).
- Thread a jam nut partially onto an eye bolt and insert the eye bolt into the blade bracket (Fig. 6). Hook the trip spring between the rear holes in the quadrant and the eye bolt. Secure with a second jam nut (Fig. 6). Tighten the top jam nut so the spring is under slight tension, then tighten lower the jam nut.
- Repeat the procedure for the other trip spring and eye bolt.

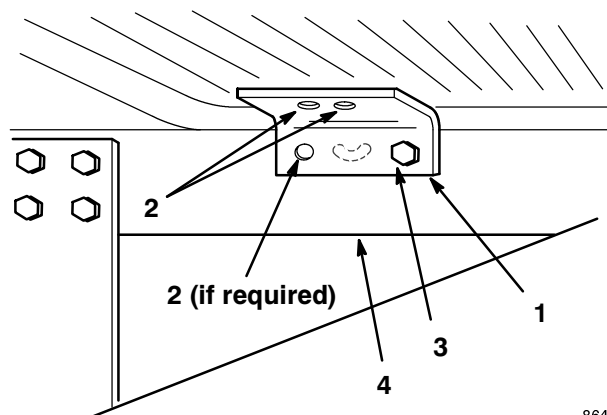

**Figure 6**

- |               |             |
|---------------|-------------|
| 1. Quadrant   | 5. Spring   |
| 2. Pivot rod  | 6. Eye bolt |
| 3. Spacer     | 7. Jam nut  |
| 4. Cotter pin |             |

## Installing the Lift Handle and Rod

- Attach the support bracket to the frame below the left footrest using the rear hole in the bracket and the existing hole in the frame (Fig. 7). Secure with bolt (5/16 x 3/4 in.) and locknut.
- Using the support bracket as a template, drill the remaining mounting holes through the left frame rail (if required), footrest, and rubber mat with a 11/32 in. (.344 in.) diameter drill (Fig. 7). Install a second bolt (5/16 x 3/4 in.) and locknut to secure the support bracket to the frame rail.



**Figure 7**

- |                                    |                                       |
|------------------------------------|---------------------------------------|
| 1. Support bracket                 | 3. Screw, 5/16 x 3/4 in., and locknut |
| 2. Drill 11/32 in. (.344 in.) hole | 4. Left frame rail                    |

3. Mount the lift handle assembly on top of the left footrest with carriage bolts (5/16 x 1-3/4 in.) and locknuts (Fig. 8). Tighten all lift handle and support bracket mounting hardware securely.

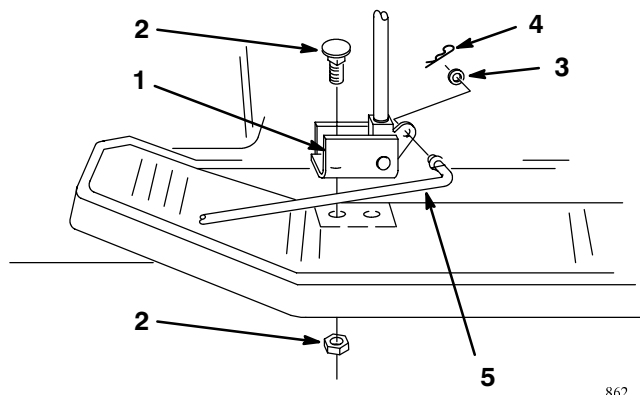

**Figure 8**

- |   |                    |
|---|--------------------|
| 1. Lift handle assembly                         | 3. Washer, 1/2 in. |
| 2. Carriage bolt, 5/16 x 1-3/4 in., and locknut | 4. Hairpin cotter  |

4. Assemble the trunnion and spacer onto the threaded end of the lift rod (Fig. 9). Thread retaining locknut onto the lift rod until approximately 1/4 in. (6 mm) of threads extend out from the locknut.

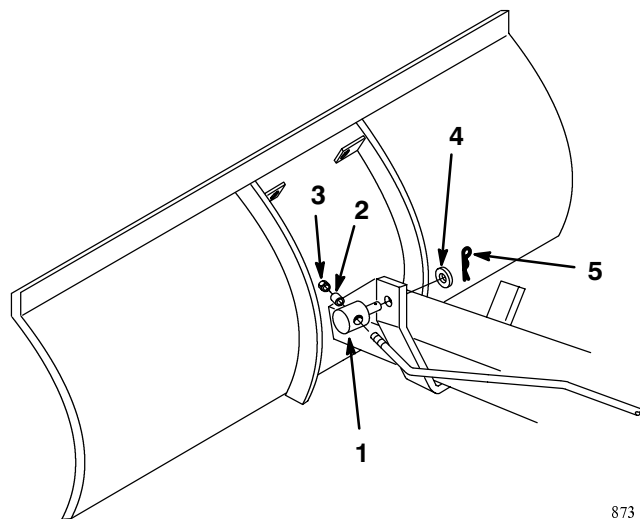

**Figure 9**

- |             |                    |
|-------------|--------------------|
| 1. Trunnion | 4. Washer, 1/2 in. |
| 2. Spacer   | 5. Hairpin cotter  |
| 3. Locknut  |                    |

5. Install the lift rod into the lift lever assembly and trunnion into the frame lift bar (Fig. 9). Secure with washers (1/2 in.) and hairpin cotters.

6. Set the unit on a level surface to adjust the blade height. Set the lift lever in the center position and turn the locknut (Fig. 9) so that the blade is just touching the ground. Adjust the fixed height to personal preference, for your conditions, from there.

## Installing the Pivot Handle

1. Align the rod with the hole in the handle bracket and slide the handle into position (Fig. 10). Secure the rod to the handle bracket with a hairpin cotter.

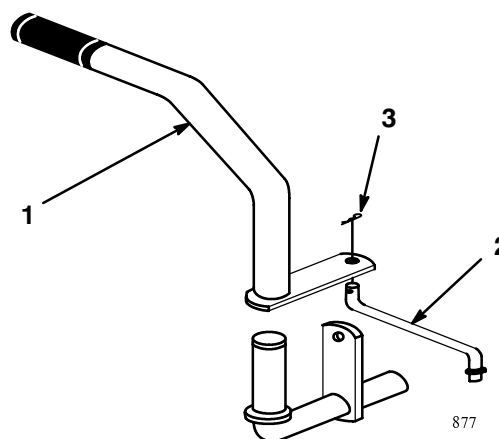

**Figure 10**

- |           |                   |
|-----------|-------------------|
| 1. Handle | 3. Hairpin cotter |
| 2. Rod    |                   |

2. Before operating make sure all bolts are tight and cotter pins are in place.
3. Apply a light coat of machine oil to all moving parts before first use and after every ten hours of operation.

## Operation

The blade is designed for removing light snow. It should not be used for pushing dirt, sand, gravel, or on any other application other than light snow.

Clearing snow from a driveway is usually done by making a first pass down the center of the drive. On following passes push the snow off to each side.

For best performance operate the engine at full throttle. Use the transmission to select the proper ground speed.

Wheel weights and chains are recommended to improve traction.

# Blade Removal

**Note:** Save all snow blade mounting hardware for use when reinstalling the snow blade to the tractor.

1. Remove the lift handle from the footrest, if desired.
2. Remove the blade frame from brackets and center braces (Fig. 4).
3. Remove brackets and braces from the tractor frame (Fig. 5).
4. Press the plastic fasteners through the open holes in the footrest pad and into the retaining washers under the support bracket (Fig. 11).
5. On 38 inch mower deck models only, guide the blade control cable (PTO) up through the frame opening along the side parking brake lever and hook the “Z” end into the blade control lever behind the dash (Fig. 1). See the Operator’s Manual for cable routing to the mower deck.

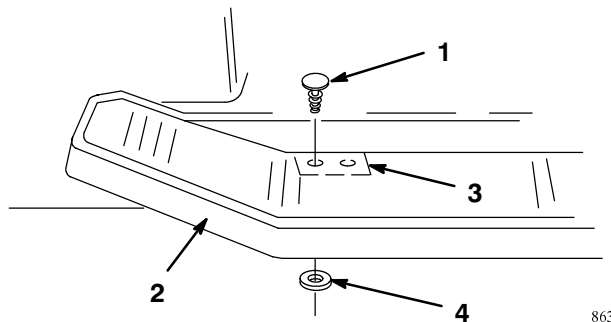

**Figure 11**

- |             |                    |
|-------------|--------------------|
| 1. Fastener | 3. Support bracket |
| 2. Footrest | 4. Washer          |

## Maintenance

Apply a light coat of machine oil to all moving parts before first use and after every ten hours of operation.

The blade edge is reversible. When the edge becomes worn, remove the attaching bolts and turn the blade edge over; this provides a new cutting edge.

Before storing, thoroughly clean the blade, washing it with a garden hose. Exposed bare metal surfaces should be painted to prevent rust. Touch up paint is available from your Authorized Dealer.





