



Contour Following Kit

ProCore Aerators

Part No. 09154

Installation Instructions

This kit is not recommended for use on greens due to the inferior hole quality resulting from the raising and lowering of the aerator and different tractor dropping rates.

1. Install the left contour guard onto the left wheel assembly (Fig. 1), using 2 bolts (M10 x 50 mm), 2 locknuts (M10), and 4 washers (M10).

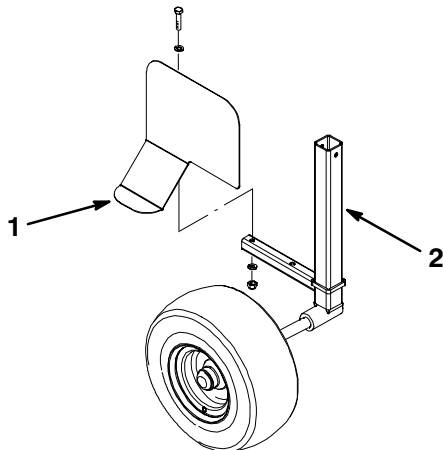

Figure 1

1. Contour guard
2. Wheel assembly

2. Repeat step 1 for the right contour guard and right wheel assembly.
3. Install a wheel mounting bracket onto the side panel of the aerator (Fig. 2), using 6 bolts (M12 x 35 mm), 6 locknuts (M12), and 12 washers (M12).
4. Repeat step 3 on the other side of the aerator.
5. Connect the bottom links of the tractor to the aerator as described in the aerator *Operator's Manual*.

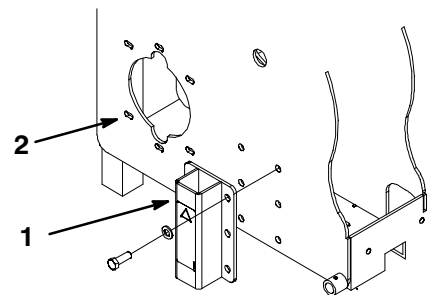

Figure 2

1. Wheel mounting bracket
2. Aerator side panel

6. Mount the top link assembly to the aerator as illustrated in Figure 3, using 2 pins and lynch pins.

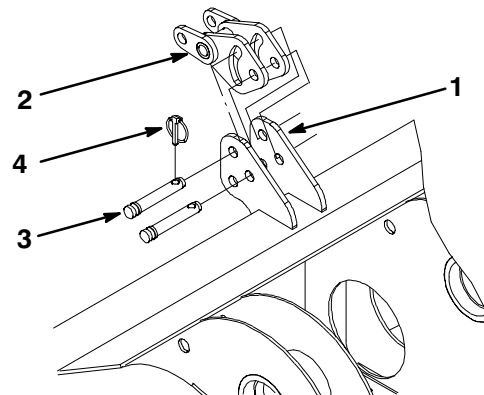

Figure 3

1. Aerator
2. Top link assembly
3. Pin
4. Lynch pin

7. Connect the top link assembly of the aerator to the top of tractor hitch as described in the aerator *Operator's Manual*.

8. Raise the aerator off of the ground until you can get the wheel leg under the wheel mounting bracket (Fig. 4).

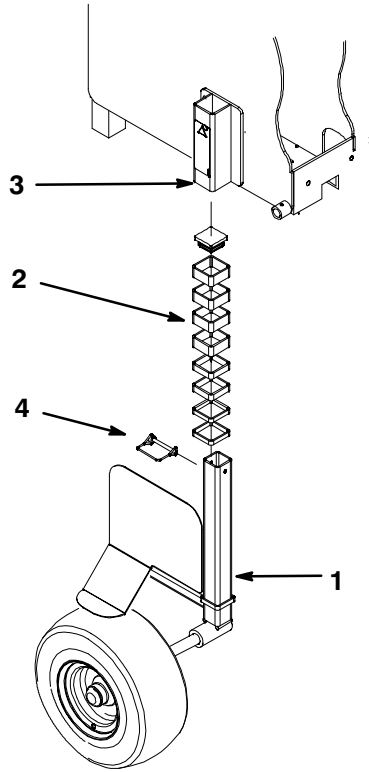

Figure 4

- | | |
|--------------|---------------------------|
| 1. Wheel leg | 3. Wheel mounting bracket |
| 2. Spacers | 4. Locking pin |

9. Using the table below (as a guide), determine the number and size (25, 15 or 10 mm) spacers required for your desired penetration depth, depth gage setting, and aerator angle.

10. Install the spacers onto wheel leg as shown in figure 4.

Important Use the same number and sizes of spacers on both sides of the aerator.

11. Install the leg of the wheel assembly up through the bottom of the wheel mounting bracket (Fig. 4).

12. Install the remaining spacers above the bracket for storage (Fig. 4).

13. Secure the wheel assembly with a locking pin (Fig. 4).

14. Repeat steps 9 through 13 for the other wheel assembly.

15. Lower aerator to the ground and determine if this is the desired operating angle. To achieve the best hole quality refer to aerator *Operator's Manual*. The angle and depth can be changed by adjusting the roller height and the number of spacers. Do not adjust the tractor top link as in a solid top link application.

16. Once the desired angle is achieved, adjust the tractor top link until mounting pin is centered in slot of top link of aerator.

This table is only a guide. Only two depths are included for use as examples. You will need to adjust the number of spacers to fit your operating conditions.

Contour Following Kit Table			
Penetration Depth	Depth Gage Setting	Aerator Angle	Space Below Bracket
2.9 in. (73 mm)	18	0 degrees forward	65 mm (i.e. 2-25mm & 1-15mm)
2.9 in. (73 mm)	23	4 degrees forward	65 or 70 mm
2.9 in. (73 mm)	27	8 degrees forward	70 mm
3.5 in. (84 mm)	21	0 degrees forward	50 mm
3.5 in. (84 mm)	25	4 degrees forward	55 mm