



17-44HXL Indy Special Edition

Wheel Horse® Lawn Tractor

Model No. 71233—210000001 and Up

Setup Instructions

Loose Parts

Note: Use the chart below to verify all parts have been shipped.

Description	Qty.	Use
Bolt, 1/4 x 3/4 in.	2	Installing the battery cables
Wing nut	2	
Spring hook	1	Install the lift assist spring
Key	2	Use in ignition and KeyChoice™ switches.
Operator's manual	1	Read and watch before operating tractor.
Engine operator's manual	1	
Safety booklet	1	
Safety video	1	
Registration card	1	Fill out and mail to Toro.

Check Tire Pressure

Check the front and rear tires for proper inflation. Refer to the Operator's Manual Maintenance section under Tire Pressure for recommended inflation pressure.

Activating the Battery

1. Remove the battery and battery box from the tractor; refer to the Operator's Manual, Removing the Battery.
2. Remove the vent caps from the battery (Fig. 1).
3. Slowly pour electrolyte into each cell until the electrolyte level is up to the Upper line (Fig. 1) on the battery case.



Danger



Battery electrolyte contains sulfuric acid which is a deadly poison and causes severe burns.

- Do not drink electrolyte and avoid contact with skin, eyes or clothing. Wear safety glasses to shield your eyes and rubber gloves to protect your hands.
- Fill the battery where clean water is always available for flushing the skin.
- Follow all instructions and comply with all safety messages on the electrolyte container.

4. Wait five to ten minutes after filling the battery cells. Add electrolyte, if necessary, until the electrolyte level is back up to the Upper line (Fig. 1) on the battery case.

Important Do not overfill the battery because electrolyte (sulfuric acid) can cause severe corrosion and damage to the chassis.

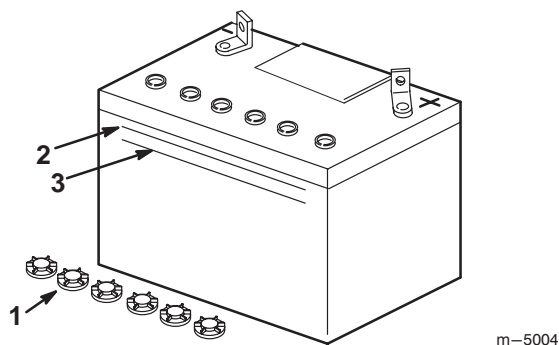

Figure 1

1. Vent caps
2. Upper line
3. Lower line

5. Reinstall the battery vent caps.
6. Connect a battery charger to the battery posts. Charge the battery for 1 hour at 25 to 30 amps or 6 hours at 4 to 6 amps. Do not overcharge the battery. Do not overcharge the battery.

Warning

Charging the battery produces gasses that can explode.

Never smoke near the battery and keep sparks and flames away from battery.

7. When the battery is fully charged, unplug the charger from the electrical outlet, then disconnect the charger leads from the battery posts (Fig. 2).

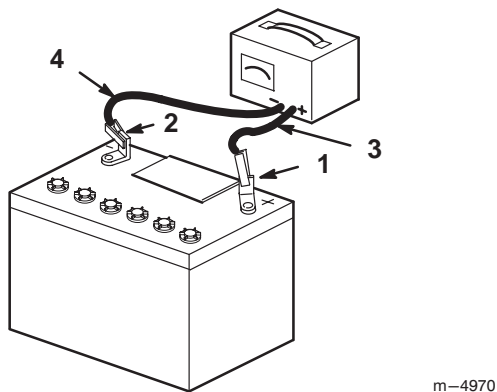

Figure 2

1. Positive battery post
2. Negative battery post
3. Red (+) charger lead
4. Black (-) charger lead

8. Install the battery in the tractor and connect the battery cables; refer to the Operator's Manual, Installing the Battery.

Note: Do not run the tractor with the battery disconnected because electrical damage may occur.

Checking the Oil Level

The tractor is shipped from the factory with oil in the engine crankcase; however, it may be necessary to add oil. Refer to the Operator's Manual, Engine Oil Specifications for oil type, viscosity, and crankcase capacity. Add only enough oil to raise the level to the Full mark on the dipstick.

Lubrication

Make sure all of the necessary points on the tractor are lubricated; refer to Greasing and Lubrication in the Operator's Manual.

Read the Operator's Manual

Read the Operation section of the Operator's Manual before operating the tractor.

Checking the Safety System

Refer to the Operator's Manual, Testing the Safety System.

Purging the Hydro Transaxle

During shipping and handling air can be introduced into the hydro transaxle. To achieve proper performance, all trapped air must be removed.

1. Place the tractor on a flat level surface.
2. Place the drive control in the Push position (Fig. 3).

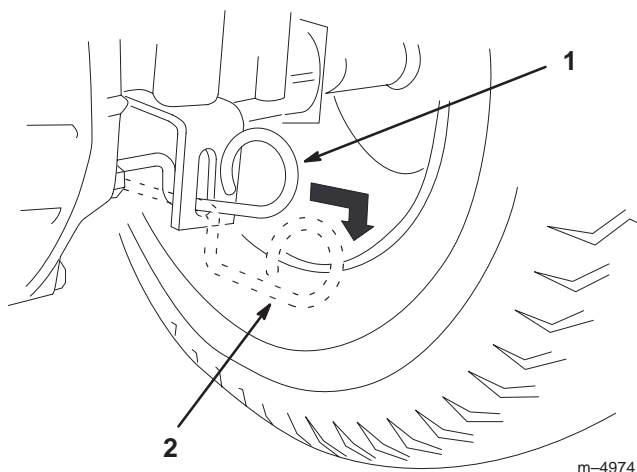

Figure 3

1. Operate position
2. Push position

3. Run the engine at a low idle and move the traction control pedal forward for 5 seconds then reverse for 5 seconds. Repeat 3 times.
4. Place the drive control in the Operate position (Fig. 3). Drive the tractor forward then reverse approximately 5 feet. Repeat 3 times.

Checking the Hydro Neutral Position

Ensure that the neutral position is set properly. An adjustment is required if the tractor moves without the traction control pedal being depressed.

1. Run the engine at a low idle and move the traction control pedal forward, then release. Move traction control pedal to reverse, then release. If the tractor moves while in the neutral position, proceed as follows:
2. Run the tractor for 5 to 10 minutes to warm the transaxle.
3. Disengage the PTO, set the parking brake, stop the engine, and remove the ignition key.
4. Raise the right rear wheel off of the ground and support it with a jack stand. Make sure that the left rear wheel stays on the ground.



Danger



Mechanical or hydraulic jacks may fail to support the machine and cause serious injury.

- Use jack stands when supporting the machine.
- Do not use hydraulic jacks.

Note: To gain access to the adjusting puck (Fig. 4), it may be necessary to remove the tire.

5. Loosen the adjusting puck screw (Fig. 4).
6. Start the engine and run it at full throttle.
7. Rotate the adjusting puck (Fig. 4) in both directions until you find the midpoint where the axle no longer rotates forward or reverse.
8. Hold the puck with an adjustable wrench so that it will not move. Then tighten and torque the adjusting puck screw to 21 to 27 ft.-lb. (28 to 36 N·m).
9. Stop the engine and remove the ignition key. Lower the tractor from the jack stand.
10. Check the adjustment again by repeating step 1.

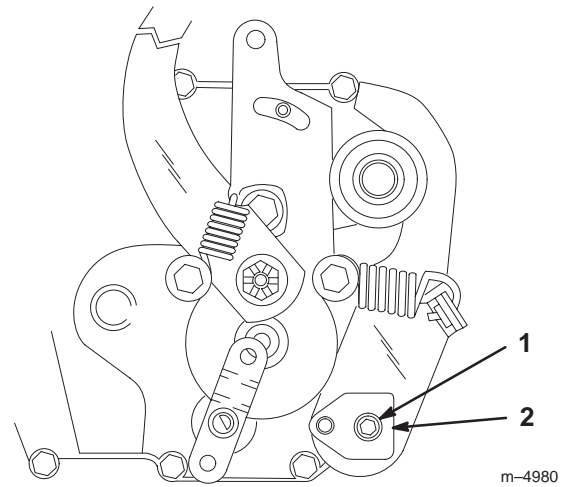

Figure 4

1. Adjusting puck screw
2. Adjusting puck

Checking the Traction Control Pedal

The traction control pedal can be adjusted for optimum forward and reverse speeds.

1. Loosen the screws below the right footrest. Slide the pedal forward for faster reverse speed or backward for faster forward speed (Fig. 5).
2. Tighten the screws and recheck the traction control pedal.

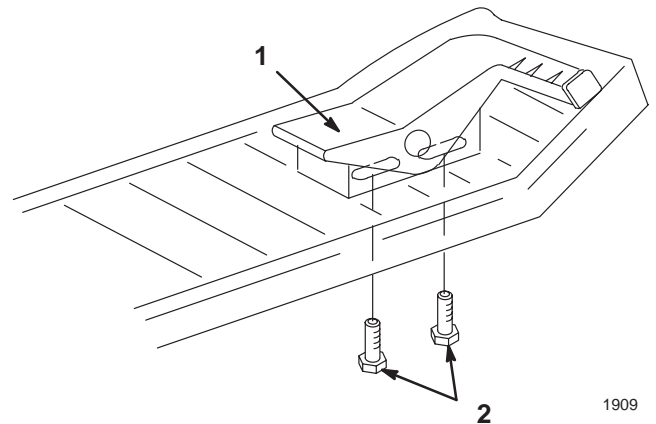

Figure 5

1. Traction control pedal
2. Adjusting screws

Test Driving the Tractor

Make sure all electrical and mechanical systems are operating properly. See the Operator's Manual for proper control function.

